

F.A.P. RTE.	SECTION	COUNTY	TOTAL SHEETS	SHEET NO.
309	16R-2	WHITESIDE	547	453
STA. 1136+25.00		TO STA. 1136+50.00		
FED. ROAD DIST. NO. 2 ILLINOIS FED. AID PROJECT				

IT SHALL BE THE CONTRACTOR'S RESPONSIBILITY TO ASCERTAIN THE LOCATIONS OF EXISTING WATER MAINS, GAS MAINS, SEWERS, ELECTRIC POWER LINES, TELEPHONE LINES AND OTHER UTILITIES FROM THE UTILITY COMPANIES AND BY FIELD INSPECTION.

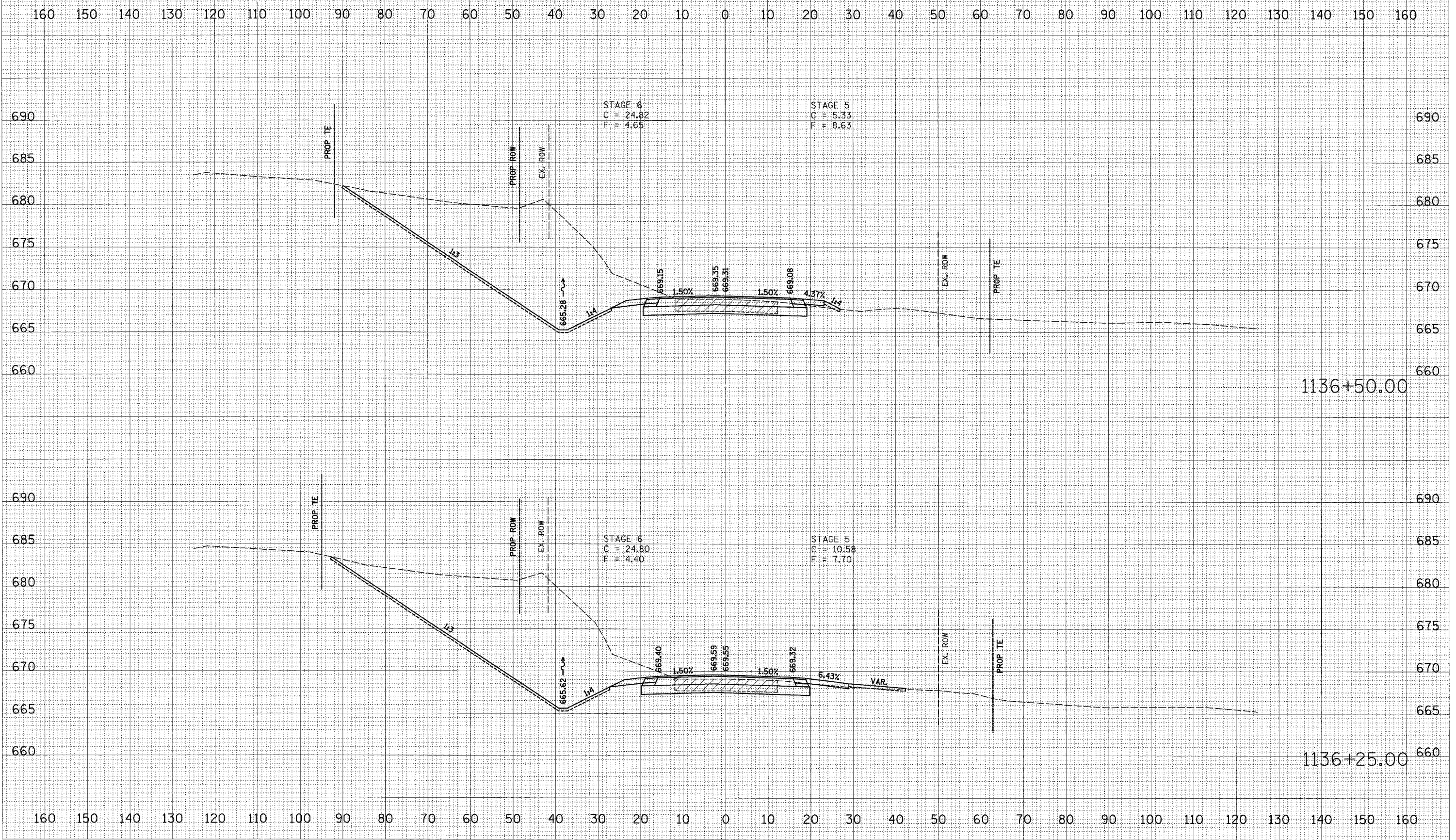

DATE: _____ BY: _____

FINAL SURVEY	SURVEYED
NOTE BOOK	PLOTTED
NO.	DATE
	AREAS CHECKED

DATE: _____ BY: _____

ORIGINAL SURVEY	SURVEYED
NOTE BOOK	PLOTTED
NO.	DATE
	AREAS CHECKED

PLOT DATE = *NOTES*
 FILE NAME = *FILE#*
 PLOT SCALE = *SCALE#*
 USER NAME = *USER#*