

F.A.P. RTE.	SECTION	COUNTY	TOTAL SHEETS	SHEET NO.
309	16R-2	WHITESIDE	547	460
STA. 1139+25.00		TO STA. 1139+50.00		
FED. ROAD DIST. NO. 2 ILLINOIS FED. AID PROJECT				

IT SHALL BE THE CONTRACTOR'S RESPONSIBILITY TO ASCERTAIN THE LOCATIONS OF EXISTING WATER MAINS, GAS MAINS, SEWERS, ELECTRIC POWER LINES, TELEPHONE LINES AND OTHER UTILITIES FROM THE UTILITY COMPANIES AND BY FIELD INSPECTION.

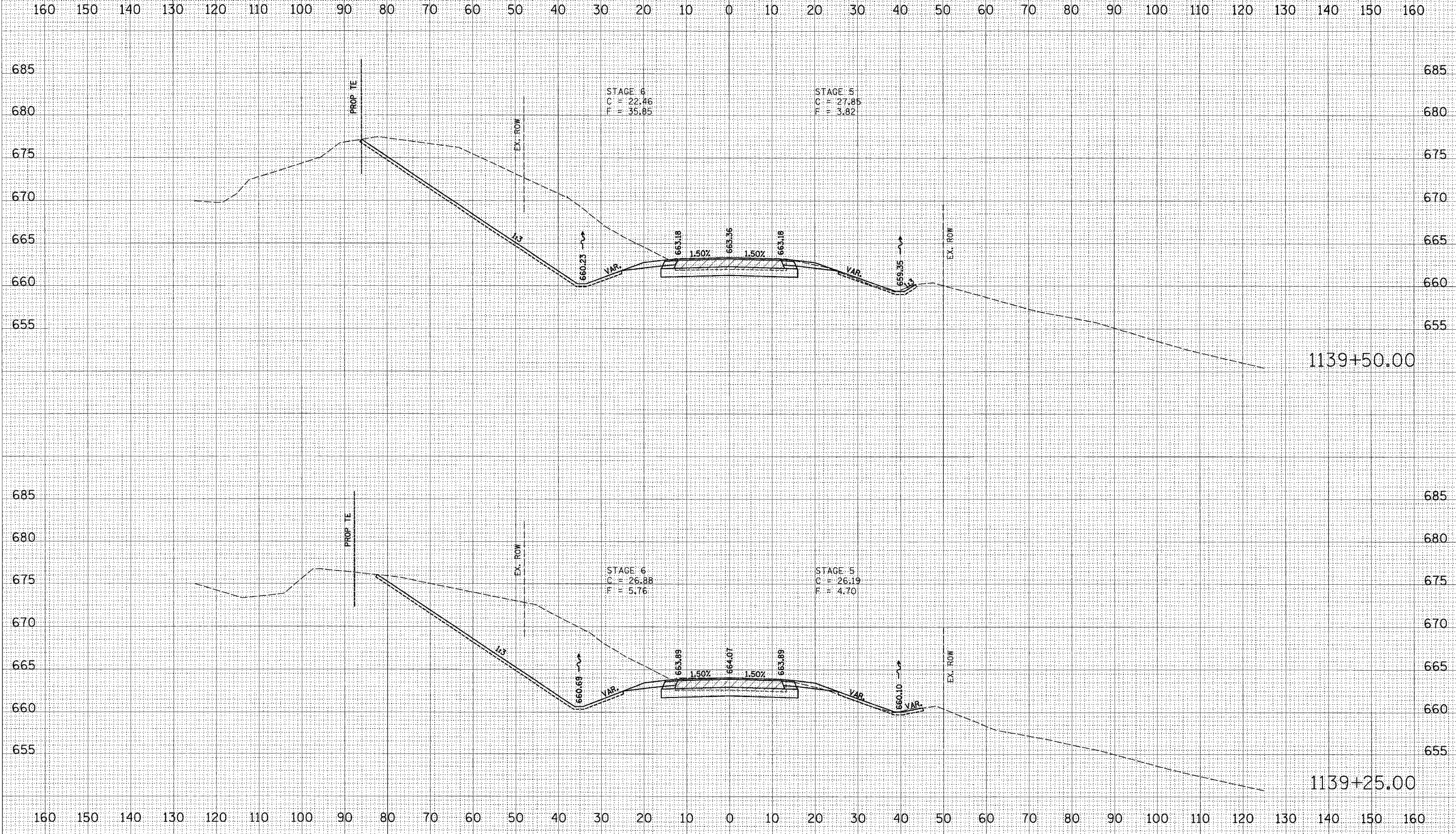

FINAL SURVEY	SURVEYED	DATE
NO.	NO.	
NO.	NO.	
NO.	NO.	

ORIGINAL SURVEY	SURVEYED	DATE
NO.	NO.	
NO.	NO.	
NO.	NO.	

DATE	SCALE	USER