

IT SHALL BE THE CONTRACTOR'S RESPONSIBILITY TO ASCERTAIN THE LOCATIONS OF EXISTING WATER MAINS, GAS MAINS, SEWERS, ELECTRIC POWER LINES, TELEPHONE LINES AND OTHER UTILITIES FROM THE UTILITY COMPANIES AND BY FIELD INSPECTION.

CONTRACT NO. 64969			
F.A.P. RTE.	SECTION	COUNTY	TOTAL SHEET NO.
309	16R-2	WHITESIDE	547 / 473
STA. 1145+50.00		TO STA. 1145+75.00	
FED. ROAD DIST. NO. 2		ILLINOIS FED. AID PROJECT	

160 150 140 130 120 110 100 90 80 70 60 50 40 30 20 10 0 10 20 30 40 50 60 70 80 90 100 110 120 130 140 150 160

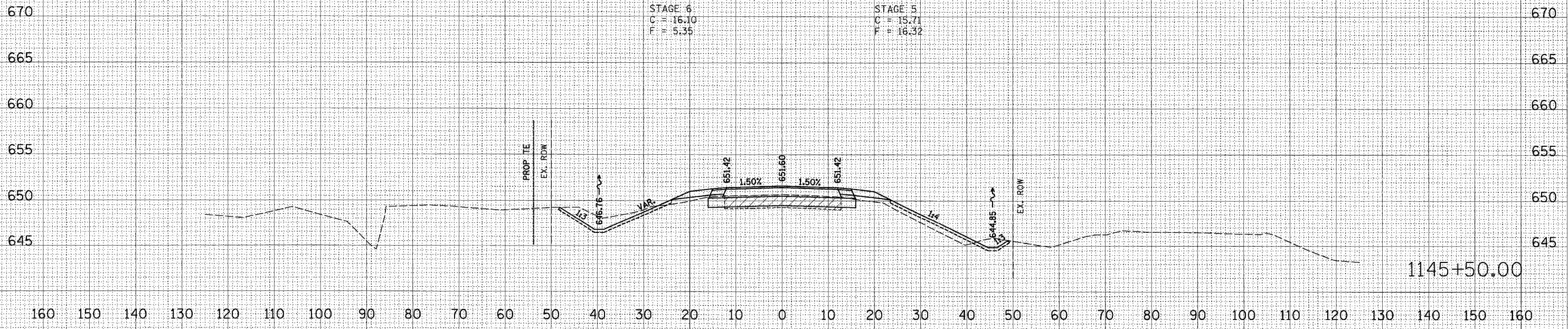
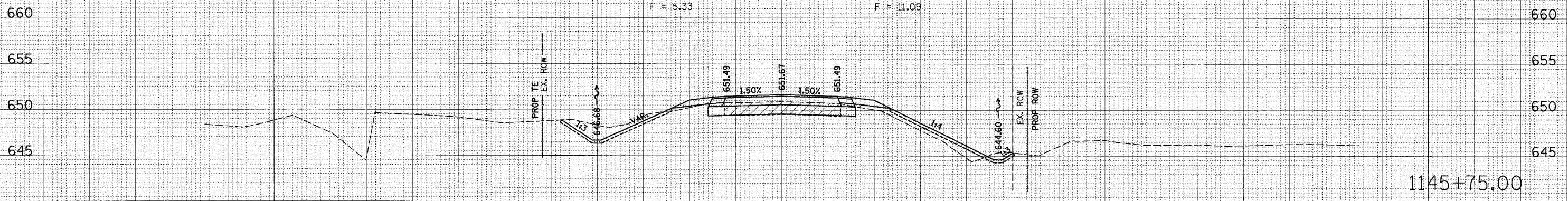

160 150 140 130 120 110 100 90 80 70 60 50 40 30 20 10 0 10 20 30 40 50 60 70 80 90 100 110 120 130 140 150 160

US ROUTE 30

DATE	BY

DATE	BY

PLOT DATE = #DATE#
FILE NAME = #FILE#
USER NAME = #USER#

Resistant Line Digit: 12/20/2005 3:35:38 PM