

IT SHALL BE THE CONTRACTOR'S RESPONSIBILITY TO ASCERTAIN THE LOCATIONS OF EXISTING WATER MAINS, GAS MAINS, SEWERS, ELECTRIC POWER LINES, TELEPHONE LINES AND OTHER UTILITIES FROM THE UTILITY COMPANIES AND BY FIELD INSPECTION.

CONTRACT NO. 64969				
F.A.P. RTE.	SECTION	COUNTY	TOTAL SHEETS	SHEET NO.
309	16R-2	WHITESIDE	547	499
STA. 1157+75.00		TO STA. 1158+00.00		
FED. ROAD DIST. NO. 2 ILLINOIS FED. AID PROJECT				

DATE	BY

NO.	AREA CHECKED

DATE	BY

NO.	AREA CHECKED

PLOT DATE = #MM/YY  
 FILE NAME = #FILE#  
 PLOT SCALE = #SCALE#  
 USER NAME = #USER#

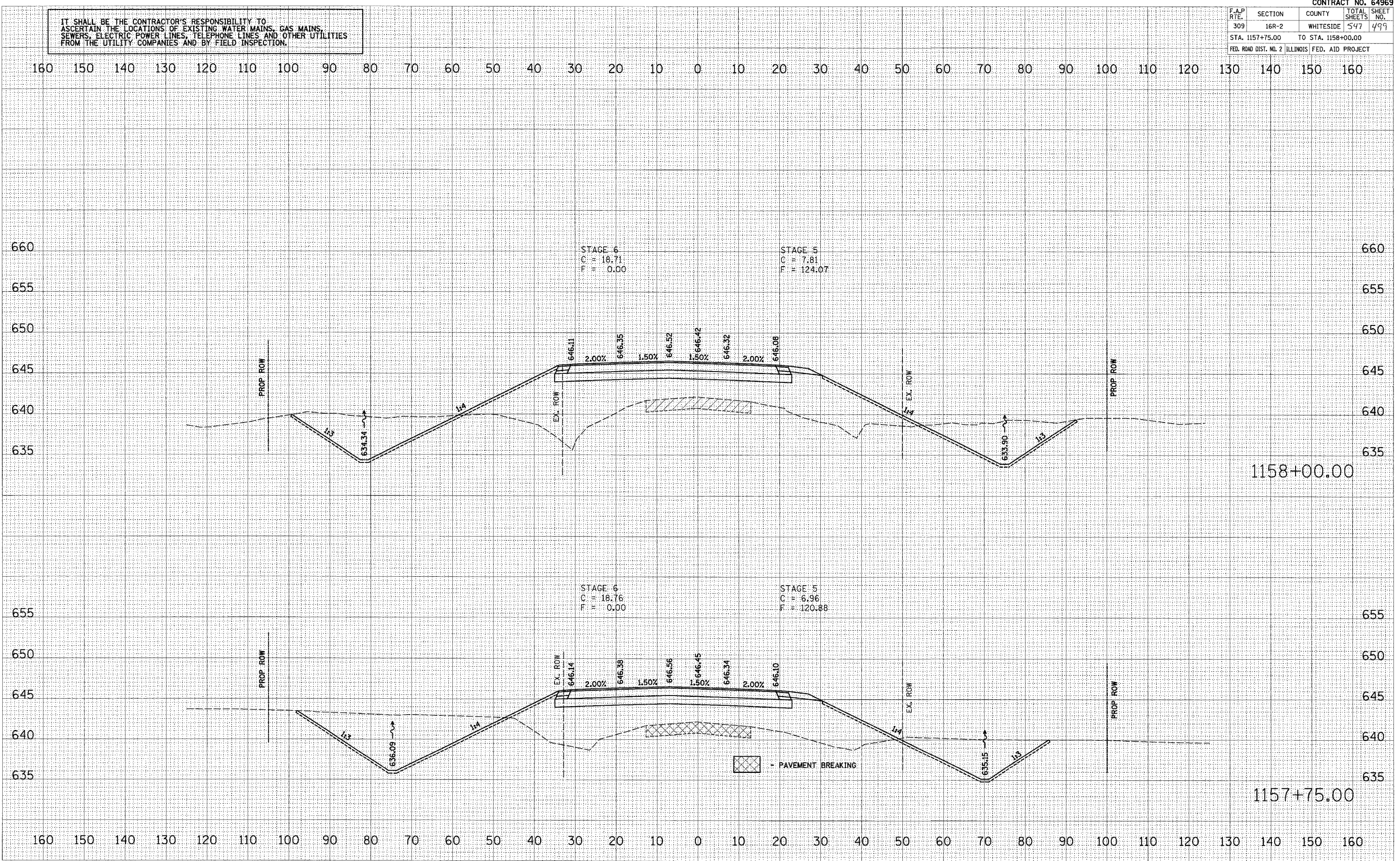

US ROUTE 30

12/9/2005 5:38:44 AM