

F.A.P. RTE.	SECTION	COUNTY	TOTAL SHEETS	SHEET NO.
309	16R-2	WHITESIDE	547	529
STA. 1172+50.00		TO STA. 1172+74.37		
FED. ROAD DIST. NO. 2 ILLINOIS FED. AID PROJECT				

IT SHALL BE THE CONTRACTOR'S RESPONSIBILITY TO ASCERTAIN THE LOCATIONS OF EXISTING WATER MAINS, GAS MAINS, SEWERS, ELECTRIC POWER LINES, TELEPHONE LINES AND OTHER UTILITIES FROM THE UTILITY COMPANIES AND BY FIELD INSPECTION.

DATE	BY

SURVEYED  
 PLOTTED  
 NOTE BOOK  
 AREAS CHECKED  
 No.

DATE	BY

ORIGINAL SURVEY  
 PLOTTED  
 NOTE BOOK  
 AREAS CHECKED  
 No.

PLOT DATE = DATE  
 FILE NAME = FILE#  
 PLOT SCALE = SCALE#  
 USER NAME = USER#

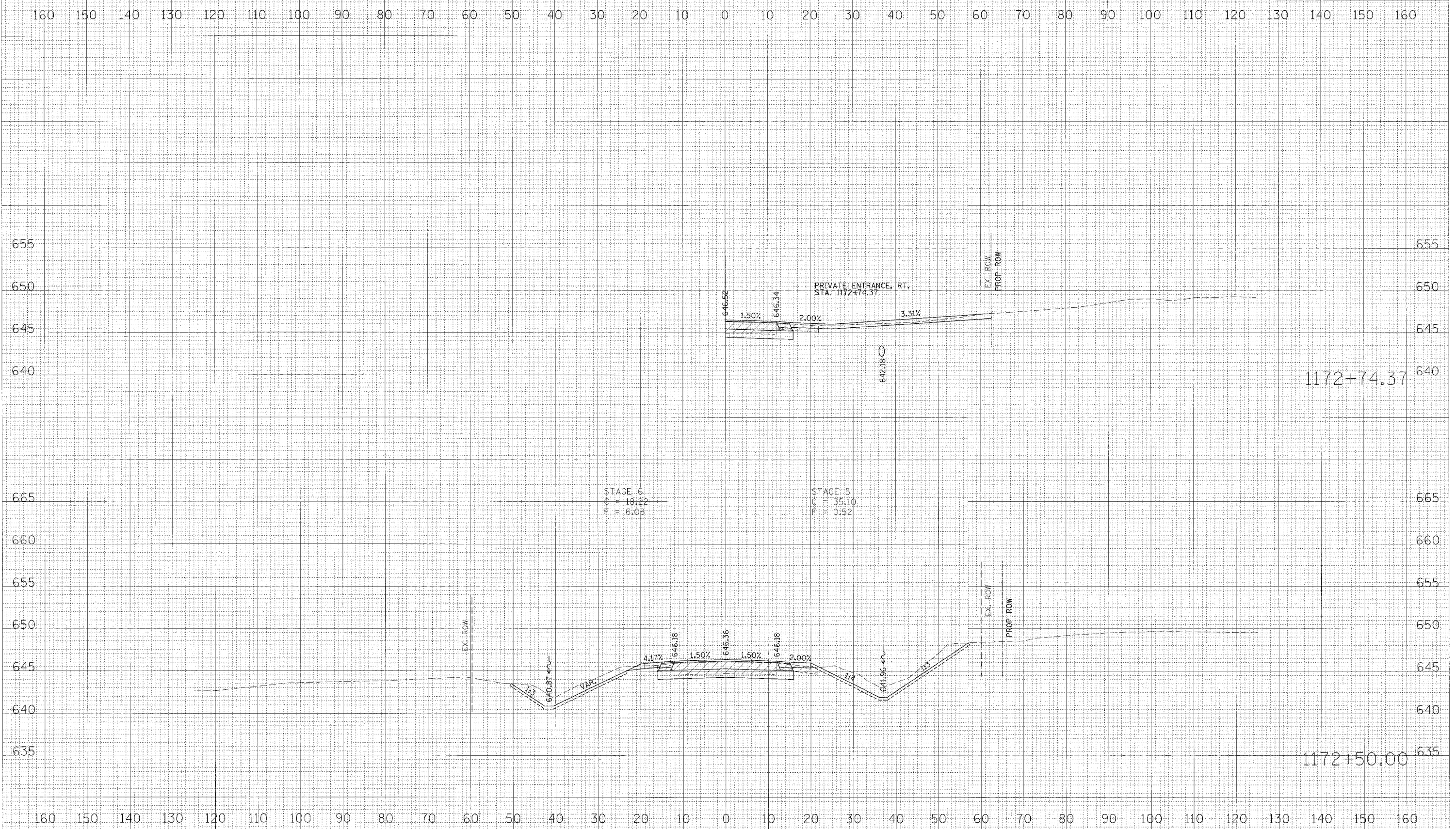

1172+74.37

1172+50.00