

| | | | | |
|---------------------|---------|---------------------------|--------------|-----------|
| F.A.P. RTE. | SECTION | COUNTY | TOTAL SHEETS | SHEET NO. |
| 627 | 1BR | LASALLE | 69 | 49 |
| STA. | | TO STA. | | |
| FED. ROAD DIST. NO. | | ILLINOIS FED. AID PROJECT | | |

STATE OF ILLINOIS
DEPARTMENT OF PUBLIC WORKS & BUILDINGS
DIVISION OF HIGHWAYS

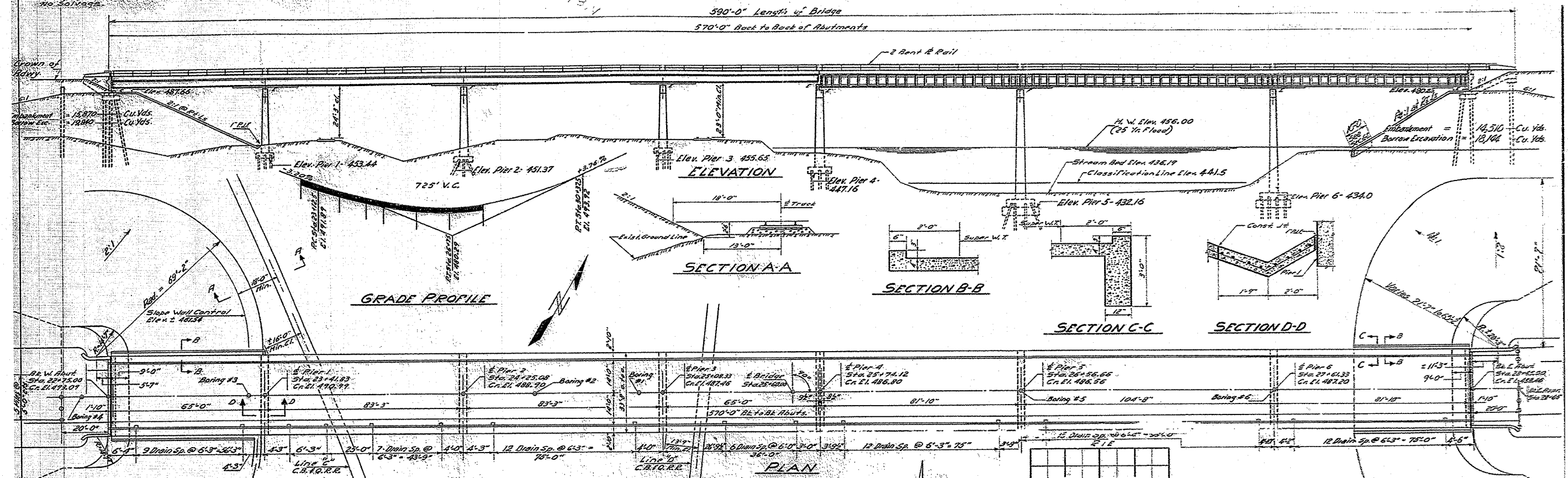

PILE DATA
(For West Approach)
Type - Crested
No. Piles - 5
Capacity - 15 Tons
Lst. Length - 40 Ft.

Note: Drains @ Ea. curb

GENERAL NOTES

Class X Concrete shall be used throughout except in end piers and seal coat concrete.
The concrete floor slab shall be poured in one continuous operation between longitudinal joints and shall be finished in accordance with Art. 61.9 of the Standard Specifications.
The curbs & slab outside of the longitudinal construction joints shown on cross section shall be poured monolithically.
All open top space 12" and 4" shall be 3" except as noted. All levels in space 24" shall be 2" except as noted.
Notes for 2" thick shall be punched 1/8" holes for 3/8" bolts shall be punched 1/4" except as follows. Void & shops splices shall be punched 1/8" reamed to proper size with all metal embedded in the shop in proper position.
All rollers, rollers bearing plates, lead plates, pinholes & anchor bolts shall be fabricated & set in accordance with Art. 51.15 of the Standard Specifications & are included in quantity of structural steel.
Estimated weight of bearings shall be 24,000 lbs.
Anchor bolts in 1/8" beam space shall be set before installing the piers over abutments & piers.
Metal handrail & structural steel, except the anchor bolts, shall receive one shop coat of red lead paint & two field coats of aluminum paint. See Arts. 26.1 to 26.5 inclusive of the Standard Specifications.
All structural steel & metal handrail shall be inspected by Illinois Division of Highways before painting.
All paint shall be furnished & applied by the contractor involved.
Expansion guards shall be fabricated & placed in accordance with Art. 51.13 (d) of the Standard Specifications. Expansion guards are included in quantity of structural steel. Estimated weight of this steel is 3,360 lbs.
Welding shall comply with Art. 54.3 (c) of the Standard Specifications.
The slope walls to be reinforced with #4 grade welded wire fabric 6"x6" mesh and weighing not less than 50 lbs. per 100 sq. ft. layout of slope walls may be varied to suit ground conditions in the field as directed by the Engineer.
The Contractor shall drive a test pile in permanent locations as follows: 1 @ Pier 2, 1 @ Pier 3, 1 @ Pier 4 and 1 @ East Abutment, as directed by the Engineer.
The test pile shall be driven before ordering or setting the remainder of piles.
Piles in East Abutment shall be placed in accordance with Art. 60.9 (c) of the Standard Specifications.

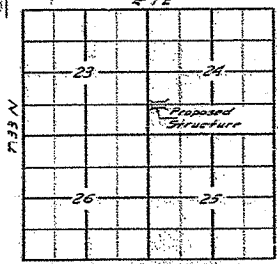

STATION 25+60
BUILT 11' BY
STATE OF ILLINOIS
F.A. PROJECT - SEC. 18-R
F.A. PROJECT - F-65-7(24)
LOADING H20-516
See Standard 2113

WATERWAY INFORMATION

Drainage Area - 86,440 Acres
Character - level, rolling, clay, wooded, cultivated
Required Opening (25% Flood) 3000 sq. ft.
Present Opening (East At Upstream) 4290 sq. ft.
Proposed Opening - 3000 sq. ft.
Ordinary Water Elev. - 442.61
Low Water Elev. - 440.5

STRESSES

f_c = 1400 p.s.i. Comp. (5000)
f_t (100) = 75 p.s.i.
f_s = 20,000 p.s.i. (Struct.)
f_s = 16,000 p.s.i. (Struct.)
D = 12

Loading H20-516-44

TOTAL BILL OF MATERIAL - SECTION 18-R

| ITEM | SUPER | SUB | TOTAL |
|----------------------------------|--------------|--------|---------|
| Class X Concrete | 570.3 | 672.7 | 1243.0 |
| Reinforcement Bars | Lbs. 89,440 | 54,190 | 143,630 |
| Erecting Structural Steel | Lbs. 628,550 | | 628,550 |
| Name Plates | Ea. 1 | | 1 |
| Handrail Concrete | Cu. Yds. 29 | | 29 |
| Seal Coat Concrete | Cu. Yds. 406 | | 406 |
| Furnishing & Erecting Metal Work | Lvs. 1153 | | 1153 |
| Class 'A' Exc. for Struct. | Cu. Yds. 560 | | 560 |
| Class 'B' Exc. for Struct. | Cu. Yds. 610 | | 610 |
| Slope wall (4") | Sq. Yds. 570 | | 570 |

| ITEM | SUPER | SUB | TOTAL |
|---------------------------|---------------|-----|-------|
| 12" Concrete Piles | Lin. Ft. 1910 | | 1910 |
| 18" Concrete Piles | Lin. Ft. 1490 | | 1490 |
| Steel Piles (BBP36) | Lin. Ft. 2108 | | 2108 |
| Test Piles - 12" Concrete | Ea. 2 | | 2 |
| Test Piles (Steel) | Ea. 1 | | 1 |
| Crested Piles | Lin. Ft. 200 | | 200 |
| Removal of Exst. Struct. | Ea. 1 | | 1 |
| Test Piles - 18" Concrete | Ea. 1 | | 1 |

TOTAL BILL OF MATERIAL SECTION 18-R

Furnishing Structural Steel Lbs. 628,550

GENERAL PLAN & ELEVATION
F.A. PROJECT - F-65-7(24)
F.A. PROJECT - SEC. 18-R & 18-F
LA SALLE COUNTY
STATION 25+60

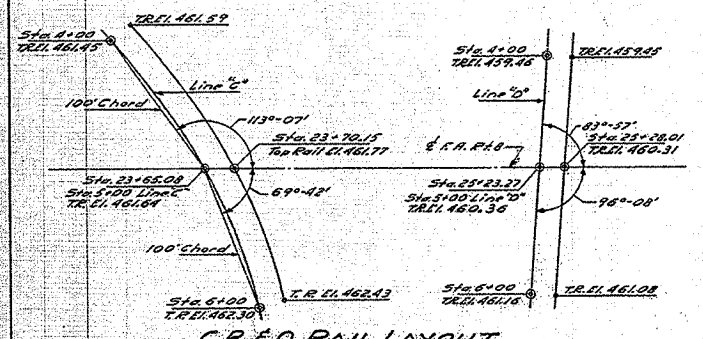

| | | | |
|----------|----------------|----------|-------------------|
| DESIGNED | J. Howard | EXAMINED | May 12 19 59 |
| CHECKED | Robert P. Wood | PASSED | E. J. [Signature] |
| DRAWN | C. W. Kelley | APPROVED | R. P. [Signature] |
| CHECKED | R. P. Wood | | |

PLOT DATE = 9/7/2005
FILE NAME = 6574E
PLOT SCALE = 1/8" = 1'-0"
USER NAME = BUSEN

EXISTING STRUCTURE