

F.A.U. RTE.	SECTION	COUNTY	TOTAL SHEETS	SHEET NO.
5952	G-BR-1	GRUNDY	50	12
STA. TO STA.		ILLINOIS FED. AID PROJECT		
FED. ROAD DIST. NO. 7				

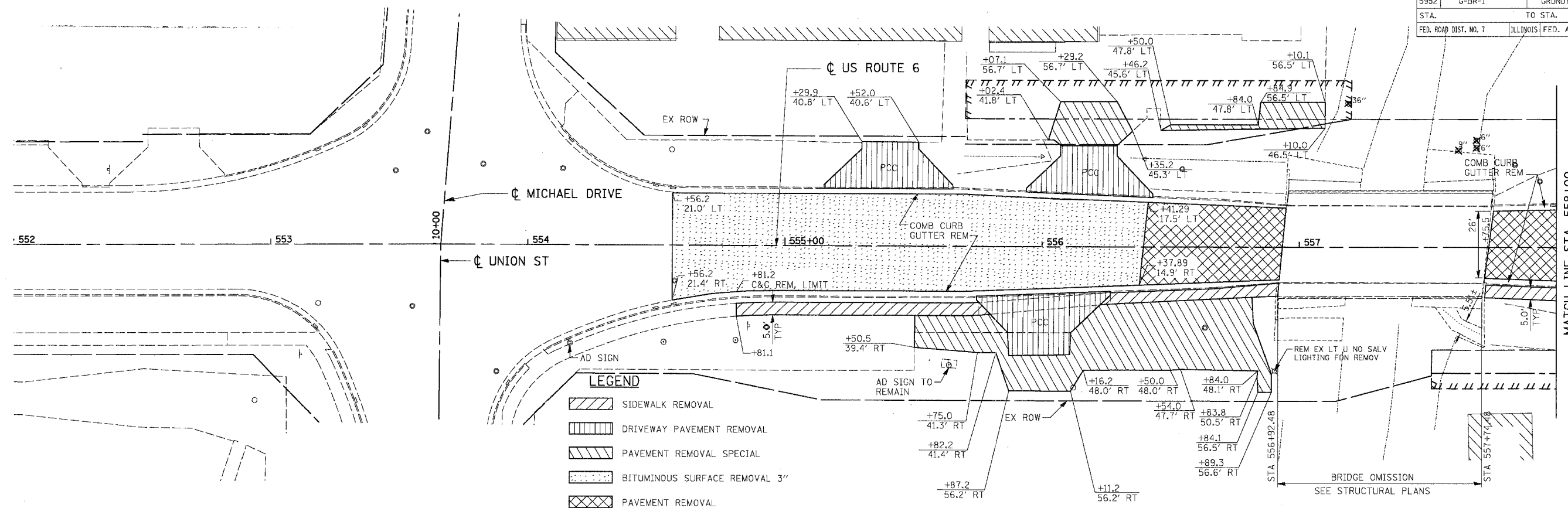

MATCH LINE STA. 558+00

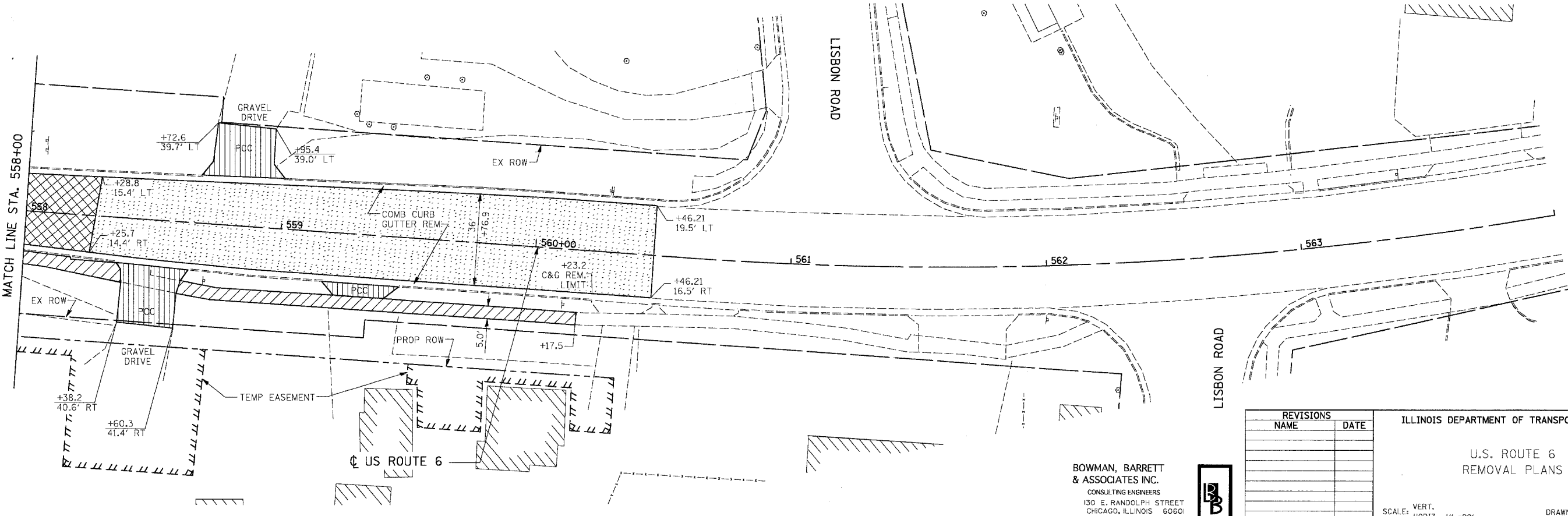

REVISIONS	
NAME	DATE

ILLINOIS DEPARTMENT OF TRANSPORTATION

U.S. ROUTE 6  
REMOVAL PLANS

SCALE: VERT. 1" = 20'  
HORIZ. 1" = 20'  
DATE 10/25/05

DRAWN BY RCR  
CHECKED BY JMD

BOWMAN, BARRETT & ASSOCIATES INC.  
CONSULTING ENGINEERS  
130 E. RANDOLPH STREET  
CHICAGO, ILLINOIS 60601  
JOB NO. 541



10/25/2005 10:05 PM m:\54\road\66563\66563 East For\K\em3\_EF.dgn

default