

F.A.U. RTE.	SECTION	COUNTY	TOTAL SHEETS	SHEET NO.
9992	G-BR-1	GRUNDY	50	20
STA.	TO STA.			
FED. ROAD DIST. NO. 7	ILLINOIS FED. AID PROJECT			

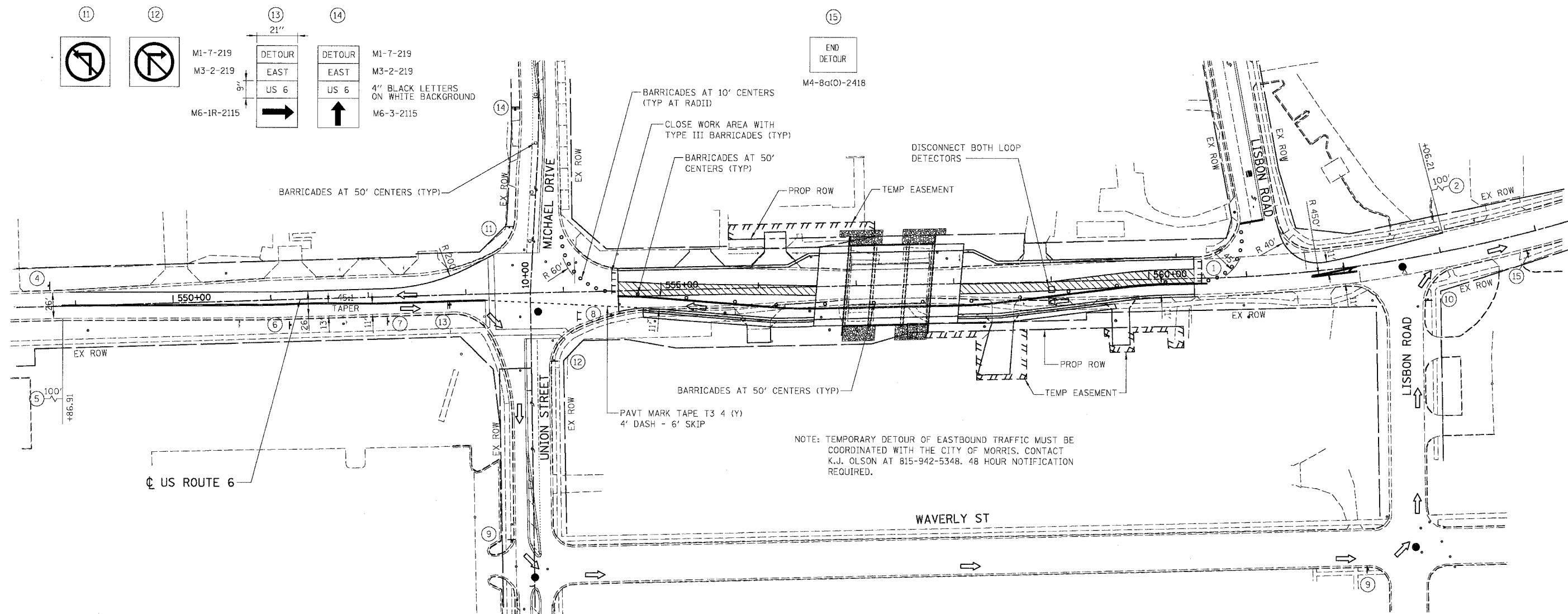
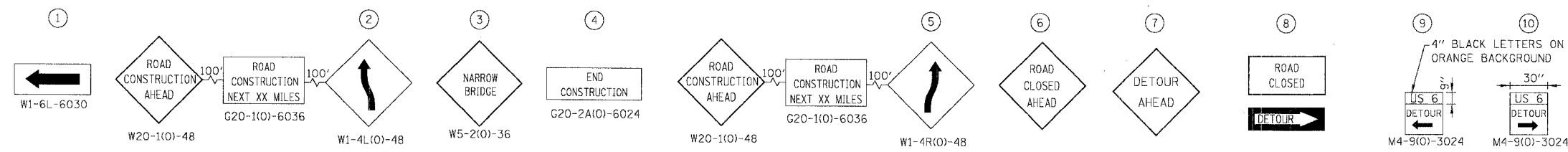

NOTE: TEMPORARY DETOUR OF EASTBOUND TRAFFIC MUST BE COORDINATED WITH THE CITY OF MORRIS. CONTACT K.J. OLSON AT 815-942-5348. 48 HOUR NOTIFICATION REQUIRED.

TRAFFIC SIGNAL WORK

1. WITH ONE WORKING DAY OR LESS, PUT BOTH SIGNALS ON FLASH AND USE FLAGMEN FOR TRAFFIC CONTROL.
2. DISABLE BOTH EASTBOUND FAR LOOP DETECTORS FOR EASTBOUND TRAFFIC AT LISBON ROAD.

- LEGEND:**
- WORK ZONE
 - DRUM OR TYPE II BARRICADE
 - TRAFFIC SIGN
 - TRAFFIC FLOW DIRECTION
 - FLAGGER
 - TYPE III BARRICADE

BOWMAN, BARRETT & ASSOCIATES INC.
 CONSULTING ENGINEERS
 130 E. RANDOLPH STREET
 CHICAGO, ILLINOIS 60601
 JOB NO. 541



REVISIONS	
NAME	DATE

ILLINOIS DEPARTMENT OF TRANSPORTATION

**U.S. ROUTE 6
 MAINTENANCE OF TRAFFIC
 STAGE 2B**

SCALE: VERT. NTS
 HORIZ. 1" = 50'

DATE 10/25/05

DRAWN BY JAM
 CHECKED BY DDM

10/25/2005 09:24:34 PM
 P:\S4\cadd\cadd\66563_East_Fork\51mor2B_EF.dgn