

F.A.P. RTE.	SECTION	COUNTY	TOTAL SHEETS	SHEET NO.
681	113BR-2	LIVINGSTON	47	9
STA.	TO STA.			
FED. ROAD DIST. NO.	ILLINOIS	FED. AID PROJECT		

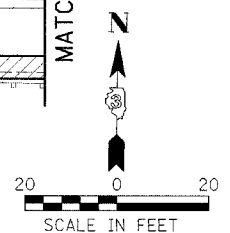

STAGE I PLAN VIEW

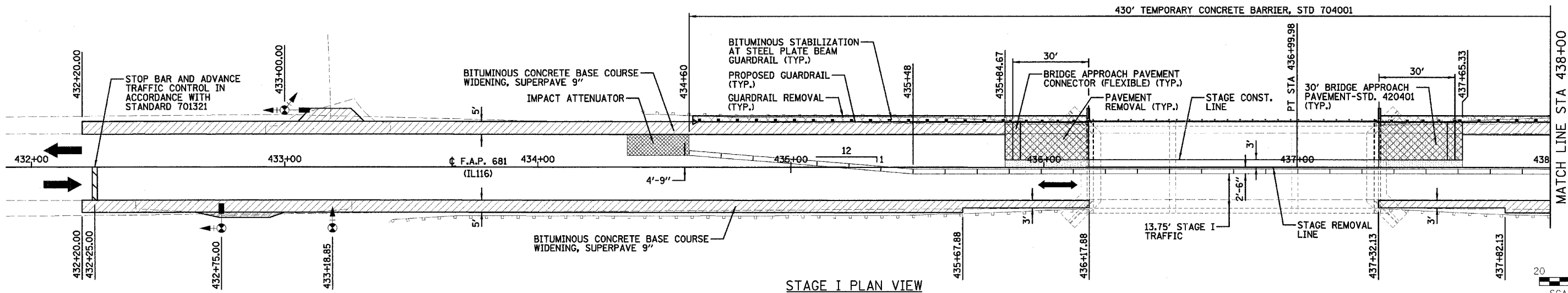
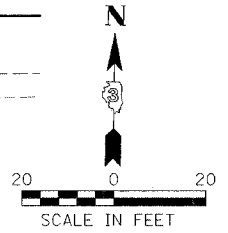
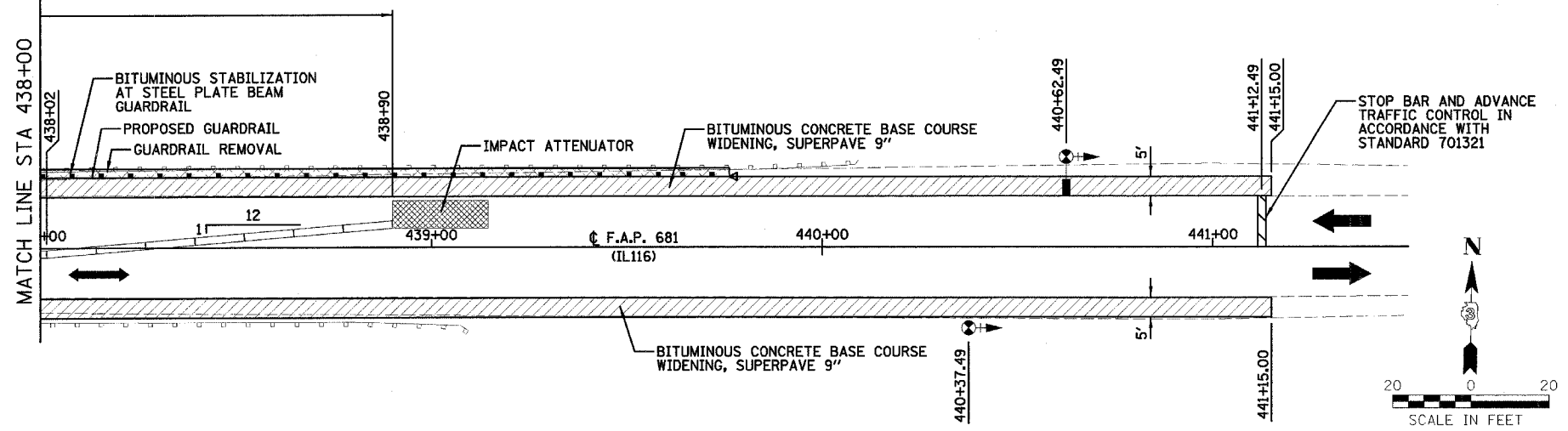

STAGE I PLAN VIEW

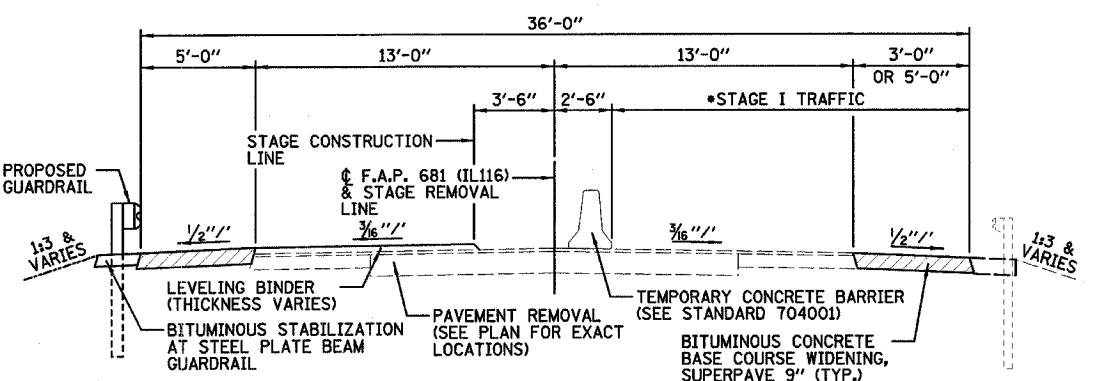

STAGE I ROADWAY TYPICAL SECTION - LOOKING EAST

\*STAGE I TRAFFIC STA. 433+20.00 TO STA. 435+48.29 AND STA. 438+01.63 TO STA. 441+15.00 VARIES FROM 18' TO 13.5'. STAGE I TRAFFIC STA. 435+48.29 TO STA. 438+01.63 IS 13.5'.

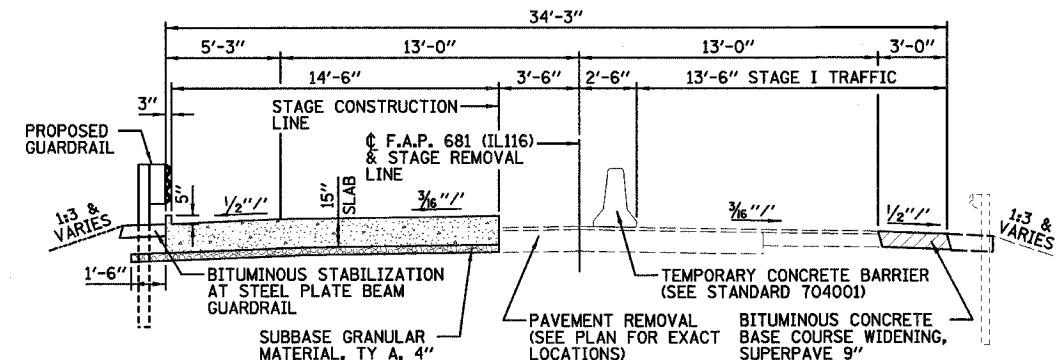

STAGE I BRIDGE APPROACH PAVEMENT TYPICAL SECTION - LOOKING EAST

STA. 435+87.67 TO STA. 436+17.67  
STA. 437+32.33 TO STA. 437+62.33

STAGE I

1. TRAFFIC CONTROL SHALL BE PROVIDED AS SHOWN HEREIN AND IN ACCORDANCE WITH "LANE CLOSURE 2L, 2W BRIDGE REPAIR WITH BARRIER" (STD. 701321). THE COST OF TYPE III BARRICADES AND DRUMS WITH STEADY BURNING LIGHTS SHALL BE INCLUDED WITH TRAFFIC CONTROL STANDARD 701321.
2. REMOVE RIGHT SHOULDER FROM STA. 432+20.00 TO STA. 436+17.88 AND STA. 437+32.13 TO STA. 441+15.00. REPLACE WITH BITUMINOUS CONCRETE BASE COURSE WIDENING, SUPERPAVE 9" AT STATIONS SHOWN ABOVE USING STANDARDS 701011 AND 701326.
3. PROVIDE TEMPORARY BRIDGE TRAFFIC SIGNALS.
4. WIDTH RESTRICTION SIGNING SHALL BE POSTED FOR A MAXIMUM WIDTH OF 10'-9" IN ACCORDANCE WITH THE DETAIL SHOWN ON SHEET 44. ACTUAL LOCATIONS TO BE DETERMINED IN THE FIELD BY THE ENGINEER. SIGNING TO REMAIN IN PLACE UNTIL STAGE II IS COMPLETE.
5. PROVIDE TEMPORARY CONCRETE BARRIER.
6. ACTIVATE TEMPORARY BRIDGE TRAFFIC SIGNALS AND DIVERT TRAFFIC TO THE STAGE I LANE.
7. REMOVE THE PORTION OF THE EXISTING BRIDGE LEFT OF STAGE REMOVAL LINE.
8. REMOVE THE PORTION OF THE EXISTING PAVEMENT REQUIRED TO CONSTRUCT THE BRIDGE, APPROACH PAVEMENTS, AND APPROACH PAVEMENT CONNECTORS.
9. CONSTRUCT THE PORTION OF BRIDGE LEFT OF STAGE CONSTRUCTION LINE.
10. CONSTRUCT THE PORTION OF BRIDGE APPROACH PAVEMENT AND CONNECTOR LEFT OF STAGE CONSTRUCTION LINE.
11. REMOVE LEFT SHOULDER FROM STA. 432+20.00 TO STA. 435+84.67 AND STA. 437+65.33 TO STA. 441+15.00. REPLACE WITH BITUMINOUS CONCRETE BASE COURSE WIDENING, SUPERPAVE 9" AT STATIONS SHOWN ABOVE USING STANDARDS 701011 AND 701326.
12. PROVIDE EMBANKMENT, EXCAVATION, BITUMINOUS STABILIZATION AND GUARDRAIL LEFT OF STAGE CONSTRUCTION LINE.
13. PROVIDE BITUMINOUS SURFACE REMOVAL WITHIN LIMITS INDICATED ON PLANS.
14. PLACE LEVELING BINDER AS SPECIFIED IN ARTICLE 406.18 AT THE ENDS OF NEW BRIDGE APPROACH PAVEMENT AND CONNECTORS PRIOR TO SWITCHING TO STAGE II.

LEGEND

- AGGREGATE SHOULDER REMOVAL (EARTH EXCAVATION) AND BIT. CONCRETE BASE COURSE WIDENING, SUPERPAVE 9"
- BITUMINOUS STABILIZATION
- PAVEMENT REMOVAL
- BRIDGE APPROACH PAVEMENT AND CONNECTOR
- TRAFFIC SIGNAL WITH SIGNAL DIRECTION INDICATED, BACK PLATE & TC-26 MICROWAVE DETECTOR
- TEMPORARY CONCRETE BARRIER

REVISIONS	
NAME	DATE

ILLINOIS DEPARTMENT OF TRANSPORTATION  
STAGE I CONSTRUCTION  
F.A.P. 681 (IL116) OVER FELKY SLOUGH  
SECTION 113BR-2  
LIVINGSTON COUNTY

DATE: 12/09/05

DRAWN BY: JJO  
CHECKED BY: MSW