

STATE OF ILLINOIS
DEPARTMENT OF TRANSPORTATION

F.A.P. RTE.	SECTION	COUNTY	TOTAL SHEETS	SHEET NO.
681	113BR-2	LIVINGSTON	47	40
STA.		TO STA.		
FED. ROAD DIST. NO.		ILLINOIS FED. AID PROJECT		

SHEET NO. B28
OF 31 SHEETS

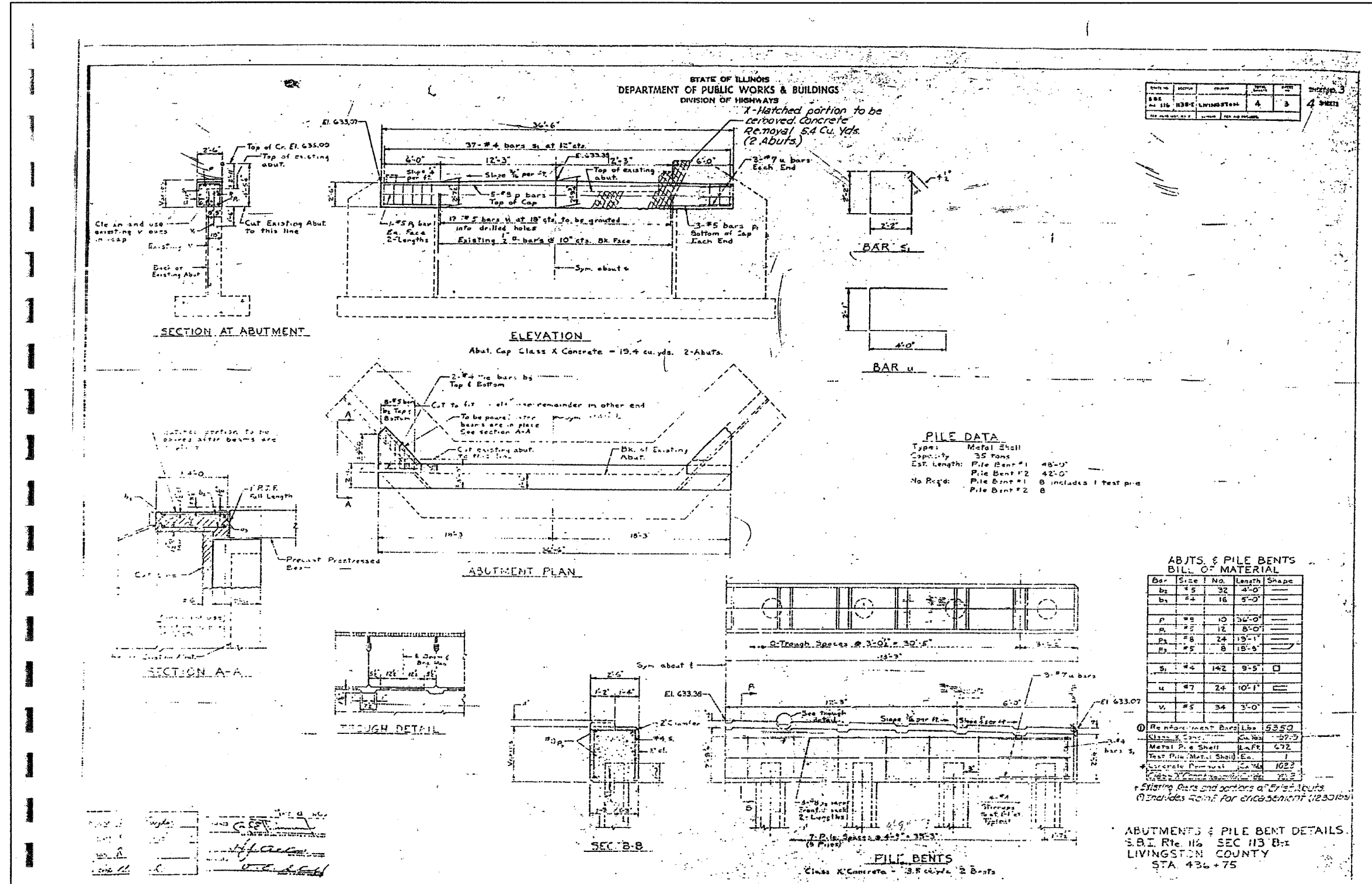

NO.	SECTION	NO. SHEETS	TOTAL SHEETS
116	113BR-2	4	3

PILE DATA

Type:	Metal Shell
Capacity:	35 tons
Est. Length:	Pile Bent #1 48'-0"
	Pile Bent #2 42'-0"
No. Piles:	Pile Bent #1 8 includes 1 test pile
	Pile Bent #2 8

ABUTS. & PILE BENTS BILL OF MATERIAL

Bar	Size	No.	Length	Shape
b2	#5	32	4'-0"	—
b1	#4	18	5'-0"	—
p	#8	10	36'-0"	—
a	#5	12	8'-0"	—
p2	#8	24	19'-1"	—
E3	#5	8	18'-5"	—
s	#2	142	9'-5"	□
u	#7	24	10'-1"	—
v	#5	34	3'-0"	—

Reinforcement Bars	Lbs	5350
Class X Concrete	Cu. Yds	22.2
Metal Pile Shell	Lbs	672
Test Pile Metal Shell	Lbs	1
Concrete Removal	Cu. Yds	10.2

ABUTMENTS & PILE BENT DETAILS
S.B.I. Rte. 116 SEC 113 B-1
LIVINGSTON COUNTY
STA. 436+75

FOR INFORMATIONAL
USE ONLY
(1965 PLANS)

REVISIONS		ILLINOIS DEPARTMENT OF TRANSPORTATION EXISTING PLANS F.A.P. 681 (IL116) OVER FELKY SLOUGH SECTION 113BR-2 LIVINGSTON COUNTY STATION 436+75.00 STRUCTURE NO. 053-0075 DESIGNED BY: JML DATE: 12/09/05
NAME	DATE	
		DRAWN BY: DJM CHECKED BY: MSW