

F.A.P. RTE.	SECTION	COUNTY	TOTAL SHEETS	SHEET NO.
68	105 BR-1	LIVINGSTON	45	1
STA.		TO STA.		
FED. ROAD DIST. NO.		ILLINOIS	FED. AID PROJECT	

STATE OF ILLINOIS
DEPARTMENT OF TRANSPORTATION

DIVISION OF HIGHWAYS
**PROPOSED
HIGHWAY PLANS**

FAP ROUTE 68 (IL RTE. 23)
SECTION 105 BR-1
PROJECT BHF-0068(097)
LIVINGSTON COUNTY

C - 93 - 072 - 05
BRIDGE SUPERSTRUCTURE REPLACEMENT

INDEX OF SHEETS

SHEET NO.	DESCRIPTION
1.	COVER SHEET, INDEX OF SHEETS AND STANDARDS
2.	GENERAL NOTES
3.	SUMMARY OF QUANTITIES
4.	TYPICAL SECTIONS
5.	SCHEDULE OF QUANTITIES
6. - 9.	PLAN AND PROFILE SHEETS
10. - 11.	STAGING PLANS
12. - 25.	BRIDGE PLANS
26. - 32.	EXISTING BRIDGE PLANS (FOR INFORMATION ONLY)
33.	DETAIL
34. - 45.	CROSS SECTIONS

STATE STANDARDS

00001-04	STANDARD SYMBOLS, ABBREVIATIONS AND PATTERNS
001001	AREAS OF REINFORCEMENT REBARS
001006	DECIMAL OF AN INCH AND OF A FOOT
515001-02	NAME PLATE FOR BRIDGES
630001-05	STEEL PLATE BEAM GUARDRAIL
631032-01	TRAFFIC BARRIER TERMINAL, TYPE 6A
635006-02	REFLECTOR AND TERMINAL MARKER PLACEMENT
635011-01	REFLECTOR MARKER AND MOUNTING DETAILS
701006-02	OFF-RD. OPERATIONS 2L, 2W 4.5 m (15') TO PAVEMENT EDGE FOR SPEEDS ≥ 45 MPH
701201-02	LANE CLOSURE, 2L, 2W, DAY ONLY ON-RD. TO 600 mm (24") FOR SPEEDS ≥ 45 MPH
701301-02	LANE CLOSURE 2L, 2W SHORT TERM OPERATIONS
701306-01	LANE CLOSURE 2L, 2W SLOW MOVING OPERATIONS - DAY ONLY FOR SPEEDS ≥ 45 MPH
701311-02	LANE CLOSURE 2L, 2W MOVING OPERATIONS - DAY ONLY
701321-08	LANE CLOSURE 2L, 2W BRIDGE REPAIR WITH BARRIER
701326-02	LANE CLOSURE 2L, 2W PAVEMENT WIDENING FOR SPEEDS ≥ 45 MPH
702001-05	TRAFFIC CONTROL DEVICES
704001-02	TEMPORARY CONCRETE BARRIER
780001-01	TYPICAL PAVEMENT MARKINGS
781001-02	TYPICAL APPLICATIONS RAISED REFLECTIVE PAVEMENT MARKERS

MICROFILMED _____
REEL NUMBER _____
AWARDED _____
RESIDENT ENGINEER _____
AS BUILT CHANGES WERE MADE
ON THE FOLLOWING SHEETS _____

J.U.L.I.E.
JOINT UTILITY LOCATION INFORMATION FOR EXCAVATION
1-800-892-0123

DISTRICT 3 NO. (815) 434-6131
PROJECT ENGINEER: DAN DRAPER
UNIT CHIEF: PAT BRABOY
TOWNSHIP: PONTIAC

SEC. 105 BR-1
CONSISTS OF REMOVING THE EXISTING STRUCTURE'S SUPERSTRUCTURE (SN 053-0148) AT STA. 586+62.00 AND REPLACE WITH PRECAST PRESTRESSED CONCRETE DECK BEAM (21" DEPTH) AND PORTLAND CEMENT CONCRETE WEARING SURFACE 5" AND RELATED ROADWAY WORK.

PONTIAC TOWNSHIP, SECTIONS 3 & 4

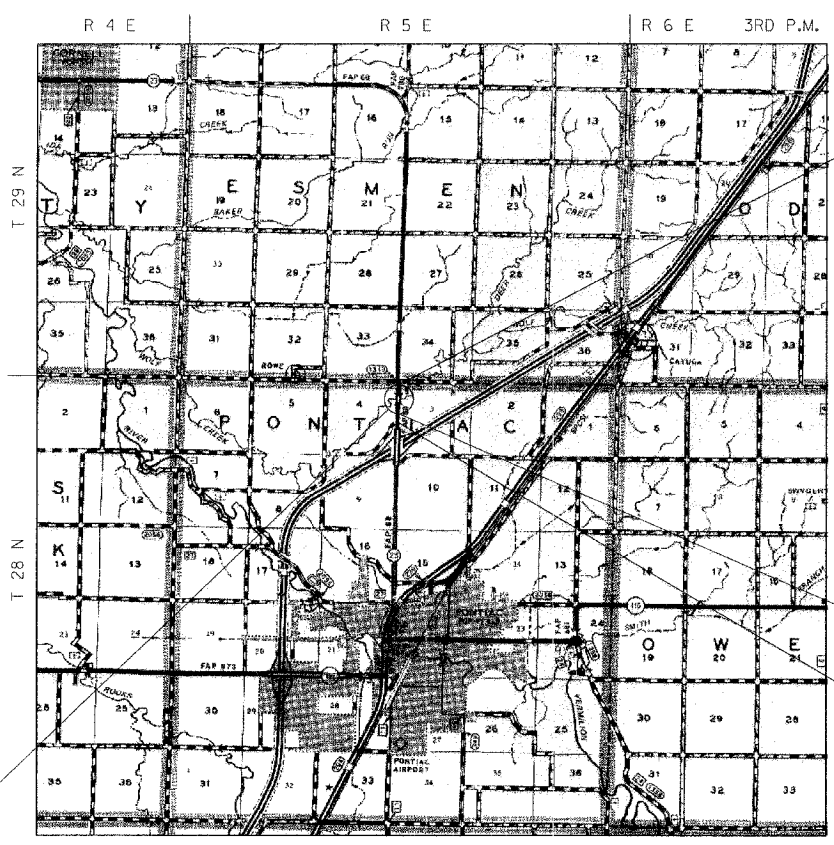

NOT TO SCALE
LOCATION MAP

NET LENGTH OF PROJECT = 440.00 FEET = 0.083 MILES
GROSS LENGTH OF PROJECT = 440.00 FEET = 0.083 MILES

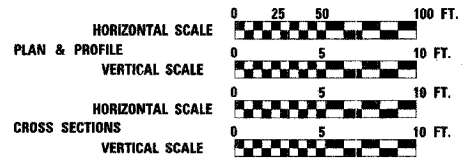

PROJECT ENDS
STA. 589+00.00

PROJECT BEGINS
STA. 584+60.00

STATION EQUATION
STA. 583+68.92 BK =
STA. 583+70.51 AH

D-93-049-05



DESIGN DESIGNATION: MINOR ARTERIAL 2005ADT = 5200

STATE OF ILLINOIS
DEPARTMENT OF TRANSPORTATION
DIVISION OF HIGHWAYS

SUBMITTED 20

James P. M...
DEPUTY DIRECTOR OF HIGHWAYS, REGION ENGINEER
February 3, 20 06

Mike Stone
ENGINEER OF DESIGN AND ENVIRONMENT
February 3, 20 06

Milton R. Sosa, P.E./D
DIRECTOR OF HIGHWAYS, CHIEF ENGINEER

**PRINTED BY THE AUTHORITY
OF THE STATE OF ILLINOIS**



Will-C. Best 12/21/05
EXPIRES: 11/30/2007

REVISIONS	
NAME	DATE

**DISTRICT 3
OTTAWA, IL
PLANS PREPARED BY:**

GREENE & BRADFORD, INC.
REGISTERED PROFESSIONAL ENGINEERS
1207 N. 8TH ST., SUITE 200, CHICAGO, ILLINOIS 60642-1000

COMPUTER FILE NO.
03236.W011.COV.DGN
PROJECT 03236 W011
11/15/05 - MDS

PLOT DATE = 12/15/2005
FILE NAME = J:\03236\w011\drwg\p03236_w011_cov.dgn
REFERENCE = REF: 000006 / IN:
OPERATOR = mschall@