

F.A.P. RTE.	SECTION	COUNTY	TOTAL SHEETS	SHEET NO.
68	105 BR-1	LIVINGSTON	45	7
STA. 582+00.00 TO STA. 588+00.00				
FED. ROAD DIST. NO. ILLINOIS FED. AID PROJECT				

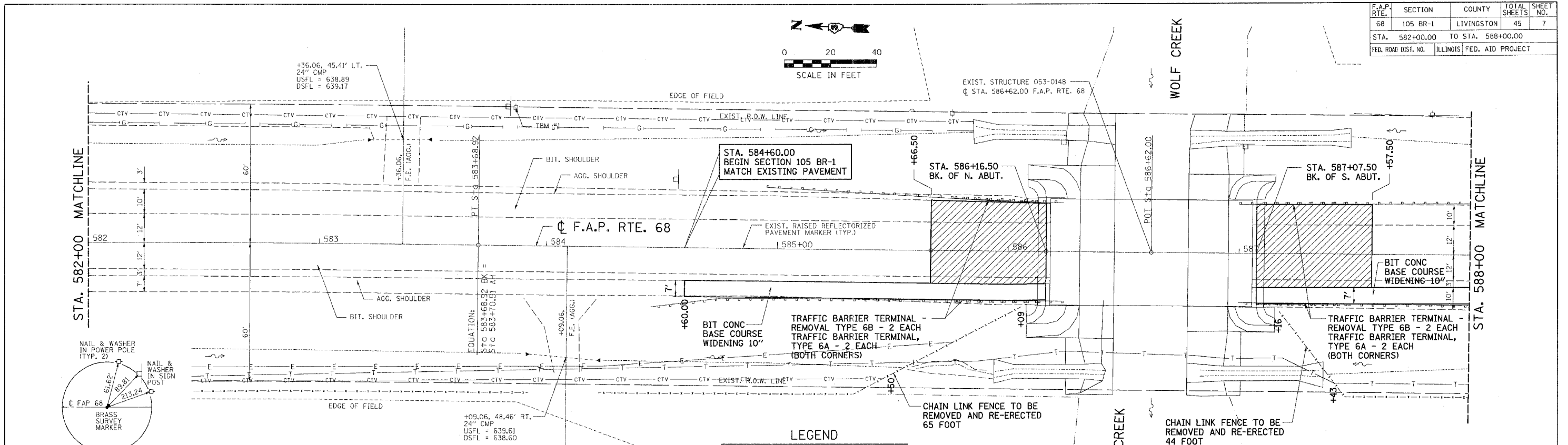

PLAN	DATE
NO.	
BY	
DATE	
NO.	
BY	
DATE	

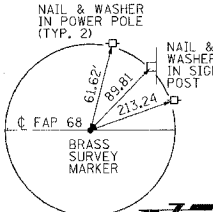

P.T. STA. 583+68.92 B.K. =
STA. 583+70.51 AH

T.B.M. #1 ELEV. 641.31'
RR SPIKE IN WEST
SIDE OF POWER POLE.
STA. 583+84, 59' LT.

LEGEND
 BITUMINOUS SURFACE REMOVAL (VARIABLE DEPTH)

B.M. #100 ELEV. 646.55'
CHISELED "□" ON S.W. CORNER
OF PARAPET S.N. 053-0148

REVISION	DATE	BY

GREENE & BRADFORD, INC.
 OF SPRINGFIELD
 REGISTERED PROFESSIONAL ENGINEERS
 LICENSE NO. 0001-0000-0000-0000
 PROFESSIONAL ENGINEER FROM THE STATE OF ILLINOIS
 LICENSE NO. 0001-0000-0000-0000

COMPUTER FILE NO.
03236.W011.PP-2
PROJECT 03236 W11
12/20/05 - MML

PROFILE	DATE
NO.	
BY	
DATE	
NO.	
BY	
DATE	

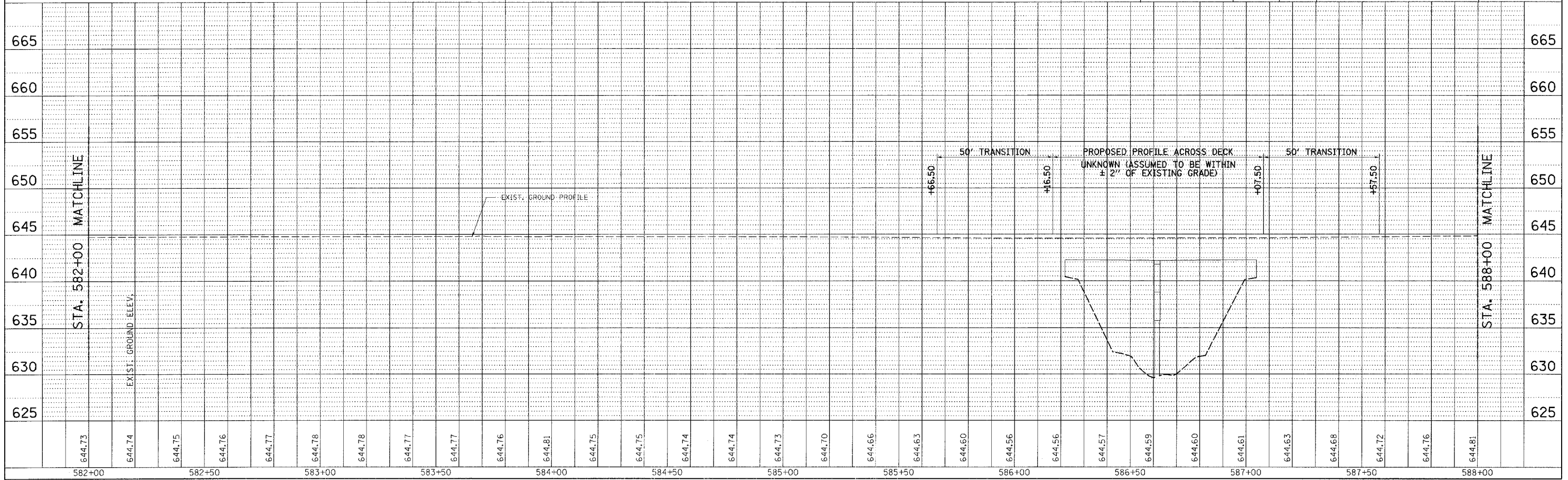

PLOT DATE = 12/21/2005
 FILE NAME = J:\03236\W011\Drawings\03236.W011.PP.dgn
 PLOT SCALE = 28.000000 / IN.
 REFERENCE = .REF.
 OPERATOR = michael

F.A.P. RTE. 68 PLAN AND PROFILE - PROPOSED STRUCTURE REPLACEMENT