

SECTION 24, T30N, R3E, 3RD P.M.

FAP RTE	SECTION	COUNTY	TOTAL SHEETS	SHEET NO.
68	101BR	LIVINGSTON	47	6
STA. 271+00		TO STA. 277+00		
FED. ROAD DIST. NO.		ILLINOIS FED. AID PROJECT		

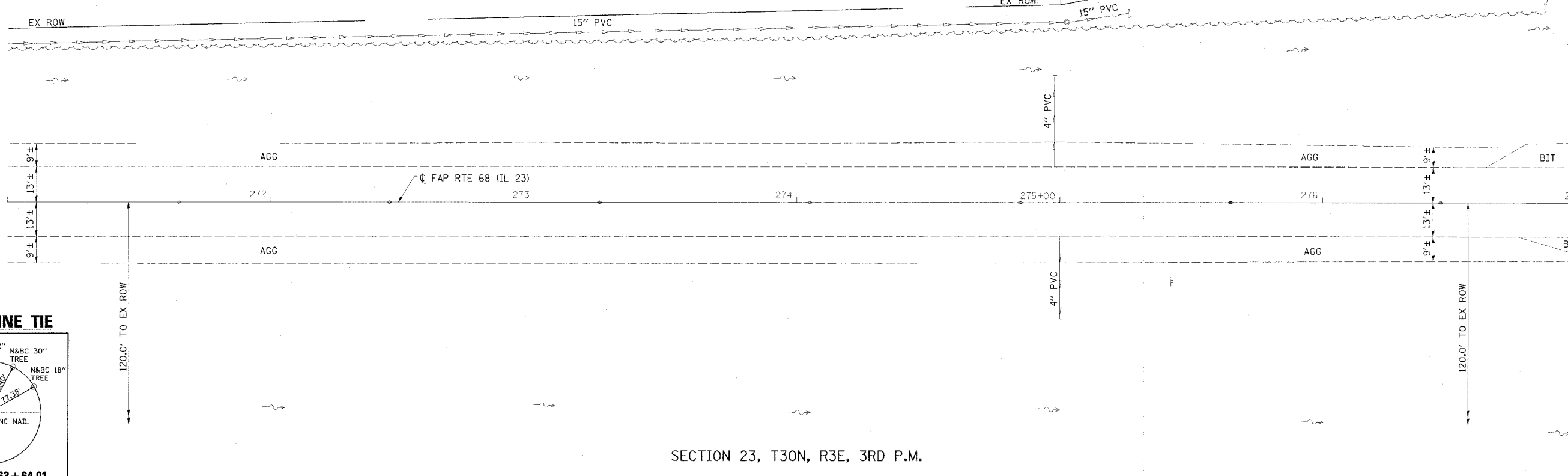
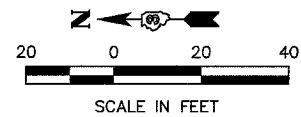

MATCH LINE - STA 277+00

SECTION 23, T30N, R3E, 3RD P.M.

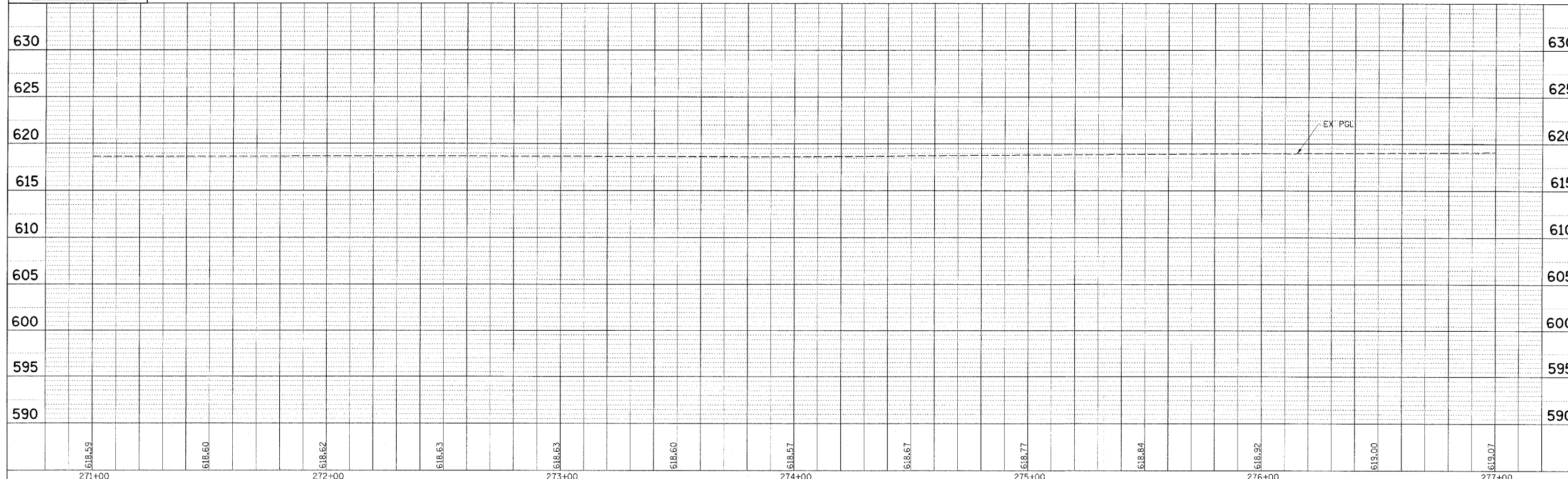

PLAN
DATE: _____ BY: _____
DRAWN BY: _____
CHECKED BY: _____
DATE: _____

PROFILE
DATE: _____ BY: _____
DRAWN BY: _____
CHECKED BY: _____
DATE: _____