

FAI RTE	SECTION	COUNTY	TOTAL SHEETS	SHEET NO.
80	(50-5,6)I	LASALLE	9	1
DISTRICT 3	ILLINOIS	PROJECT		

INDEX OF SHEETS

- 1 COVER SHEET
- 2 GENERAL NOTES AND STANDARDS
- 3 SUMMARY OF QUANTITIES
- 4 TYPICAL SECTIONS
- 5 SCHEDULE OF QUANTITIES
- 6 PROJECT LAYOUT
- 7-9 DETAILS

STATE OF ILLINOIS DEPARTMENT OF TRANSPORTATION DIVISION OF HIGHWAYS PLANS FOR PROPOSED FEDERAL AID HIGHWAY

F.A.I. ROUTE 80 (I-80)

SECTION (50-5,6)I

PROJECT IM-080-3(122) 094

LASALLE COUNTY

C-93-023-06

INTERMITTENT MILLING & RESURFACING

STANDARDS

- 000001-04 STANDARD SYMBOLS, ABBREVIATIONS AND PATTERNS
- 001006 DECIMAL OF AN INCH AND OF A FOOT
- 631011-02 TRAFFIC BARRIER TERMINAL, TYPE 2
- 631026-02 TRAFFIC BARRIER TERMINAL, TYPE 5 & 5A
- 631033-01 TRAFFIC BARRIER TERMINAL, TYPE 6B
- 701400-02 APPROACH TO LANE CLOSURE, FREEWAY / EXPRESSWAY
- 701401-03 LANE CLOSURE, FREEWAY/EXPRESSWAY
- 701426-02 LANE CLOSURE, MULTILANE INTERMITTENT OR MOVING OPERATION, FOR SPEEDS P 45 MPH
- 702001-05 TRAFFIC CONTROL DEVICES
- 780001-01 TYPICAL PAVEMENT MARKINGS

FULL SIZE PLANS HAVE BEEN PREPARED USING STANDARD ENGINEERING SCALES, REDUCED SIZE PLANS WILL NOT CONFORM TO STANDARD SCALES, IN MAKING MEASUREMENTS ON REDUCED PLANS, THE ABOVE SCALES MAY BE USED.

MICROFILMED _____
 REEL NUMBER _____
 AWARDED _____
 RESIDENT ENGINEER _____
 AS BUILT CHANGES WERE MADE
 ON THE FOLLOWING SHEETS _____

JULIE 1-800-892-0123

DISTRICT 3 NO. (815) 434-6131

PROJECT ENGINEER: DAN DRAPER
 UNIT CHIEF: MICHELE LINDEMANN
 TOWNSHIP: RUTLAND, MILLER

CONTRACT NO. 66620

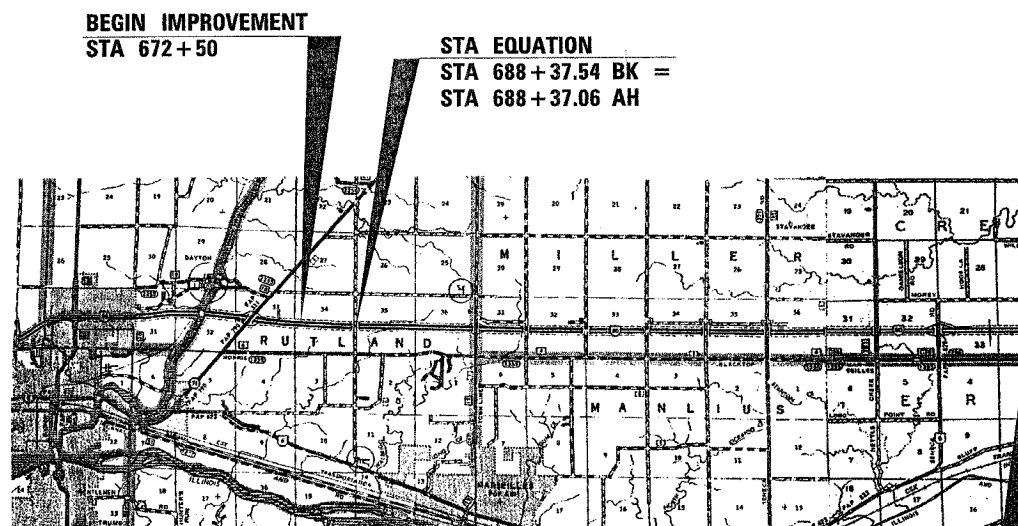

LOCATION MAP

NOT TO SCALE

NET LENGTH = 19,600.48 FT = 3.712 MILES
 GROSS LENGTH = 47,850.48 FT = 9.063 MILES

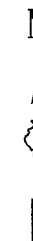
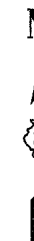

D-93-018-06

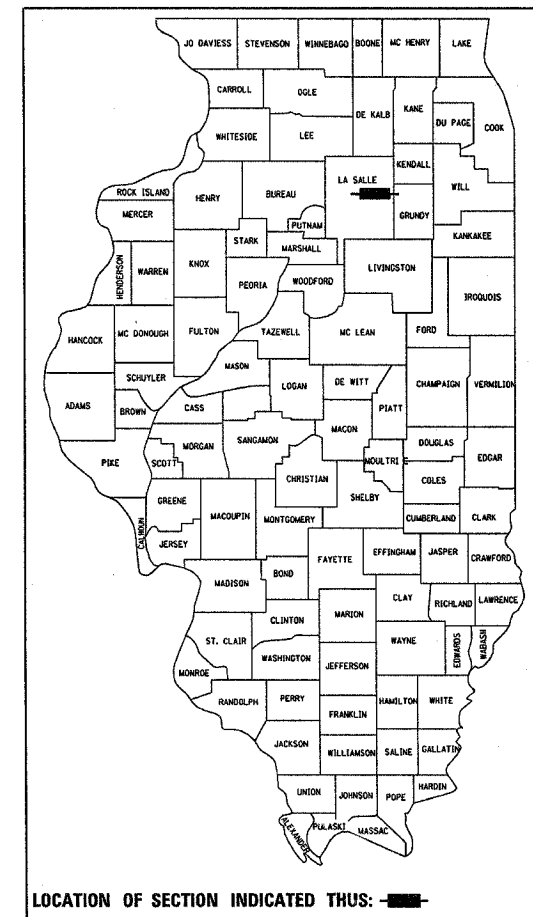

FUNCTIONAL CLASSIFICATION - INTERSTATE
 2006 ADT = 28,800
 P.V. = 61.3%
 S.U. = 6.1%
 M.U. = 32.6%

STATE OF ILLINOIS
 DEPARTMENT OF TRANSPORTATION
 DIVISION OF HIGHWAYS

SUBMITTED Dec 15 2005

Gregory Marts
 DEPUTY DIRECTOR OF HIGHWAYS, REGION ENGINEER

February 3, 20 06
Mike Hine
 ENGINEER OF DESIGN AND ENVIRONMENT

February 3, 20 06
Milton R. Seer P.E.
 DIRECTOR OF HIGHWAYS, CHIEF ENGINEER

PRINTED BY THE AUTHORITY
 OF THE STATE OF ILLINOIS