

F.A.P. RTE.	SECTION	COUNTY	TOTAL SHEETS	SHEET NO.
824	19MRS	COLES	13	1

CONTRACT NO. 70484

STATE OF ILLINOIS
 DEPARTMENT OF TRANSPORTATION
 DIVISION OF HIGHWAYS
**PROPOSED
 HIGHWAY PLANS**
 FAP ROUTE 824 (US 45)
 SECTION 19MRS
 COLES COUNTY

FOR INDEX OF SHEETS, SEE SHEET NO. 2
 FOR SUMMARY OF QUANTITIES, SEE SHEET NO. 4

C-95-006-06

RESURFACING ON DEWITT AVENUE FROM 20TH STREET
 TO EAST OF 18TH STREET IN MATTOON

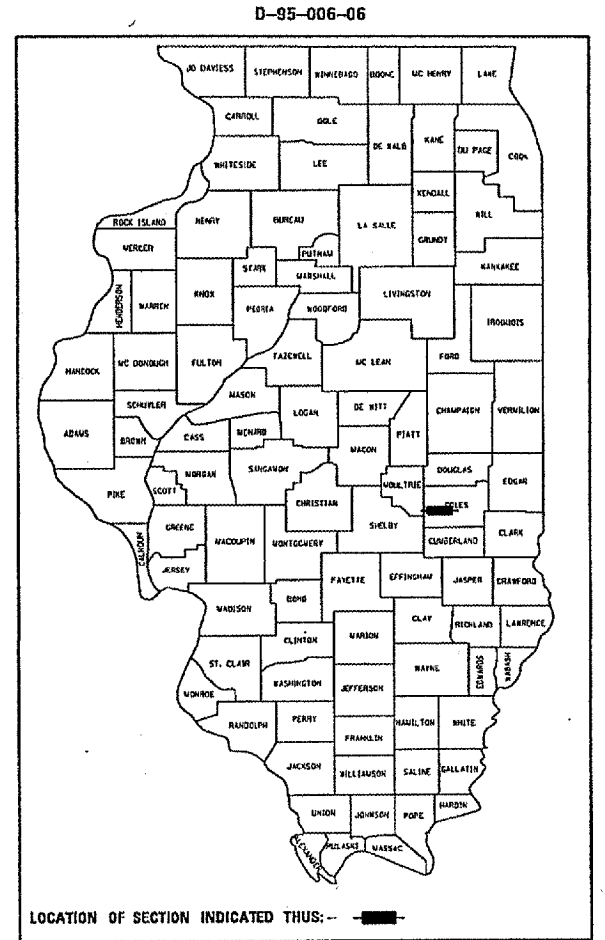

LOCATION OF SECTION INDICATED THIS: —■—

FOR UNDERGROUND UTILITY
 LOCATIONS CALL
 TOLL FREE J.U.L.I.E. TELEPHONE NO.
 1-800-692-0123

SECTION 19MRS
 BEGIN STATION 103+03.00

SECTION 19MRS
 END STATION 111+44.87

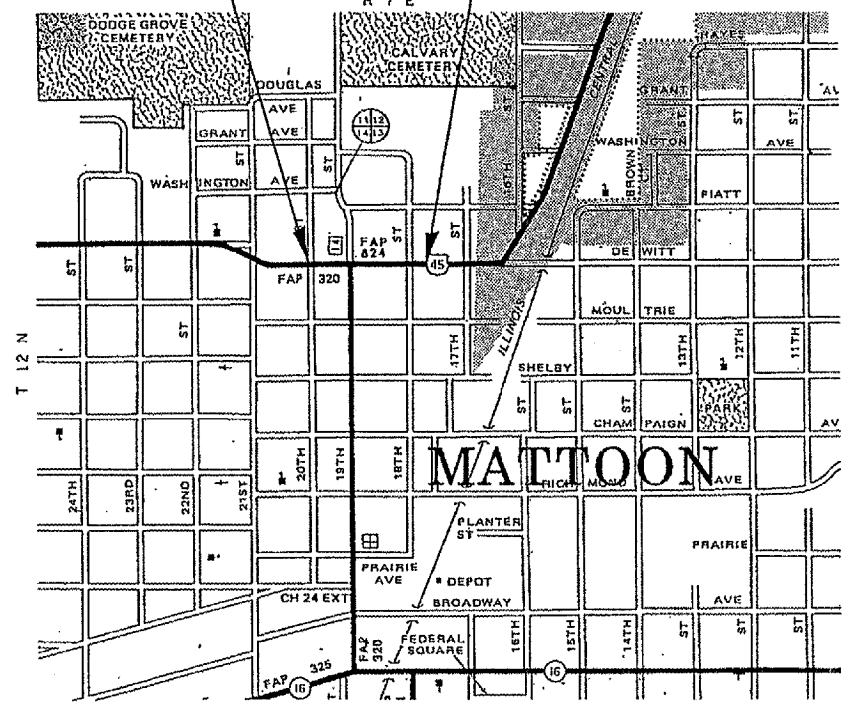

CURRENT ADT:
 ADT = 10,500 (2005)

DESIGN DESIGNATION
 OTHER PRINCIPAL ARTERIAL

STATE OF ILLINOIS
 DEPARTMENT OF TRANSPORTATION
 DIVISION OF HIGHWAYS

SUBMITTED *1/28/06* 2005
[Signature]
 DEPUTY DIRECTOR OF HIGHWAYS, REGION THREE ENGINEER

February 3, 2006
[Signature]
 ENGINEER OF DESIGN AND ENVIRONMENT

February 3, 2006
[Signature]
 DIRECTOR OF HIGHWAYS, CHIEF ENGINEER

**PRINTED BY THE AUTHORITY
 OF THE STATE OF ILLINOIS**

TOTAL LENGTH OF SECTION & PROJECT = 841.87 FEET = 0.159 MILES
 NET LENGTH OF SECTION & PROJECT = 841.87 FEET = 0.159 MILES

CONTRACT NO. 70484

FAP ROUTE 824 (US 45) SECTION 19MRS COLES COUNTY

PLOT DATE = 12/27/2005
 FILE NAME = c:\projects\70484\cover\606.dgn
 PLOT SCALE = 1/8"=1'-0"
 USER NAME = philipj

PROJECT ENGINEER: TIM BRANDENBURG (217)465-4181
 SQUAD LEADER: MICHAEL LEROY
 DESIGNER: MICHAEL LEROY

F.A.P. RTE.	SECTION	COUNTY	TOTAL SHEETS	SHEET NO.
824	19MRS	COLES	13	2

INDEX OF SHEETS

1	COVER SHEET
2	INDEX OF SHEETS/HIGHWAY STANDARDS
3	GENERAL NOTES
4	SCHEDULES OF QUANTITIES
5	SUMMARY OF QUANTITIES
6	EXISTING TYPICAL CROSS SECTIONS
7	PROPOSED TYPICAL CROSS SECTIONS
8	PAVEMENT MARKING DETAILS
9	DETECTOR LOOP LOCATIONS
10	TYPICAL APPLICATION OF TRAFFIC CONTROL DEVICES FOR SIDE STREET CLOSURE
11-13	TYPICAL APPLICATIONS OF PAVEMENT MARKINGS

HIGHWAY STANDARDS

000001-04	ABBREVIATIONS AND SYMBOLS
001006	DECIMAL OF AN INCH AND A FOOT
701426-02	LANE CLOSURE, MULTILANE, INTERMITTENT OR MOVING OPERATIONS FOR SPEEDS \geq 45 MPH
701502-01	URBAN LANE CLOSURE, MULTILANE, 2W WITH BIDIRECTIONAL TURN LANE
701701-04	URBAN LANE CLOSURE, MULTILANE INTERSECTION
702001-05	TRAFFIC CONTROL DEVICES
780001-01	TYPICAL PAVEMENT MARKINGS
781001-02	TYPICAL APPLICATIONS RAISED REFLECTIVE PAVEMENT MARKERS
886001	DETECTOR LOOP INSTALLATIONS
886006	TYPICAL LAYOUT FOR DETECTION LOOPS

F.P.P. RTE.	SECTION	COUNTY	TOTAL SHEETS	SHEET NO.
824	19MRS	COLES	13	3

GENERAL NOTES

G. N. -100
 ENGLISH UNITS OF MEASUREMENT SHALL GOVERN OVER AND SUPERSEDE ANY METRIC UNITS SHOWN
 IN THIS CONTRACT. WHERE INCLUDED, METRIC UNITS ARE FOR INFORMATION ONLY.

G. N. -1004.01
 COARSE AGGREGATE GRADATION CA-10 MAY BE USED WHENEVER COARSE AGGREGATE CA-6 IS SPECIFIED
 IN THE STANDARD SPECIFICATIONS.

G. N. -1004.03
 REVISE ARTICLE 1004.03 (c) NOTE 5/ OF THE STANDARD SPECIFICATIONS TO READ:
 ' 5/ GRADATION CA-16 SHALL BE USED IN LIEU OF CA-13 WHEN THE SURFACE COURSE IS
 LESS THAN 1 3/4 INCHES IN THICKNESS. CA-13 OR CA-16 MAY BE USED WHEN THE SURFACE COURSE
 IS 1 3/4 INCHES OR MORE IN THICKNESS.'

G. N. -406H
 MIXTURE REQUIREMENTS

The following mixture requirements are applicable for this project:

Location	Dewitt Ave.
Mixture Use	Surface
AC/PG	SBS PG 70-22
RAP % (Max)	0
Design Air Voids	4.0% @ Ndes=90
Mix Comp(Gradation)	IL 9.5
Friction Aggregate	Mix D

G. N. -703A
 SHORT TERM PAVEMENT MARKING SHALL BE APPLIED TO THE PAVEMENT AFTER ANY OF THE
 FOLLOWING: COLD MILLING AND/OR PLACING BITUMINOUS MATERIALS (PRIME COAT), LEVELING
 BINDER (MACHINE METHOD), BINDER AND SURFACE COURSES. SHORT TERM PAVEMENT MARKING
 PLACED ON THE SURFACE, SHALL COINCIDE WITH THE FINAL PAVEMENT STRIPING. SHORT TERM
 PAVEMENT MARKING PLACED PRIOR TO THE SURFACE SHALL COINCIDE WITH THE EXISTING PAVEMENT
 MARKINGS. USE 4 FEET PER 40 FEET (OR 10% PER STATION).

G. N. -781
 RAISED REFLECTIVE PAVEMENT MARKERS SHALL BE PLACED IN ACCORDANCE WITH STANDARD 781001,
 AND THE DETAILS SHOWN IN THE PLANS. IF THERE IS ANY DISCREPENCY BETWEEN THE STANDARD
 AND THE DETAILS IN THE PLANS, THE DETAILS IN THE PLANS SHALL GOVERN. THE FINAL PAVEMENT
 MARKINGS SHALL BE IN PLACE PRIOR TO PLACING THE RAISED REFLECTIVE PAVEMENT MARKERS AND
 THE RAISED REFLECTIVE PAVEMENT MARKERS SHALL BE PLACED MIDWAY IN THE 30 FOOT (9 m) SPACE
 BETWEEN THE DASHED CENTERLINE STRIPES (WHEN APPLICABLE).

F.A.P. RTE.	SECTION	COUNTY	TOTAL SHEETS	SHEET NO.
824	19MRS	COLES	13	4

SCHEDULES OF QUANTITIES

MANHOLE TO BE ADJUSTED

DEWITT AVE: STATION/OFFSET	EACH
106+09, 5 FEET RT	1
106+17, 31 FEET RT	1
110+36, 2 FEET RT	1
110+50, 19 FEET LT	1
TOTAL	4

AS DIRECTED BY THE ENGINEER

WATER VALVE TO BE ADJUSTED

STATION/OFFSET	EACH
106+00, 21 FEET LT	1
106+45, 24 FEET RT	1
TOTAL	2

AS DIRECTED BY THE ENGINEER

INLET TO BE ADJUSTED

STATION/OFFSET	EACH
109+87, 23 FEET LT	1
110+61, 23 FEET RT	1
TOTAL	2

AS DIRECTED BY THE ENGINEER

COLD MILLING SPECIAL

DEWITT AVE:				
STATION	TO	STATION	OFFSET	FOOT
103+03		106+46	21.5' LT	343.0
103+03		106+46	23' RT	343.0
106+46		111+45	23' RT	499.0
106+46		111+45	23' RT	0.0
TOTAL				1,185.0

AS DIRECTED BY THE ENGINEER

THERMOPLASTIC PAVEMENT MARKINGS, LINE 6"

STATION	TO	STATION	FOOT
RT 106+02 (CROSSWALK)		RT 106+80	137.0
LT 106+13 (CROSSWALK)		LT 106+71	116.0
LT 106+71 (CROSSWALK)		RT 106+92	114.0
RT 106+02 (CROSSWALK)		LT 106+13	116.0
TOTAL			483.0

THERMOPLASTIC PAVEMENT MARKINGS, LINE 24"

STATION	FOOT
DEWITT AVE:	
106+94 (STOP BAR)	23.0
105+89 (STOP BAR)	23.0
19TH STREET:	
1750+40 (STOP BAR)	23.0
1749+50 (STOP BAR)	33.5
TOTAL	102.0

THERMOPLASTIC PAVEMENT MARKINGS, LETTERS AND SYMBOLS

STATION	SO. FT.
109+54 (RIGHT TURN, URBAN, SMALL)	8.8
108+47 (RIGHT TURN, URBAN, SMALL)	8.8
107+94 (RIGHT TURN, URBAN, SMALL)	8.8
107+17 (RIGHT TURN, URBAN, SMALL)	8.8
105+56 (LEFT TURN, BI-DIRECTIONAL)	17.6
104+36 (LEFT TURN, BI-DIRECTIONAL)	17.6
109+54 (LEFT TURN/THROUGH, URBAN, SMALL)	14.7
108+47 (LEFT TURN/THROUGH, URBAN, SMALL)	14.7
107+94 (LEFT TURN/THROUGH, URBAN, SMALL)	14.7
107+17 (LEFT TURN/THROUGH, URBAN, SMALL)	14.7
TOTAL	130.0

TEMPORARY RAMPS

STATION	SO. YD.
111+50	26.0
110+27 LT (18TH STREET, NORTH)	25.0
110+27 RT (18TH STREET, SOUTH)	25.0
106+46 LT (19TH STREET, NORTH)	22.0
106+46 LT (19TH STREET, SOUTH)	36.0
103+76 LT (20TH STREET, NORTH)	25.0
103+76 RT (20TH STREET, SOUTH)	25.0
103+03	25.0
TOTAL	209.0

DETECTOR LOOPS

LOCATION	FOOT
DEWITT AVE:	
EAST	142.0
WEST	156.0
19TH STREET:	
NORTH	156.0
SOUTH	439.0
TOTAL	893.0

F.A.P. RTE.	SECTION	COUNTY	TOTAL SHEETS	SHEET NO.
824	19MRS	COLES	13	6

A) EXISTING TYPICAL CROSS SECTION

STATION TO STATION
103+03.00 TO 106+46.40

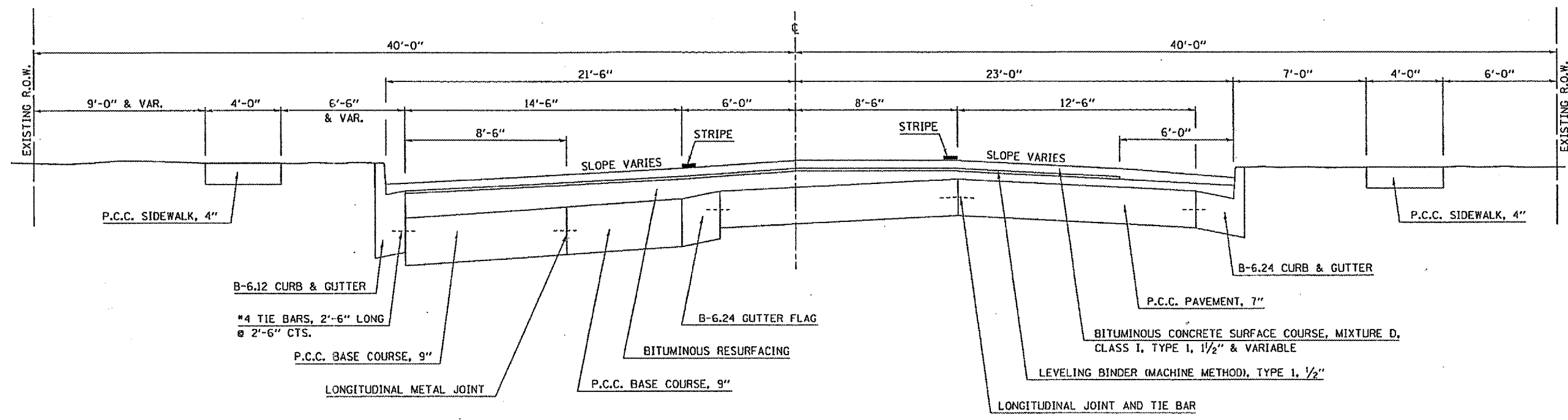

B) EXISTING TYPICAL CROSS SECTION

STATION TO STATION
106+46.40 TO 111+44.87

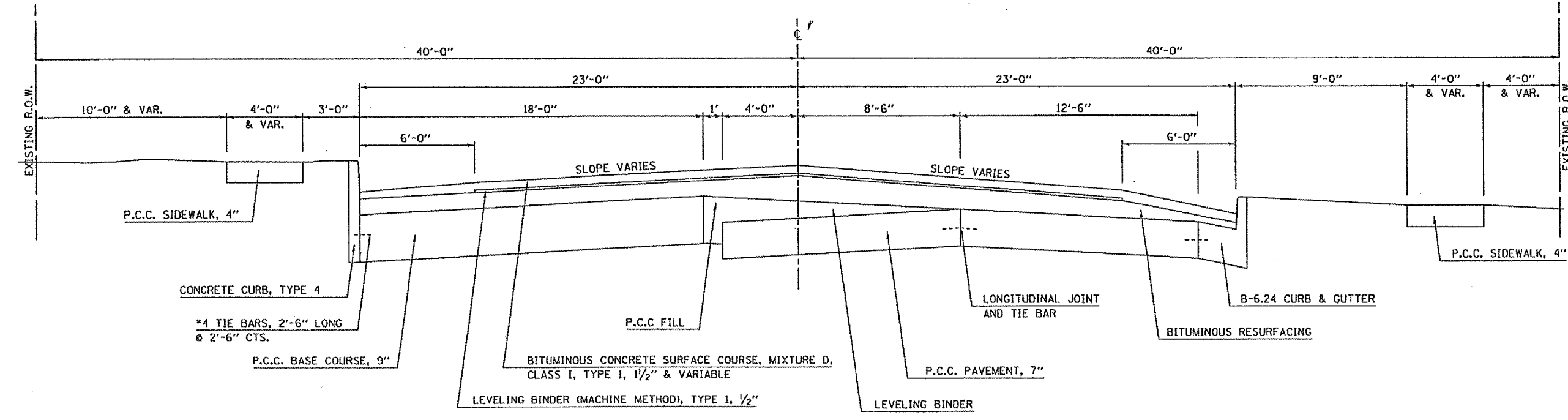

PLOT DATE = 12/22/2005
 FILE NAME = C:\p\m\m\10646487.dwg
 PLOT SCALE = 1/8" = 1'-0"
 USER NAME = phillips

F.A.P. RTE.	SECTION	COUNTY	TOTAL SHEETS	SHEET NO.
824	19MRS	COLES	13	7

A PROPOSED TYPICAL CROSS SECTION

STATION TO STATION
103+03.00 106+46.40

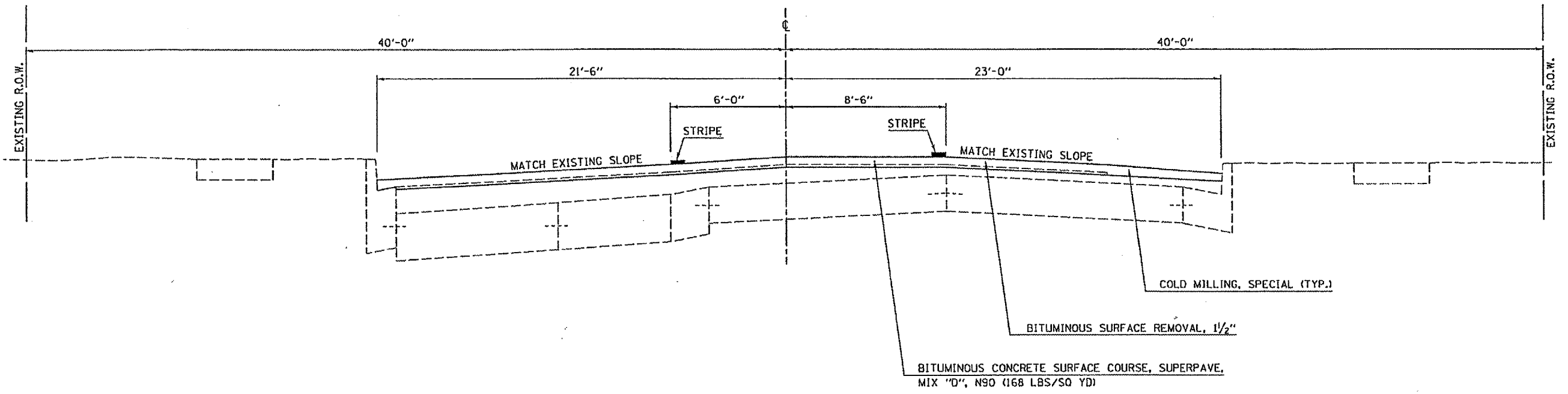

B PROPOSED TYPICAL CROSS SECTION

STATION TO STATION
106+46.40 111+44.87

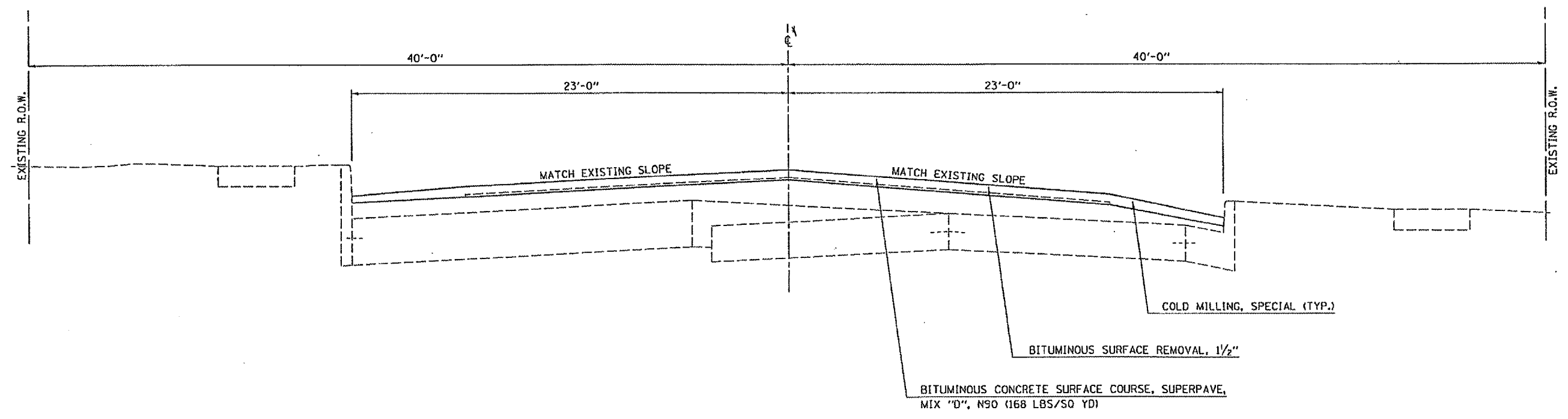

PLOT DATE = 12/27/06
 FILE NAME = c:\projects\70484\19mrs\19mrs.dgn
 PLOT SCALE = 1/8" = 1'-0"
 USER NAME = phillips

F.A.P. RTE.	SECTION	COUNTY	TOTAL SHEETS	SHEET NO.
B24	19MRS	COLES	13	8

PAVEMENT MARKING DETAILS

DEWITT AVENUE & 19TH STREET

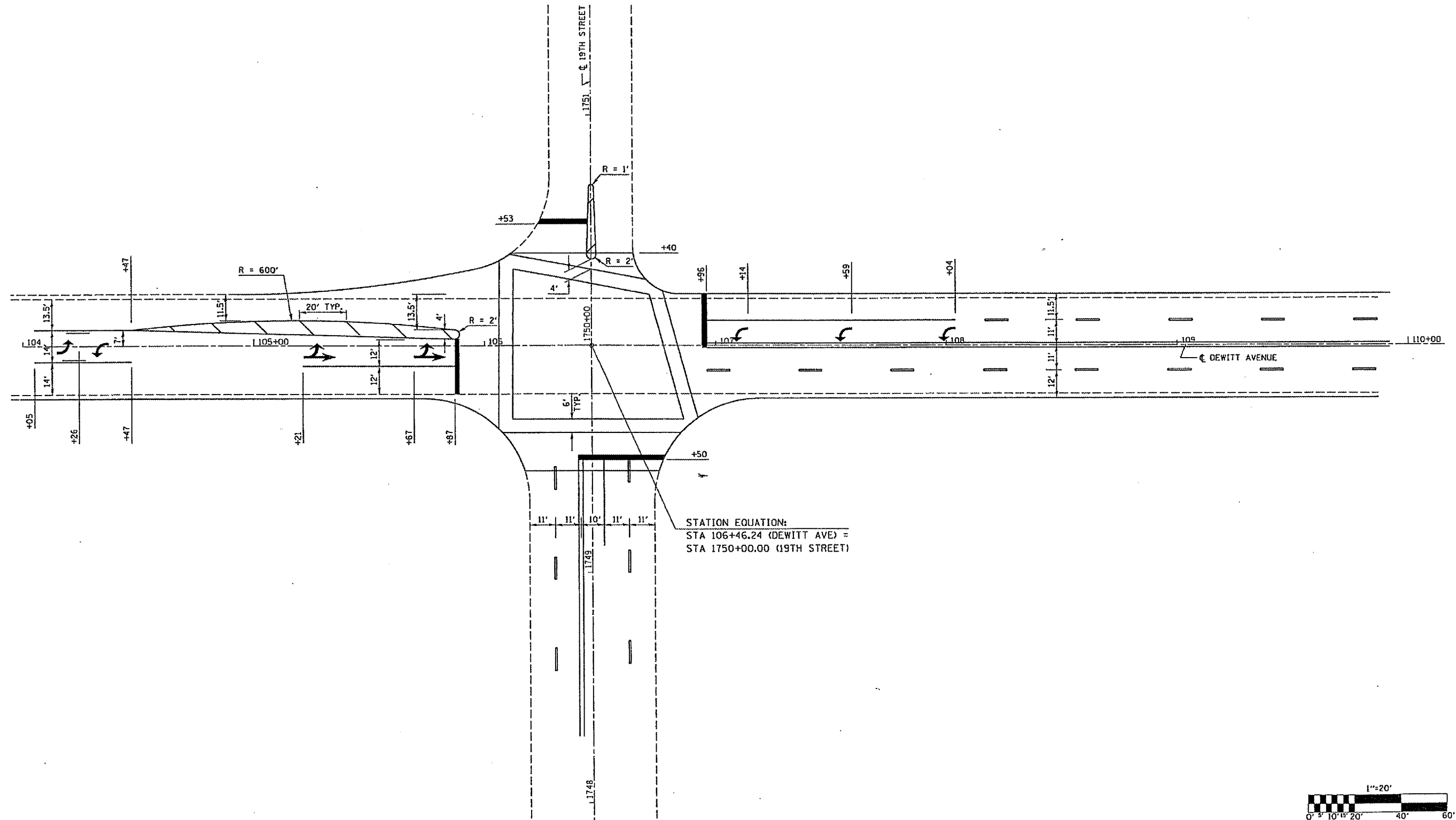

PLOT DATE = 12/2/2005
 FILE NAME = s:\projects\19mrs\19mrs\19mrs.dgn
 PLOT SCALE = 1/8" = 1'-0"
 USER NAME = philipj

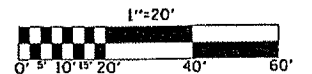

F.A.P. RTE.	SECTION	COUNTY	TOTAL SHEETS	SHEET NO.
824	19MRS	COLES	13	9

DETECTOR LOOP LOCATIONS

DEWITT AVENUE & 19TH STREET

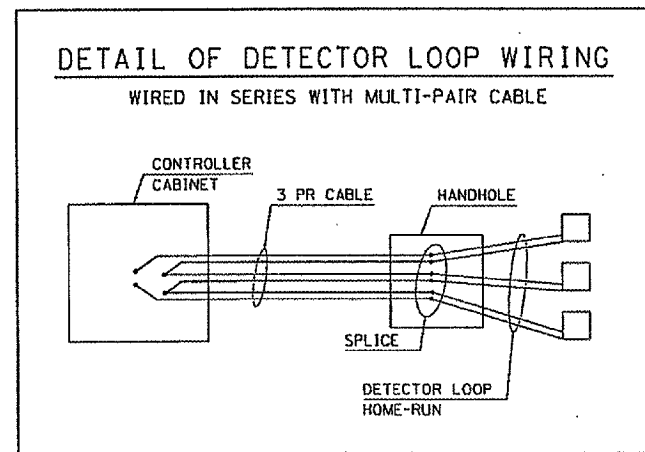
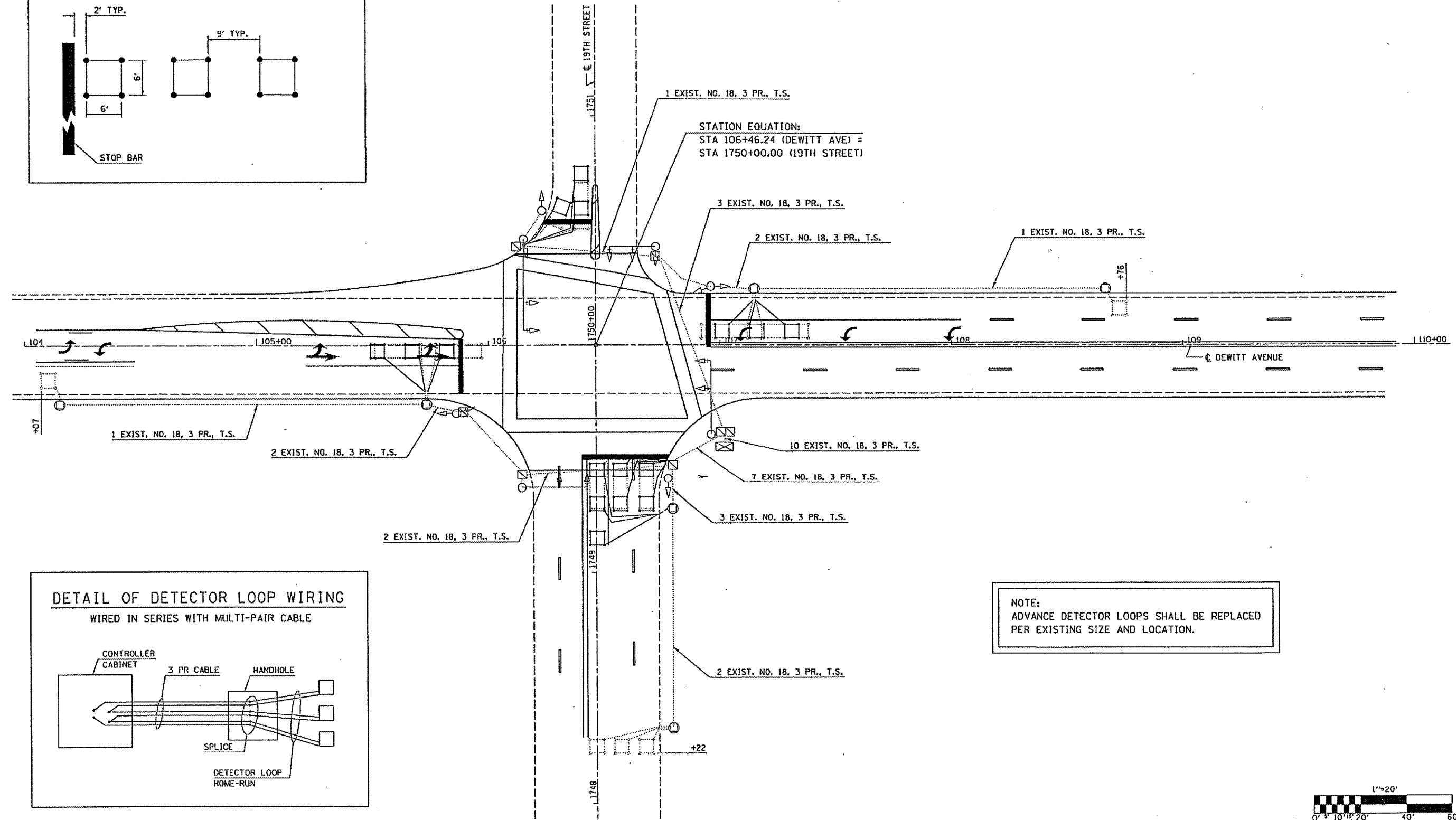
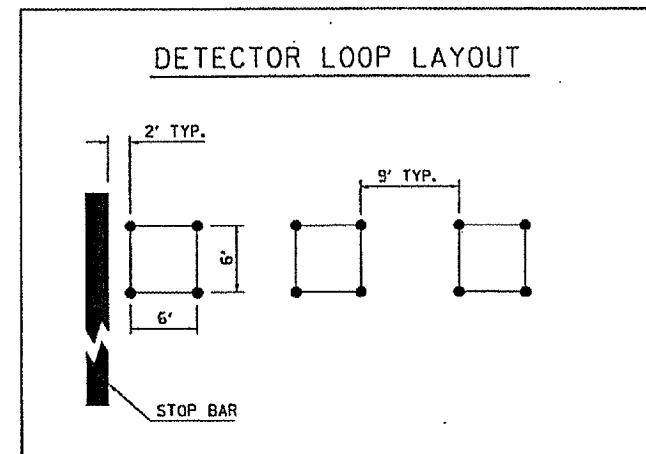

NOTE:
ADVANCE DETECTOR LOOPS SHALL BE REPLACED PER EXISTING SIZE AND LOCATION.

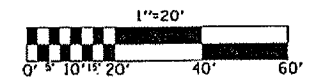

PLOT DATE = 12/2/2005
 FILE NAME = c:\projects\120805\120805.dgn
 PLOT SCALE = 1/8" = 1'-0"
 USER NAME = philipj

F.A.P. RITE.	SECTION	COUNTY	TOTAL SHEETS	SHEET NO.
B24	19MRS	COLES	13	10

TYPICAL APPLICATION OF TRAFFIC CONTROL DEVICES FOR SIDE STREET CLOSURE

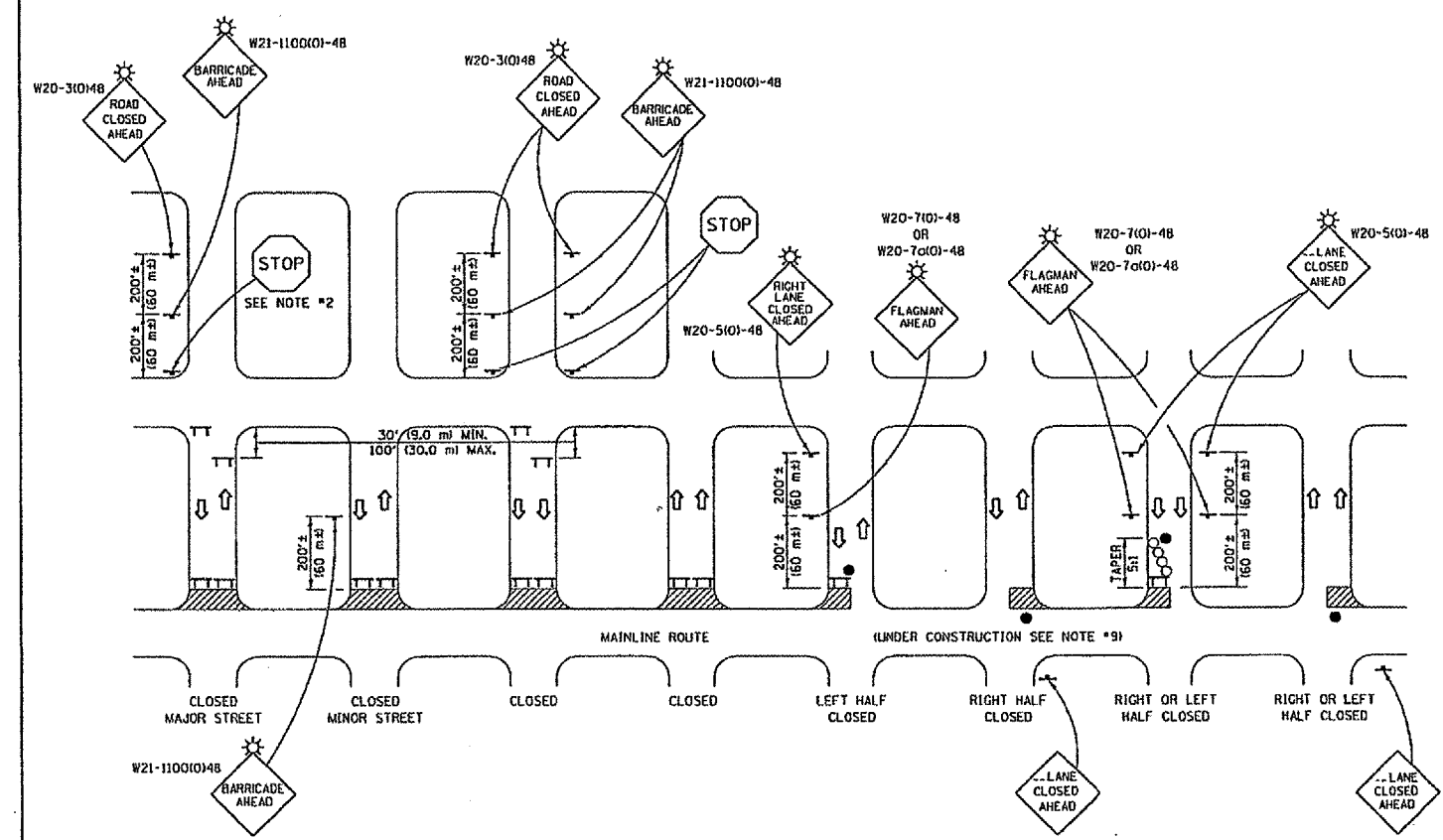

GENERAL NOTES

- TYPE III BARRICADES SHALL BE AS SHOWN ON "TYPICAL APPLICATIONS OF TYPE III BARRICADES CLOSING A ROAD". EACH TYPE III BARRICADE SHALL HAVE TWO FLASHING AMBER LIGHTS MOUNTED ABOVE IT.
- WHERE A STOP CONDITION EXISTS, AS SHOWN ABOVE, WARNING SIGNS MAY BE OMITTED IN ADVANCE OF THE "STOP" SIGN.
- STANDARD 702001 SHALL APPLY FOR THE PLACEMENT & MANUFACTURE OF TYPE III BARRICADES.
- ALL SIGNS SHALL BE POST MOUNTED IF THE CLOSURE TIME EXCEEDS FOUR DAYS.
- ONE FLASHING LIGHT IS REQUIRED ABOVE EACH ADVANCE WARNING SIGN DURING HOURS OF DARKNESS.
- LONGITUDINAL DIMENSIONS MAY BE ADJUSTED SLIGHTLY TO FIT FIELD CONDITIONS.
- FORMS BT 725 AND BT 726 ARE REQUIRED.
- THE MAINLINE ROUTE TEMPORARY TRAFFIC CONTROL SHALL BE IN ACCORDANCE WITH THE PLANS, SPECIAL PROVISIONS AND STANDARD SPECIFICATIONS.
- THIS WORK WILL NOT BE PAID FOR SEPARATELY BUT SHALL BE CONSIDERED INCLUDED IN THE VARIOUS PAY ITEMS INVOLVING THE RECONSTRUCTION OF ALL APPLICABLE SIDE STREETS AND NO ADDITIONAL COMPENSATION WILL BE ALLOWED.

SYMBOLS

- TT TYPE III BARRICADE (SEE NOTE)
- ⚡ FLASHING LIGHT
- FLAGGER WITH TRAFFIC CONTROL SIGN (WHILE WORK IS BEING PERFORMED)
- CONE (DAYLIGHT HOURS ONLY), DRUM, TYPE I OR TYPE II BARRICADE
- ▨ WORK AREA
- ⇨ TRAFFIC FLOW

	NAME		DATE		REVISIONS	
	DESIGNED	J.H.M.	8-11-87	NAME	DATE	
CHECKED	P.E.K.	8-25-87	R.M.H.	12/97		
CADD NO.	F-5.04		K.A.G.	08/03		

ALL DIMENSIONS ARE IN INCHES (MILLIMETERS) UNLESS OTHERWISE SHOWN.

PLOT DATE: 12/2/2005
 FILE NAME: m:\projects\10280886 - 18\Drawings\B24.dwg
 USER: philip.y

CONTRACT NO. 70484				
F.A.P. R/YE.	SECTION	COUNTY	TOTAL SHEETS	SHEET NO.
B24	19MRS	COLES	13	11

TYPICAL APPLICATIONS OF PAVEMENT MARKINGS AND MARKERS

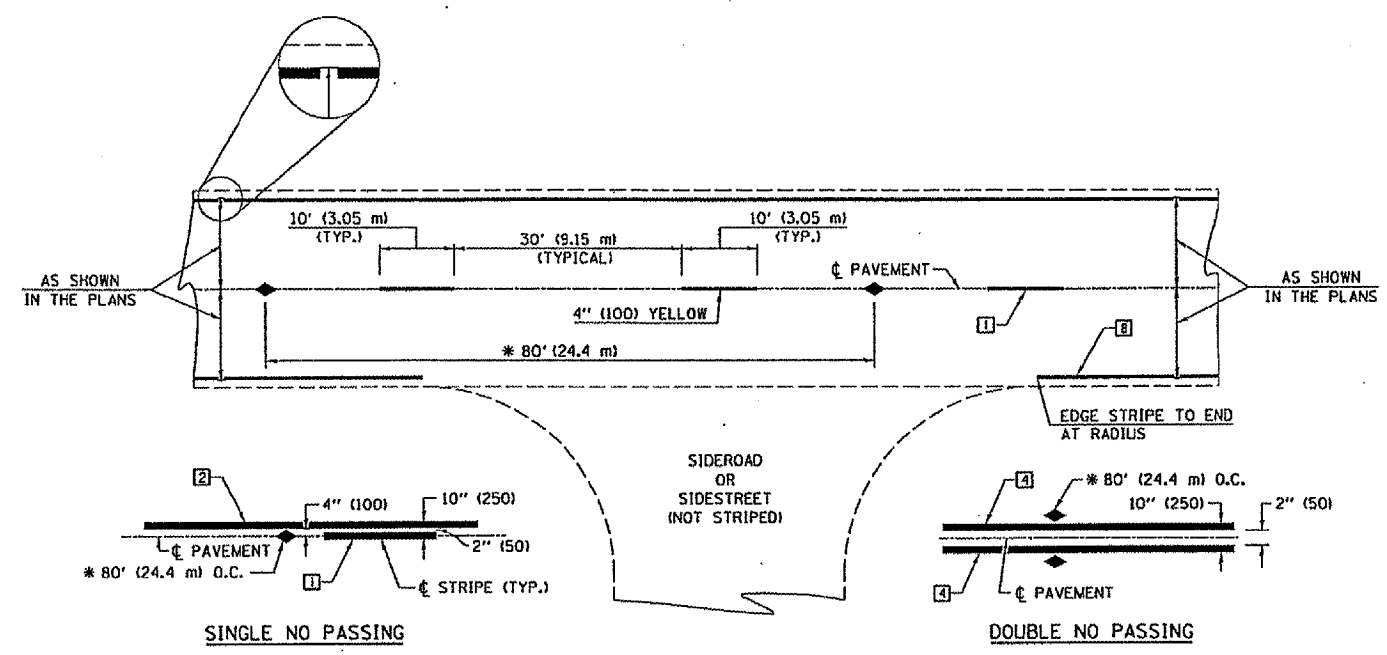

* REDUCE TO 40' (12.2 m) O.C. ON CURVES WITH POSTED OR ADVISORY SPEEDS OF 45 mph (70 km/h) OR LESS.

TYPICAL PAVEMENT MARKING LEGEND

- 1 4" (100) SKIP-DASH (YELLOW)
- 2 4" (100) SOLID (YELLOW)
- 3 12" (300) DIAGONAL (YELLOW)
- 4 4" (100) DOUBLE YELLOW (NARROW)
- 5 RESERVED
- 6 RESERVED
- 7 4" (100) SKIP-DASH (WHITE)
- 8 4" (100) SOLID (WHITE)
- 9 12" (300) DIAGONAL (WHITE)
- 10 6" (150) CROSS WALK (WHITE)
- 11 24" (600) STOP BAR (WHITE)
- 12 8" (200) SOLID (WHITE)
- 13 4" (100) LANE LINE EXTENSIONS (WHITE)
- 14 4" (100) PARKING WHITE

TYPICAL PAVEMENT MARKERS LEGEND

- ◆ TWO-WAY AMBER MARKER
- ▶ ONE-WAY AMBER MARKER
- ▷ ONE-WAY CRYSTAL MARKER

DETAIL OF RURAL LEFT TURN LANE

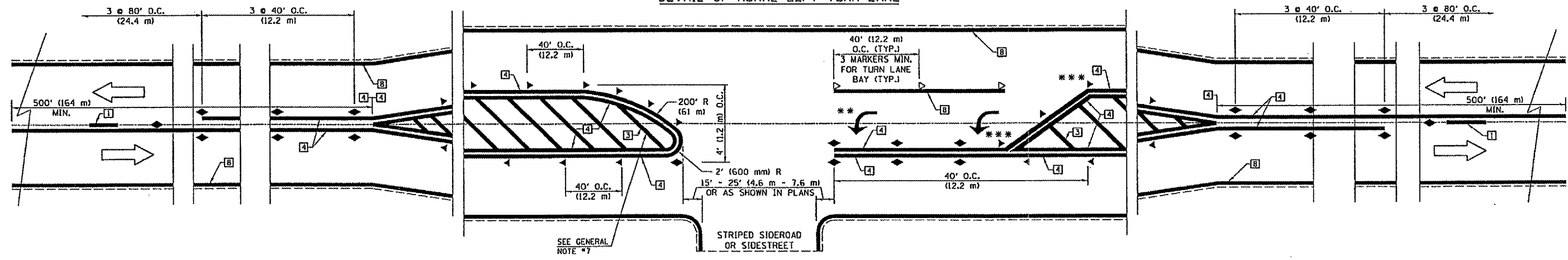

*** REDUCE SPACING IF NECESSARY TO ASSURE MARKERS AT CORNER POINTS.
 ** TURN ARROWS SHALL BE PLACED AS SHOWN ON SHEET "2".

SHEET 1 OF 3

DESIGNED	NAME	DATE	REVISIONS
J.M.H.		5/85	
CHECKED	FMS	6/85	GEOMETRICS/K.A.G.
CADD NO.	F-5.25	6/88	K.A.G.

ALL DIMENSIONS ARE IN INCHES (MILLIMETERS) UNLESS OTHERWISE SHOWN.

PLOT DATE = 12/2/2005
 FILE NAME = c:\projects\70484\19MRS\19MRS-606.dwg
 PLOT SCALE = 1/8" = 1'-0"
 USER NAME = pmlt19p

CONTRACT NO. 70484				
F.A.P. RTE.	SECTION	COUNTY	TOTAL SHEETS	SHEET NO.
824	19MRS	COLES	13	12

TYPICAL APPLICATIONS OF PAVEMENT MARKINGS AND MARKERS

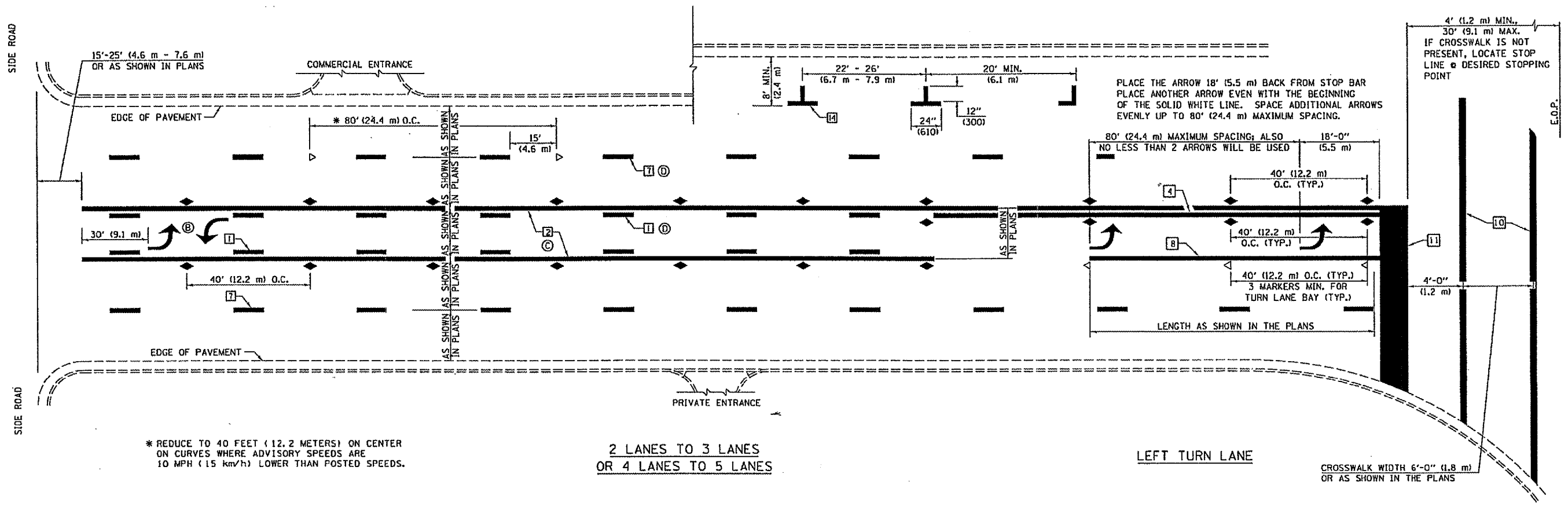

* REDUCE TO 40 FEET (12.2 METERS) ON CENTER ON CURVES WHERE ADVISORY SPEEDS ARE 10 MPH (15 km/h) LOWER THAN POSTED SPEEDS.

2 LANES TO 3 LANES
OR 4 LANES TO 5 LANES

LEFT TURN LANE

CROSSWALK WIDTH 6'-0" (1.8 m)
OR AS SHOWN IN THE PLANS

SHEET 2 OF 3

	NAME	DATE	REVISIONS	DATE
DESIGNED	J.M.H.	5/95		
CHECKED	FHS	6/95	GEOMETRICS/K.A.G.	07/02
CADD NO.	F-5.25		K.A.G.	08/04

ALL DIMENSIONS ARE IN INCHES (MILLIMETERS) UNLESS OTHERWISE SHOWN.

FILE NAME = 12/02/2005
PLOT SCALE = 1/8" = 1'-0"
USER NAME = philipm

TYPICAL APPLICATIONS OF PAVEMENT MARKINGS AND MARKERS

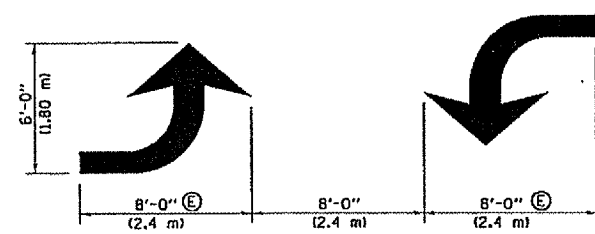

TYPICAL DOUBLE TURN ARROWS (WHITE)

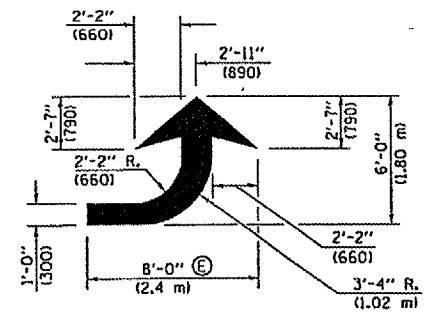

LEFT ARROW
REVERSE FOR RIGHT ARROW
AREA = 15.6 SQ. FT. (1.47 m²)
(WHITE)

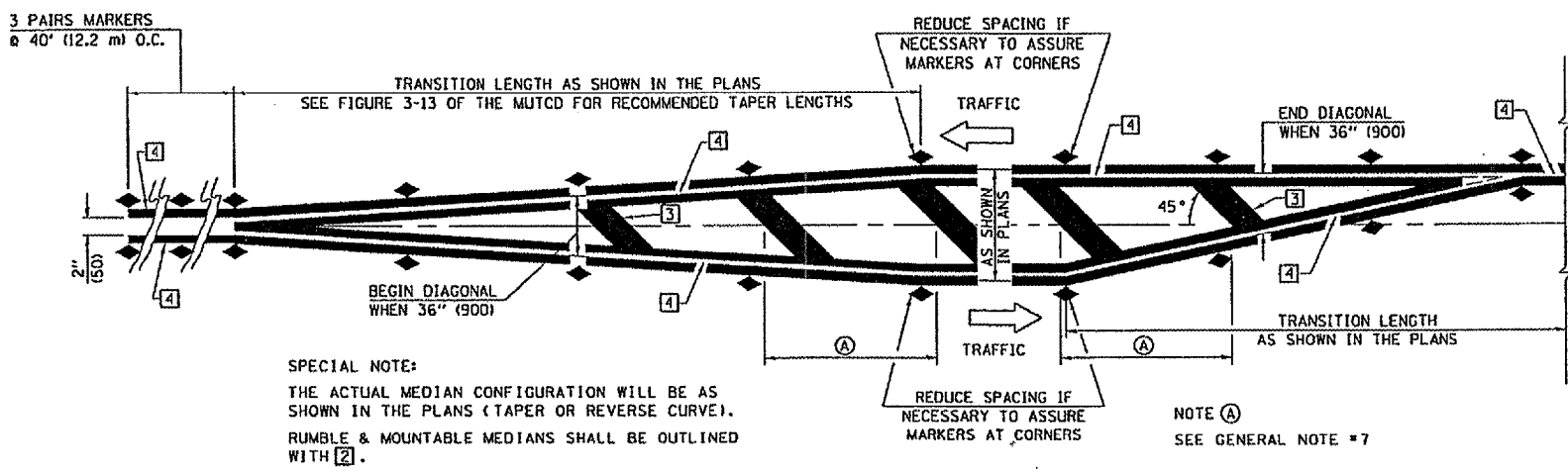

SPECIAL NOTE:
THE ACTUAL MEDIAN CONFIGURATION WILL BE AS SHOWN IN THE PLANS (TAPER OR REVERSE CURVE).
RUMBLE & MOUNTABLE MEDIANS SHALL BE OUTLINED WITH [2].

NOTE (A)
SEE GENERAL NOTE # 7

TYPICAL MEDIAN TRANSITIONS

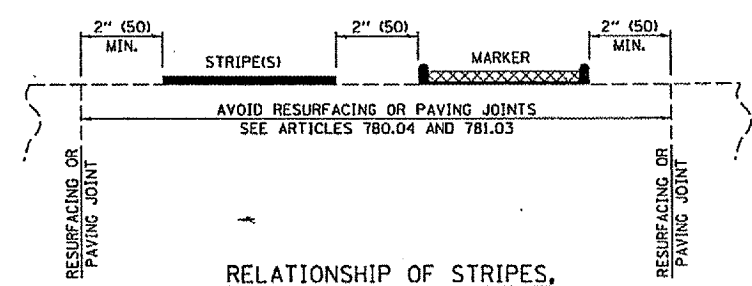

RELATIONSHIP OF STRIPES, MARKERS AND JOINTS

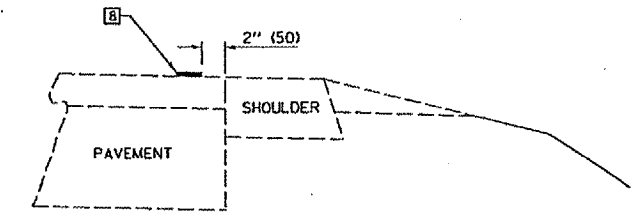

RELATIONSHIP OF EDGE STRIPE TO SAFETY SHOULDER OR PAVED SURFACE

- SPECIAL NOTES:
- (B) TURN ARROW PAIRS SHALL BE PLACED AT 250' (75 m) INTERVALS AND SHALL BE EVENLY SPACED BETWEEN BOTH ENDS OF THE BIDIRECTIONAL LEFT TURN LANE.
 - (C) THE SOLID YELLOW PAVEMENT MARKINGS [2] SHOULD GENERALLY START OR END NEAR THE RADIUS POINT OF EACH STREET RETURN EXCEPT WHERE ONE OR BOTH ENDS WOULD INCLUDE STOP BARS.
 - (D) THE SKIP-DASH PAVEMENT MARKINGS [1] OR [7] SHOULD BE CENTERED BETWEEN BOTH ENDS OF EACH CITY BLOCK AND SHALL BE PLACED SO THEY LINE UP ACROSS FROM EACH OTHER. SEE EXAMPLE ON SHEET 2 OF 3.
 - (E) TURN ARROW SIZE DEPENDS ON THE LOCATION.
RURAL LOCATION - LARGE ARROW SIZE
URBAN LOCATION - SMALL ARROW SIZE

GENERAL NOTES

1. WHEN MEDIANS ARE PRESENT, PAVEMENT MARKINGS ARE TO BE PLACED ADJACENT TO MEDIANS.
2. SCALE: NONE
3. SOME OF THE INFORMATION INCLUDED WITH THIS DETAIL MAY NOT BE APPLICABLE TO THIS IMPROVEMENT.
4. PAVEMENT MARKINGS ARE TO BE EXTENDED THROUGH OMISSIONS WHEN APPLICABLE.
5. A STRIPING KEY IS AVAILABLE ELSEWHERE AND SHALL BE SHOWN WHERE THE QUANTITIES ARE LISTED.
6. FINAL PAVEMENT MARKINGS SHALL BE IN PLACE PRIOR TO PLACING ANY RAISED REFLECTIVE PAVEMENT MARKERS.
7. THE FOLLOWING CRITERIA SHALL BE USED FOR SELECTING THE DIAGONAL PAVEMENT MARKING SPACING,
< 30 MPH USE 15' (< 50 km/h USE 4.5 m)
30-45 MPH USE 20' (50-75 km/h USE 6.0 m)
> 45 MPH USE 30' (> 75 km/h USE 9.0 m)

SHEET 3 OF 3

		REVISIONS	
DESIGNED	NAME	DATE	DATE
J.M.H.		5/95	6/98
CHECKED	FMS	6/95	6/98
CADD NO.	F-5.25	K.A.G.	08/04

ALL DIMENSIONS ARE IN INCHES (MILLIMETERS) UNLESS OTHERWISE SHOWN.

PLOT DATE = 12/2/2008
 FILE NAME = c:\projects\120808\120808.dwg
 PLOT SCALE = 100:1
 USER NAME = philipj