

F.A. RTE.	SECTION	COUNTY	TOTAL SHEETS	SHEET NO.
	*	**	24	4

• D5 CRACK & JOINT SEAL 2006-1
 •• CHAMPAIGN, EDGAR & VERMILION

LOCATION MAP #3 IL 49, FROM KANSAS TO CHAMPAIGN COUNTY LINE

EDGAR COUNTY /RURAL 2-LANE

SECTION D5 CRACK & JOINT SEAL 2006-1
 ENDS @ STATION 320+46.00

STATION EQUATION:
 STATION 124+86.86 (BK.) =
 STATION 125+00.00 (AH.)

STATION EQUATION:
 STATION 873+45.00 (BK.) =
 STATION 0+00.00 (AH.)

STATION EQUATION:
 STATION 543+01.58 (BK.) =
 STATION 543+01.65 (AH.)

STATION EQUATION:
 STATION 58+75.66 (BK.) =
 STATION 352+07.00 (AH.)

STATION EQUATION:
 STATION 324+50.00 (BK.) =
 STATION 31+19.00 (AH.)

STATION EQUATION:
 STATION 248+84.56 (BK.) =
 STATION 246+78.52 (AH.)

STATION EQUATION:
 STATION 191+14.30 (BK.) =
 STATION 191+11.74 (AH.)

SECTION D5 CRACK & JOINT SEAL 2006-1
 BEGINS @ STATION 3+35.00

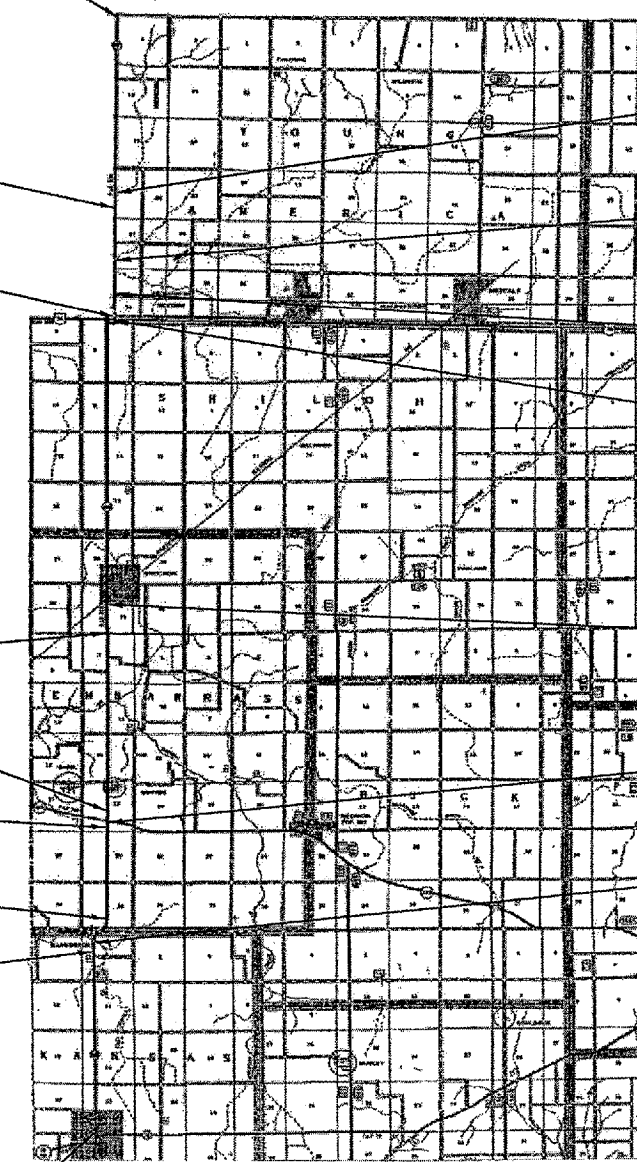

OMISSION FROM RESURFACING:
 STATION 135+02.17 TO
 STATION 135+75.83

BRIDGE OMISSION:
 S. N. 023-0022
 STATION 69+65.35 TO
 STATION 69+94.66

RAILROAD OMISSION:
 STATION 26+05.00 TO
 STATION 26+14.00

OMISSION FROM RESURFACING:
 STATION 868+80.00 TO
 STATION 4+30.00

RAILROAD OMISSION:
 STATION 575+86.95 TO
 STATION 576+15.70

OMISSION FROM RESURFACING:
 STATION 31+19.00 TO
 STATION 58+75.66

BRIDGE OMISSION:
 S. N. 023-0026
 STATION 208+35.70 TO
 STATION 209+44.05



TOTAL LENGTH OF SECTION = 119,251.05 FT. = 22.585 MILES
 NET LENGTH OF SECTION = 115,350.32 FT. = 21.847 MILES



LOCATION MAP #4 F.A.I. 74, FROM WEST OF OGDEN TO U.S. 150

CHAMPAIGN & VERMILION COUNTIES /RURAL 2-LANE, URBAN 2-LANE

OMISSIONS FROM RESURFACING:
 STATION 900+32.00 TO STATION 902+26.00
 STATION 999+85.10 TO STATION 1001+79.10
 STATION 1106+33.18 TO STATION 1108+27.18
 STATION 1159+13.70 TO STATION 1161+07.70
 STATION 1240+24.59 TO STATION 1242+18.59
 STATION 1319+72.33 TO STATION 1321+66.33
 STATION 1412+61.00 TO STATION 1414+67.00
 STATION 1627+88.22 TO STATION 1632+12.11

SECTION D5 CRACK & JOINT SEAL 2006-1
 BEGINS @ STATION 880+00.00

SECTION D5 CRACK & JOINT SEAL 2006-1
 ENDS @ STATION 1720+00.00

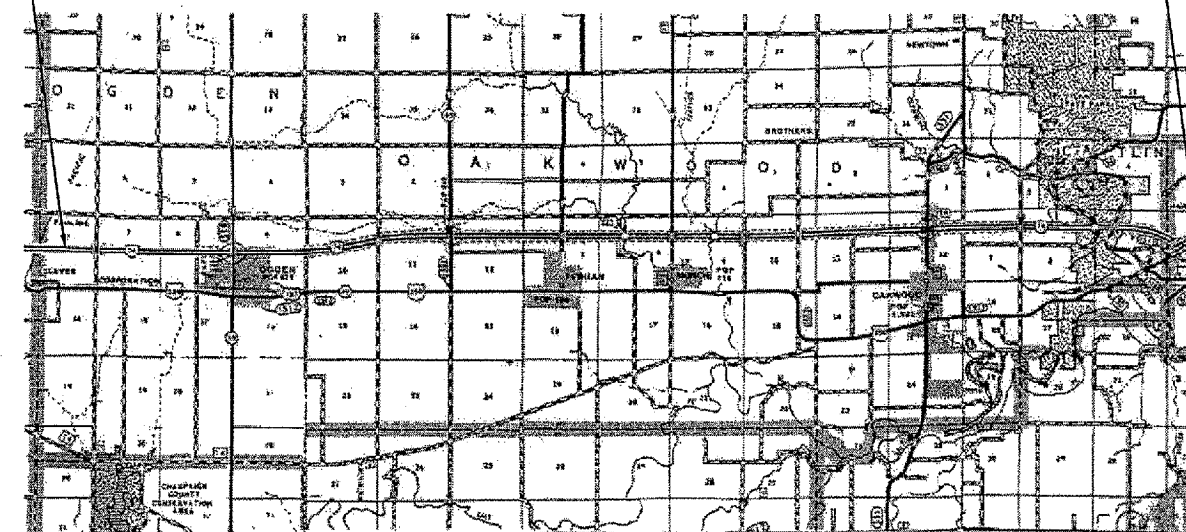

TOTAL LENGTH OF SECTION = 84,000.00 FT. = 15.909 MILES
 NET LENGTH OF SECTION = 82,206.11 FT. = 15.569 MILES



PLOT DATE = 12/15/2005
 FILE NAME = g:\projects\70492\70492plans.dgn
 PLOT SCALE = 402355 / IN
 USER NAME = pier.sundor