

F.A. RTE.	SECTION	COUNTY	TOTAL SHEETS	SHEET NO.
VAR.	*	**	24	4

- \* D5 CRACK & JOINT SEAL 2006-1
- \*\* CHAMPAIGN, EDGAR & VERMILION

### LOCATION MAP #3 IL 49, FROM KANSAS TO CHAMPAIGN COUNTY LINE

#### EDGAR COUNTY /RURAL 2-LANE

SECTION D5 CRACK & JOINT SEAL 2006-1  
ENDS @ STATION 320+46.00

STATION EQUATION:  
STATION 124+86.86 (BK.) =  
STATION 125+00.00 (AH.)

STATION EQUATION:  
STATION 873+45.00 (BK.) =  
STATION 0+00.00 (AH.)

STATION EQUATION:  
STATION 543+01.58 (BK.) =  
STATION 543+01.65 (AH.)

STATION EQUATION:  
STATION 58+75.66 (BK.) =  
STATION 352+07.00 (AH.)

STATION EQUATION:  
STATION 324+50.00 (BK.) =  
STATION 31+19.00 (AH.)

STATION EQUATION:  
STATION 248+84.56 (BK.) =  
STATION 246+78.52 (AH.)

STATION EQUATION:  
STATION 191+14.30 (BK.) =  
STATION 191+11.74 (AH.)

SECTION D5 CRACK & JOINT SEAL 2006-1  
BEGINS @ STATION 3+35.00

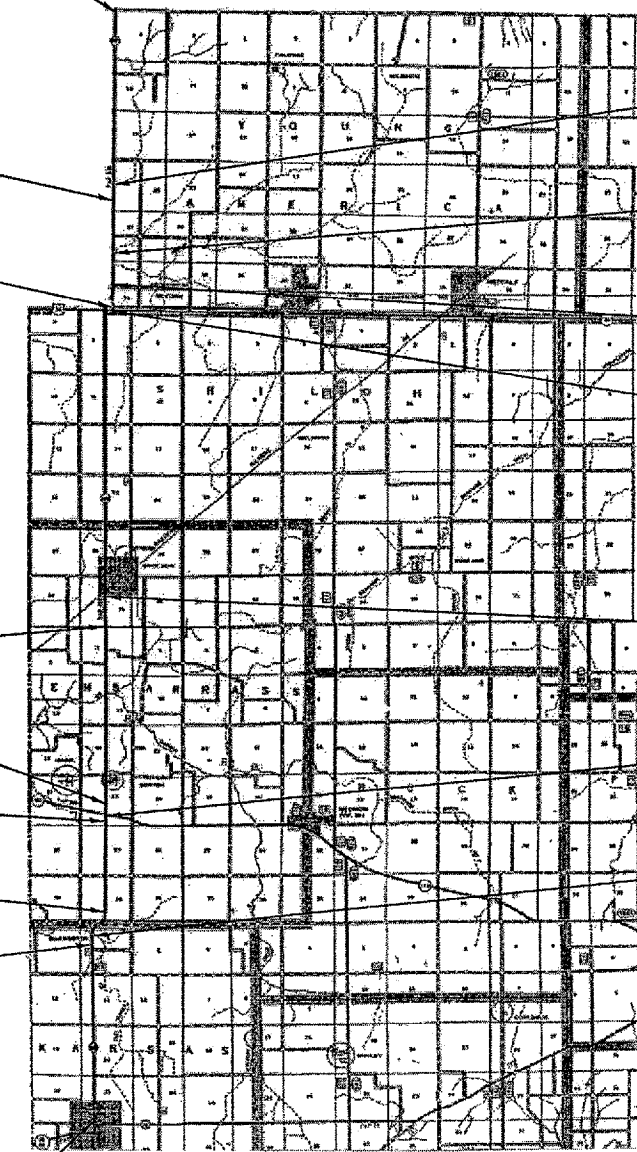

OMISSION FROM RESURFACING:  
STATION 135+02.17 TO  
STATION 135+75.83

BRIDGE OMISSION:  
S. N. 023-0022  
STATION 69+65.35 TO  
STATION 69+94.66

RAILROAD OMISSION:  
STATION 26+05.00 TO  
STATION 26+14.00

OMISSION FROM RESURFACING:  
STATION 868+80.00 TO  
STATION 4+30.00

RAILROAD OMISSION:  
STATION 575+86.95 TO  
STATION 576+15.70

OMISSION FROM RESURFACING:  
STATION 31+19.00 TO  
STATION 58+75.66

BRIDGE OMISSION:  
S. N. 023-0026  
STATION 208+35.70 TO  
STATION 209+44.05

TOTAL LENGTH OF SECTION = 119,251.05 FT. = 22.585 MILES  
NET LENGTH OF SECTION = 115,350.32 FT. = 21.847 MILES

### LOCATION MAP #4 F.A.I. 74, FROM WEST OF OGDEN TO U.S. 150

#### CHAMPAIGN & VERMILION COUNTIES /RURAL LANE, URBAN LANE

OMISSIONS FROM RESURFACING:  
STATION 900+32.00 TO STATION 902+26.00  
STATION 999+85.10 TO STATION 1001+79.10  
STATION 1106+33.18 TO STATION 1108+27.18  
STATION 1159+13.70 TO STATION 1161+07.70  
STATION 1240+24.59 TO STATION 1242+18.59  
STATION 1319+72.33 TO STATION 1321+66.33  
STATION 1412+61.00 TO STATION 1414+67.00  
STATION 1627+88.22 TO STATION 1632+12.11

SECTION D5 CRACK & JOINT SEAL 2006-1  
BEGINS @ STATION 880+00.00

SECTION D5 CRACK & JOINT SEAL 2006-1  
ENDS @ STATION 1720+00.00

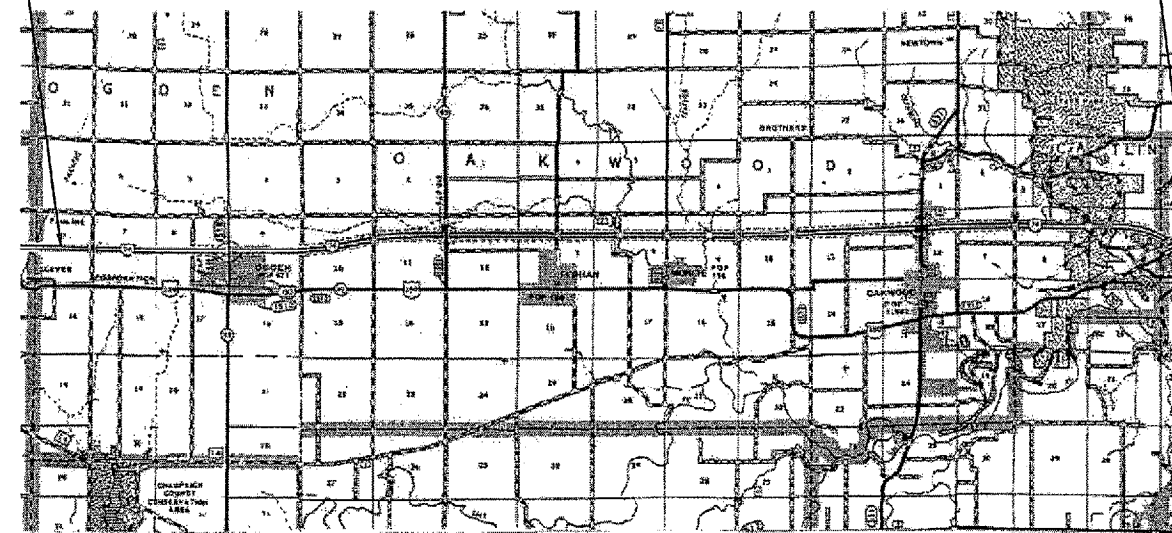

TOTAL LENGTH OF SECTION = 84,000.00 FT. = 15.909 MILES  
NET LENGTH OF SECTION = 82,206.11 FT. = 15.569 MILES

**REVISED**  
2-24-06