

SEE PAGE 2 FOR INDEX OF SHEETS AND HIGHWAY STANDARDS

STATE OF ILLINOIS
DEPARTMENT OF TRANSPORTATION
DIVISION OF HIGHWAYS
**PLANS FOR PROPOSED
CONTRACT MAINTENANCE**
FAP 713 (IL 101)
OVER LAMOINE RIVER
SECTION (120BR)I-1
SCHUYLER COUNTY
C-96-011-06

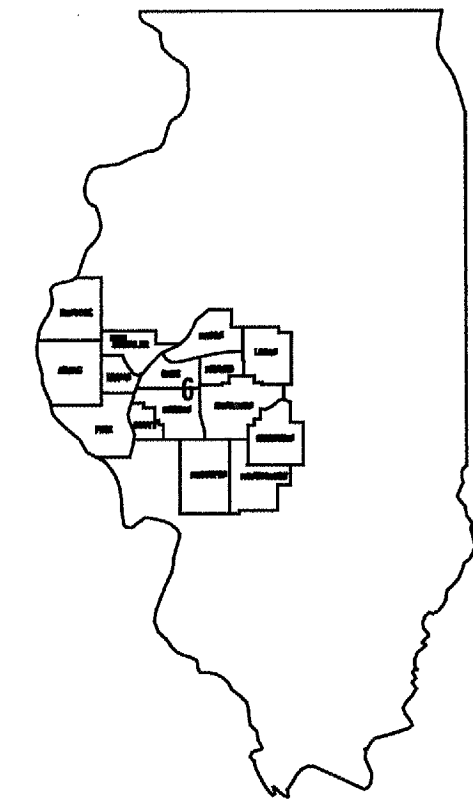

LOCATION OF SECTION INDICATED THUS: ■

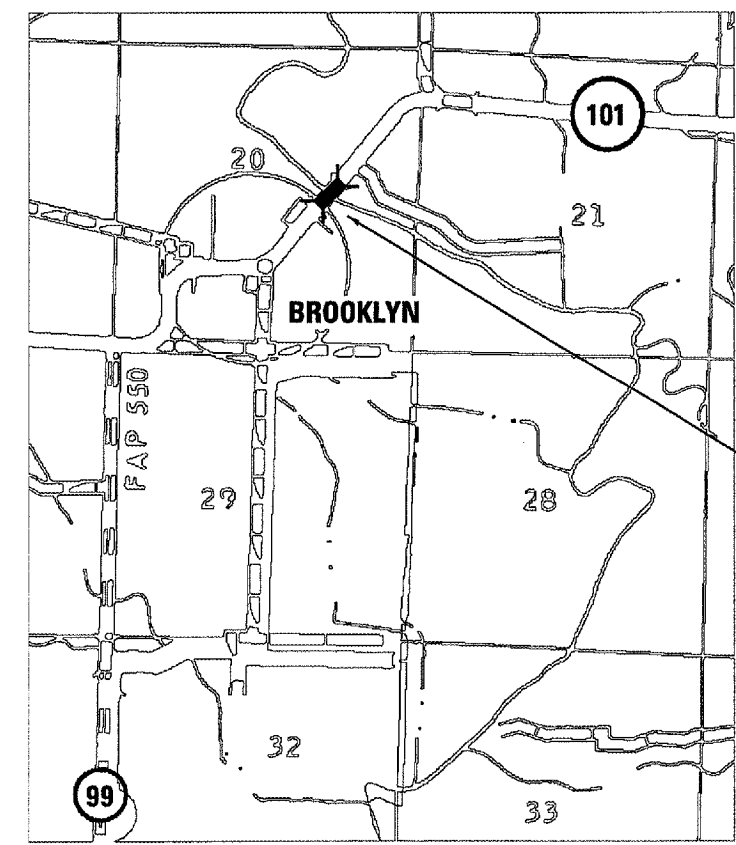

SN 085-0016

NET LENGTH OF PROJECT: 486 FT = 0.09 MI

J. U. L. I. E.
JOINT UTILITY LOCATION INFORMATION FOR EXCAVATION
1-800-892-0123

DESIGN & PLANNING ENGINEER: CECIL DOWNING
BRIDGE INSPECTOR ENGINEER: DAVE COPENBARGER
PHONE: (217) 785-5306

CONTRACT NO. 72A21

STATE OF ILLINOIS
DEPARTMENT OF TRANSPORTATION
DIVISION OF HIGHWAYS

SUBMITTED JANUARY 10 2006
Chris M Reed
DISTRICT ENGINEER

February 3, 2006
Mike Fine / RD
ENGINEER OF DESIGN AND ENVIRONMENT

February 3, 2006
Milton R. Ses, P.E. / RD
DIRECTOR, DIVISION OF HIGHWAYS