

SCHEDULE OF STRUCTURES

FAU RTE	SECTION	COUNTY	TOTAL SHEETS	SHEET NO.
1447	03-00159-00-RS	COOK	24	13
F. HW. A. REC.	ILLINOIS	PROJECT STPM-8003(S81)	CONTRACT NO. 83835	



- 126. STA. 44+59, 18.5' L CATCH BASIN TO BE ADJUSTED PROP. RIM = 616.75
- 127. STA. 44+92, 33' L VALVE VAULT TO BE RECONSTRUCTED PROP. RIM = 616.80
- 128. STA. 44+55, 18.5 R CATCH BASIN TO BE ADJUSTED PROP. RIM = 616.75
- 129. STA. 44+97, 34' R VALVE VAULT TO BE ADJUSTED, SPECIAL PROP. RIM = 617.00
- 130. STA. 45+03, 23.5' L MANHOLE TO BE RECONSTRUCTED PROP. RIM = 617.10
- 131. STA. 45+44, 18.5' L CATCH BASIN TO BE ADJUSTED PROP. RIM = 616.50
- 132. STA. 45+44, 18.5' R INLET TO BE ADJUSTED PROP. RIM = 616.50
- 133. STA. 45+44, 24.5' R CATCH BASIN TO BE ADJUSTED PROP. RIM = 617.10
- 134. STA. 46+67, 16' L MANHOLE TO BE RECONSTRUCTED PROP. RIM = 617.10
- 135. STA. 47+92, 18.5' L CATCH BASIN TO BE ADJUSTED PROP. RIM = 616.50
- 136. STA. 48+29, 36' L VALVE VAULT TO BE ADJUSTED, SPECIAL PROP. RIM = 616.80
- 137. STA. 47+92, 25.5' R CATCH BASIN TO BE ADJUSTED PROP. RIM = 617.10
- 138. STA. 47+93, 18.5' R INLET TO BE ADJUSTED PROP. RIM = 616.50
- 139. STA. 48+17, 37' R VALVE VAULT TO BE ADJUSTED PROP. RIM = 617.40
- 140. STA. 48+37, 28.5' L MANHOLE TO BE ADJUSTED, SPECIAL PROP. RIM = 617.00
- 141. STA. 48+94, 11.5' L MANHOLE TO BE ADJUSTED, SPECIAL PROP. RIM = 617.00
- 142. STA. 49+68, 11.5' L VALVE VAULT TO BE ADJUSTED, SPECIAL PROP. RIM = 616.70
- 143. STA. 49+74, 11.5' L VALVE VAULT TO BE ADJUSTED, SPECIAL PROP. RIM = 616.70
- 144. STA. 50+00, 15' L MANHOLE TO BE RECONSTRUCTED PROP. RIM = 616.65
- 145. STA. 51+31, 18.5' L CATCH BASIN TO BE ADJUSTED PROP. RIM = 616.17
- 146. STA. 51+61, 32.5' L VALVE VAULT TO BE RECONSTRUCTED PROP. RIM = 616.50
- 147. STA. 51+34, 13.5' CATCH BASIN TO BE ADJUSTED, SPECIAL PROP. RIM = 616.30
- 148. STA. 51+35, 18.5' R INLET TO BE ADJUSTED PROP. RIM = 616.17
- 149. STA. 51+63, 33' R VALVE VAULT TO BE ADJUSTED, SPECIAL PROP. RIM = 616.90
- 150. STA. 51+70, 21.5' L MANHOLE TO BE RECONSTRUCTED PROP. RIM = 616.80
- 151. STA. 52+13, 18.5' L CATCH BASIN TO BE ADJUSTED PROP. RIM = 616.45
- 152. STA. 52+10, 26' R CATCH BASIN TO BE ADJUSTED PROP. RIM = 617.05
- 153. STA. 52+13, 18.5' R INLET TO BE ADJUSTED PROP. RIM = 616.45
- 154. STA. 53+15, 15.5' L MANHOLE TO BE RECONSTRUCTED PROP. RIM = 617.10
- 155. STA. 54+55, 15' L MANHOLE TO BE RECONSTRUCTED PROP. RIM = 616.65
- 156. STA. 54+65, 8.5' L VALVE VAULT TO BE RECONSTRUCTED PROP. RIM = 616.70
- 157. STA. 54+66, 14' L CATCH BASIN TO BE RECONSTRUCTED PROP. TYPE 1 FRAME, CLOSED LID PROP. RIM = 616.60
- 158. STA. 54+66, 18.5' L INLET TO BE ADJUSTED PROP. RIM = 616.50
- 159. STA. 54+87, 32.5' L VALVE VAULT TO BE ADJUSTED, SPECIAL PROP. RIM = 616.90
- 160. STA. 54+62, 13.5' R CATCH BASIN TO BE RECONSTRUCTED PROP. RIM = 616.75
- 161. STA. 54+65, 18.5' R INLET TO BE ADJUSTED PROP. RIM = 616.50
- 162. STA. 54+88, 34.5' R VALVE VAULT TO BE ADJUSTED, SPECIAL PROP. RIM = 616.85
- 163. STA. 55+00, 22' R MANHOLE TO BE ADJUSTED, SPECIAL PROP. RIM = 616.95
- 164. STA. 55+20, 45' R CATCH BASIN TO BE RECONSTRUCTED PROP. RIM = 616.45
- 165. STA. 55+39, 10' L VALVE VAULT TO BE RECONSTRUCTED PROP. RIM = 616.90
- 166. STA. 58+00, 18.5' L CATCH BASIN TO BE ADJUSTED PROP. RIM = 615.60
- 167. STA. 58+29, 31.5' L VALVE VAULT TO BE RECONSTRUCTED PROP. RIM = 615.50
- 168. STA. 58+39, 30.5' L MANHOLE REHABILITATION AND ADJUSTMENT, SPECIAL INVERT = 608.40 PROP. RIM = 615.60
- 169. STA. 58+00, 18.5' R INLET TO BE ADJUSTED PROP. RIM = 615.60
- 170. STA. 58+00, 25' R CATCH BASIN TO BE ADJUSTED PROP. RIM = 616.20
- 171. STA. 58+30, 34.5' R VALVE VAULT TO BE ADJUSTED, SPECIAL PROP. RIM = 615.70
- 172. STA. 58+39, 0' R MANHOLE TO BE LINED AND ADJUSTED, SPECIAL PROP. TYPE 1 FRAME, CLOSED LID INVERT = 603.35 PROP. RIM = 616.15
- 173. STA. 58+39, 6' R MANHOLE TO BE ADJUSTED, SPECIAL PROP. RIM = 616.15

- WATER MAIN SCHEDULE**
- (D) 1-8" INSERTION VALVE
1-VALVE VAULT, 4' DIA.
1-TYPE 1 FRAME WITH "WATER" STAMPED ON CLOSED LID
 - (E) 1-8" GATE VALVE
1-VALVE VAULT, 4' DIA.
1-8" SLEEVE
3'-8" D.I.P.
1-TYPE 1 FRAME WITH "WATER" STAMPED ON CLOSED LID

ALL BUFFALO BOXES ON THIS PROJECT LOCATED BETWEEN THE CURB AND THE SIDEWALK ARE TO BE ADJUSTED TO GRADE. BROKEN OR OTHERWISE UNUSABLE BUFFALO BOXES SHALL BE REPAIRED AND BE PAID FOR AS DOMESTIC WATER SERVICE BOXES TO BE ADJUSTED, SPECIAL.

IMPORTANT!
FULL SIZE PLANS HAVE BEEN PREPARED USING STANDARD ENGINEERING SCALES. REDUCED SIZED PLANS WILL NOT CONFORM TO STANDARD SCALES INDICATED IN TITLE BLOCK.

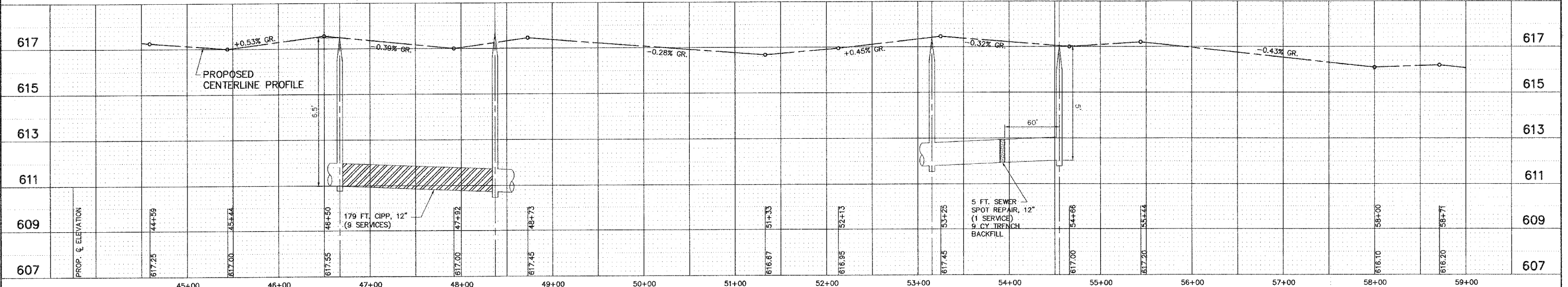
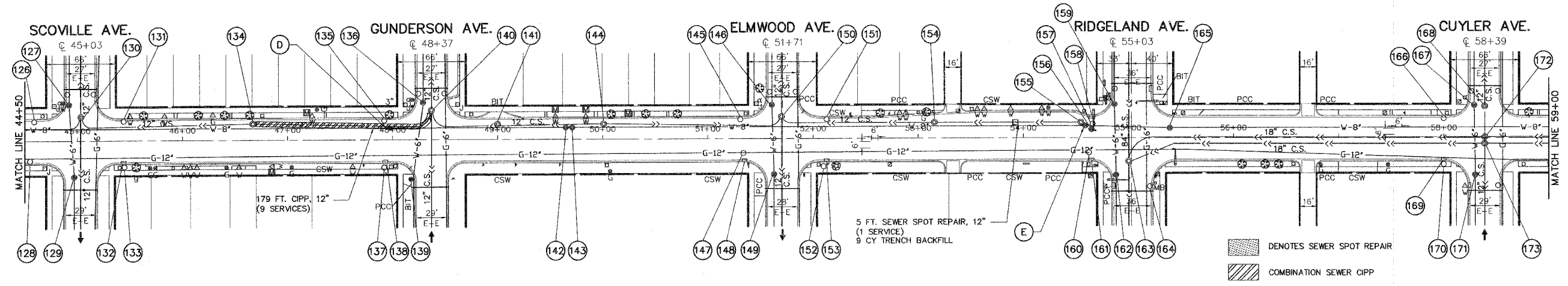

Frank Novotny & Associates, Inc.
Civil Engineers/Municipal Consultants
825 Midway Drive • Willowbrook, IL • 60527 • Telephone: (630) 887-8640 • Fax: (630) 887-0132
Illinois Professional Design Firm No. 194-000928

PROJECT
CITY OF BERWYN, ILLINOIS
16TH STREET RESURFACING
SECTION NO. 03-00159-00-RS

REVISIONS			
NO.	BY	DATE	DESCRIPTION
1	THK	11/30/05	PER IDOT DIST. 1 B.L.R. COMMENTS
2	THK	12/14/05	PER IDOT DIST. 1 B.L.R. COMMENTS
3	THK	12/16/05	PER IDOT DIST. 1 B.L.R. COMMENTS

DRAINAGE PLAN
16TH STREET
STA. 44+50 TO STA. 59+00

PROJECT NO. 02260	SCALE H:1"=50'; V:1"=1'	SHEET 13
DRAWN/DESIGNED JEP-RAW/THK	DATE OCT., 2005	OF 24
CHECKED/APPROVED JEF	FIELD BOOK NO. FILE	SHEETS

I:\Projects\2005\02260_SIT_03-00159-00-RS\Drawings\16_18_Strip.dwg, 12/20/2005 11:44:44 PM