

OPAL SHOEMAKER & GLADYS KAUFMAN
NE 1/4, SEC 14, T.19N, R. 3E, 3rd PM

E.O. MARTIN COMPANY
SE 1/4, SEC 11, T.19N, R. 3E, 3rd PM

C.H.	SECTION	COUNTY	TOTAL SHEETS	SH. N.
5	85-00043-00-RS	DEWITT	79	
STA. 218+00		TO STA. 233+00		
FED. ROAD DIST. NO.		ILLINOIS	FED. AID PROJECT	
CONTRACT No. 91316				

P.I. STA. 222+00.00
Δ = 0° 05' 38.86" (LT)
NO CURVE
N. 1255506.0040
E. 847703.3761

P.I. STA. 227+00.00
Δ = 0° 13' 19.25" (RT)
NO CURVE
N. 1256005.9630
E. 847709.8558

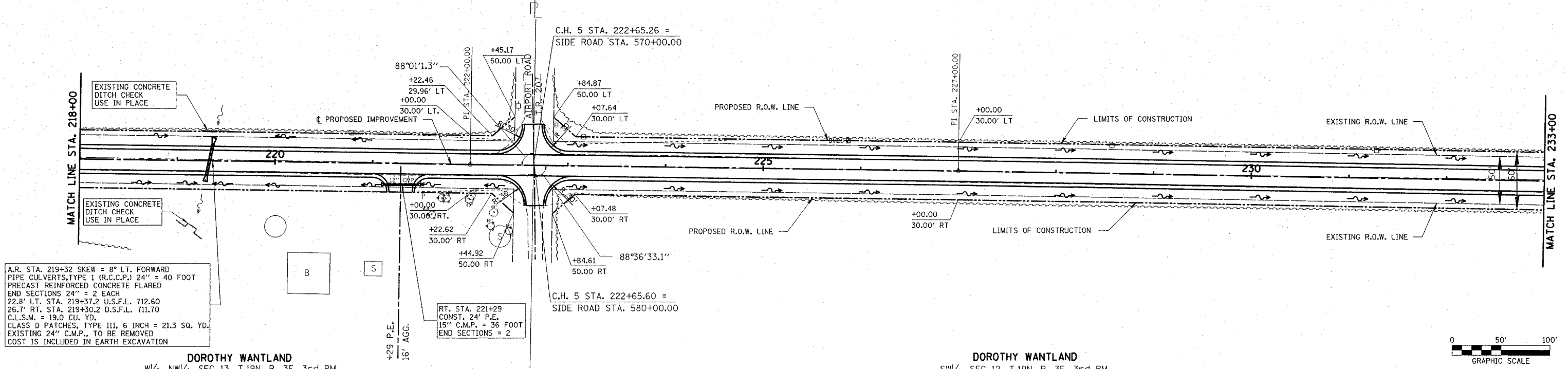

A.R. STA. 219+32 SKEW = 8° LT. FORWARD
PIPE CULVERTS, TYPE 1 (R.C.C.P.) 24" = 40 FOOT
PRECAST REINFORCED CONCRETE FLARED
END SECTIONS 24" = 2 EACH
22.8' LT. STA. 219+37.2 U.S.F.L. 712.60
26.7' RT. STA. 219+30.2 D.S.F.L. 711.70
C.L.S.M. = 19.0 CU. YD.
CLASS D PATCHES, TYPE III, 6 INCH = 21.3 SQ. YD.
EXISTING 24" C.M.P., TO BE REMOVED
COST IS INCLUDED IN EARTH EXCAVATION

DOROTHY WANTLAND
W 1/2, NW 1/4, SEC 13, T.19N, R. 3E, 3rd PM

DOROTHY WANTLAND
SW 1/4, SEC 12, T.19N, R. 3E, 3rd PM

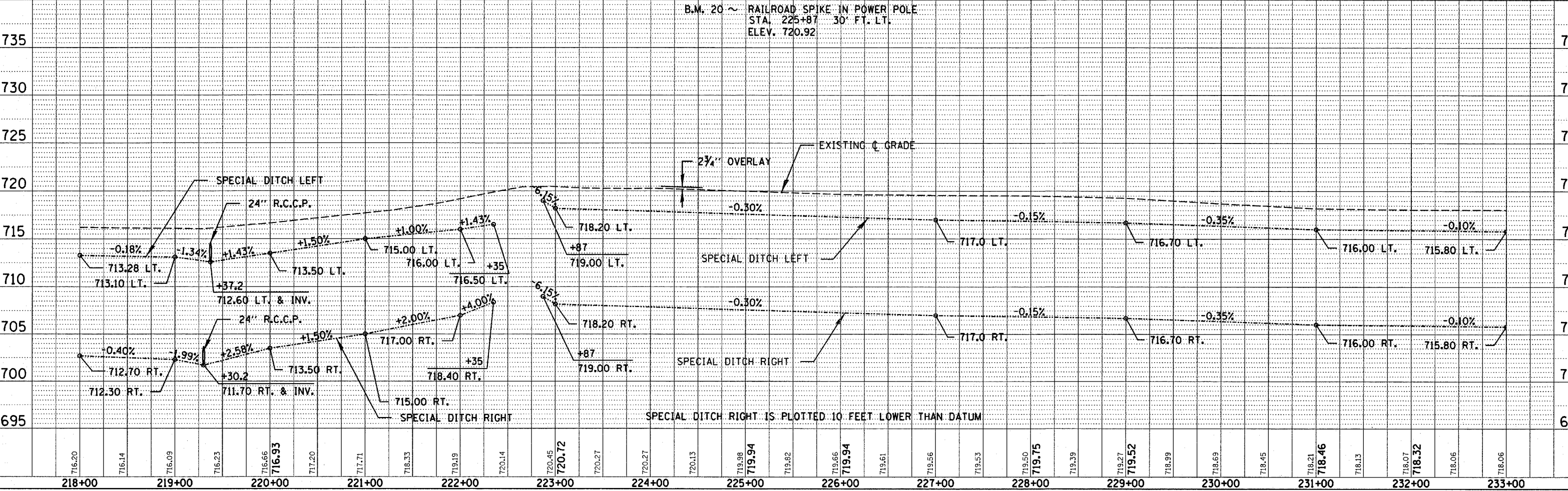
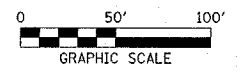

B.M. 20 ~ RAILROAD SPIKE IN POWER POLE
STA. 225+87 30' FT. LT.
ELEV. 720.92