

ROUTE NO.	SECTION	COUNTY	TOTAL SHEETS	SHEET NO.
C.H. 5	85-00043-00-RS	DEWITT	79	38
FED. ROAD DIST. NO.	ILLINOIS FED. AID PROJECT-			

CONTRACT No. 91316

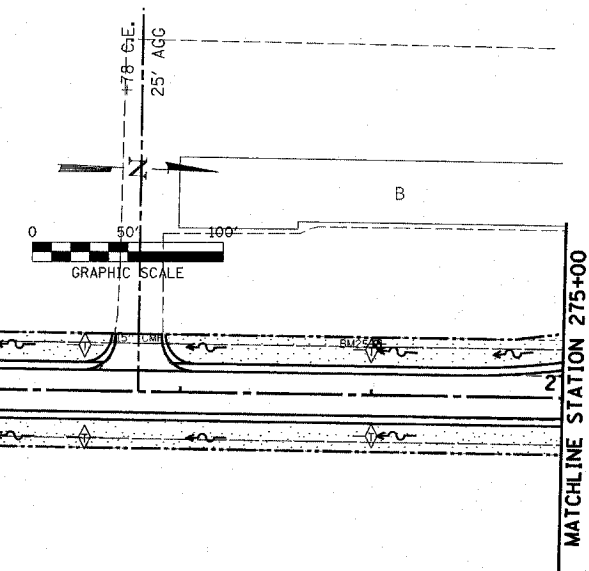
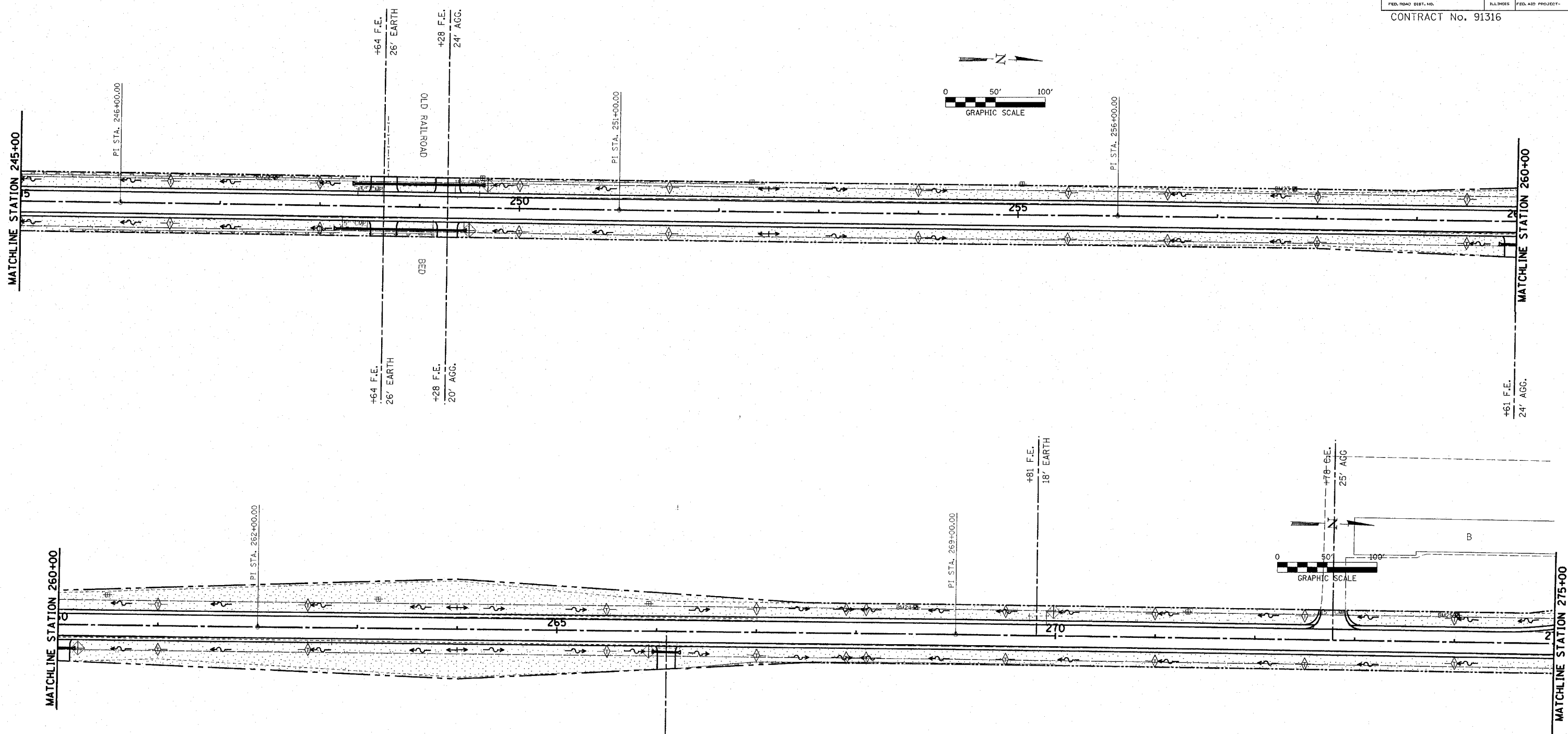

- TYPICAL EROSION CONTROL CONSTRUCTION SEQUENCING
- 1.) INSTALLATION OF SOIL EROSION AND SEDIMENT CONTROL MEASURES
 - A.) SELECTIVE VEGETATION REMOVAL FOR SILT FENCE INSTALLATION
 - B.) SILT FENCE INSTALLATION
 - C.) CONSTRUCTION FENCING AROUND AREA NOT TO BE DISTURBED (IF REQUIRED)
 - D.) STABILIZED CONSTRUCTION ENTRANCE (IF REQUIRED)
 - 2.) TREE REMOVAL WHERE NECESSARY (CLEAR & GRUB)
 - 3.) GRADE SITE
 - 4.) INSTALL CROSS ROAD CULVERT PIPES, STRUCTURES, UNDERDRAINS, ETC.
 - 5.) TEMPORARY STABILIZE ALL GRADING AREAS
 - 6.) INSTALL PAVING AND SHOULDERS
 - 7.) PERMANENTLY STABILIZE ALL GRADING AREAS
 - 8.) REMOVE ALL TEMPORARY EROSION CONTROL MEASURES AFTER THE SITE IS STABILIZED WITH VEGETATION

LEGEND

- STONE RIPRAP, CLASS A4
- PERIMETER EROSION BARRIER
- TEMPORARY DITCH CHECK
- INLET AND PIPE PROTECTION
- SEEDING CLASS 2 (SPECIAL)

HLR
 Rice, Berry and Associates
 A Division of Hampton,
 Lenzi and Renwick, Inc.
 Civil & Structural Engineers
 3085 Stevenson Drive
 Suite 201
 Springfield, Illinois 62703
 217-546-3400
 P.O. Box 1036
 DuQuoin, Illinois 62832
 618-790-4637
 Account Number 03-29-0007-1
 Date: 9-8-03
 DESIGNED: L.F.S. CHECKED: L.F.S. DRAWN: W.J.S.

EROSION CONTROL PLAN
 SECTION 85-00043-00-RS
 C.H. 5
 DEWITT COUNTY