

ROUTE NO.	SECTION	CITY	TOTAL SHEETS	SHEET NO.
KOESTER-COMMERCE PL	04-00000-00-RP	FORSYTH	21	18
FED. ROAD DIST. NO.		ILLINOIS	PROJECT NCPD-0115 (053)	

PAVEMENT MARKING SCHEDULE

	780005102	780005110	780005140	780005150
Letters & Symbols	4" White Foot	4" Yellow Foot	8" Yellow Foot	12" White Foot
KOESTER-COMMERCE				
6' Lt. 23+66.0 - 19' Rt. 23+66.0				24
Lt. & Rt. 24+38.0 - 24+40.0				180
6' Lt. 24+41.0 - 6' Lt. 24+41.0				30
6' Lt. 24+41.0 - 24' Lt. 24+41.0				30
CL 24+36.0 - CL 24+41.0	176			
6' Rt. 24+36.0 - CL 24+41.0		744	147	
CL 24+62.0 - CL 30+51.4		777		
LUCILE AVENUE				
Rt. 36+42.0				24
Lt. & Rt. 36+70.0 - 36+77.0				286
Lt. & Rt. 370+28.0 - 370+30.0				169
Lt. 370+31.0				16
TOTALS	176	30	1571	147
				674

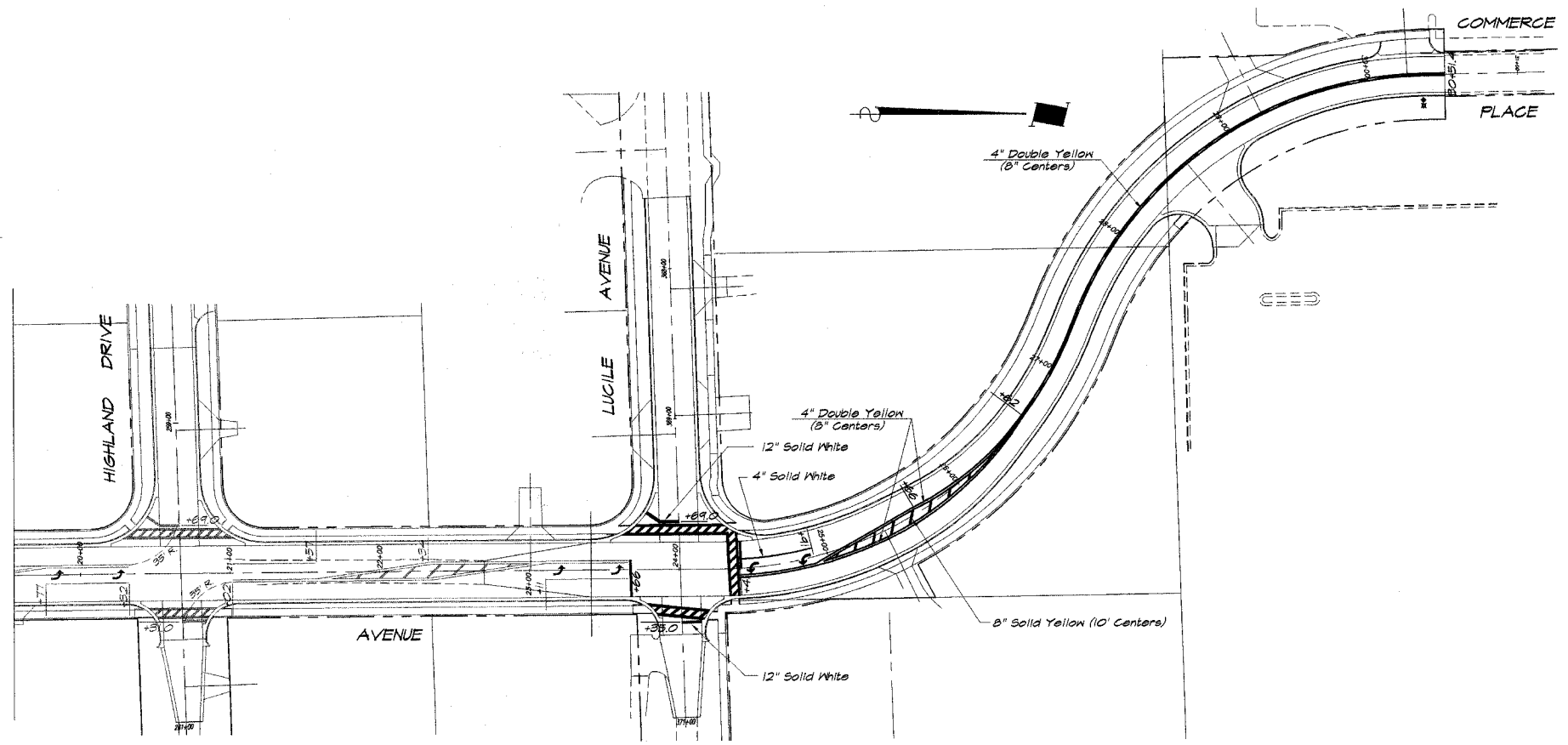
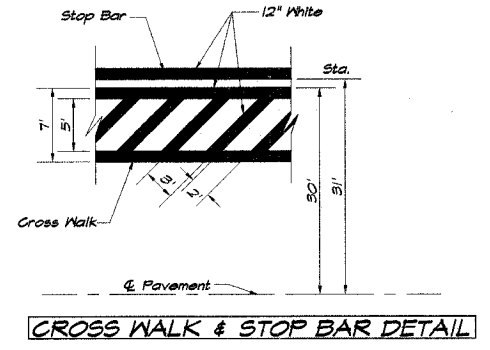
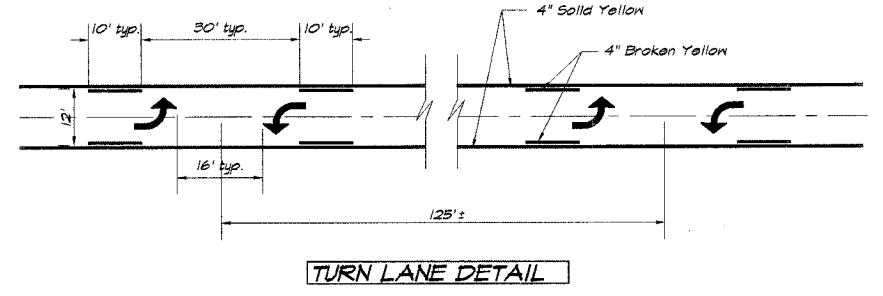

REVISIONS

NO.	BY	DATE

BENBRIDGE & ASSOCIATES, INC.
 Consulting Engineers
 1070 SOUTH TAYLORVILLE ROAD
 DECATUR, ILLINOIS 62526
 Phone: 618-401-2526

DESIGNED: MHP
 DRAWN: Les Jankins
 FIELD BOOK: 146

SCALE: 1" = 50'
 DATE: Oct. 2004
 JOB NO.: 01-0979

VILLAGE OF FORSYTH, ILLINOIS
 COMMERCE PLACE EXTENSION
 PAVEMENT MARKING DETAILS