

STATE OF ILLINOIS DEPARTMENT OF TRANSPORTATION DIVISION OF HIGHWAYS PLANS FOR PROPOSED BRIDGE REPLACEMENT AND REHABILITATION PROGRAM

ROUTE NO. T.R. 112	SECTION 02-23112 -00-BR	COUNTY SHELBY	TOTAL SHEETS 11
FED. ROAD DIST. NO.	ILLINOIS	FED. AID PROJECT-	

CONTRACT NO. 91336

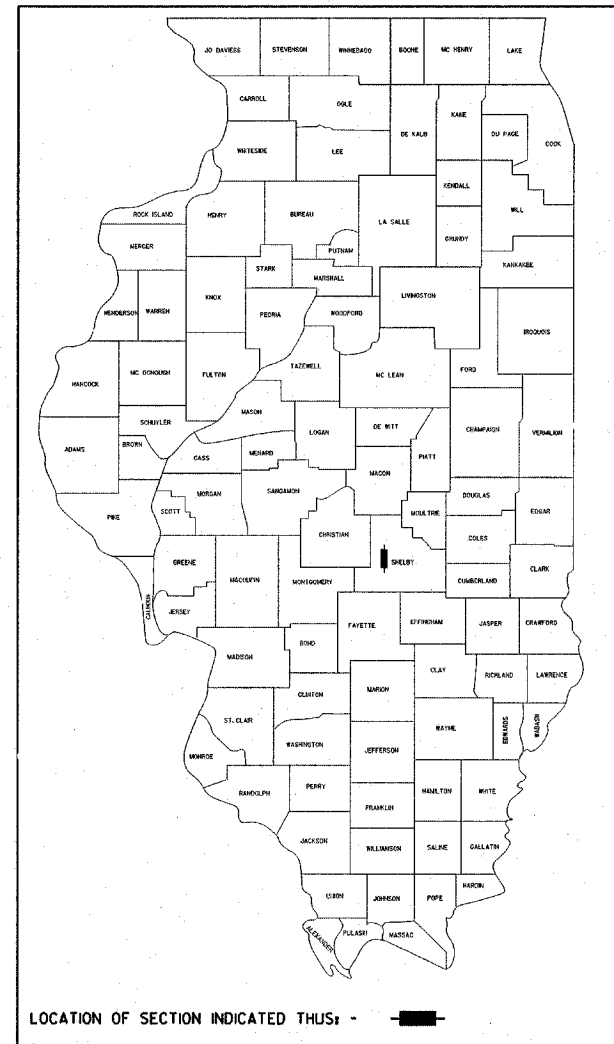

INDEX OF SHEETS

1. COVER SHEET
2. SUMMARY OF QUANTITIES AND TYPICAL CROSS SECTIONS
3. PLAN AND PROFILE
- 4.-6. STATION CROSS SECTIONS
- 7.-10. BRIDGE PLANS
11. BORINGS

HIGHWAY STANDARDS:

- 000001-04 STANDARD SYMBOLS, ABBREVIATIONS AND PATTERNS
- 280001-02 TEMPORARY EROSION CONTROL SYSTEMS
- 515001-02 NAME PLATE FOR BRIDGES
- 630301-03 SHOULDER WIDENING FOR TYPE 1, (SPECIAL) GUARDRAIL TERMINALS
- 631026-02 TRAFFIC BARRIER TERMINAL 5 & 5A
- 702001-05 TRAFFIC CONTROL DEVICES
- BLR 21-6 TYPICAL APPLICATION OF TRAFFIC CONTROL DEVICES FOR CONSTRUCTION ON RURAL LOCAL HIGHWAYS

UTILITIES

SHELBY CO-OP
PO BOX 560
SHELBYVILLE, ILLINOIS 62565
(217) 774-3986
ATTN: JIM MATLOCK

DESIGN FUNCTIONAL CLASSIFICATION:
LOCAL ROAD O-250 ADT
DESIGN TRAFFIC: 150 ADT
DESIGN SPEED: 30 M.P.H.

CONTRACT NO. 91336

SCALES { PLAN 0' = 50'
PROFILE HORIZ. 0' = 50'
PROFILE VERT. 0' = 5'
CROSS SECTIONS 0' = 5'

PROJECT BROS-173(130) SECTION 02-23112-00-BR TOWER HILL ROAD DISTRICT SHELBY COUNTY T.R. 112 JOB NO. C-95-315-05

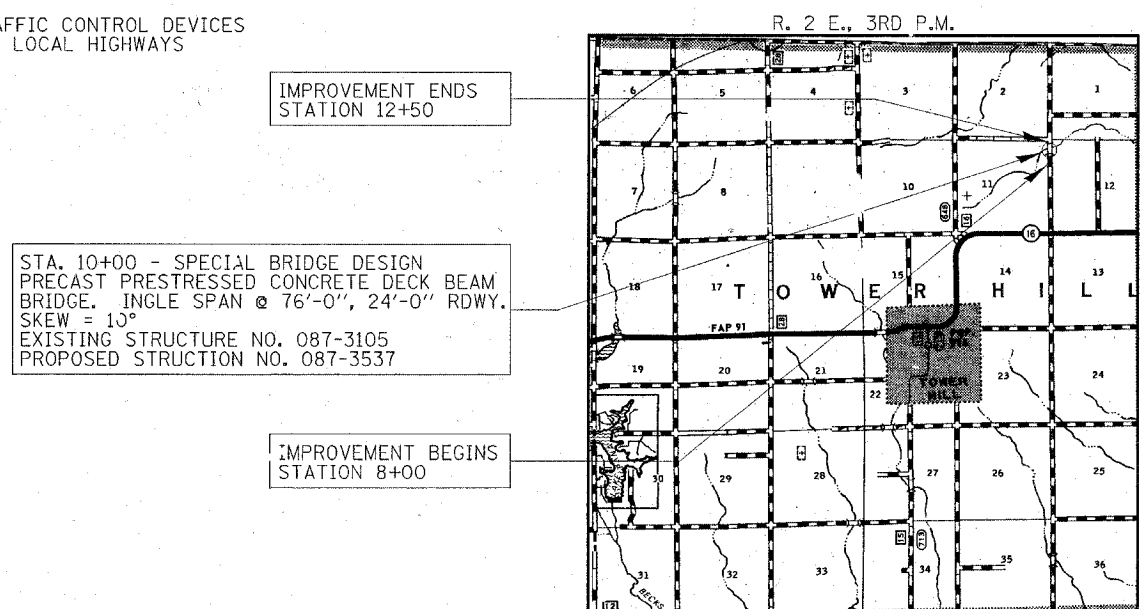

LAYOUT

APPROXIMATE SCALE: 1 MILE

GROSS LENGTH = NET LENGTH OF SECTION = 450 FEET = 0.082 MILES



APPROVED 12-12-05
B. Ah...
COUNTY ENGINEER

APPROVED 12-13-05
Burt Barringer
ROAD COMMISSIONER

PASSED 12/20/05
D...
DISTRICT FIVE ENGINEER OF LOCAL ROADS & STREETS

Releasing For Bid Based on Limited Review Dec 20 2005
Joseph...
DEPUTY DIRECTOR OF HIGHWAYS
REGION THREE ENGINEER
STATE OF ILLINOIS
DEPARTMENT OF TRANSPORTATION

DATE: December 8, 2005

BY: *Steven W. Meigs*

LICENSE EXPIRES: NOVEMBER 30, 2007

LICENSE NO. 50051

STEVEN W. MEGS
SEVEN W. MEGS
SINCE LICENSED PROFESSIONAL ENGINEER OF ILLINOIS

ILR
Rice, Berry and Associates
A Division of Hampton, Lenzini and Renwick, Inc.
Civil & Structural Engineers
3085 Stevenson Drive
Suite 201
Springfield, Illinois 62703
217-546-3400
P.O. Box 1036
DuQuoin, Illinois 62832
618-790-4637

Account Number 12-87-003-1