

DATE: 02/20/23
 SURVEYED: []
 PLOTTED: []
 CHECKED: []
 RT. OF MAG. CHECKED: []
 NO. MAG. HERE: []
 CAD FILE NAME: []

PROFILE
 SURVEYED: []
 PLOTTED: []
 CHECKED: []
 RT. OF MAG. CHECKED: []
 NO. MAG. HERE: []
 CAD FILE NAME: []

PARCEL 001
 EUGENE W. & JEAN SCHMIT TRUST
 NE 1/4, SEC 11, T. 11 N., R. 2 E., 3RD P.M.

PARCEL 002
 EUGENE W. & JEAN SCHMIT TRUST
 W 1/2, NW 1/4, SEC 12, T. 11 N., R. 2 E., 3RD P.M.

T.R.	SECTION	COUNTY	TOTAL SHEETS
112	02-23112-00-BR	SHELBY	11
STA. 5+00		TO STA. 15+00	
FED. ROAD DIST. NO.		ILLINOIS CONTRACT NO. 9133	
TOWER HILL ROAD DISTRICT			

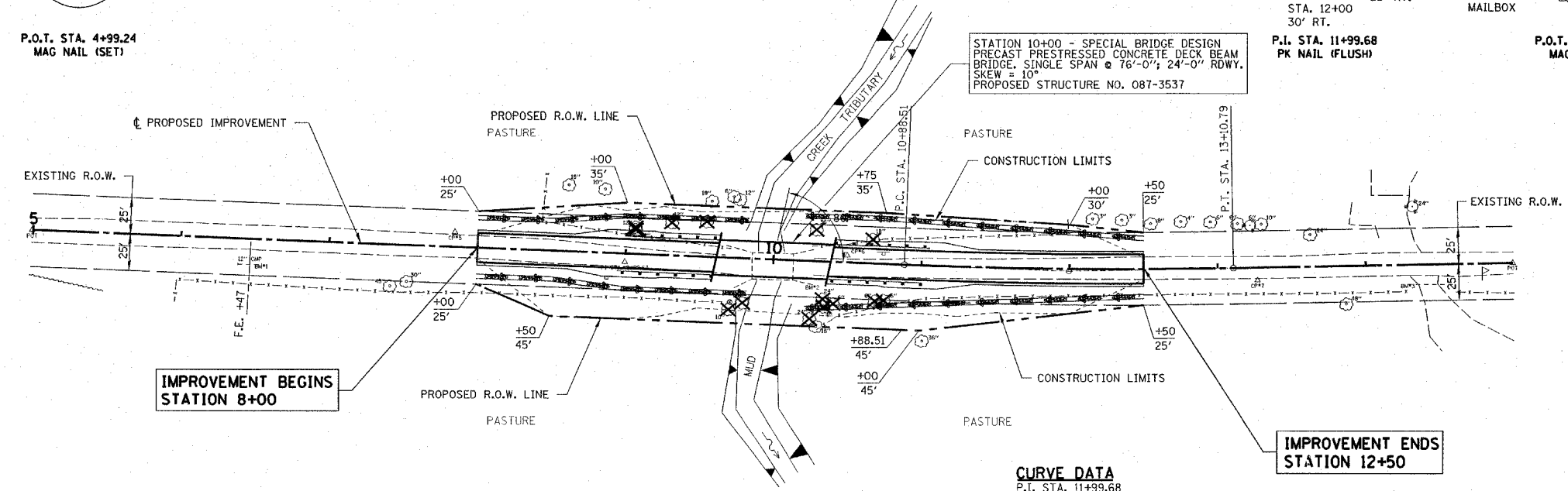
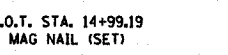
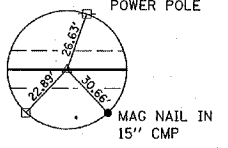
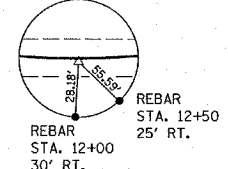
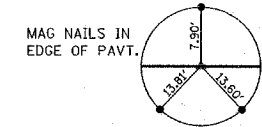

CURVE DATA
 P.I. STA. 11+99.68
 $\Delta = 3^\circ 20' 03''$ (LT)
 $D = 1^\circ 30' 00''$
 $T = 111.17'$
 $R = 3,819.72'$
 $L = 222.28'$
 $E = 1.62'$
 P.C. STA. 10+88.51
 P.T. STA. 13+10.79
 NO CURVE

INDICATES TREES TO BE REMOVED

TEMPORARY DITCH CHECKS
 DITCH CHECK SHALL BE CONSTRUCTED AS DIRECTED BY THE ENGINEER IF EARTH SLOPES TO BE EXPOSED MORE THAN 7 DAYS.

CHANNEL EXCAVATION
 THE CHANNEL SHALL BE EXCAVATED AS SHOWN IN THE PLANS WITH 2:1 SIDE SLOPES WITHIN THE LIMIT OF THE PROPOSED STRUCTURE, THEN TAPER TO THE EXISTING CHANNEL AT THE R.O.W. LINES. ONLY SUITABLE EXCAVATED MATERIAL SHALL BE USED IN THE EMBANKMENT.

EXISTING STRUCTURE NO. 087-3105
 STATION 10+00 - SINGLE SPAN STEEL BEAM BRIDGE WITH CONCRETE DECK ON CLOSED CONCRETE ABUTMENTS AND WINGWALLS. 27'-10" FC-FC, ABUT.; 19'-11" 0-0, DECK. REMOVAL OF EXISTING STRUCTURES = 1 EACH

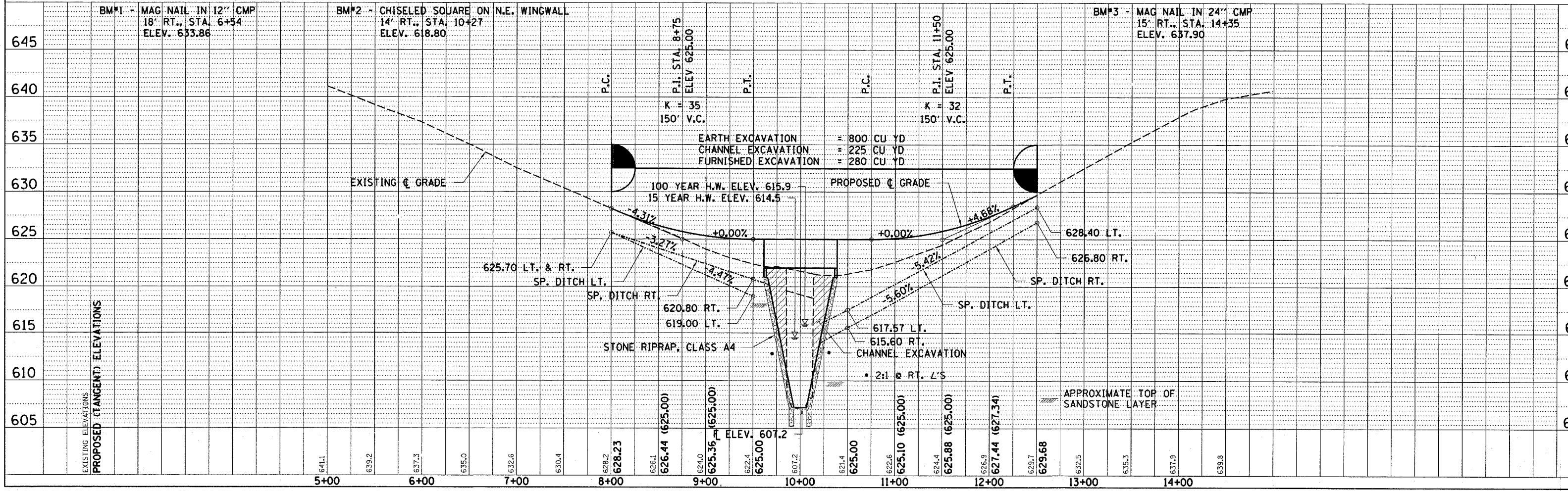
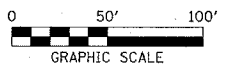

EXISTING ELEVATIONS
 PROPOSED (TANGENT) ELEVATIONS

5+00 6+00 7+00 8+00 9+00 10+00 11+00 12+00 13+00 14+00