

ROUTE NO.	SECTION	COUNTY	TOTAL SHEETS	SHEET NO.
*	JASPER	11	4	
FED. ROAD DIST. NO. 7		BALANCE	FED. AID PROJECT	

\* 05-00100-00-BR

B.M. - SEE PLAN-PROFILE  
 Existing Structure - SEE PLAN-PROFILE  
 Salvage - SEE SPECIAL PROVISIONS

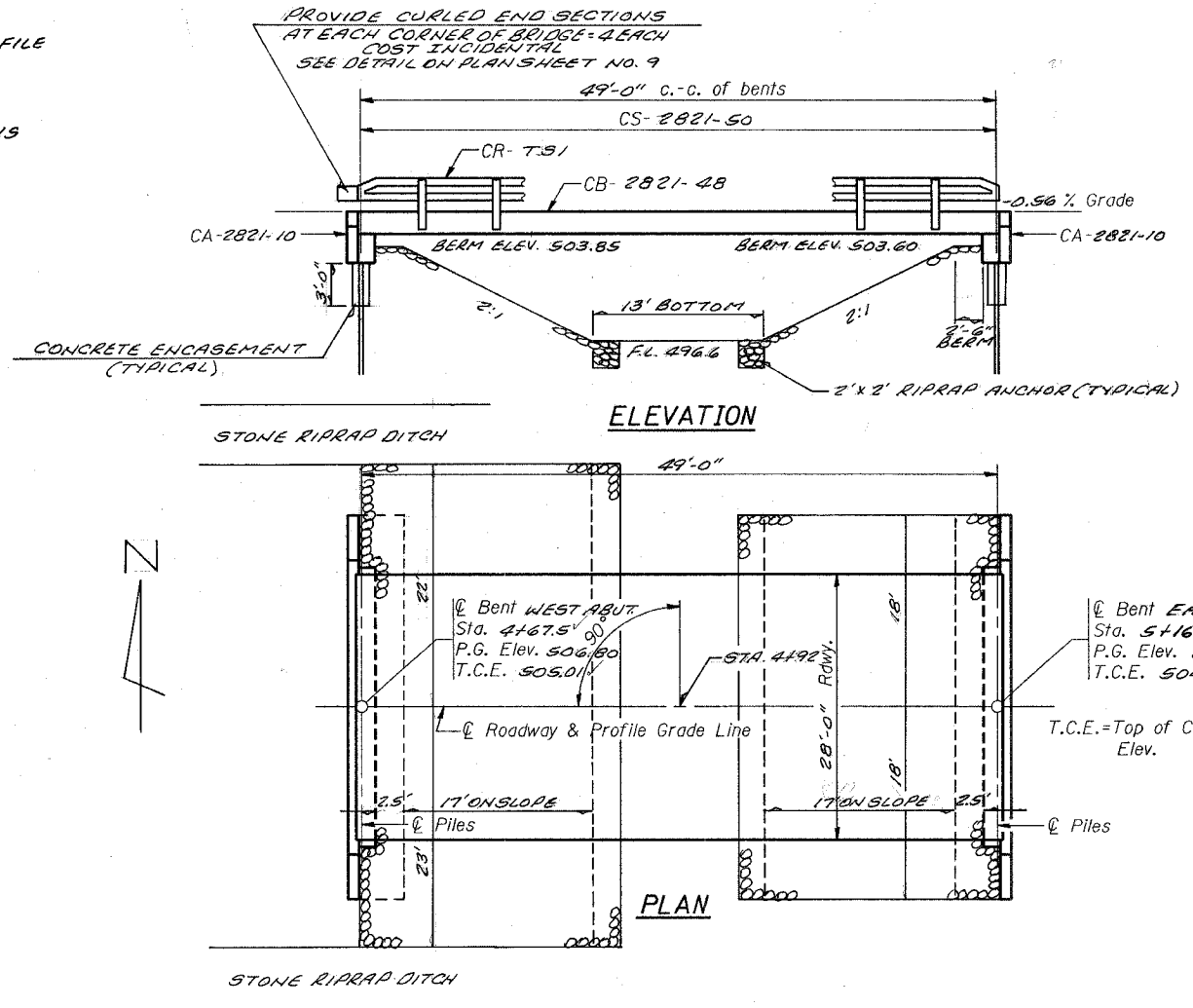

**GENERAL NOTES**

- The Contractor shall drive / test piles, as specified, in a permanent location as directed by the Engineer before ordering the remaining piles.
- See Special Provisions for boring logs.
- A Calcium Nitrite Corrosion inhibitor, as covered in the Special Provisions, shall be used in the concrete for precast prestressed concrete deck beams.

**TOTAL BILL OF MATERIAL**

Item	Unit	Super	Sub.		Total
			Piers	Abuts.	
Removal of Existing Structures	Each				1
Bituminous Concrete Surface Course, Class I	Ton				
Waterproofing Membrane System - Concrete Structures	Sq. Yd.			19.8	19.8
Precast Prestressed Concrete Deck Beams (21" Depth)	Sq. Ft.	1400			1400
Steel Bridge Rail, Type SM	Foot				
Steel Railing, Type S-1	Foot	100			100
Reinforcement Bars	Pound		1940		1940
Furnishing STEEL PILES HP10X42	Foot		252		252
Driving STEEL PILES	Foot		252		252
Test Piles STEEL HP10X42	Each		1		1
Name Plates	Each				1
Class II Concrete Encasement	Cu. Yd.			2.6	2.6
STONE DUMPED RIPRAP CL. AA	TON				108

**NOTE:**  
 The Article or Section numbers referencing the Standard Specifications for Road and Bridge Construction as shown on the standard bridge plan sheets included with the contract plans should be interpreted as referring to the current edition of the Standard Specification (Adopted January 1, 2002) as shown in the "Article/Section No. Reference Table".

**ARTICLE/SECTION NO. REFERENCE TABLE**

Previous No.	Current No.
504.06	504.06
505.04	505.04
706.05	1006.05
706.32	1006.32
760.07	1060.07
STD. 2340	631026

**PILE DATA (2-ABUTS.)**

Type STEEL HP10X42  
 Capacity Tons REFUSAL  
 Estimated Length Feet 28'  
 Number Required 10 (Includes 1 Test Pile located in Bent #1 EITHER ABUT.)

STATION 4+92.1  
 -CREEK-  
 SEC. 05-00100-00-BR BUILT 200  
 HUNT CITY ROAD DIST.  
 JASPER COUNTY  
 LOADING HS20  
 STR. NO. 040-3250

**LETTERING FOR NAME PLATE**

Locate Name Plate at SOUTHWEST Corner of Bridge (See Std. CN)

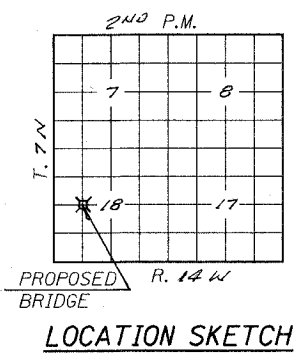

**INDEX OF SHEETS**

- General Plan & Elevation
- Standard CS - 2821 - 50
- Standard CB - 2821 - 48
- Standard CA - 2821 - 10
- Standard CA - 2821 - 10
- Standard CR - 751
- Standard CN
- Standard CX - 1
- Standard

**DESIGN SPECIFICATIONS**

2002 AASHTO, STANDARD SPECIFICATIONS - 17TH ED.  
 HS20-44 Loading. Load Factor Design.

**WATERWAY INFORMATION**

Drainage Area = 371.82 MI. Low Grade Elev. = 505.0 @ Sta. 8+0

Flood	Freq. Yr.	Q C.F.S.	Opening Sq. Ft.		Nat. H.W.E.	Head - Ft.		Headwater El.	
			Exist.	Prop.		Exist.	Prop.	Exist.	Prop.
Design	15	622	165	189	503.6	0.3	0.2	503.9	503.8
Base	100	974	165	217	504.2	0.6	0.6	504.8	504.8
Overtopping									
Max. Calc.	500	1252			504.6		1.0		505.6

**GENERAL PLAN & ELEVATION**

ROUTE 11  
 OVER \_\_\_\_\_  
 SECTION 05-00100-00-BR  
 JASPER COUNTY  
 STATION 4+92