

ROUTE	SECTION	COUNTY	TOTAL SHEETS	SHEET NO.
FAS 1934	93-00017-01-RS	HARDIN	30	5
PROJECT NO. STPSR-1934 (108)			CONTRACT NO. 99171	

CURVE DATA
 $\Delta = 3^{\circ}40'00''$ $T = 111.798$ m
 $R = 3492.773$ m $L = 223.520$ m
 $S.E. = N.C.$ $E = 1.789$ m

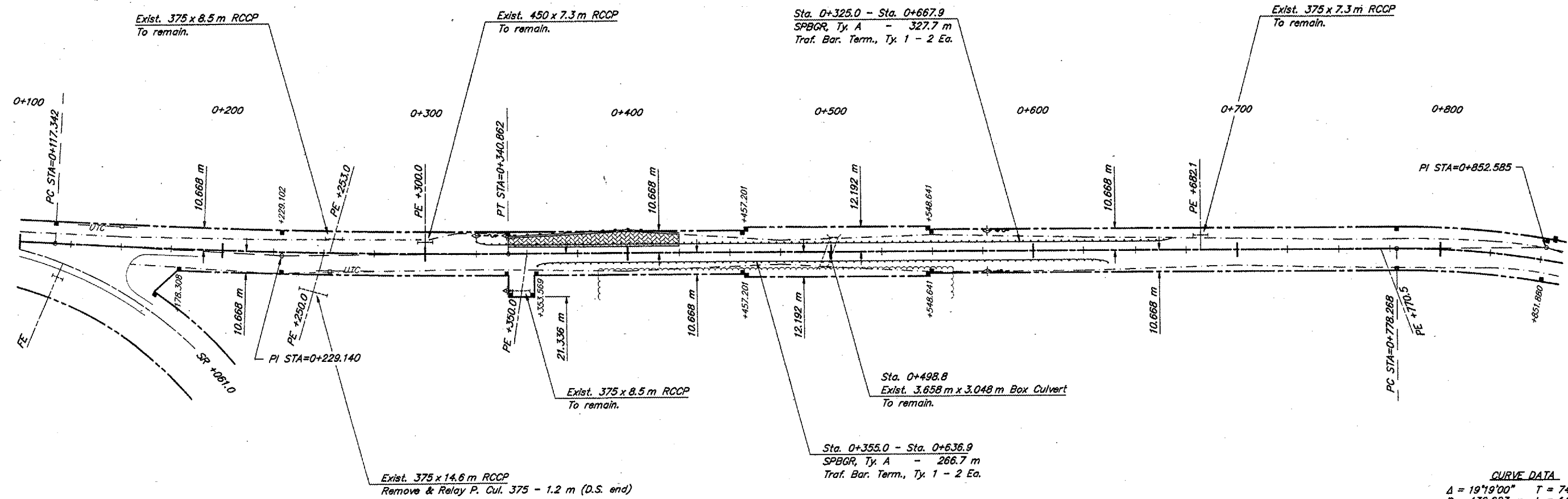
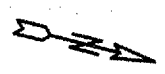

SCALES:
 1:1000 HOR
 1:100 VER
 B.M.#4 - RR Spike in PP
 17.0 m Rt. Sta. 0+161.0
 Elev. 117.615

CURVE DATA
 $\Delta = 19^{\circ}19'00''$ $T = 74.317$ m
 $R = 436.683$ m $L = 147.224$ m
 $S.E. = 6.3\%$ $E = 6.279$ m
 Attain Sta. 0+736.8 - Sta. 0+793.6
 Remove Sta. 0+910.2 - Sta. 0+960.2

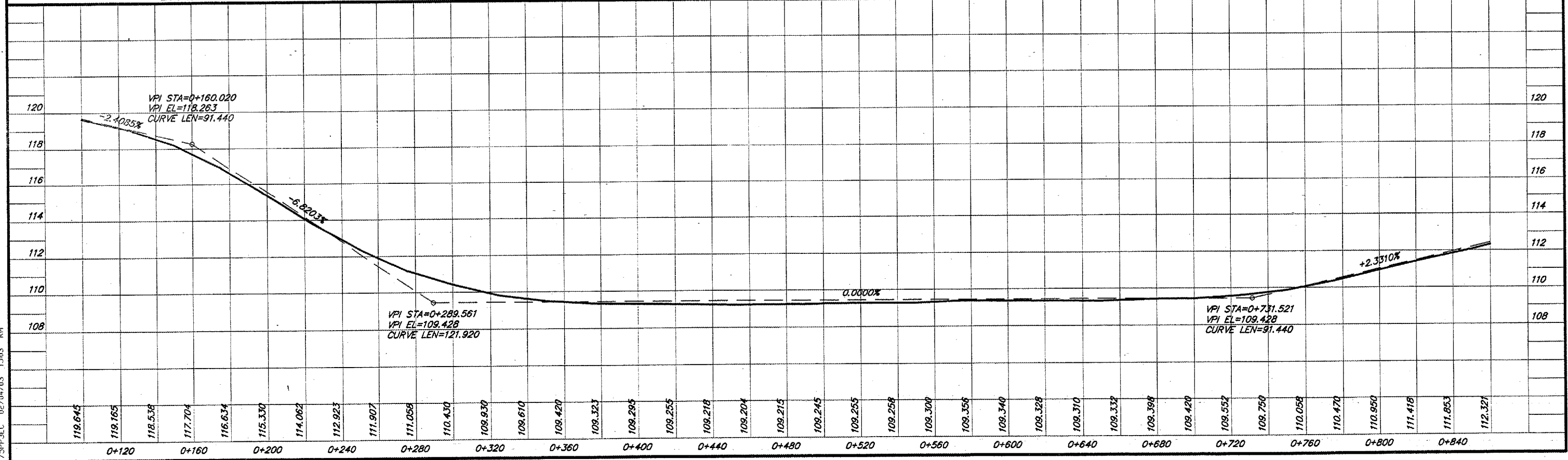

475PP3EC 02/04/03 15:03 RM