

ROUTE	SECTION	COUNTY	TOTAL SHEETS	SHEET NO.
FAS 1934	93-00017-01-RS	HARDIN	30	7
PROJECT NO. STPSR-1934 (108)			CONTRACT NO. 99171	

CURVE DATA
 $\Delta = 10^{\circ}48'00''$ $T = 82.545$ m
 $R = 873.230$ m $L = 164.600$ m
 $S.E. = 3.8\%$ $E = 3.893$ m
 Attain Sta. 1+944.7 - Sta. 2+000.5
 Remove Sta. 2+135.1 - Sta. 2+190.9

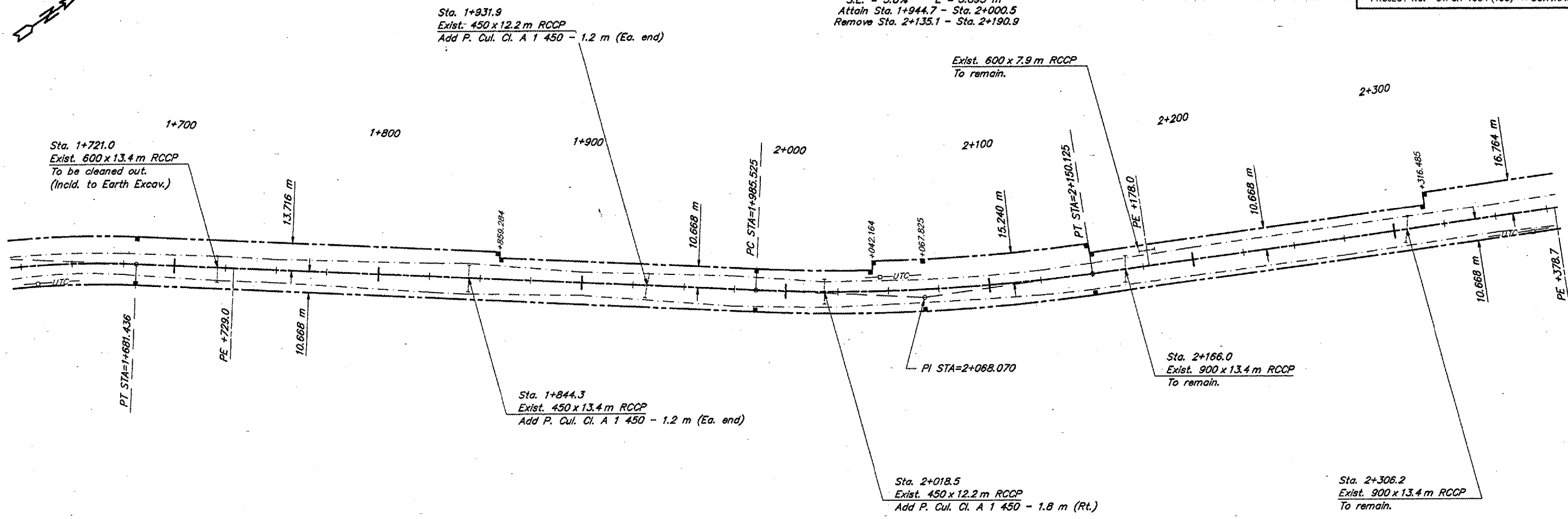

SCALES:
 1:1000 HOR
 1:100 VER

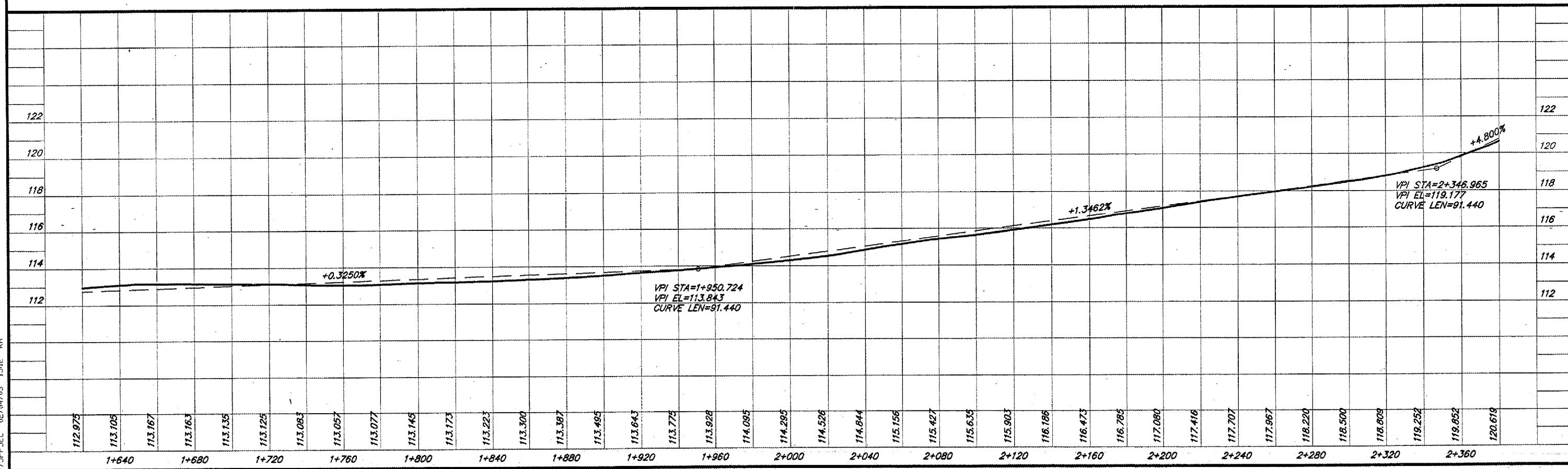

475PPEC 02/04/03 1512 RK