

DU071

PATH: K:\0425704-Apron_Ph4\Sheets
FILE: apron-joint1.dwg
UPDATE BY: johse
SURVEY BOOK #
XREF DWG:
XREF DWG:
DATE: Tue 11/23/04 2:34pm

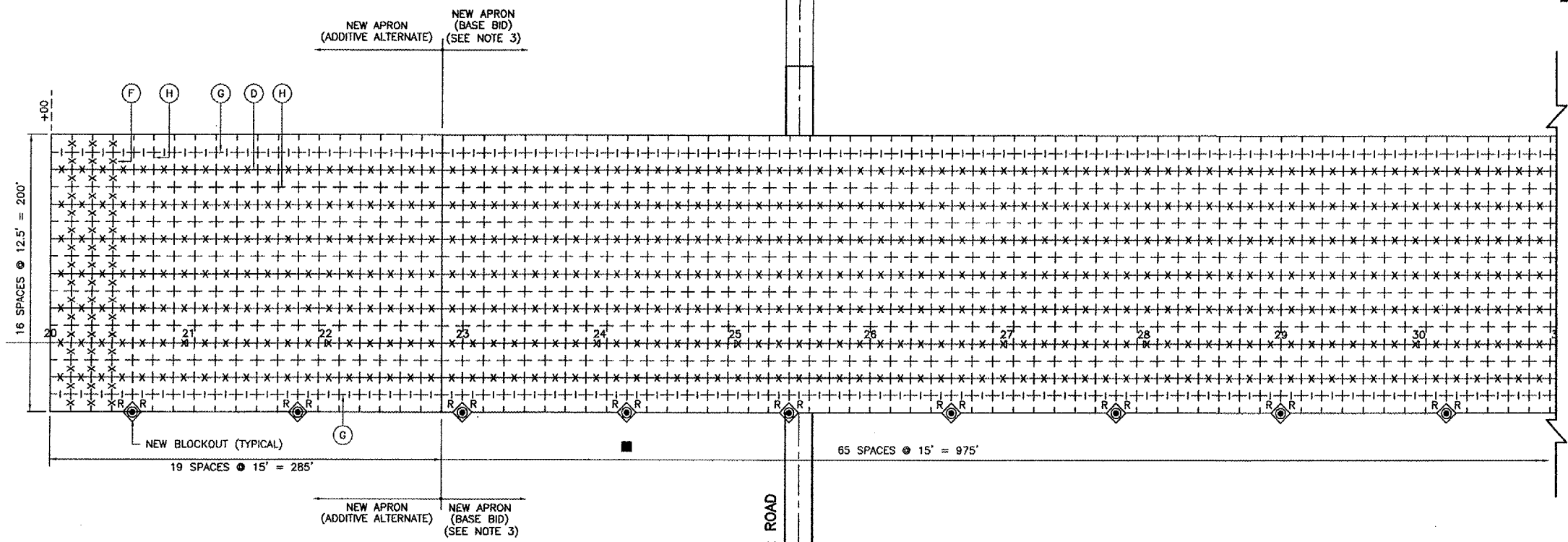

REVISIONS		
NUMBER	BY	DATE

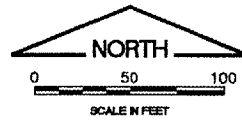
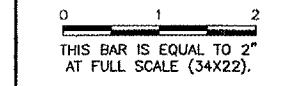

**DUPAGE AIRPORT
WEST CHICAGO, ILLINOIS
SOUTH FLIGHT CENTER APRON - PHASE 4
PAVEMENT JOINTING PLAN**

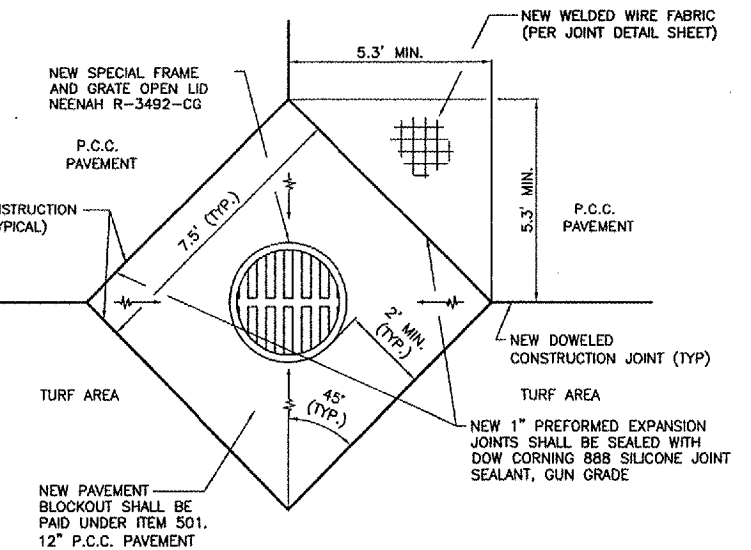
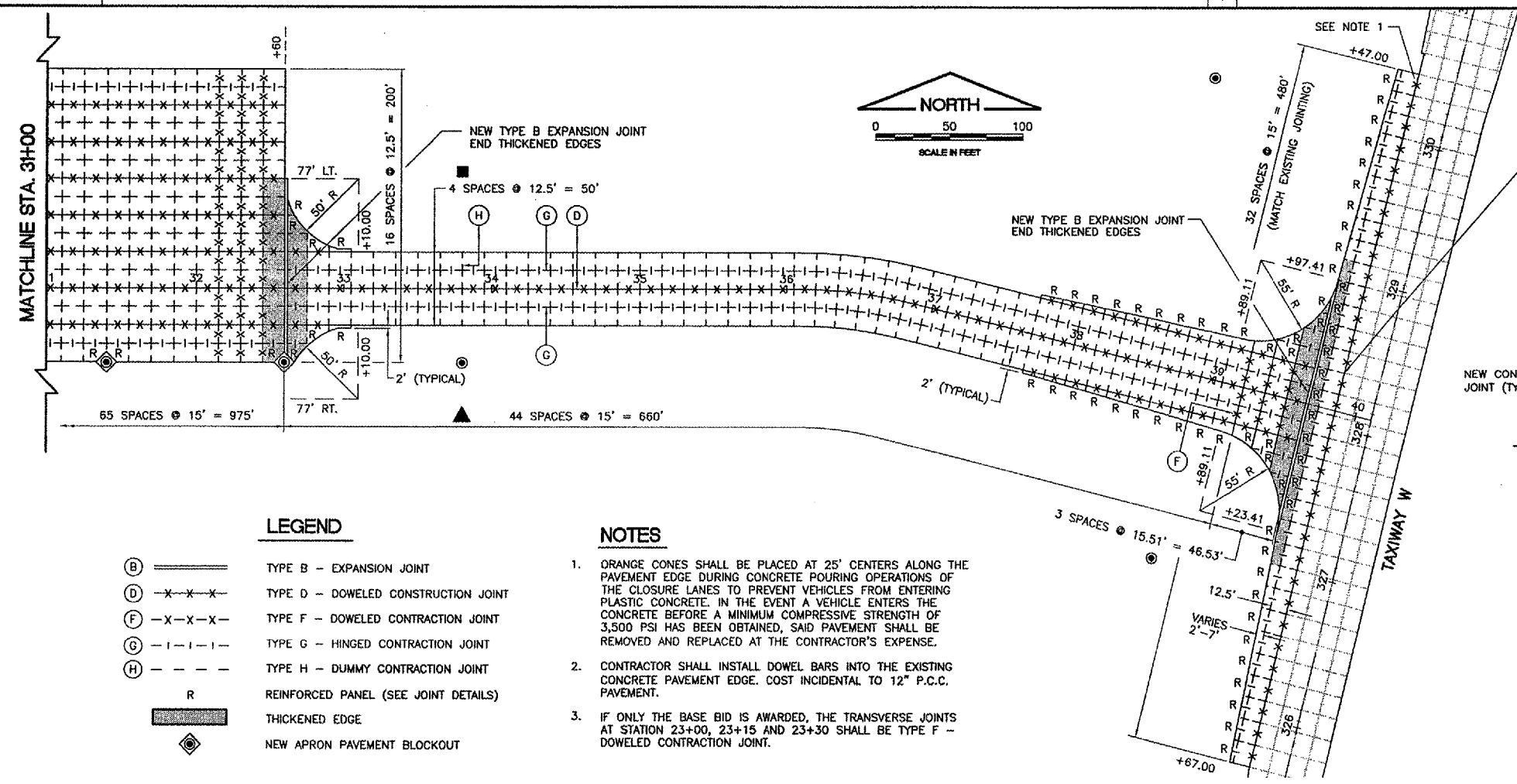

**APRON PAVEMENT BLOCKOUT
DETAIL FOR MANHOLES**

N.T.S.
NOTE: ABOVE BLOCKOUT SHALL BE CONSTRUCTED FOR ALL APRON MANHOLES

LEGEND

- (B) ——— TYPE B - EXPANSION JOINT
- (D) -x-x-x- TYPE D - DOWELED CONSTRUCTION JOINT
- (F) -x-x-x- TYPE F - DOWELED CONTRACTION JOINT
- (G) - - - - - TYPE G - HINGED CONTRACTION JOINT
- (H) - - - - - TYPE H - DUMMY CONTRACTION JOINT
- R REINFORCED PANEL (SEE JOINT DETAILS)
- THICKENED EDGE
- NEW APRON PAVEMENT BLOCKOUT

NOTES

- ORANGE CONES SHALL BE PLACED AT 25' CENTERS ALONG THE PAVEMENT EDGE DURING CONCRETE POURING OPERATIONS OF THE CLOSURE LANES TO PREVENT VEHICLES FROM ENTERING PLASTIC CONCRETE. IN THE EVENT A VEHICLE ENTERS THE CONCRETE BEFORE A MINIMUM COMPRESSIVE STRENGTH OF 3,500 PSI HAS BEEN OBTAINED, SAID PAVEMENT SHALL BE REMOVED AND REPLACED AT THE CONTRACTOR'S EXPENSE.
- CONTRACTOR SHALL INSTALL DOWEL BARS INTO THE EXISTING CONCRETE PAVEMENT EDGE. COST INCIDENTAL TO 12" P.C.C. PAVEMENT.
- IF ONLY THE BASE BID IS AWARDED, THE TRANSVERSE JOINTS AT STATION 23+00, 23+15 AND 23+30 SHALL BE TYPE F - DOWELED CONTRACTION JOINT.

© Copyright CMT, Inc.
CMT
CRANFORD, MURPHY & TILLY, INC.
CONSULTING ENGINEERS
License No. 184-000618



DESIGN BY:	MJS/JRL
DRAWN BY:	JRO
CHECKED BY:	MJS / DKP
APPROVED BY:	MJS
DATE:	01/13/06
JOB No:	04257-04-00-00
A.I.P. PROJECT:	3-17-0017-B18
ILLINOIS PROJECT:	OPA-3391
SHEET	11 OF 36 SHEETS