

AIRFIELD VAULT NOMENCLATURE

- ① EXISTING 430 KW (537.5 KVA) STAND-BY GENERATOR SET.
- ② EXISTING 800A, 480V, 3Ø UTILITY MAIN DISCONNECT.
- ③ EXISTING 800A, 480V, 3Ø AUTOMATIC TRANSFER SWITCH.
- ④ EXISTING 800A, 480V, 3Ø GENERATOR SET MAIN DISCONNECT.
- ⑤ EXISTING 20BY/120 VAC, 3Ø, 4W, LIGHTING PANEL.
- ⑥ EXISTING 75 KVA, 480-208Y/120 VAC TRANSFORMER.
- ⑦ EXISTING 480V, 3Ø POWER DISTRIBUTION PANEL PDP-2.
- ⑧ EXISTING 480V, 3Ø POWER DISTRIBUTION PANEL PDP-1.
- ⑨ EXISTING 480V, 3Ø, 480V DELTA TO 480Y/277 VAC TRANSFORMER.
- ⑩ EXISTING 480Y/277V POWER DISTRIBUTION PANEL.
- ⑪ EXISTING HIGH VOLTAGE "HOMERUN" WIREWAY. (SEE NOTE 2)
- ⑫ EXISTING 480 VAC, 10 KW, RW 15-33 REGULATOR.
- ⑬ EXISTING 480 VAC, 10 KW RUNWAY 10/28 REGULATOR.
- ⑭ PROPOSED 30KW, 480V, 5-STEP, 6.6 AMP, L-828 SPARE AIRFIELD LIGHTING REGULATOR #1. REGULATOR SHALL BE SIEMENS TO MATCH EXISTING REGULATORS IN VAULT. CONTRACTOR SHALL TERMINATE EXISTING GROUND, PRIMARY, SECONDARY AND CONTROL WIRING TO PROPOSED REGULATOR.**
- ⑮ NOT USED
- ⑯ EXISTING 480 VAC, 10 KW, RUNWAY 1R/19L REGULATOR.
- ⑰ EXISTING 480 VAC, 20 KW, RUNWAY 1L/19R REGULATOR.
- ⑱ EXISTING 480 VAC, 30 KW, RUNWAY 1L/19R CENTERLINE REGULATOR.
- ⑲ EXISTING 480 VAC, 30 KW, RUNWAY 1L/19R TOUCHDOWN ZONE REGULATOR.
- ⑳ EXISTING 480 VAC, 30 KW, SPARE REGULATOR TO BE DISCONNECTED AND RELOCATED TO ⑳.**
- ㉑ EXISTING 480 VAC, 30 KW, SPARE REGULATOR #2.
- ㉒ EXISTING 480 VAC, 30 KW, TAXIWAY X REGULATOR.
- ㉓ EXISTING 480 VAC, 30 KW, TAXIWAY W REGULATOR.
- ㉔ EXISTING 480 VAC, 20 KW, TAXIWAY R REGULATOR.
- ㉕ EXISTING 480 VAC, 15 KW, TAXIWAY G REGULATOR.
- ㉖ EXISTING 480 VAC, 15 KW, TAXIWAY E REGULATOR.
- ㉗ EXISTING 480 VAC, 10 KW, TAXIWAY B-SOUTH REGULATOR.
- ㉘ EXISTING 480 VAC, 10 KW, TAXIWAY B-NORTH REGULATOR.
- ㉙ EXISTING 480 VAC, 10 KW, TAXIWAY C REGULATOR.
- ㉚ EXISTING 480 VAC, 15 KW, TAXIWAY C, D, E-EAST REGULATOR.
- ㉛ RELOCATED 30 KW REGULATOR.**
- ㉜ EXISTING SPARE REGULATOR.
- ㉝ EXISTING SPARE REGULATOR.
- ㉞ EXISTING WORK BENCH.
- ㉟ NOT USED
- ㊱ EXISTING L-854 RADIO CONTROLLER.
- ㊲ EXISTING PLC CONTROL CABINET. TERMINATE PROPOSED 5-STEP REGULATOR CONTROL WIRES. SEE VAULT CONTROL DETAIL SHEETS.
- ㊳ EXISTING 8" x 8" HIGH VOLTAGE (5 KV) WIREWAY.
- ㊴ EXISTING 8" x 8" LOW VOLTAGE (600V) WIREWAY.
- ㊵ **PROPOSED 5#12 THWN. IN EXISTING CONDUIT FOR CONTROL OF PROPOSED 5-STEP REGULATOR.**

REVISIONS

NUMBER	BY	DATE

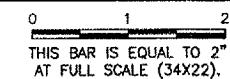

DUPAGE AIRPORT
 WEST CHICAGO, ILLINOIS
 SOUTH FLIGHT CENTER APRON - PHASE 4

AIRFIELD VAULT PLAN

© Copyright CMT, Inc.
CMT
 CRAWFORD, MURPHY & TULLY, INC.
 CONSULTING ENGINEERS
 License No. 384-000613



DESIGN BY:	AB
DRAWN BY:	JRO
CHECKED BY:	AB
APPROVED BY:	AB
DATE:	01/13/06
JOB No:	04257-04-00-00

A.I.P. PROJECT: 3-17-0017-B18
 ILLINOIS PROJECT: DPA-3391

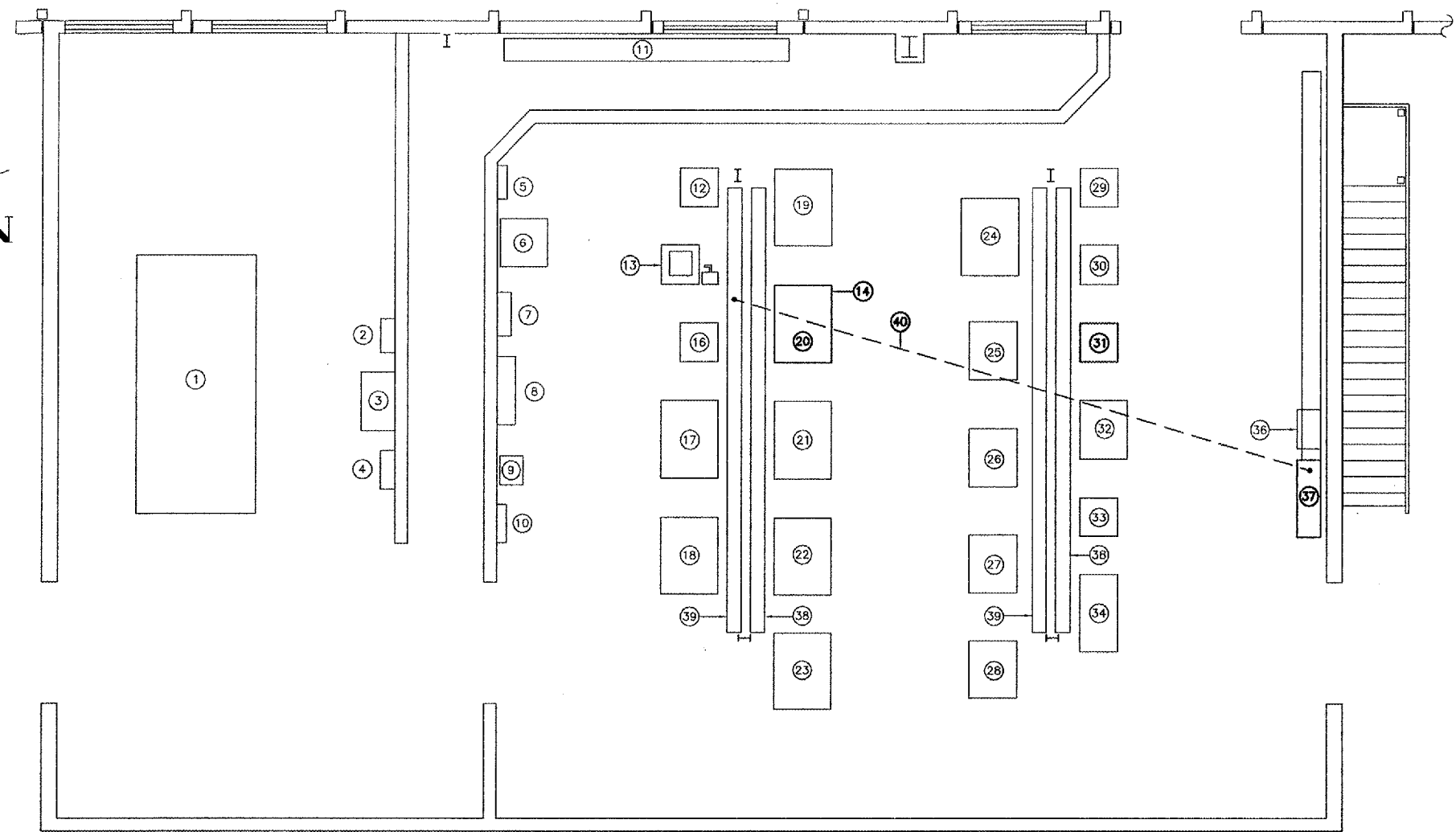

PROPOSED AIRFIELD VAULT MODIFICATIONS

1/4"=1'-0"

NOTES:

1. ALL PROPOSED WORK OR ITEMS BEING MODIFIED ARE SHOWN IN BOLD. ALL OTHER ITEMS SHOWN ARE FOR INFORMATIONAL PURPOSES ONLY.
2. INSTALL L-823 CONNECTORS TO TERMINATE PROPOSED 30KW REGULATOR CABLES TO INSIDE THE HIGH VOLTAGE WIREWAY FOR FUTURE USE.