

DU071

K:\DupageAp\0425704-Apron_Ph4\Draw
 FILE: apron-index.dwg
 LAYOUT: Layout1
 UPDATE BY: jinke
 SURVEY BOOK #
 DATE: Wed 1/18/06 2:20pm
 XREF DWG: apronbase.dwg
 tbcnt.dwg
 tb.dwg
 p-topo.dwg

LOCATION	TOPSOIL STRIPPING INITIAL POSITION (CUBIC YARDS)	TOPSOIL PLACEMENT FINAL POSITION (CUBIC YARDS)	SHOULDER FILL FINAL POSITION (CUBIC YARDS)	UNCLASSIFIED EXCAVATION INITIAL POSITION (CUBIC YARDS)	EMBANKMENT FILL FINAL POSITION (CUBIC YARDS)
APRON	30,297	7,258	7,789	34,165	43,410
DITCH	3,072	1,630	-	14,438	-
TOTAL	33,369	8,888	7,789	48,603	43,410

NUMBER	BY	DATE

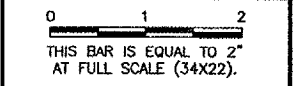

EARTHWORK NOTES

- ALL EARTHWORK QUANTITIES ARE CALCULATED BASED ON THE MATERIAL IN ITS INITIAL OR FINAL POSITION AS SHOWN IN THE PLANS AND QUANTIFIED BY THE METHOD OF AVERAGE END AREAS.
- AREAS OF UNSUITABLE MATERIAL (UNCLASSIFIED EXCAVATION) SHALL BE AS DESIGNATED BY THE ENGINEER. THE QUANTITY OF UNSUITABLE MATERIAL SHALL NOT BE USED AS EMBANKMENT FILL MATERIAL UNLESS AUTHORIZED BY THE ENGINEER.
- UNCLASSIFIED EXCAVATION IS THE SUM OF TOPSOIL STRIPPING AND UNCLASSIFIED EXCAVATION AND IS TO BE PAID FOR UNDER ITEM NO. AR152410 IN ITS INITIAL POSITION.
- ALL HAUL ROADS TO BE CONSTRUCTED FOR THE PROJECT WILL NOT BE MEASURED FOR PAYMENT BUT SHALL BE CONSIDERED INCIDENTAL TO THE PROJECT.
- SURPLUS MATERIAL SUITABLE FOR USE AS SELECT FILL CAN BE STOCKPILED ON-SITE. EXACT LOCATION SHALL BE DETERMINED BY THE ENGINEER.
- CONTRACTOR'S HAUL ROADS TO THE SITE SHALL BE RESTORED WITH 4" MINIMUM OF TOPSOIL PLACED. ALL HAUL ROAD RESTORATION SHALL BE INCIDENTAL TO THE CONTRACT AND NO SEPERATE PAYMENT SHALL BE MADE.
- TOPSOIL PLACEMENT, EMBANKMENT FILL AND SHOULDER FILL ARE INCIDENTAL TO UNCLASSIFIED EXCAVATION (ITEM AR152410). NO SEPERATE PAYMENT WILL BE MADE FOR TOPSOIL PLACEMENT AND SHOULDER FILL.
- IT IS THE INTENT OF THE EARTHWORK / GRADING TO PLACE ALL USEABLE CLAY AS EMBANKMENT FILL. DEPENDING ON ACTUAL SWELL / SHRINK FACTORS OBSERVED IN THE FIELD, THE ENGINEER MAY MODIFY THE GRADING PLAN TO BALANCE CLAY. A QUANTITY OF TOPSOIL TO BE DETERMINED IN THE FIELD MAY BE SPREAD EAST OF FREEDOM DRIVE AND GRADED TO DRAIN BY THE CONTRACTOR. (COST INCLUDED TO UNCLASSIFIED EXCAVATION) ANY EXCESS TOPSOIL SHALL BE HAULED OFFSITE BY THE CONTRACTOR. (COST INCLUDED TO UNCLASSIFIED EXCAVATION)
- IF ONLY THE BASE BID IS AWARDED, THE ENGINEER MAY PROVIDE THE CONTRACTOR WITH REVISED CROSS SECTIONS AND EARTHWORK SUMMARY.

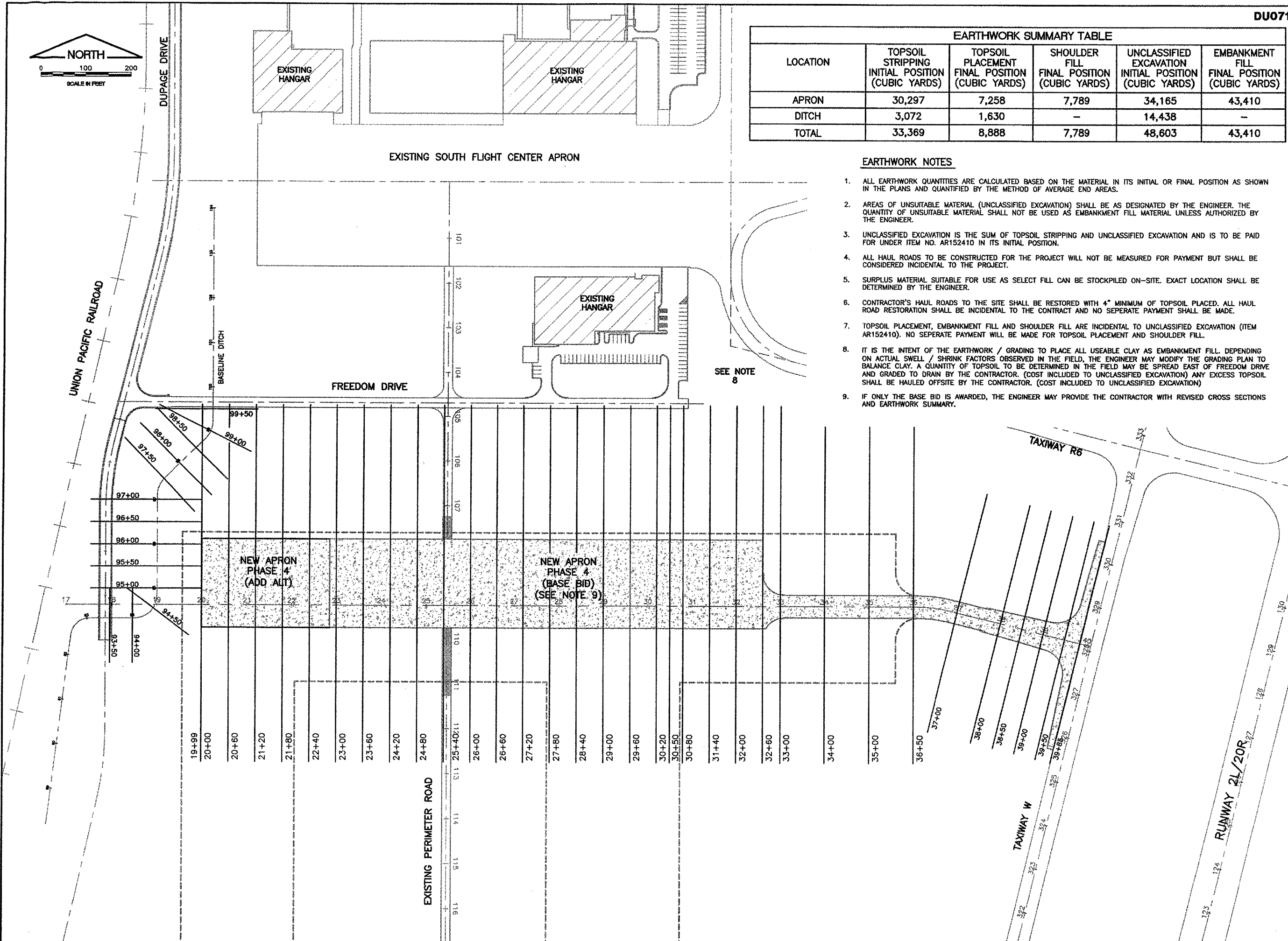

DUPAGE AIRPORT
 WEST CHICAGO, ILLINOIS
 SOUTH FLIGHT CENTER APRON - PHASE 4
 INDEX TO CROSS SECTIONS

© Copyright CMT, Inc.

CMT
 CRAWFORD, MURPHY & TILLY, INC.
 CONSULTING ENGINEERS
 License No. 184-000618

DESIGN BY:	JWD / JRL
DRAWN BY:	JRO
CHECKED BY:	MJS / DKP
APPROVED BY:	MJS
DATE:	01/13/06
JOB No:	04257-04-00-00
A.I.P. PROJECT:	3-17-0017-818
ILLINOIS PROJECT:	DPA-3391
SHEET 28 OF 36 SHEETS	