

2W

STATE OF ILLINOIS
DEPARTMENT OF NATURAL RESOURCES
OFFICE OF WATER RESOURCES

DES PLAINES RIVER - RAND PARK FLOOD CONTROL

PHASE III

FLOODWALL, BERM AND BIKE TRAIL

DES PLAINES, ILLINOIS
COOK COUNTY

FR-416
2006

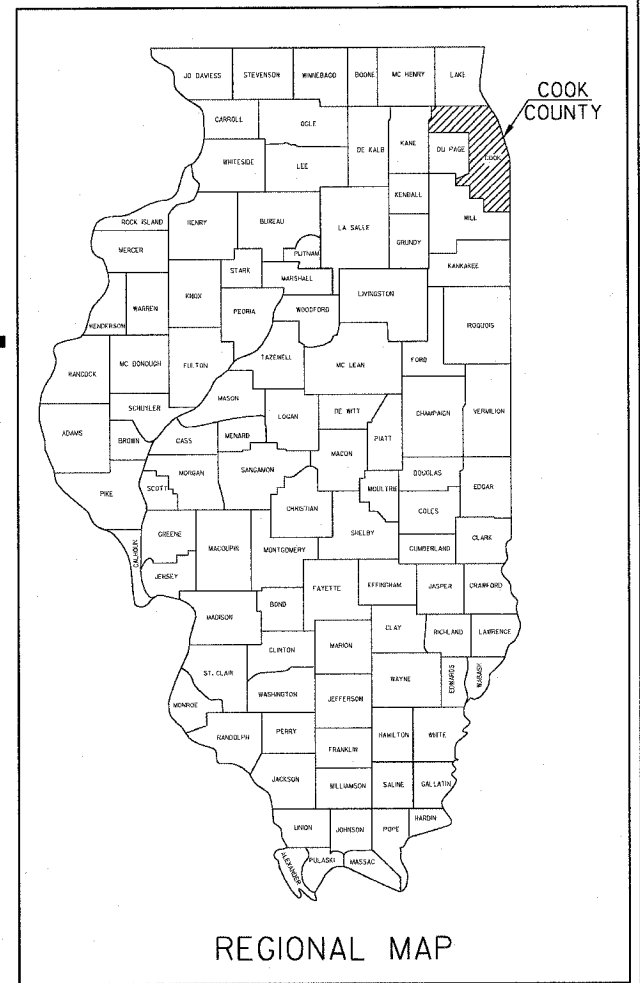

REGIONAL MAP



David R. Handwerk
DAVID R. HANDWERK
PROJECT MANAGER
11/30/07
EXPIRES
01/31/06
DATE



Patrick J. O'Brien
PATRICK J. O'BRIEN
1 - 88
SHEET NOS.
11/30/07
EXPIRES
01/31/06
DATE



Brian J. Malone
BRIAN J. MALONE
92 - 94, 97 - 106, 120 - 154
SHEET NOS.
11/30/06
EXPIRES
01/31/06
DATE



Kirk H. Higgs
KIRK H. HIGGS
89 - 91
SHEET NOS.
11/30/07
EXPIRES
01/31/06
DATE



Donald E. Sieracki
DONALD E. SIERACKI
155 - 167
SHEET NOS.
11/30/07
EXPIRES
01/31/06
DATE



Safdar A. Gill
SAFDAR A. GILL
95 - 96, 107 - 119
SHEET NOS.
11/30/06
EXPIRES
01/31/06
DATE

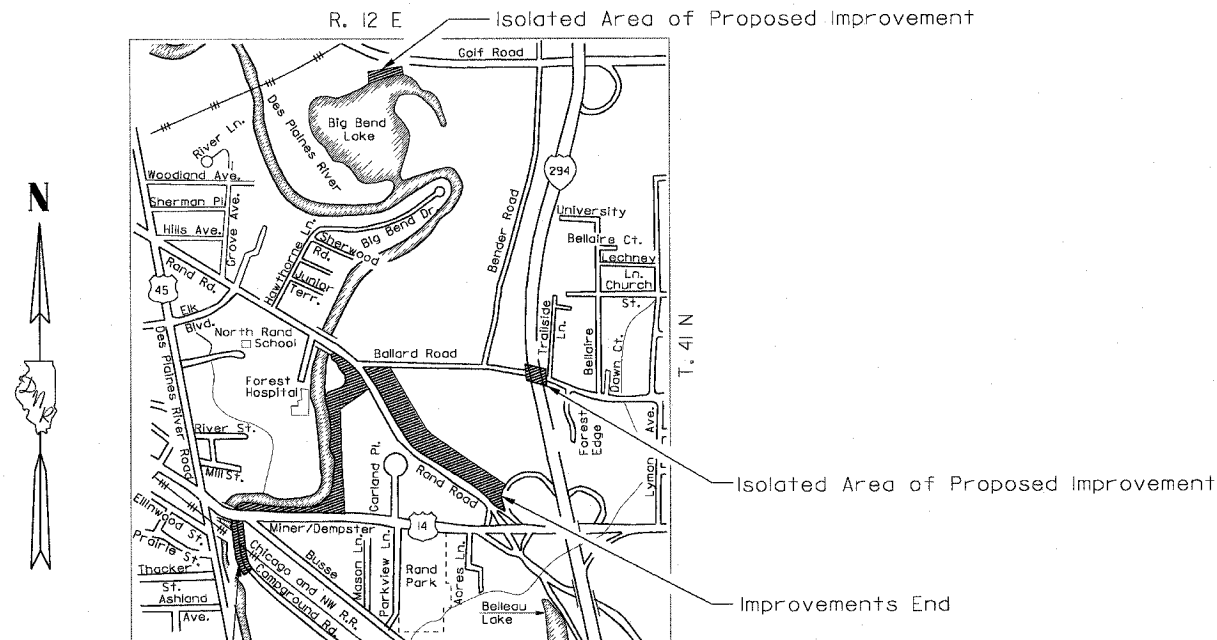

Improvements Begin

Areas of Proposed Improvements
indicated by hatching

LOCATION MAP

SCALE

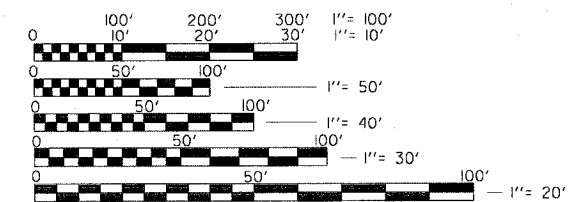
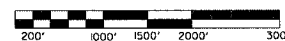

FULL SIZE PLANS HAVE BEEN PREPARED USING STANDARD
ENGINEERING SCALES, REDUCED SIZED PLANS WILL NOT
CONFORM TO STANDARD SCALES, IN MAKING MEASUREMENTS
ON REDUCED PLANS, THE ABOVE SCALES MAY BE USED.

CTE | AECOM

CTE
303 East Wacker Drive, Suite 600, Chicago, Illinois 60601-5276
T 312.938.0300 F 312.938.1109 www.cte.aecom.com

SUBMITTED BY *William J. Schuch* DATE 2/2/06
MANAGER, DIVISION OF PROJECT IMPLEMENTATION
APPROVED BY *Sam R. Clark* DATE 2/3/06
DIRECTOR

FOR INDEX OF SHEETS AND STANDARDS, SEE SHEET G-2