

STAGE I CONSTRUCTION ACTIVITIES

1. WATER MAIN RELOCATION AT BIKE TRAIL CULVERT
2. AMERITECH TELEPHONE / FIBER OPTIC DUCT RELOCATION (BY OTHERS) AT BIKE TRAIL CULVERT
3. SOUTH HALF OF BIKE TRAIL CAST-IN-PLACE CULVERT AND HEADWALL
4. BIKE TRAIL STEEL SHEET PILE WITH CONCRETE CAP-RETAINING WALL CONSTRUCTION
5. BIKE TRAIL CONSTRUCTION SOUTH OF MINER STREET
6. CAMPGROUND ROAD IMPROVEMENTS
7. CAMPGROUND ROAD FLOODWALL

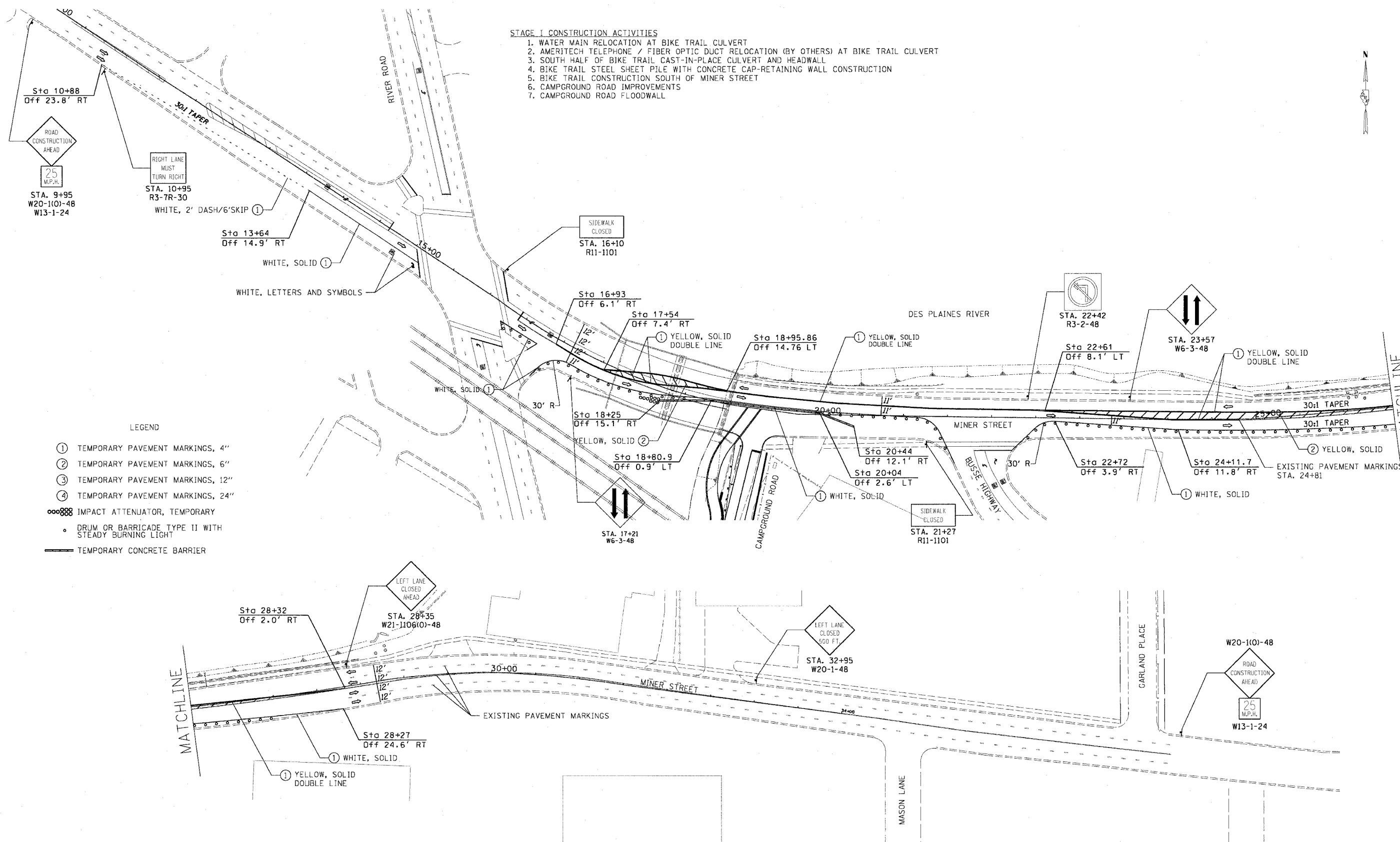

LEGEND

- ① TEMPORARY PAVEMENT MARKINGS, 4"
- ② TEMPORARY PAVEMENT MARKINGS, 6"
- ③ TEMPORARY PAVEMENT MARKINGS, 12"
- ④ TEMPORARY PAVEMENT MARKINGS, 24"
- IMPACT ATTENUATOR, TEMPORARY
- DRUM OR BARRICADE TYPE II WITH STEADY BURNING LIGHT
- TEMPORARY CONCRETE BARRIER

MINER STREET MAINTENANCE OF TRAFFIC MIXTURE REQUIREMENTS

ITEM	AC TYPE	VOIDS	RAP %
* BITUMINOUS BASE COURSE, SUPERPAVE	PC 58-22	2% @ 50 Gry	50

* TEMPORARY PAVEMENT

NOTE: NO COORDINATE INFORMATION HAS BEEN PROVIDED FOR THE ALIGNMENT SHOWN ON THIS SHEET. THIS ALIGNMENT WAS CREATED USING AERIAL SURVEY THAT HAS NO CONTROL. THIS ALIGNMENT IS USED TO SHOW THE APPROXIMATE LOCATION OF TRAFFIC CONTROL ITEMS.

01/30/2006 10:31:18 AM P:\P60003332\Civil\SH\mot_sfg_150.sht

DESIGNED BY: _____ CHECKED BY: _____
DRAWN BY: _____