

BORING NO. WS-1		BORING NO. WS-2		BORING NO. WS-3		BORING NO. WS-4	
Elev. N	Description	Elev. N	Description	Elev. N	Description	Elev. N	Description
629.4 18	Dk. brn. ORGANIC silty CLAY little c-f sand.	629.6 10	Brn. c-f SAND, little SILT, medium.	629.7 9	Brn. ORGANIC silty Clay, some c-f sand.	629.6 5	Yell. brn. c-f SAND, some m-f GRAVEL, trace loose to medium.
626.8 21	Yell. brn. c-f SAND and m-f Gravel, trace Silt, medium to dense.	627.0 22	Gray brn. silty CLAY (-) little of Sand; hard.	626.1 8	Gray brn. silt, trace Clay, some c-f Sand, little GRAVEL, medium or very stiff.	626.2 14	Gray brn. silty CLAY, some c-f sand; very stiff.
623.4 15	Stratum of clayey Silt; hard.	624.6 27		623.7 16		623.6 13	
621.6 23		622.0 23	Brn. c-f SAND, trace m-f Gravel, trace Silt; medium.	621.1 25		621.2 22	Yell. brn. m-f GRAVEL, and c-f Sand; medium.
619.4 22		619.6 27		618.7 18		618.6 19	
616.8 28		617.0 21		616.1 26	Gray brn. clayey SILT, some c-f Sand, very stiff.	616.2 20	
614.4 28		614.6 23		613.7 27		612.6 25	
611.8 29		612.0 26		611.1 28		612.2 27	
610.4 32		610.6 27		609.7 20	Gray brn. silty CLAY, little c-f Sand; hard.		
608.6 39	Gray brn. clayey SILT, some c-f SAND, little f GRAVEL, very stiff to hard, very dense.	608.6 20	Gray brn. SILT, trace Clay, little m-f Sand; dense to very dense with increasing depth. (hard).	606.7 40		602.2 44	Gray brn. clayey SILT, some c-f Sand, trace f Gravel; very stiff to hard (very dense).
600.4 182		602.6 111			Gray SILT, trace Clay, some c-f Sand; very dense.	601.2 80	
595.4 200	Gray brn. SILT, trace Clay, some f Sand; very dense.	593.8 64		592.7 27			
		590.6 51		589.7 124	Gray brn. clayey SILT, little c-f Sand, trace Gravel; hard or very dense.		
		585.8 52		584.7 25			
		580.6 20	Gray brn. clayey SILT, little c-f Sand; hard.	579.7 22			

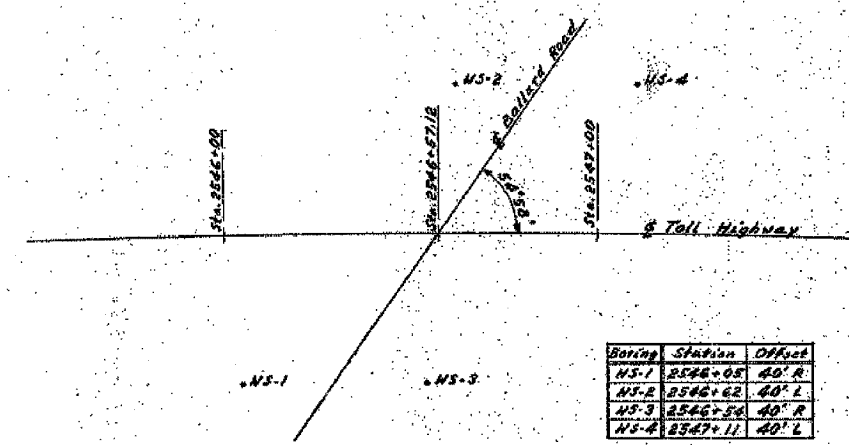

Boring	Station	Offset
WS-1	2546+08	40' R
WS-2	2546+62	40' L
WS-3	2546+58	40' R
WS-4	2547+11	40' L

**NOTE:**  
N<sup>o</sup> Relative Density - Number of blows required to drive 1 1/2" A.S. 1 1/2" O.D. sample spoon 12" with 140 lb weight falling 30"

ILLINOIS STATE TOLL HIGHWAY COMMISSION  
NORTHERN ILLINOIS TOLL HIGHWAY

TRI-STATE ROUTE  
BRIDGE T 9-8  
ARRYING TOLL HIGHWAY  
OVER BALLARD ROAD  
STATION 2546 +57.12

BORING LOGS

CONTRACT T 9-B

H. W. LOCHNER, INC.  
Consulting Engineers  
CHICAGO, ILLINOIS

SCALE AS SHOWN DATE REVISED SHEET 16 OF 16 DWG. NO. T 9-8

**NOTES:**  
The soil borings were taken during the original construction of I-294 over Ballard Road in the 1950s. The soil borings set forth the subsurface ground conditions at the location of the test boring at the time the boring was obtained. This soil boring information is being made available for the convenience of the prospective bidders; however, the Contractor shall plan his work based on his own subsurface information or knowledge of such.

REVISION	
DATE	DESCRIPTION

DESIGNED BY: AAG  
DRAWN BY: RJ  
CHECKED BY: DPV  
CHECKED BY: AAG/DPV

Designed By: W.K.  
Drawn By: W.K.  
Checked By: B.S.T.

PLANS PREPARED BY:  
**CTE | AECOM**  
CTE  
303 East Wacker Drive, Suite 600, Chicago, Illinois 60601-5276  
T 312.938.0300 F 312.938.1109 www.cte.aecom.com

SCALE: NONE  
**SBC-3** FR-416