

U.S.G.S. B.M. ~ NW corner Rand and
Dempster No. 44 W Elev. 632.00

STATE OF ILLINOIS
DEPARTMENT OF PUBLIC WORKS & BUILDINGS
DIVISION OF HIGHWAYS

STATE AID	SEC	COUNTY	TOTAL SHEETS	SHEET NO.
123	0101	COOK	18	16
200 RAND PARK FLOOD CONTROL PROJECT 338, 783				

SHEET NO. 1
1 SHEETS

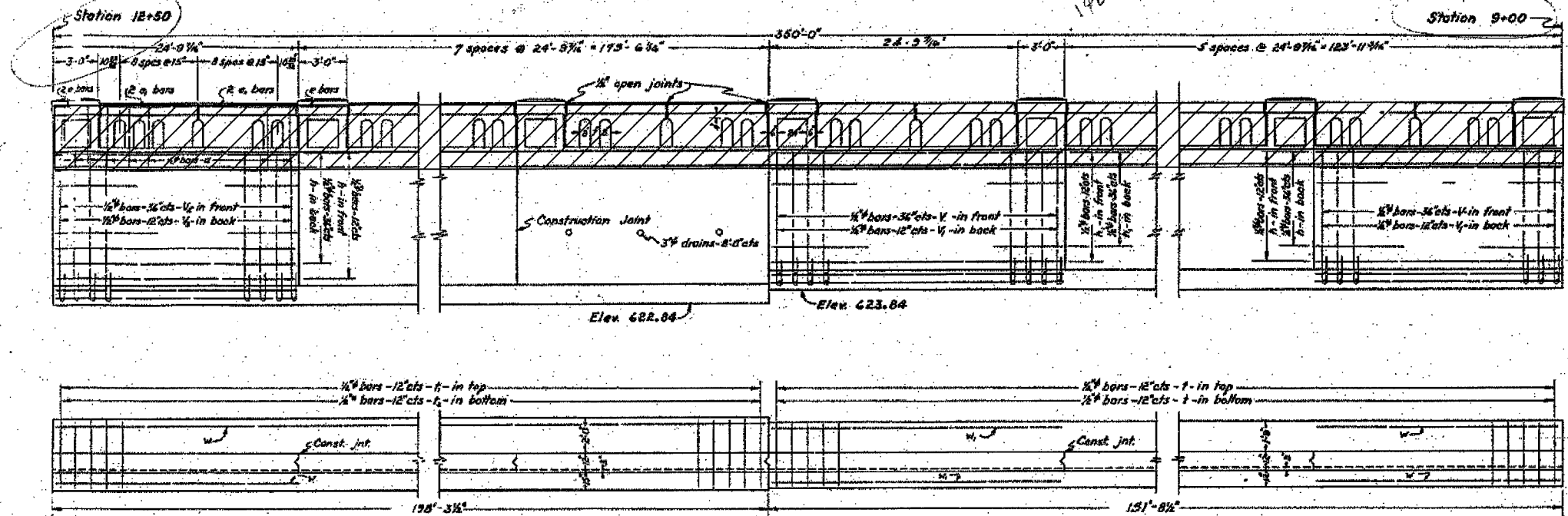

Class X Concrete to be used throughout.
All reinforcing steel to be wired securely
in place before concrete is poured.
Wall to be built parallel to E. of roadway.

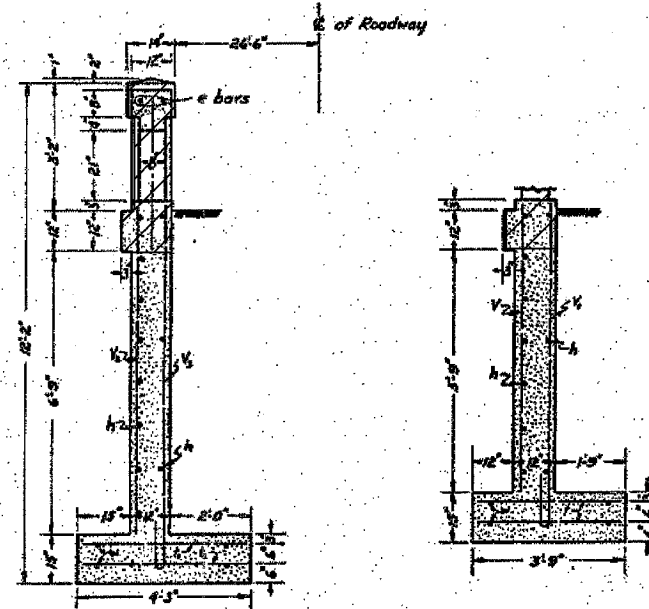

BILL OF MATERIAL

Bar	No.	Size	Length
V	153	#4	4'-9"
W	155	-	8'-9"
X	200	-	7'-9"
Y	200	-	5'-9"
Z	145	#5	24'-6"
A	9	-	27'-6"
B	30	#6	3'-0"
C	54	-	10'-6"
D	207	-	3'-9"
E	208	#6	3'-6"
F	209	-	4'-0"
G	205	#6	4'-0"
H	35	-	26'-6"
I	4	-	27'-6"

Reinforcing Steel Lbs. 11,110
Randall Concrete Cu. Yds. 21.6
Class X Concrete Cu. Yds. 156.6

NO 203-E
RETAINING WALL
STATE AID RTE. 123 ~ SEC. 0101-NRS-1
COOK COUNTY
STA. 9+00 to 12+50

DESIGNED BY: MA	CHECKED BY: AAG
DRAWN BY: RJ	CHECKED BY: AAG

STANDARD	COMPUTED	BY: J.H. Thompson
	CHECKED	BY: J.H. Thompson
	DRAWN	BY: J.H. Thompson
	CHECKED	BY: J.H. Thompson
SPECIAL	ASSEMBLED	BY: J.H. Thompson
	CHECKED	BY: J.H. Thompson

EXAMINED	2-10-39
BY:	H.F. Dunch
FIELD	H.C. Thompson
APPROVED	Carl Robinson

NOTE:
Removal of Existing Structure as shown on this sheet is included
in the pay item for Removal of Existing Structures.

LEGEND:
[Hatched Box] - Indicates existing concrete to be Demolished.

REVISION	
DATE	DESCRIPTION

PLANS PREPARED BY:
CTE | AECOM

CTE
303 East Wacker Drive, Suite 600, Chicago, Illinois 60601-5276
T 312.938.0300 F 312.938.1109 www.cte.aecom.com