

THE LOCATION, SIZE AND TYPE OF MATERIAL OF EXISTING UNDERGROUND UTILITIES INDICATED ON THE PLANS IS NOT REPRESENTED AS BEING ACCURATE, SUFFICIENT OR COMPLETE. IT SHALL BE THE CONTRACTOR'S RESPONSIBILITY TO DETERMINE THE ACTUAL LOCATION OF ALL SUCH FACILITIES, INCLUDING SERVICE CONNECTIONS TO UNDERGROUND UTILITIES. PRIOR TO CONSTRUCTION, THE CONTRACTOR SHALL NOTIFY THE UTILITY COMPANIES OF HIS OPERATIONAL PLANS AND SHALL OBTAIN FROM THE RESPECTIVE UTILITY COMPANIES DETAILED INFORMATION AND ASSISTANCE RELATIVE TO THE LOCATION OF THEIR FACILITIES AND THE WORKING SCHEDULE OF THE COMPANIES FOR REMOVAL OR ADJUSTMENT WHERE REQUIRED. IN THE EVENT AN UNEXPECTED UTILITY INTERFERENCE IS ENCOUNTERED DURING CONSTRUCTION, THE CONTRACTOR SHALL IMMEDIATELY NOTIFY THE UTILITY COMPANY OF JURISDICTION. THE ENGINEER SHALL ALSO BE IMMEDIATELY NOTIFIED. ANY SUCH MAINS AND SERVICES SHALL BE RESTORED TO SERVICE AT ONCE AND PAID FOR BY THE CONTRACTOR AT NO ADDITIONAL COST TO THE CONTRACT.

CALL J.U.L.I.E. FOR UTILITY INFORMATION AT 1-800-892-0123.

LEGEND

- EXISTING PAVEMENT
- EXISTING BUILDINGS
- EXISTING ELECTRICAL CABLES
- EXISTING ELECTRICAL DUCT
- PROPOSED IMPROVEMENTS
- PROPOSED ELECTRICAL DUCT
- PROPOSED 1/C NO. 8, 5KV, U.G. CABLE IN U.D.
- EXISTING ELECTRICAL TRANSFORMER
- EXISTING ELECTRICAL PEDESTAL
- EXISTING DUCT MARKERS
- EXISTING CABLE MARKERS
- EXISTING ROTATING BEACON
- EXISTING ELECTRICAL HANDHOLE
- EXISTING STAKE MOUNTED TAXIWAY LIGHT
- EXISTING BASE MOUNTED TAXIWAY LIGHT
- EXISTING WIND CONE
- EXISTING WIND TEE
- PROPOSED ELECTRICAL VAULT
- PROPOSED ELECTRICAL HANDHOLE
- PROPOSED ELECTRICAL TRANSFORMER
- PROPOSED STAKE MOUNTED TAXIWAY LIGHT
- PROPOSED BASE MOUNTED TAXIWAY LIGHT

NOTE

ABANDONMENT AND/OR REMOVAL OF EXISTING RUNWAY OR TAXIWAY LIGHTING CABLES SHALL BE INCIDENTAL TO ITEM AR108158 1/C NO. 8, 5KV, U.G. CABLE IN U.D.

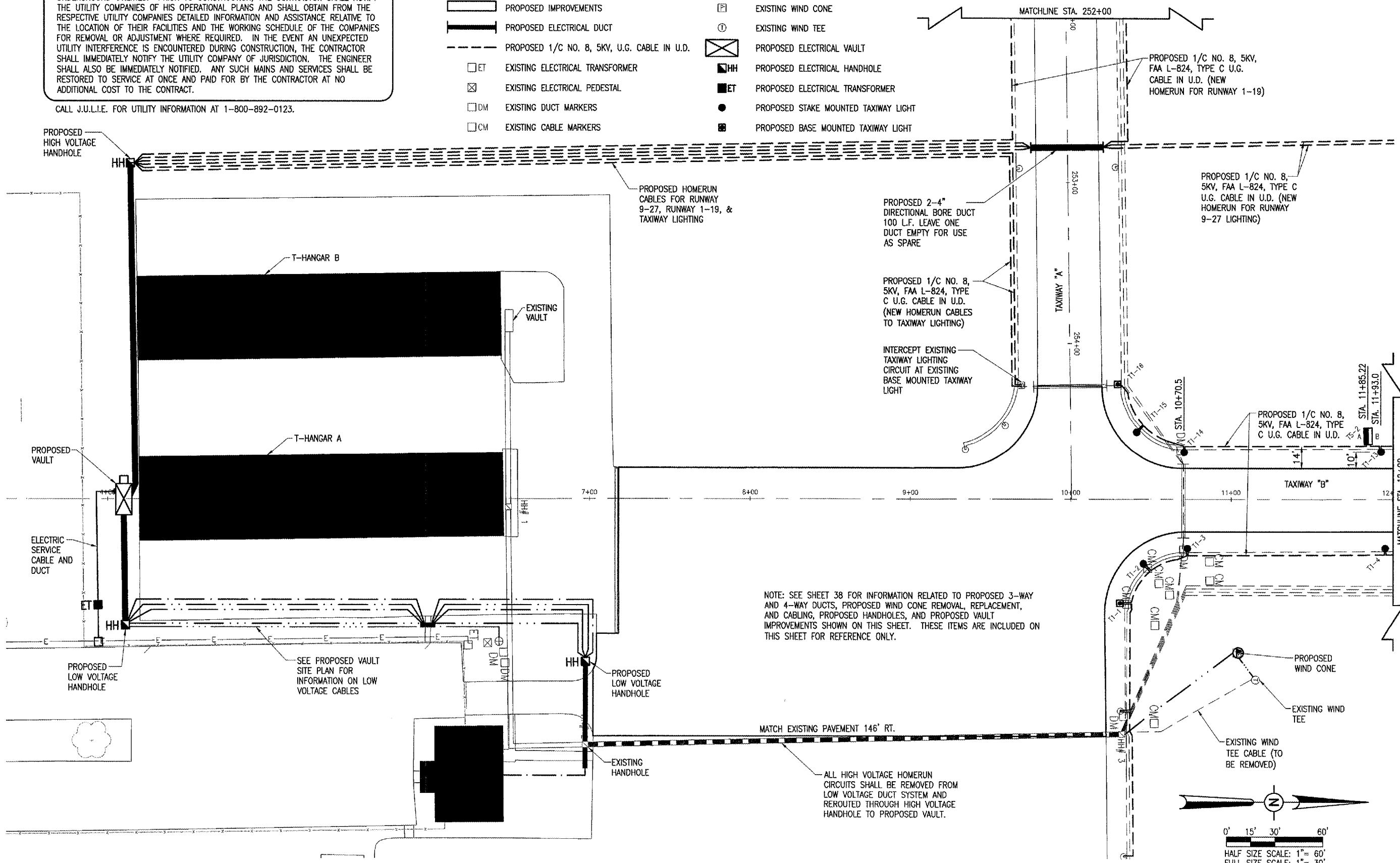

NOTE: SEE SHEET 38 FOR INFORMATION RELATED TO PROPOSED 3-WAY AND 4-WAY DUCTS, PROPOSED WIND CONE REMOVAL, REPLACEMENT, AND CABLING, PROPOSED HANDHOLES, AND PROPOSED VAULT IMPROVEMENTS SHOWN ON THIS SHEET. THESE ITEMS ARE INCLUDED ON THIS SHEET FOR REFERENCE ONLY.

MATCH EXISTING PAVEMENT 146' RT.
ALL HIGH VOLTAGE HOMERUN CIRCUITS SHALL BE REMOVED FROM LOW VOLTAGE DUCT SYSTEM AND REROUTED THROUGH HIGH VOLTAGE HANDHOLE TO PROPOSED VAULT.

DATE	REVISION	BY

Kewanee Municipal Airport, Illinois
Kewanee, Henry County, Illinois
A.I.P. PROJ.: 3-17-0058-B10
I.L. PROJ.: E2-3533

LAYOUT	R.A.W.	08/02/05
DRAWN	B.A.K.	08/02/05
REVIEWED	C.A.H.	xx/xx/xx

HANSON
Hanson Professional Services Inc.
3125 Dancy Trail, Suite 100
Indianapolis, Indiana 46214
Offices Nationwide

OVERLAY TXY & APRON CONSTRUCT VAULT
PROPOSED ELECTRICAL PLAN
STA. 4+00 TO STA. 12+00

JAN 18, 2006 10:46 PM RAW
I:\AIRPORTS\KEWANEE\810-051\X'D\AIRPORT\SHETS\R-142ELE.DWG - STA. 4+00 TO STA. 12+00