

SCOPE OF WORK

THIS PROJECT CONSISTS OF THE CONSTRUCTION OF ACCESS TAXIWAYS FOR A NEW B PLACE T-HANGAR INCLUDING A CORPORATE HANGAR. PROJECT INCLUDES GRADING, DRAINAGE, AGGREGATE BASE COURSE, BITUMINOUS BASE COURSE, BITUMINOUS SURFACE COURSE, PAVEMENT MARKING, SEEDING AND MULCHING

AIRPORT SECURITY NOTE

AIRPORT SECURITY WILL BE MAINTAINED AT ALL TIMES. THE CONTRACTOR WILL CLOSE AND LOCK THE EXISTING GATE IN THE HAUL ROUTE AT THE END OF EACH WORKING DAY.

UTILITY NOTE

THE CONTRACTOR SHALL CONTACT ALL UTILITY COMPANIES AND AGENCIES WHICH HAVE LINES OR CONDUITS IN THE PROPOSED WORK AREA. ALL LINES AND CONDUITS SHALL BE LOCATED AND IDENTIFIED FOR DEPTH BEFORE ANY EXCAVATION BEGINS. THE CONTRACTOR WILL CALL J.U.L.I.E. (1-800-892-0123) TO ACCOMPLISH THE ABOVE. IT IS THE CONTRACTOR'S RESPONSIBILITY TO IDENTIFY ALL UNDERGROUND NON-JULIE UTILITIES LOCATED WITHIN THE PROPOSED CONSTRUCTION LIMITS. THESE UNDERGROUND IMPROVEMENTS WILL BE LOCATED AT THE CONTRACTOR'S OWN EXPENSE PRIOR TO THE START OF CONSTRUCTION ACTIVITIES.

HEIGHT OF CONSTRUCTION EQUIPMENT

THE MAXIMUM ANTICIPATED HEIGHT OF THE CONSTRUCTION EQUIPMENT WILL BE 25 FEET. THE TALLEST EQUIPMENT IS EXPECTED TO BE A SEMI-TRAILER TRUCK W/EXTENDED BED.

HAUL ROUTE AND VEHICLE PARKING

THE CONTRACTOR WILL USE THE DESIGNATED HAUL ROUTE AND PARKING AREA AS SHOWN ON THIS SHEET. THE PROPOSED PARKING AREA WILL BE 100' X 100'. THE CONTRACTOR WILL BE REQUIRED TO MAINTAIN THE PROPOSED HAUL ROUTE AND PARKING AREA THROUGHOUT THE COURSE OF THE PROJECT. ANY AREAS DAMAGED OUTSIDE OF THESE AREAS WILL BE REPAIRED BY THE CONTRACTOR AND AT THE CONTRACTOR'S OWN EXPENSE. AT THE CONCLUSION OF THE PROJECT THE CONTRACTOR WILL GRADE, FERTILIZE, SEED AND MULCH THE HAUL ROUTE AND PARKING AREA AS NEEDED TO RESTORE IT TO ITS ORIGINAL STATE. RESTORATION OF THE HAUL ROUTE AND PARKING AREA WILL BE CONSIDERED INCIDENTAL TO THE PROJECT AND NO ADDITIONAL COMPENSATION WILL BE ALLOWED.

CONTRACTOR RESPONSIBILITIES

THE CONTRACTOR'S EQUIPMENT PARKING AND STORAGE AREA WILL BE AS SHOWN ON THIS SHEET. THE CONTRACTOR'S EMPLOYEES WILL PARK THEIR VEHICLES IN THIS AREA. ONLY CONTRACTOR VEHICLES WILL BE ALLOWED OUTSIDE THIS AREA.

THE CONTRACTOR AND HIS EMPLOYEES WILL BE RESTRICTED TO THE WORK AREA AND ALL OTHER AREAS OF THE AIRPORT ARE "OFF LIMITS" TO THEM.

THE CONTRACTOR SHALL MAINTAIN CONTINUOUS TAXIWAY ACCESS TO ALL HANGARS AND ADMINISTRATIVE AREAS.

ALL WORK PERFORMED SHALL BE DONE IN A ORDERLY AND EFFECTIVE MANNER TO MINIMIZE TAXIWAY CLOSURE.

NO TRENCHES OR HOLES WILL REMAIN OPEN OVERNIGHT.

150-ENGINEER'S FIELD OFFICE NOTES

THE PROPOSED ENGINEER'S FIELD OFFICE WILL BE FURNISHED, MAINTAINED, AND REMOVED IN ACCORDANCE WITH ITEM AR150510 "ENGINEER'S FIELD OFFICE" AS STATED ON PAGE 168 OF THE SUPPLEMENTAL SPECIFICATIONS AND RECURRING SPECIAL PROVISIONS, ADOPTED JULY 1, 2004.

THE LOCATION OF THE PROPOSED ENGINEER'S FIELD OFFICE WILL BE DETERMINED AT THE PRE-CONSTRUCTION MEETING.

THE ENGINEERING FIRM WILL MAKE PAYMENT FOR ALL LONG DISTANCE TELEPHONE CALLS IN EXCESS OF ONE HUNDRED DOLLARS (\$100.00) PER MONTH.

THE PROPOSED ENGINEER'S FIELD OFFICE WILL BE PAID FOR UNDER ITEMS:
AR150510 ENGINEER'S FIELD OFFICE ____ 1 L.S.

BARRICADES AND TRAFFIC CONES

IT WILL BE THE CONTRACTOR'S RESPONSIBILITY TO PLACE AND MAINTAIN BARRICADES AND TRAFFIC CONES AS DIRECTED BY THE AIRPORT MANAGER. THE BARRICADES WILL BE EQUIPPED WITH RED STEADY BURN OR FLASHING LIGHTS AND 20" SQUARE ORANGE FLAGS. THE BARRICADES, THEIR MAINTENANCE, PLACEMENT AND REMOVAL WILL BE CONSIDERED AS AN INCIDENTAL ITEM TO THE CONTRACT AND NO ADDITIONAL COMPENSATION WILL BE ALLOWED.

THE LOCATION, SIZE AND TYPE OF MATERIAL OF EXISTING UNDERGROUND UTILITIES INDICATED ON THE PLANS IS NOT REPRESENTED AS BEING ACCURATE, SUFFICIENT OR COMPLETE. IT SHALL BE THE CONTRACTOR'S RESPONSIBILITY TO DETERMINE THE ACTUAL LOCATION OF ALL SUCH FACILITIES, INCLUDING SERVICE CONNECTIONS TO UNDERGROUND UTILITIES. PRIOR TO CONSTRUCTION, THE CONTRACTOR SHALL NOTIFY THE UTILITY COMPANIES OF HIS OPERATIONAL PLANS AND SHALL OBTAIN FROM THE RESPECTIVE UTILITY COMPANIES DETAILED INFORMATION AND ASSISTANCE RELATIVE TO THE LOCATION OF THEIR FACILITIES AND THE WORKING SCHEDULE OF THE COMPANIES FOR REMOVAL OR ADJUSTMENT WHERE REQUIRED. IN THE EVENT AN UNEXPECTED UTILITY INTERFERENCE IS ENCOUNTERED DURING CONSTRUCTION, THE CONTRACTOR SHALL IMMEDIATELY NOTIFY THE UTILITY COMPANY OF JURISDICTION. THE ENGINEER SHALL ALSO BE IMMEDIATELY NOTIFIED. ANY SUCH MAINS AND SERVICES SHALL BE RESTORED TO SERVICE AT ONCE AND PAID FOR BY THE CONTRACTOR AT NO ADDITIONAL COST TO THE CONTRACT.

CALL J.U.L.I.E. FOR UTILITY INFORMATION AT 1-800-892-0123.

BENCHMARK DATA				
NO.	DESCRIPTION	NORTHING	EASTING	ELEV.
1	LACPORT NGS MONUMENT	1,585,214.690	2,512,981.969	N/A
2	LACPORT AZ MONUMENT	1,587,067.557	2,510,579.083	N/A
3	5/8" IRON PIN W/ HELI METAL CAP	1,586,449.457	2,511,380.665	549.16

J.U.L.I.E. INFORMATION

COUNTY: MARSHALL
CITY: LACON
TOWNSHIP: HOPEWELL
SECTION NO.: 31
ADDRESS: MARSHALL COUNTY AIRPORT
LACON, ILLINOIS 61540

CRITICAL POINT DATA

LATITUDE: 41° 01' 19.256"N
LONGITUDE: 89° 23' 24.361"W
ELEVATION: 533.50 M.S.L.

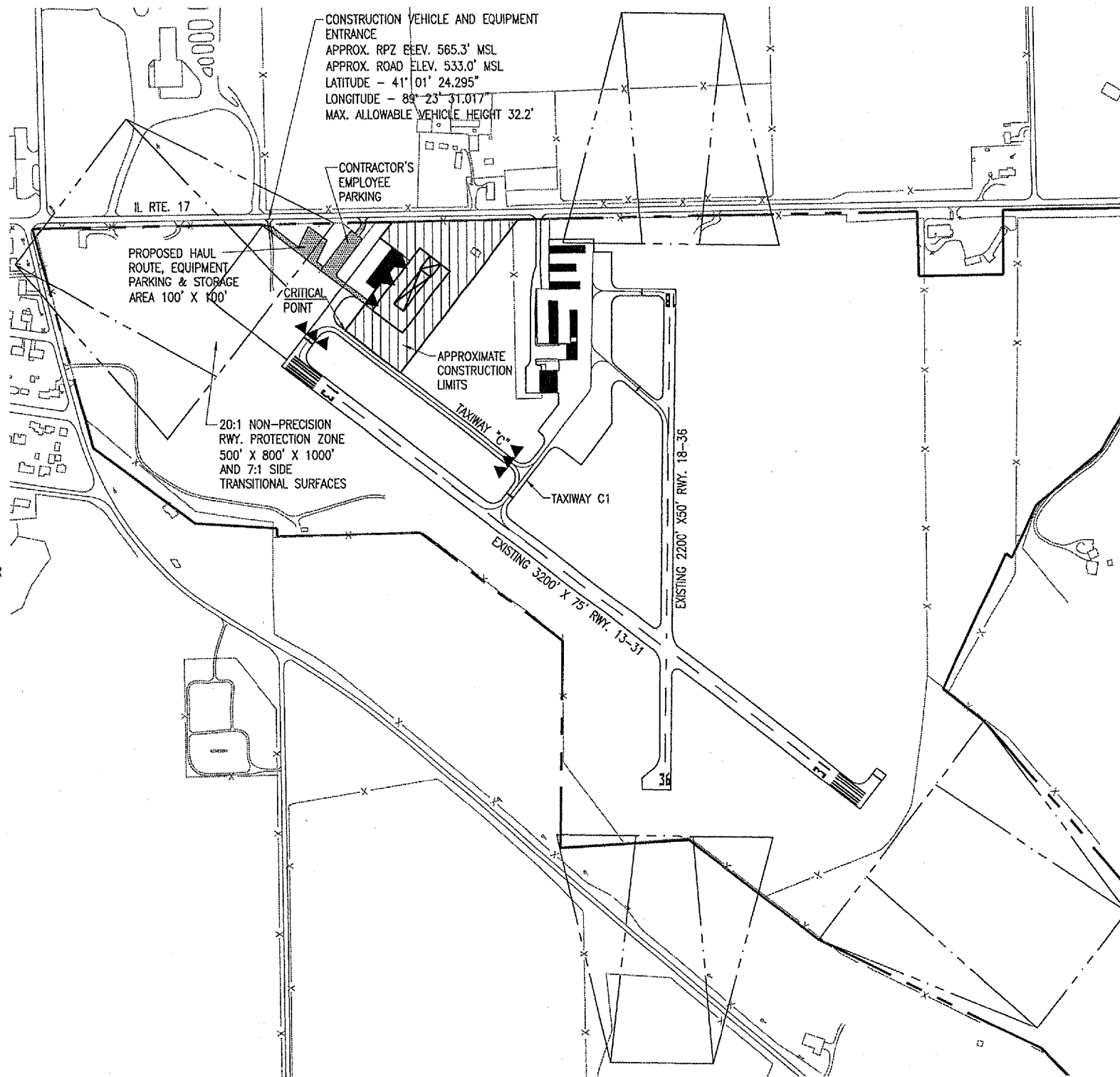

PROPOSED SAFETY PLAN

GENERAL - THE MARSHALL COUNTY AIRPORT IS COMPRISED OF TWO RUNWAYS. THE PROPOSED CONSTRUCTION WILL NOT NECESSITATE THE CLOSING OF EITHER OF THESE RUNWAYS. THE PARTIAL PARALLEL TAXIWAY WILL BE CLOSED WHENEVER WORK IS DONE WITHIN 40' OF THE TAXIWAY CENTERLINE (79 FT WIDE SAFETY AREA). THE CONTRACTOR WILL MINIMIZE THE LENGTH OF TIME THE TAXIWAY WILL BE CLOSED. TEMPORARY TAXIWAY CLOSURE WILL BE COORDINATED WITH THE AIRPORT MANAGER. THE AIRPORT MANAGER WILL BE ADVISED IN ADVANCE OF THE CLOSURE OF THE TAXIWAY IN ORDER TO INSURE THE REQUIRED NOTAM IS ISSUED. ALL WORK INCLUDED IN OPENING AND CLOSING THE TAXIWAY WILL BE CONSIDERED INCIDENTAL TO THE PROJECT AND NO ADDITIONAL COMPENSATION WILL BE ALLOWED.

STAGING - NO STAGING OF THE PROPOSED PROJECT WILL BE REQUIRED. THE CONTRACTOR WILL HAVE TO PROVIDE THE AIRPORT MANAGER WITH TWO WEEKS ADVANCE NOTICE PRIOR TO STARTING. THIS WILL PROVIDE THE AIRPORT MANAGER WITH SUFFICIENT TIME TO NOTIFY THE TENANTS OF THE EXISTING T-HANGAR TO MOVE THEIR PLANES IF THEY DON'T WANT RESTRICTIONS PLACED ON THEM BECAUSE OF THE PROPOSED CONSTRUCTION.

IDENTIFICATION - WHEN THE CONTRACTORS VEHICLES AND EQUIPMENT ARE ON THE AIRPORT THEY SHALL BE PROPERLY MARKED WITH THREE (3") FOOT SQUARE CHECKERED FLAGS (INTERNATIONAL ORANGE AND WHITE). THE CONTRACTOR WILL ALSO PROVIDE WORKERS WITH SOME TYPE OF TAG OR GARMENT TO IDENTIFY THE PERSON AS BEING PART OF THE CONSTRUCTION CREW.

RADIO CONTROL - THE CONTRACTOR WILL BE REQUIRED TO BE IN TWO-WAY RADIO CONTACT (122.80 MHz.) WITH THE AIRPORT UNICOM. THIS WILL KEEP THE CONTRACTOR IN CONSTANT CONTACT WITH THE MARSHALL COUNTY AIRPORT AND ENABLE THE AIRPORT TO IMMEDIATELY CONTACT THE CONTRACTOR IN CASE OF AN AERONAUTIC EMERGENCY THAT WOULD REQUIRE ACTION BY THE CONTRACTOR AND/OR HIS PERSONNEL.

EROSION CONTROL

THIS PROJECT WILL DISTURB MORE THAN 1 ACRE OF LAND, THEREFORE A N.P.D.E.S. PERMIT WILL BE REQUIRED.

LEGEND

- EXISTING IMPROVEMENTS
- PROPOSED IMPROVEMENTS
- EXISTING BUILDINGS
- PROPOSED BUILDINGS
- PROPOSED HAUL ROUTE AND EQUIPMENT PARKING AREA
- BENCHMARK
- PROPOSED BARRICADES OR TRAFFIC CONES
- EXISTING PROPERTY LINE

0' 150' 300' 600'
HALF SIZE SCALE: 1" = 600'
FULL SIZE SCALE: 1" = 300'



DATE	REVISION	BY
01/23/06	REVISED AS PER B.A. REVIEW	CAH

MARSHALL COUNTY AIRPORT
LACON, ILLINOIS
A.I.P. PROJ.: 3-17-0059-BB
IL PROJ.: C75-3542

HEI Project No. 811-08TIGD-0800	10/10/05
Drawn R-003SFY.DWG	B.A.K.
Scale 1" = 300'	10/10/05
Date 10/10/05	xx/xx/xx
LAYOUT	C.A.H.
DRAWN	
REVIEWED	

Hanson Professional Services Inc.
1525 South Shore Street
Springfield, IL 62769-2886
Offices Nationwide

PROPOSED T-HANGAR
ACCESS TAXIWAY
PROPOSED
SAFETY
PLAN