

STATE OF ILLINOIS  
DEPARTMENT OF TRANSPORTATION

F.A.U.P. RTE.	SECTION	COUNTY	TOTAL SHEETS	SHEET NO.
*	(35)CJS&(12)CJS	KENDALL	10	1
* F.A.U. 2503 / F.A.P. 860		ILLINOIS	CONTRACT NO. 66M72	

INDEX OF SHEETS

- 1 COVER SHEET
- 2 GENERAL NOTES
- 3 SUMMARY OF QUANTITIES
- 4-5 TYPICAL SECTIONS
- 6 SCHEDULES
- 7-8 LINE DIAGRAM
- 9-10 DETAILS

LIST OF ILLINOIS DOT HIGHWAY STANDARDS

000001-08	STANDARD SYMBOLS, ABBREVIATIONS AND PATTERNS
001006	DECIMAL OF AN INCH AND OF A FOOT
701001-02	OFF-ROAD OPERATIONS 2L, 2W, MORE THAN 15' (4.5 m) AWAY
701006-05	OFF-ROAD OPERATIONS 2L, 2W, 15' (4.5 m) TO 24" (600 mm) FROM PAVEMENT EDGE
701306-04	LANE CLOSURE, 2L, 2W, SLOW MOVING OPERATIONS DAY ONLY, FOR SPEEDS >= 45 MPH
701901-08	TRAFFIC CONTROL DEVICES
780001-05	TYPICAL PAVEMENT MARKINGS

# PROPOSED HIGHWAY PLANS

## FAU ROUTE 2503 (IL 25) & FAP ROUTE 860 (IL 31) SECTION (35)CJS&(12)CJS PROJECT NHPP-STP-PG0L(189) CRACK & JOINT SEALING KENDALL COUNTY

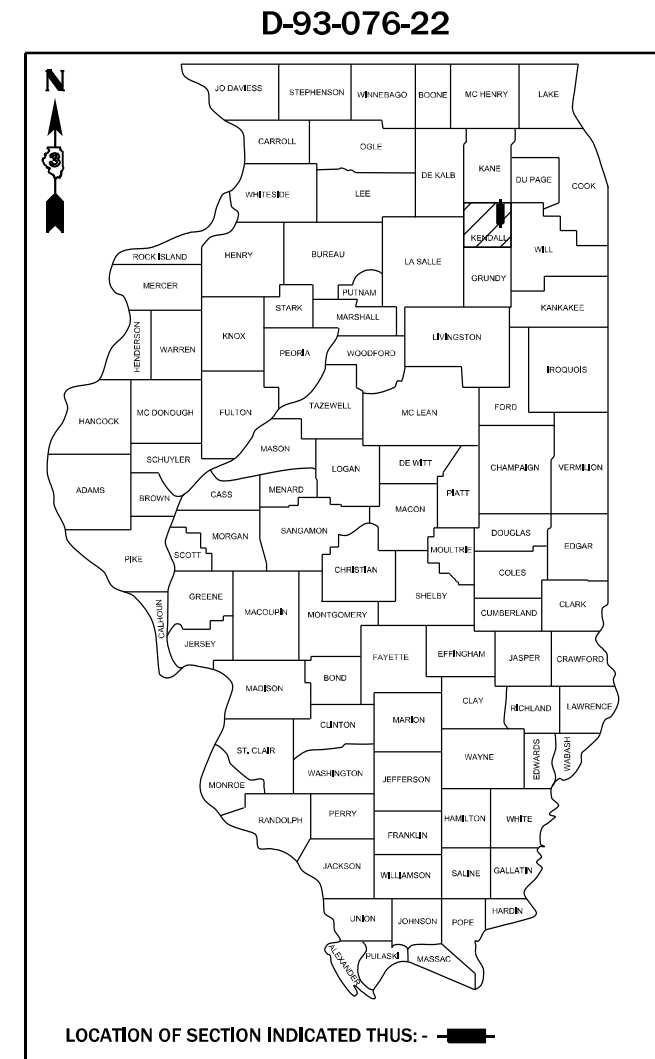

LOCATION OF SECTION INDICATED THIS: - ■ -

KENDALL COUNTY IL 31	KENDALL COUNTY IL 25
FUNCTIONAL CLASSIFICATION- OTHER PRINCIPAL ARTERIAL 2022 ADT=10183 PV=93.87% SU=3.81% MU=2.32%	FUNCTIONAL CLASSIFICATION- MINOR ARTERIAL 2022 ADT=4900 PV=98.08% SU=1.84% MU=0.08%

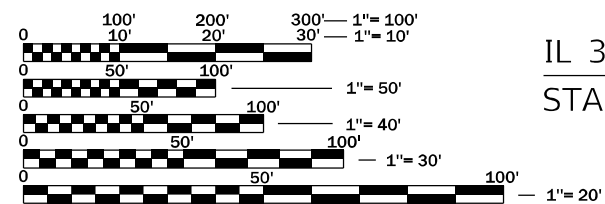

FULL SIZE PLANS HAVE BEEN PREPARED USING STANDARD ENGINEERING SCALES. REDUCED SIZED PLANS WILL NOT CONFORM TO STANDARD SCALES. IN MAKING MEASUREMENTS ON REDUCED PLANS, THE ABOVE SCALES MAY BE USED.

J.U.L.I.E.  
JOINT UTILITY LOCATION INFORMATION FOR EXCAVATION  
1-800-892-0123  
OR 811

PROJECT ENGINEER: BRAD DUNCAN P.E.  
UNIT CHIEF: MOHAMED YOUSIF  
DISTRICT 3 NO. (815) 434-6131  
CONTRACT NO. 66M72

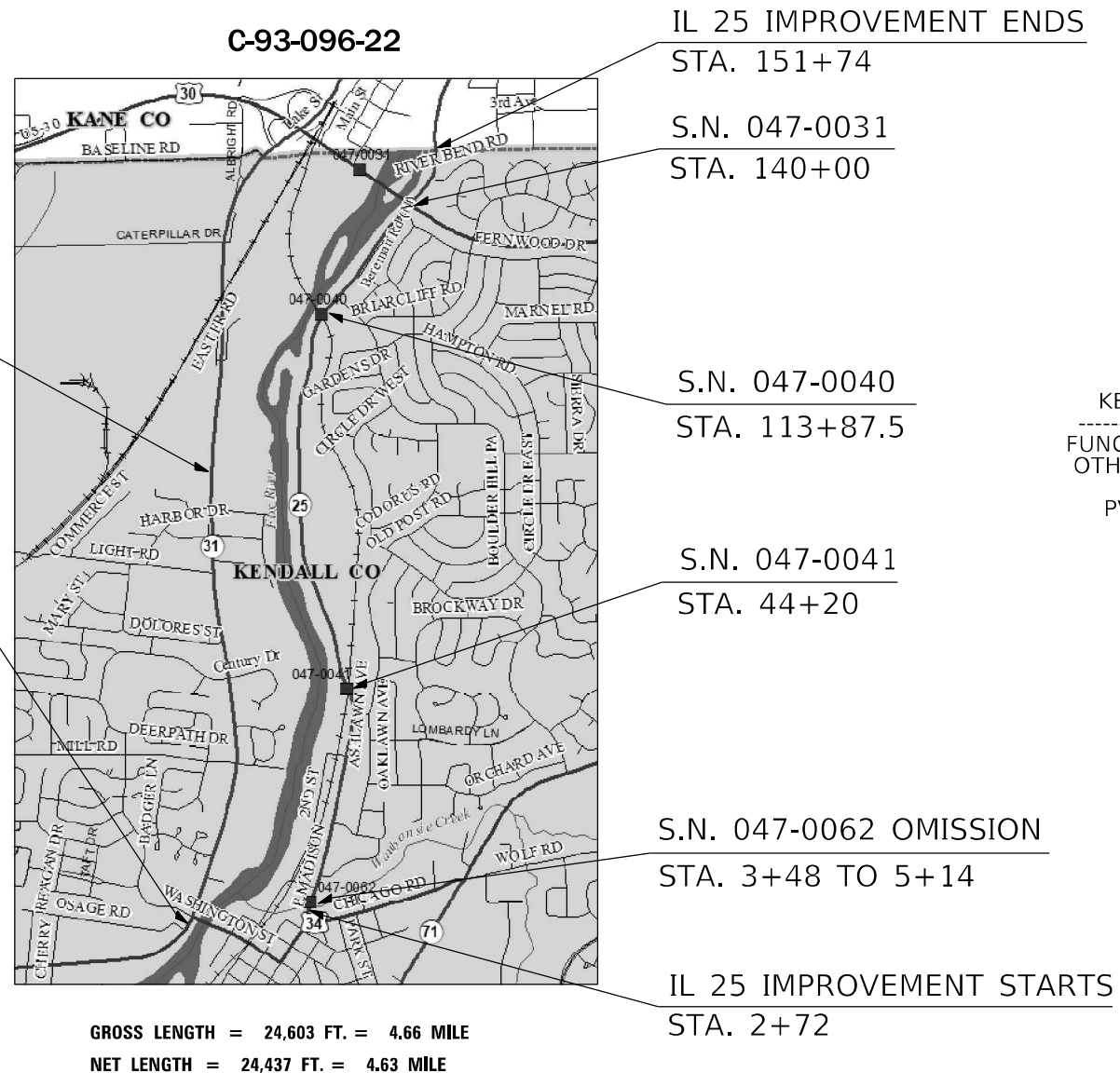

GROSS LENGTH = 24,603 FT. = 4.66 MILE  
NET LENGTH = 24,437 FT. = 4.63 MILE

STATE OF ILLINOIS  
DEPARTMENT OF TRANSPORTATION

SUBMITTED December 14, 2022

*James Ahmed*  
REGIONAL ENGINEER

February 3, 2023

*Steph McSwain*  
ENGINEER OF DESIGN AND ENVIRONMENT

February 3, 2023

*Steph McSwain*  
DIRECTOR OF HIGHWAYS PROJECT IMPLEMENTATION

PRINTED BY THE AUTHORITY  
OF THE STATE OF ILLINOIS

**GENERAL NOTES**

THE INTENT OF THIS PROJECT IS TO SEAL WORKING TRANSVERSE CRACKS AND PRIMARY LONGITUDINAL CRACKS GREATER THAN 1/4" IN WIDTH. SECONDARY CRACKS GREATER THAN 1/4" IN WIDTH SHALL BE CLEANED AND SEALED.

THE CONTRACTOR SHALL NOT DISTURB THE EXISTING PAVEMENT MARKING OR RAISED REFLECTIVE PAVEMENT MARKERS. THE CONTRACTOR SHALL REPLACE AT NO ADDITIONAL COST TO THE DEPARTMENT, ANY PAVEMENT MARKING OR RAISED REFLECTIVE PAVEMENT MARKERS DAMAGED BY HIS OPERATION.

THE ENGINEER SHALL DETERMINE WHETHER SECTIONS OF CRACKS SEALING SHOULD BE OMITTED IN ORDER TO AVOID DAMAGING THE PAVEMENT MARKING IN THOSE AREAS.

PLAN DIMENSIONS AND DETAIL RELATIVE TO THE EXISTING PLANS ARE SUBJECT TO ROUTINE VARIATIONS. THE CONTRACTOR SHALL FIELD VERIFY EXISTING DIMENSIONS AND DETAILS AFFECTING NEW CONSTRUCTION OF ORDERING OF MATERIALS, SUCH VARIATIONS SHALL NOT BE CAUSE FOR ADDITIONAL COMPENSATION FOR A CHANGE IN THE SCOPE OF THE WORK, HOWEVER, THE CONTRACTOR WILL BE PAID FOR THE QUANTITY FURNISHED BASED UPON THE UNIT BID PRICE.

ALL PCC BRIDGE DECKS AND PAVEMENT SHALL BE OMITTED. BRIDGE DECKS WITH HMA OVERLAYS ARE TO BE SEALED ONLY (NO ROUTING).

THE FOLLOWING RATES OF APPLICATION HAVE BEEN USED IN CALCULATING PLAN QUANTITIES:

CRACK FILLING	0.5	POUND/FOOT
---------------	-----	------------

**COMMITMENTS**

NONE

STATE OF ILLINOIS  
DEPARTMENT OF TRANSPORTATION  
DISTRICT THREE  
AS BUILT INFORMATION

\_\_\_\_\_  
SUPERVISING CONSTRUCTION FIELD ENGINEER

\_\_\_\_\_  
RESIDENT ENGINEER / TECHNICIAN

START & END DATES  
OF CONSTRUCTION:

INSPECTORS:

**STATE OF ILLINOIS  
DEPARTMENT OF TRANSPORTATION**

**GENERAL NOTES**

SCALE: SHEET OF SHEETS STA. TO STA.

F.A.U.P. RTE.	SECTION	COUNTY	TOTAL SHEETS	SHEET NO.
*	(35)CJ56(12)CJS	KENDALL	10	2
* F.A.U 2503 / F.A.P 860		CONTRACT NO. 66M72		
		ILLINOIS	FED. AID PROJECT	

CODE NO.	ITEM	UNIT	TOTAL QUANTITY	CONSTRUCTION CODE	
				IL25	IL31
				STP-URB STATE 20% FED 80%	NHPP STATE 20% FED 80%
				ROADWAY 0005 URBAN	ROADWAY 0005 URBAN
45100200	CRACK FILLING	POUND	14030	8694	5336
67100100	MOBILIZATION	L SUM	1	0.6	0.4
70100460	TRAFFIC CONTROL AND PROTECTION, STANDARD 701306	L SUM	1	0.6	0.4
20030850	TEMPORARY INFORMATION SIGNING	SQ FT	84	42	42

MODEL: Default  
FILE NAME: p:\ultra-cad-bea\paw.com\FW\DOT\Documents\DOT Office\Dir\dir: 3\Project\1D366M72\CAD\Date: 1D366M72-ht-500.dgn

USER NAME = Boudle,Shan	DESIGNED -	REVISED -
	DRAWN -	REVISED -
PLOT SCALE = 100,0000 ' / in.	CHECKED -	REVISED -
PLOT DATE = 12/14/2022	DATE -	REVISED -

**STATE OF ILLINOIS  
DEPARTMENT OF TRANSPORTATION**

**SUMMARY OF QUANTITIES**

SCALE: SHEET OF SHEETS STA. TO STA.

F.A.J/P RTE.	SECTION	COUNTY	TOTAL SHEETS	SHEET NO.
~	(35)CJ56(12)CJS	KENDALL	10	3
* F.A.U 2503 / F.A.P 860		CONTRACT NO. 66M72		
		ILLINOIS FED. AID PROJECT		

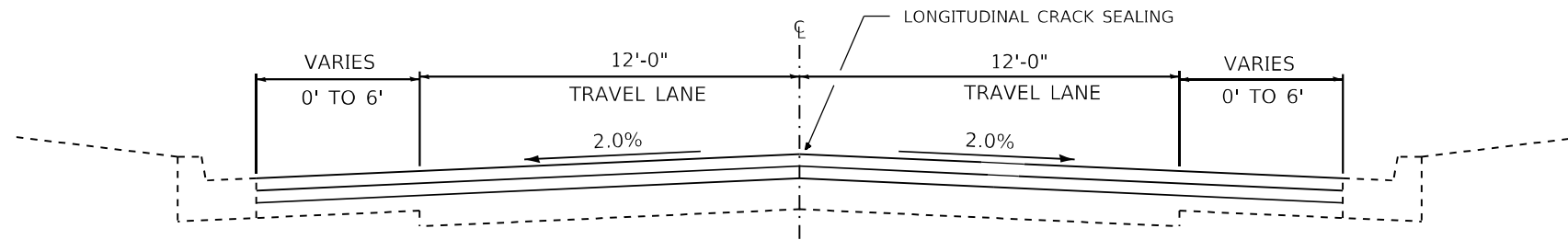

**TYPICAL SECTION 1 IL 31**

STA 659+89 TO STA 690+97  
 STA 703+07 TO STA 756+90

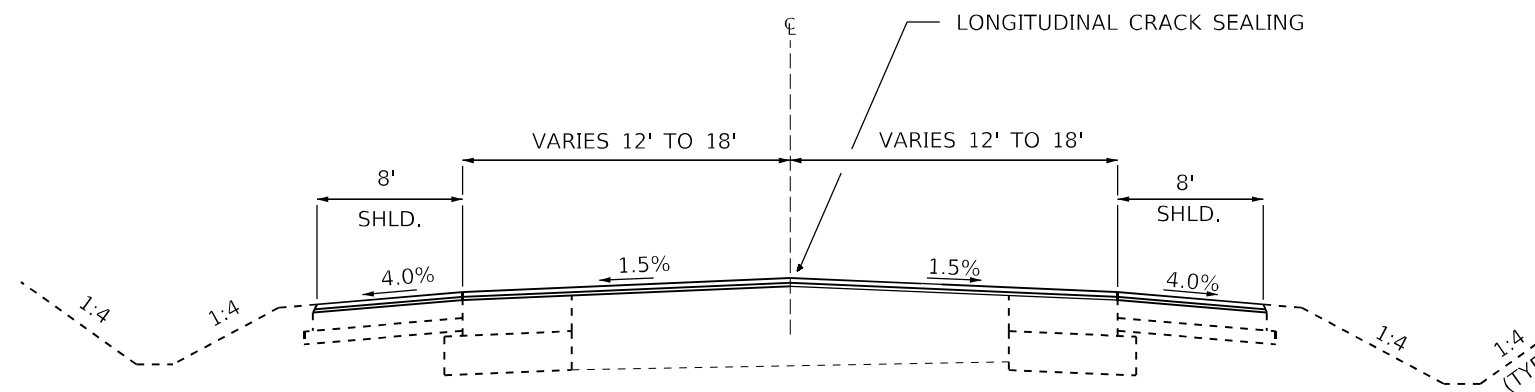

**TYPICAL SECTION 2 IL 31**

STA. 690+97 TO STA. 703+07

MODEL: Default  
 FILE: \\nafe-pw-bentley.com\PW\DOT\Documents\DOT Office\Shirley\_3\Project\1D366M72\CADD\1D366M72-shr-typical.dgn

USER NAME = Boudie,Shan	DESIGNED -	REVISED -
	DRAWN -	REVISED -
PLOT SCALE = 100,0000 ' / in.	CHECKED -	REVISED -
PLOT DATE = 12/14/2022	DATE -	REVISED -

**STATE OF ILLINOIS  
 DEPARTMENT OF TRANSPORTATION**

**TYPICAL SECTIONS IL 31**

SCALE: SHEET OF SHEETS STA. 659+89 TO STA. 756+90

F.A.U./P RTE.	SECTION	COUNTY	TOTAL SHEETS	SHEET NO.
*	(35)CIS6(12)CJS	KENDALL	10	4
* F.A.U 2503 / F.A.P 860		CONTRACT NO. 66M72		
		ILLINOIS	FED. AID PROJECT	

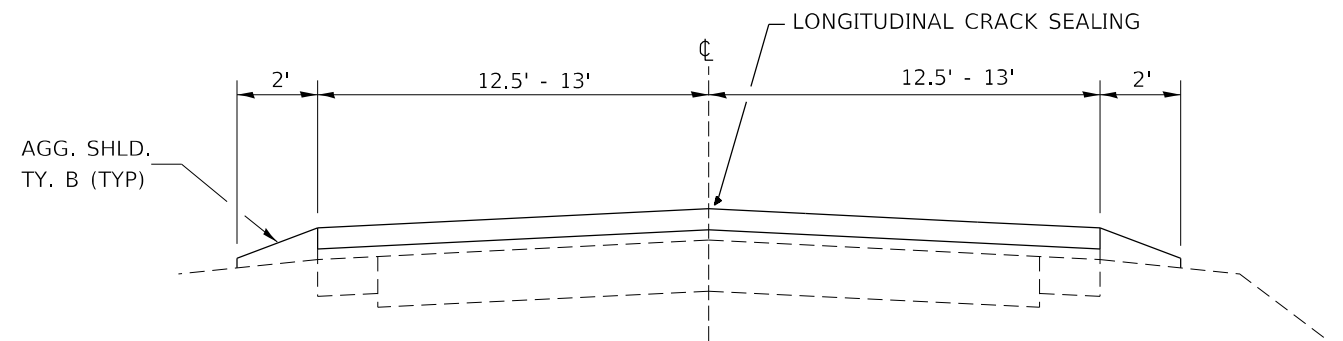

**TYPICAL SECTION 1 IL 25**

STA. 2+72 TO STA. 3+48  
 STA. 3+48 TO STA. 5+14 OMISSION S.N. 047-0062  
 STA. 5+14 TO STA. 39+60  
 STA. 46+27 TO STA. 141+02

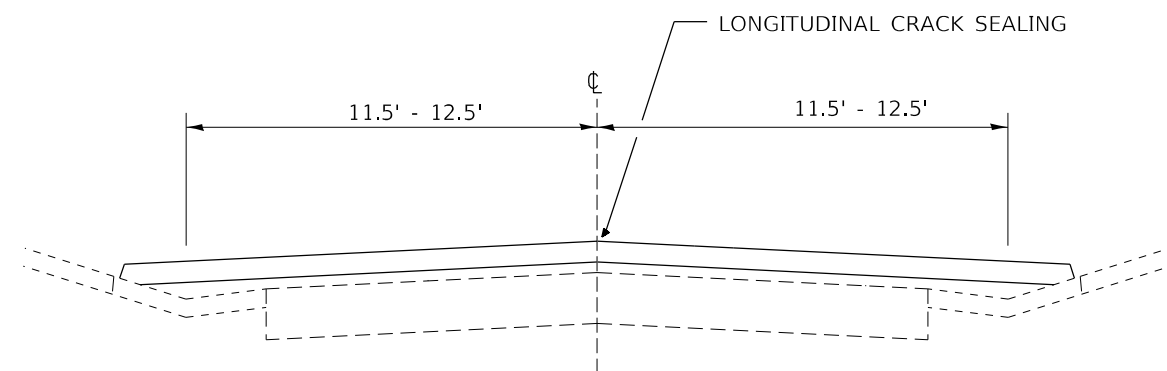

**TYPICAL SECTION 2 IL 25**

STA. 39+60 TO STA. 46+72

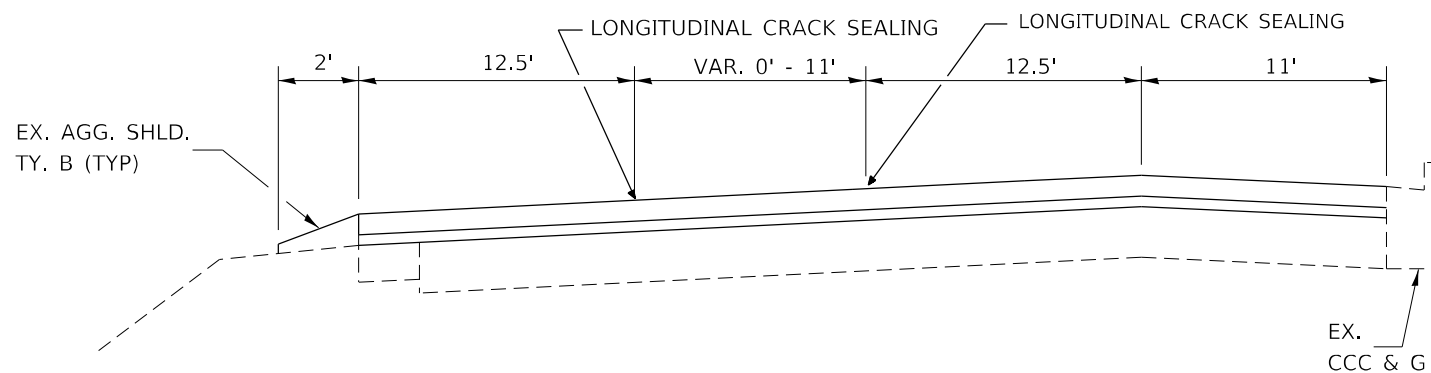

**TYPICAL SECTION 3 IL 25**

STA. 141+02 TO STA. 151+74

MODEL: Default  
 FILE: \\mariq-pw-bentley.com\P\DOT\Documents\DOT Office\Shirley\_3\Project\10366472\CADD\Drawings\10366472-shr-typical.dgn

USER NAME = Boudie,Shan	DESIGNED -	REVISED -
	DRAWN -	REVISED -
PLOT SCALE = 100,0000 ' / in.	CHECKED -	REVISED -
PLOT DATE = 12/14/2022	DATE -	REVISED -

**STATE OF ILLINOIS  
 DEPARTMENT OF TRANSPORTATION**

**TYPICAL SECTIONS IL 25**

SCALE: SHEET OF SHEETS STA. 2+72 TO STA. 145+67

F.A.U./RTE.	SECTION	COUNTY	TOTAL SHEETS	SHEET NO.
*	(35)CIS&(12)CJS	KENDALL	10	5
* F.A.U 2503 / F.A.P 860		CONTRACT NO. 66M72		
		ILLINOIS	FED. AID PROJECT	



IL 31

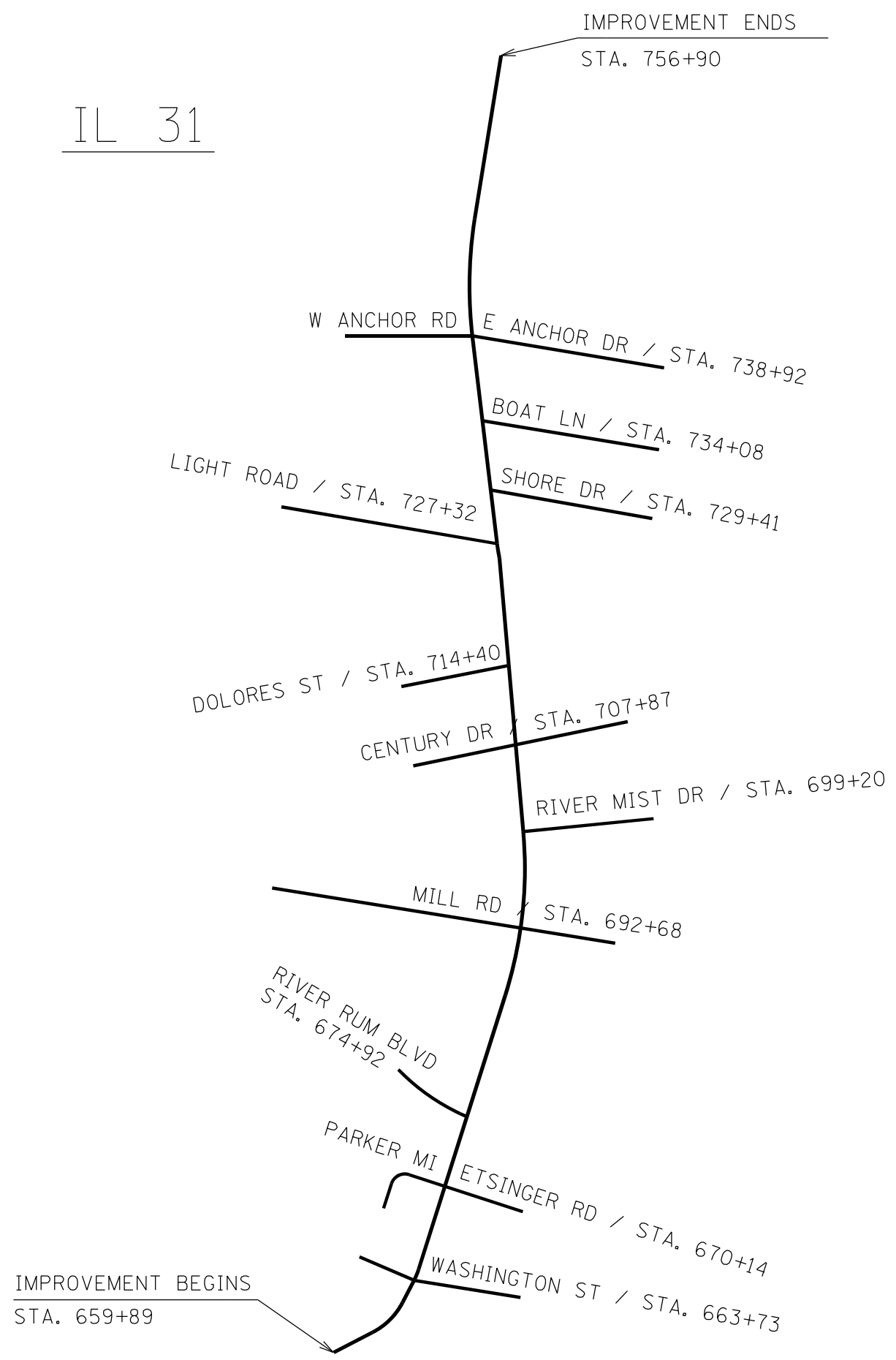

MODEL: Default  
 FILE: \\na11e01.pw.us\idirect-pw-beadley.com\PIV\DOT\Documents\1\DOT\Office\Shan\2\Project\ID366M72\CADD\Drawn\ID366M72-2ht-details.dgn

USER NAME = Boudle,Shan	DESIGNED -	REVISED -
	DRAWN -	REVISED -
PLOT SCALE = 100,0000' / in.	CHECKED -	REVISED -
PLOT DATE = 12/14/2022	DATE -	REVISED -

**STATE OF ILLINOIS  
DEPARTMENT OF TRANSPORTATION**

**LINE DIAGRAM IL 31**

SCALE: SHEET OF SHEETS STA. 663+73 TO STA. 756+90

F.A.U./RTE.	SECTION	COUNTY	TOTAL SHEETS	SHEET NO.
*	(35)CJ56(12)CJS	KENDALL	10	7
* F.A.U 2503 / F.A.P 860		CONTRACT NO. 66M72		
ILLINOIS FED. AID PROJECT				

IL 25

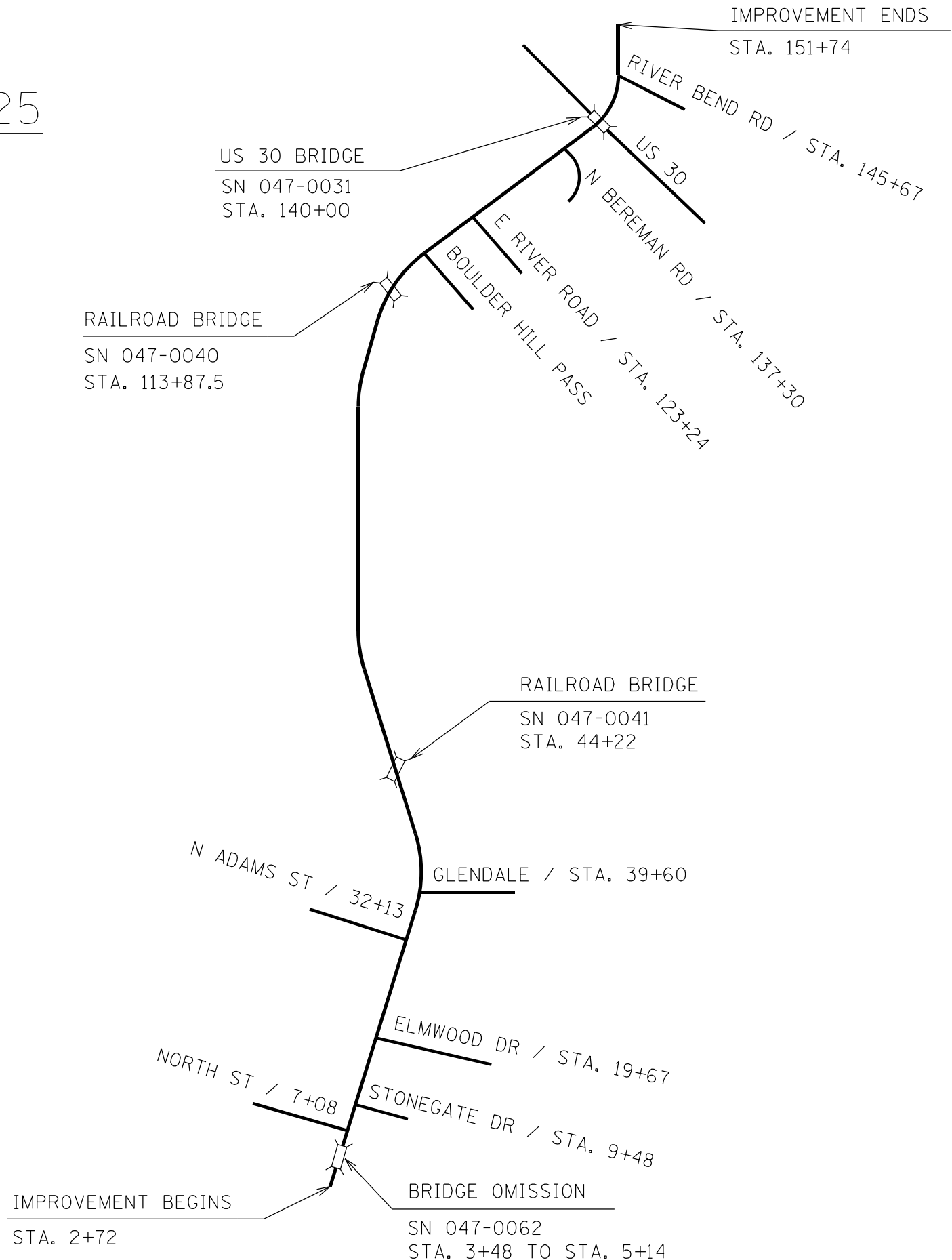

MODEL: Default  
 FILE: Mainfile.pxl  
 SUBJECT: new\_bentley.com:PIV\DOT\Documents\DOT\_office\Dir\rdet\_3\Project\0366M72\CADD\0366M72-2ht-details.dgn

USER NAME = Boudle,Shan	DESIGNED -	REVISED -
	DRAWN -	REVISED -
PLOT SCALE = 100,0000' / in.	CHECKED -	REVISED -
PLOT DATE = 12/14/2022	DATE -	REVISED -

**STATE OF ILLINOIS**  
**DEPARTMENT OF TRANSPORTATION**

**LINE DIAGRAM IL 25**  
 SCALE: SHEET OF SHEETS STA. 2+72 TO STA. 151+74

F.A.U./RTE.	SECTION	COUNTY	TOTAL SHEETS	SHEET NO.
*	(35)CJ56(12)CJS	KENDALL	10	8
* F.A.U 2503 / F.A.P 860		CONTRACT NO. 66M72		
		ILLINOIS FED. AID PROJECT		



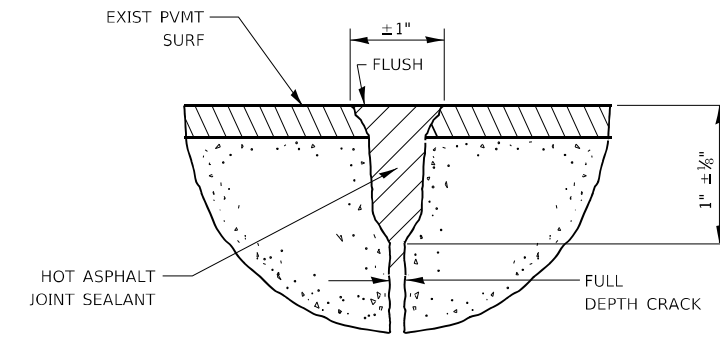

**ROUTING & SEALING JOINTS**  
(TRANSVERSE PATCH BOUNDARIES)

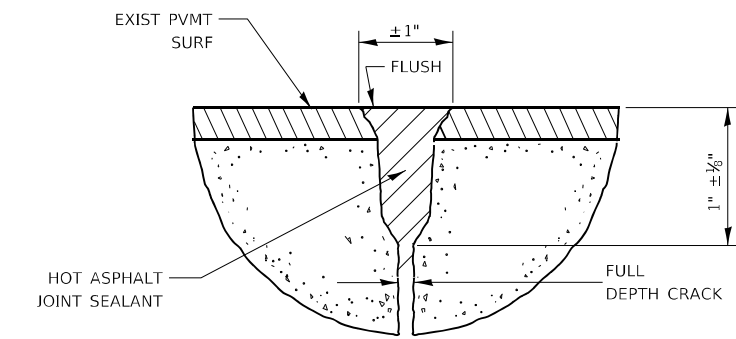

**SEALING CRACKS (PAVEMENT) DETAIL**  
NOTE: ALL CRACKS LESS THAN 1/8" WIDTH REQUIRE ROUTING

MODEL: Default  
 FILE: Mainfile.pia  
 SUBJECT: pav\_bentley.com  
 PLOT DATE: 12/14/2022  
 PROJECT: D:\Projects\DOT Documents\DOT Office\Shan\12142022\DOT\66M72\66M72-ht-detail.dgn

USER NAME = Boudie,Shan	DESIGNED -	REVISED -
	DRAWN -	REVISED -
PLOT SCALE = 100,0000 ' / in.	CHECKED -	REVISED -
PLOT DATE = 12/14/2022	DATE -	REVISED -

**STATE OF ILLINOIS  
DEPARTMENT OF TRANSPORTATION**

DETAILS			
SCALE:	SHEET	OF SHEETS	STA. TO STA.

F.A.U./H RTE.	SECTION	COUNTY	TOTAL SHEETS	SHEET NO.
	(35)CJ56(12)CJS	KENDALL	10	9
* F.A.U 2503 / F.A.P 860		CONTRACT NO. 66M72		
		ILLINOIS	FED. AID PROJECT	

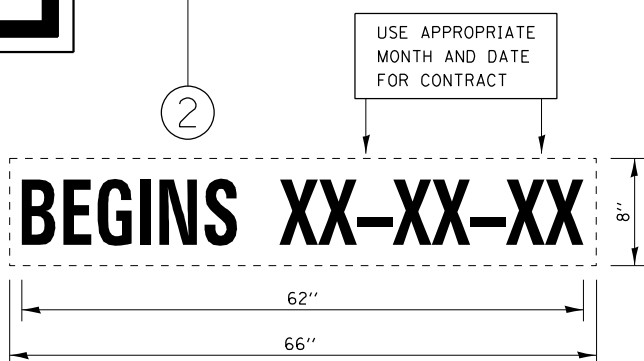
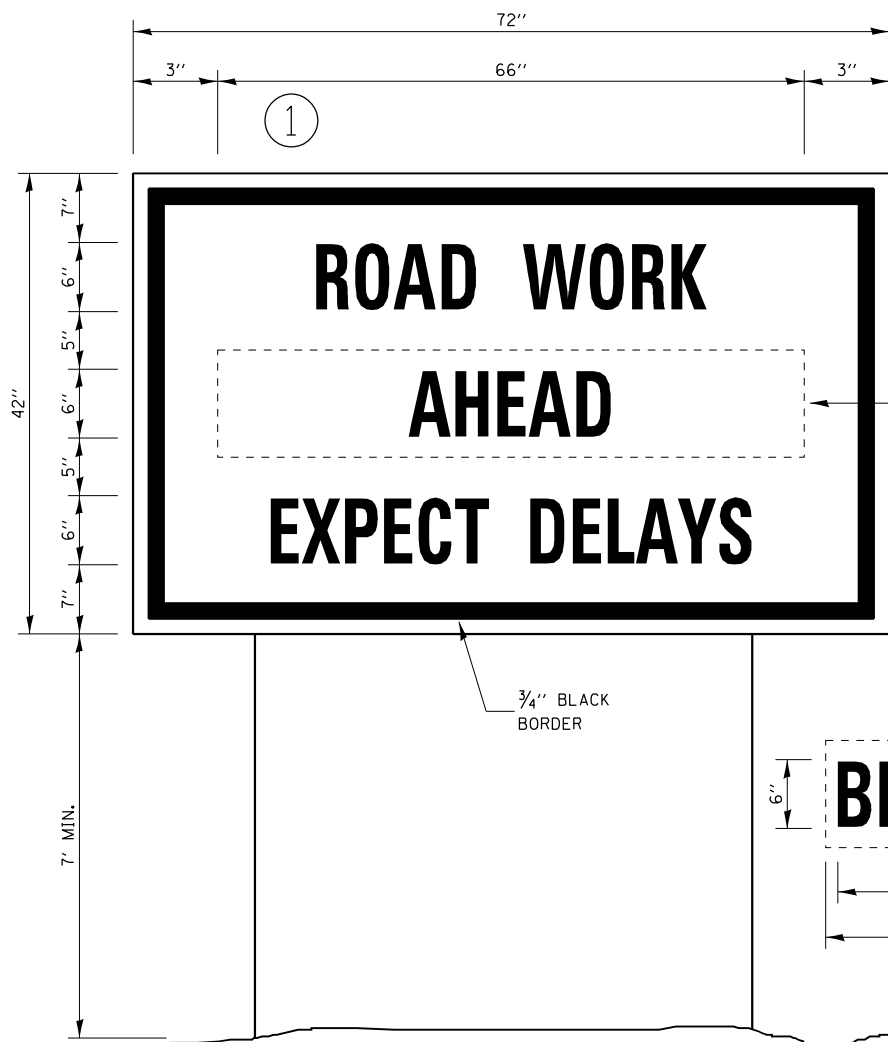

**TEMPORARY INFORMATION SIGNING**

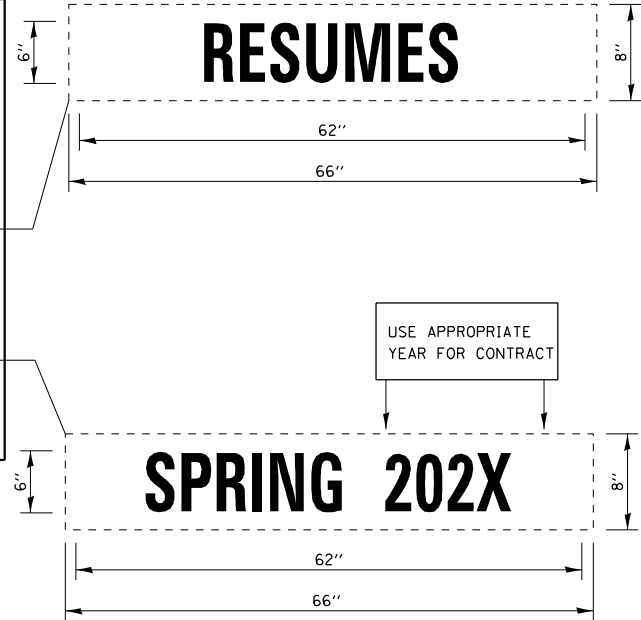
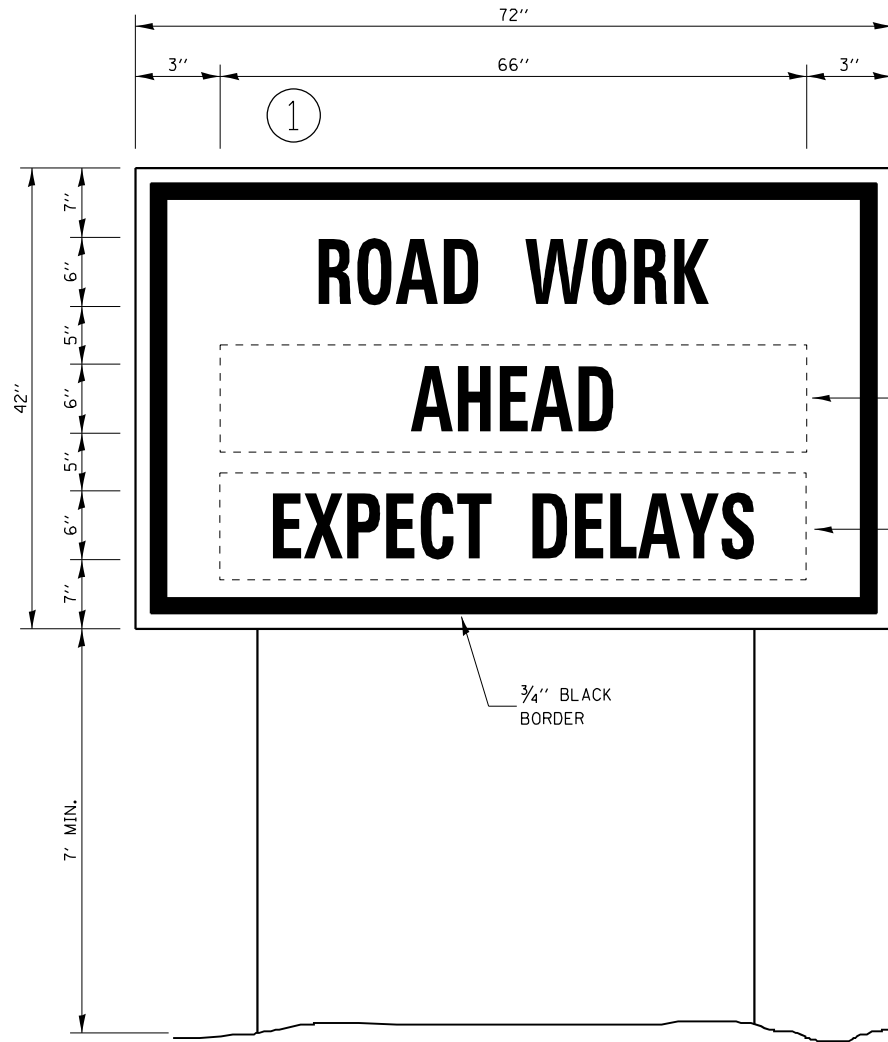

**WINTER SHUT DOWN SIGNING**

**NOTES:**

1. USE 6" D BLACK LETTERING ON FLOURESENT ORANGE BACKGROUND.
2. ERECT SIGNS AT LOCATIONS IN ADVANCE OF THE "ROAD CONSTRUCTION AHEAD" SIGNS AS DIRECTED BY THE ENGINEER.
3. ERECT SIGN ① WITH INSTALLED PANEL ② A MINIMUM OF ONE WEEK PRIOR TO THE START OF THE LANE CLOSURE.
4. REMOVE PANEL ② ON THAT DATE.
5. SEE SPECIAL PROVISION "TEMPORARY INFORMATION SIGNING" FOR ADDITIONAL INFORMATION.
6. WILL BE PAID FOR PER SQ FT AS "TEMPORARY INFORMATION SIGNING". EACH SIGN = 21 SQ FT AND THE DATE PANEL ② WILL NOT BE MEASURED SEPARATELY FOR PAYMENT.

MODEL: Default  
FILE: Model - 2011/11/14 10:00 AM  
PROJECT: \\dot\projects\66672\CADD\Drawings\66672-2011-11-14\66672-2011-11-14.dgn

USER NAME = Boudle,Shan	DESIGNED -	REVISED -
	DRAWN -	REVISED -
PLOT SCALE = 100,0000 ' / in.	CHECKED -	REVISED -
PLOT DATE = 12/14/2022	DATE -	REVISED -

**STATE OF ILLINOIS  
DEPARTMENT OF TRANSPORTATION**

**DETAILS**

SCALE: SHEET OF SHEETS STA. TO STA.

F.A.U./RTE.	SECTION	COUNTY	TOTAL SHEETS	SHEET NO.
*	(35)CJ56(12)CJS	KENDALL	10	10
* F.A.U 2503 / F.A.P 860		CONTRACT NO. 66M72		
ILLINOIS FED. AID PROJECT				