

F.A. RTE.	SECTION	COUNTY	TOTAL SHEETS	SHEET NO.
	19-00001-01-SW	MACON	10	1
		ILLINOIS	CONTRACT NO. 95915	



UNDERGROUND FACILITIES, STRUCTURES AND UTILITIES HAVE BEEN PLOTTED FROM AVAILABLE SURVEYS AND RECORDS AND THEIR LOCATIONS MUST BE CONSIDERED APPROXIMATE ONLY. THERE MAY BE OTHERS, THE EXISTENCE OF WHICH IS PRESENTLY NOT KNOWN. THE DEPTH OF UTILITIES IS ASSUMED TO BE NORMAL AND CUSTOMARY. THE CONTRACTOR SHALL VERIFY LOCATION AND DEPTH OF ALL UTILITIES PRIOR TO CONSTRUCTION.

03-10-2023 LETTING ITEM 153

STATE OF ILLINOIS  
DEPARTMENT OF TRANSPORTATION  
DIVISION OF HIGHWAYS

**PLANS FOR PROPOSED LOCAL AGENCY IMPROVEMENT**

SAFE ROUTES TO SCHOOL (SRTS)  
SECTION 19-00001-00-SW  
PROJECT 9J9D(390)  
PROPOSED SIDEWALK CONSTRUCTION  
VILLAGE OF WARRENSBURG  
C-97-054-22



LOCATION OF SECTION INDICATED THUS: - [black box] -

INDEX OF SHEETS

- 1 COVER
- 2 GENERAL NOTES, ALIGNMENT, & BENCHMARKS
- 3 SUMMARY OF QUANTITIES
- 4 TYPICAL SECTIONS & DETAILS
- 5-7 PLAN AND PROFILES
- 8-10 RAMP AND INTERSECTION DETAILS

HIGHWAY STANDARDS

- 000001-08 STANDARD SYMBOLS, ABBREVIATIONS AND PATTERNS
- 001006 DECIMAL OF AN INCH AND OF A FOOT
- 424001-11 PERPENDICULAR CURB RAMPS FOR SIDEWALKS
- 442201-03 CLASS C AND D PATCHES
- 606001-08 CONCRETE CURB TYPE B AND COMBINATION CONCRETE CURB AND GUTTER
- 701006-05 OFF-RD OPERATIONS, 2L, 2W, 15' TO 24" FROM PAVEMENT EDGE
- 701501-06 URBAN LANE CLOSURE, 2L, 2W, UNDIVIDED
- 701801-06 SIDEWALK, CORNER OR CROSSWALK CLOSURE
- 701901-08 TRAFFIC CONTROL DEVICES
- 720001-01 SIGN PANEL MOUNT DETAILS
- 720006-04 SIGN PANEL ERECTION DETAILS
- 728001-01 TELESCOPING STEEL SIGN SUPPORT

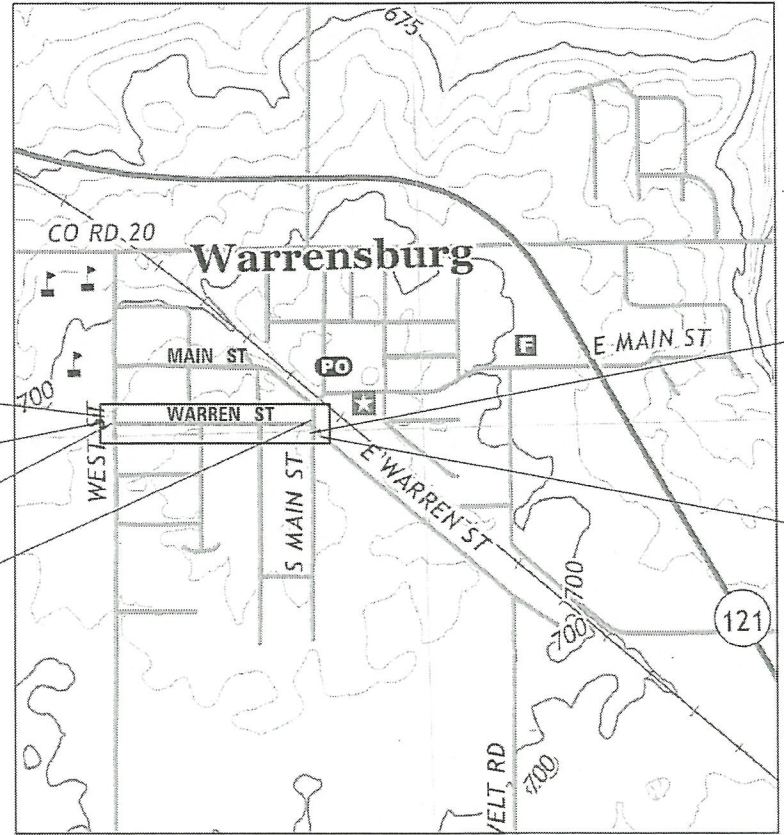

END SIDEWALK WEST ST  
STA 1009 + 15.41

BEGIN SIDEWALK WEST ST  
STA 1008 + 74.18

BEGIN SIDEWALK WARREN ST  
STA 4000 + 09.72

END SIDEWALK WARREN ST  
STA 4013 + 24.46

BEGIN SIDEWALK WARREN ST  
STA 5000 + 03.10

END SIDEWALK WARREN ST  
STA 5000 + 74.78

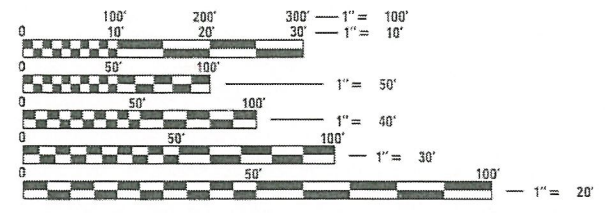

FULL SIZE PLANS HAVE BEEN PREPARED USING STANDARD ENGINEERING SCALES. REDUCED SIZED PLANS WILL NOT CONFORM TO STANDARD SCALES. IN MAKING MEASUREMENTS ON REDUCED PLANS, THE ABOVE SCALES MAY BE USED.

J.U.L.I.E.  
JOINT UTILITY LOCATION INFORMATION FOR EXCAVATION  
1-800-892-0123  
OR 811

**CHASTAIN & ASSOCIATES LLC**  
CONSULTING ENGINEERS

DECATUR, IL  
ROCKFORD, IL  
BENTON, IL  
BELOIT, WI  
(833) 424-2782

SCHAUMBURG, IL  
CHAMPAIGN, IL  
LAFAYETTE, IN  
PADUCAH, KY  
184-001397

	WEST ST.	WARREN ST.
ADT:	375	650
DESIGN SPEED:	30 MPH	30 MPH
ROAD CLASSIFICATION:	LOCAL STREET	LOCAL STREET

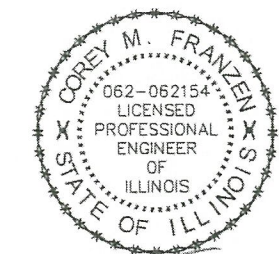

COREY M. FRANZEN, P.E. DATE 12/20/22  
LICENSE EXPIRES 11/30/23

STATE OF ILLINOIS  
DEPARTMENT OF TRANSPORTATION  
DIVISION OF HIGHWAYS

APPROVED: [Signature] VILLAGE OF WARRENSBURG

PASSED: 12/27/22 [Signature]

RELEASED FOR BID BASED ON LIMITED REVIEW: 12/27/22 [Signature] REGIONAL ENGINEER

PRINTED BY THE AUTHORITY OF THE STATE OF ILLINOIS

CONTRACT NO. 95915

GENERAL NOTES

**ALIGNMENT - WEST STREET**

```

=====
POT      N 1,189,202.1832  E 778,399.3183  Sta 17+00.00
Course from POT to POT  N 0° 42' 36.82" E Dist 53.03
POT      N 1,189,255.2077  E 778,399.9756  Sta 17+53.03
Course from POT to POT  N 0° 42' 36.82" E Dist 5.0000
POT      N 1,189,260.2073  E 778,400.0376  Sta 17+58.03
Course from POT to PI   N 0° 42' 36.82" E Dist 25.1734
PI       N 1,189,285.3788  E 778,400.3496  Sta 17+83.20
Course from PI to POT  N 1° 42' 06.58" W Dist 5.0044
Point POT N 1,189,290.3810  E 778,400.2010  Sta 17+88.21
=====
    
```

**ALIGNMENT - WARREN STREET**

```

=====
Point POT N 1,189,259.6383  E 778,445.5347  Sta 20+00.00
Course from POT to POT  S 89° 17' 00.41" E Dist 1,330.0638
Point POT N 1,189,243.0046  E 779,775.4946  Sta 33+30.06
=====
    
```

- EXCEPT WHERE DESIGNATED OTHERWISE, THE LOCATIONS AND/OR DEPTHS OF ABOVE GROUND AND UNDERGROUND UTILITIES SHOWN MUST BE CONSIDERED APPROXIMATE. THE CONTRACTOR SHALL BE RESPONSIBLE FOR DETERMINING EXACT LOCATIONS OF ALL UTILITIES. CONTACT JULIE AT 1-800-892-0123 OR 811 AND ALL OTHER UTILITY OWNERS PRIOR TO EXCAVATION OR CONSTRUCTION. THE CONTRACTOR SHALL USE SPECIAL CARE WHEN CONDUCTING OPERATIONS NEAR UTILITIES SO AS TO PREVENT DAMAGE TO THEM.
- WHERE EXISTING UTILITY POLES OR OTHER APPURTENANCES INTERFERE WITH THE FULL CONSTRUCTED WIDTH OF THE SIDEWALK, THE SIDEWALK SHALL BE CONSTRUCTED TO THE LINES AND GRADES SHOWN ON THE PLANS EXCEPT THAT A NOTCH OF SIDEWALK SHALL BE OMITTED AT THE INTERFERENCE. THE NOTCH SHALL BE TAPERED FROM THE FULL SIDEWALK WIDTH TO THE REDUCED WIDTH AT A RATE OF 1:1 EACH SIDE. MAINTAIN A MINIMUM WIDTH OF FOUR FEET (4') AT ALL NEW SIDEWALK LOCATIONS. THIS METHOD OF CONSTRUCTION SHALL APPLY AT LOCATIONS WHERE WATER METERS ARE NOT TO BE ADJUSTED OR RELOCATED. USE PREFORMED JOINT FILLER WHERE THE SIDEWALK IS DIRECTLY ADJACENT TO EACH ITEM.
- CLASS D PATCHES ARE SPECIFIED AT ISOLATED LOCATIONS WHERE THE EXISTING PAVEMENT CONSISTS OF AN OIL AND CHIP SURFACE. THE THICKNESS OF EACH HMA PAVEMENT PATCH SHALL BE 5" UNLESS OTHERWISE DIRECTED BY THE ENGINEER. IF ADJUSTMENTS TO THE THICKNESS ARE REQUIRED, QUANTITIES SHALL BE ADJUSTED ACCORDING TO ARTICLE 442.10. EXCAVATION REQUIRED TO PLACE THE PAVEMENT SHALL BE INCLUDED IN THE COST OF THE PATCH.
- PAVEMENT PATCHES SHALL BE CONSTRUCTED TO MATCH THE ELEVATIONS OF THE SIDEWALK RAMPS WHERE THEY MEET. PORTIONS OF THE PERIMETER OF EACH PATCH ADJACENT TO EXISTING PAVEMENT SHALL BE CONSTRUCTED TO MATCH THE ELEVATIONS OF THE EXISTING PAVEMENT. THE REMAINDER OF THE PERIMETER SHALL BE CONSTRUCTED AS A SMOOTH TRANSITION FROM THE SIDEWALK RAMPS TO THE EXISTING PAVEMENT ELEVATIONS. CROSS SLOPES SHALL BE GENERALLY PLANAR SLOPING DOWN TOWARD THE SIDEWALK RAMPS.
- NEATLY GRADE AREAS OF DISTURBANCE ADJACENT TO SIDEWALK CONSTRUCTION WITH TRANSITIONS TO EXISTING GRADE TO MAINTAIN DRAINAGE. PRE- CONSTRUCTION DRAINAGE PATTERNS SHALL BE MAINTAINED. COORDINATE WITH THE ENGINEER FOR ITEMS OF CONSTRUCTION THAT MAY IMPEDE DRAINAGE. UPON COMPLETION OF CONSTRUCTION, ALL DISTURBED AREAS SHALL BE SEEDED AND MULCHED IN ACCORDANCE WITH SECTION 250 AND SECTION 251 OF THE STANDARD SPECIFICATIONS.
- AT LOCATIONS WHERE SIDEWALK CONSTRUCTION CROSSES OR ABUTS EXISTING AGGREGATE DRIVEWAYS (INCLUDING OIL AND CHIP), THE MATERIAL EXCAVATED FROM WITHIN THE DRIVEWAY SHALL BE STOCKPILED AND USED TO BACKFILL THE EXCAVATION ADJACENT TO THE NEW SIDEWALK. COMPACTION OF THE BACKFILL MATERIAL SHALL BE TO THE SATISFACTION OF THE ENGINEER. THIS WORK WILL BE INCLUDED IN THE COST OF THE SIDEWALK.
- SIDEWALK RAMPS SHALL MEET STABLE PAVEMENT AT STREET LOCATIONS WHERE THEY MEET AN EXISTING OIL AND CHIP PAVEMENT SURFACE. LOOSE GRAVEL OR CHIP SHALL BE SWEEPED AWAY PRIOR TO ESTABLISHING THE FINAL MATCH ELEVATIONS. THIS WORK WILL NOT BE PAID FOR SEPARATELY, BUT INCLUDED IN THE COST OF THE SIDEWALK.
- WHERE PERMANENT SIGNS INTERFERE WITH CONSTRUCTION THE CONTRACTOR SHALL COORDINATE WITH THE ENGINEER FOR TEMPORARY SIGN PLACEMENT. THE VILLAGE OF WARRENSBURG WILL REMOVE DUPLICATE SIGN ASSEMBLIES CONTAINING R2-1 SIGNS WHERE NEW R2-1 SIGNS ARE SPECIFIED.
- ALL SAW CUTS FOR REMOVAL WILL NOT BE PAID FOR SEPARATELY, BUT SHALL BE INCLUDED IN THE COST OF THE REMOVAL ITEMS.
- THE CONTRACTOR SHALL TAKE REASONABLE PRECAUTIONS TO PROTECT PUBLIC AND PRIVATE PROPERTY. IF AT ANY TIME THE CONTRACTOR DAMAGES OR DESTROYS PUBLIC OR PRIVATE PROPERTY, THE CONTRACTOR SHALL, AT HIS OWN EXPENSE, RESTORE SUCH PROPERTY TO A CONDITION EQUAL TO THAT EXISTING BEFORE SUCH DAMAGE.
- IT IS THE CONTRACTOR'S RESPONSIBILITY TO VERIFY ALL DIMENSIONS AND CONDITIONS EXISTING IN THE FIELD PRIOR TO CONSTRUCTION AND ORDERING MATERIALS.
- THE CONTRACTOR SHALL BE SOLELY RESPONSIBLE FOR THE MEANS, METHODS, TECHNIQUES, SEQUENCE AND PROCEDURES OF CONSTRUCTION.
- ALL ELEVATIONS ARE BASED ON THE NORTH AMERICAN VERTICAL DATUM OF 1988 (NAVD 88). THE PROPOSED GRADE ELEVATIONS SHOWN ON THE PLAN AND PROFILE SHEETS ARE THE ELEVATIONS FOR THE FINISHED SURFACE AT LOCATIONS AS INDICATED.
- ALL COORDINATES SHOWN ARE BASED ON THE ILLINOIS COORDINATE SYSTEM, EAST ZONE, NORTH AMERICAN DATUM OF 1983, ADJUSTMENT OF 2011 (NAD1983).

**BITUMINOUS MIXTURE REQUIREMENTS**

MIXTURE USES	AC/PG	DESIGN AIR VOIDS	MIXTURE COMPOSITION	FRICTION AGGREGATE
HMA PATCHES	PG-64-22	4.0% @ N <sub>v</sub> =50	IL-9.5	MIX C

Benchmark	Elev(Z)	Description	Station	Offset	Alignment
BM#3	712.92	"T" IN TENN ON THE FIRE HYDRANT NE OF WARREN ST AND POWERS ST	25+40	9' RT.	Warren St
BM#6	709.71	"M" IN MUELLER ON THE FIRE HYDRANT SE OF WEST ST AND WARREN ST	16+94	74' RT.	West St

Control Point#	North(Y)	East(X)	Elev(Z)	Description	Station	Offset	Alignment
1	1189172.881	779700.968	710.28	1/2 IP W/ CAP, NE COR OF ILLINI PARK	32+56.58	71.05' RT.	Warren St
4	1189207.426	778471.122	706.63	1/2 IP W/ CAP, SE COR WEST & WARREN	20+26.24	51.89' RT.	Warren St
6	1189637.700	778869.604	707.18	1/2 IP W/ CAP, NW COR POWERS & W.MAIN			Main St
5	1188802.630	778397.986	708.59	1/2 IP W/ CAP, W.SIDE OF WEST ST OPP. HOUSE #300			West St

FILE NAME = I:\Municipalities\illage of Warrensburg\301.01\_SRTS W-L\_Grade\_Sch Ph. 2\CADD\CADD.Civil\301.01\_SHT02.gennotes.dgn

USER NAME = rkocher	DESIGNED - CMF	REVISED -
	DRAWN - RLK	REVISED -
PLOT SCALE = 40,0000' / in.	CHECKED - CMF	REVISED -
PLOT DATE = 9/13/2022	DATE - 7/13/2022	REVISED -



DECATUR, IL      SCHAUMBURG, IL  
 ROCKFORD, IL    CHAMPAIGN, IL  
 BENTON, IL       LAFAYETTE, IN  
                          PADUCAH, KY  
 (833) 424-2782      184-001397

<b>WARRENSBURG SRTS SIDEWALK IMPROVEMENTS GENERAL NOTES, ALIGNMENT, &amp; BENCHMARKS</b>			
SCALE: N/A	SHEET NO. 1 OF 1 SHEETS	STA. TO STA.	

F.A. RTE.	SECTION	COUNTY	TOTAL SHEETS	SHEET NO.
	19-00001-00-SW	MACON	10	2
<b>CONTRACT NO. 95915</b>				
ILLINOIS FED. AID PROJECT				

FILE NAME: J:\Municipalities\illage of Warrensburg\7301.01 SRTS W-L Grade Sch Ph 2\CAD\CA00.Civil\7301.01\_SMT103\_500.dgn

CODE NO.	ITEM	UNIT	TOTAL QUANTITY
42400800	DETECTABLE WARNINGS	SQ FT	120
44000600	SIDEWALK REMOVAL	SQ FT	5354
44201711	CLASS D PATCHES, TYPE IV, 5 INCH	SQ YD	42
50105220	PIPE CULVERT REMOVAL	FOOT	35
542D0215	PIPE CULVERTS, CLASS D, TYPE 1 10"	FOOT	42
542D0217	PIPE CULVERTS, CLASS D, TYPE 1 12"	FOOT	12
60600605	CONCRETE CURB, TYPE B	FOOT	27
67100100	MOBILIZATION	L SUM	1
* 72000100	SIGN PANEL - TYPE 1	SQ FT	42
* 72800100	TELESCOPING STEEL SIGN SUPPORT	FOOT	81
* 78001180	PAINT PAVEMENT MARKING - LINE 24"	FOOT	144
X4240430	PORTLAND CEMENT CONCRETE SIDEWALK 5 INCH, SPECIAL	SQ FT	6376
X4240440	PORTLAND CEMENT CONCRETE SIDEWALK 6 INCH, SPECIAL	SQ FT	901
X7010216	TRAFFIC CONTROL AND PROTECTION, (SPECIAL)	L SUM	1

\* SPECIALTY ITEMS

USER NAME: r.kocher	DESIGNED - CMF	REVISED -
DRAWN - RLK	CHECKED - CMF	REVISED -
PLOT SCALE = 28.0000 1" = 100'	DATE - 7/13/2022	REVISED -
PLOT DATE = 9/14/2022		

**CHASTAIN & ASSOCIATES LLC**  
CONSULTING ENGINEERS

DECATUR, IL    SCHAUMBURG, IL  
ROCKFORD, IL    CHAMPAIGN, IL  
BENTON, IL    LAFAYETTE, IN  
                  PADUCAH, KY  
(833) 424-2782    184-001397

**WARRENSBURG SRTS SIDEWALK IMPROVEMENTS**  
**SUMMARY OF QUANTITIES**

SCALE: N/A    SHEET NO. 1 OF 1 SHEETS    STA.    TO STA.

F.A. RTE.	SECTION	COUNTY	TOTAL SHEETS	SHEET NO.
	19-00001-00-SW	MACON	10	3
			CONTRACT NO. 95915	
ILLINOIS FED. AID PROJECT				

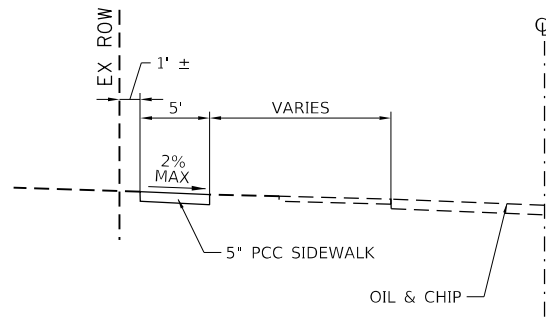

**WARREN STREET  
TYPICAL CROSS SECTION**

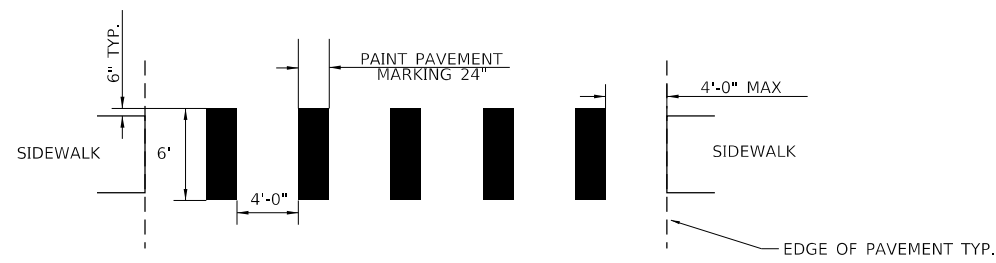

**LONGITUDINAL  
TYPICAL STRIPING DETAIL**

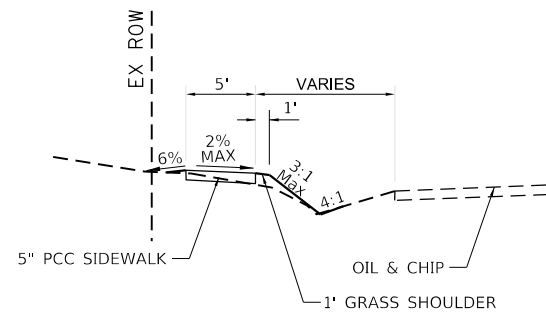
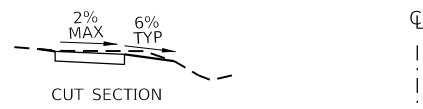

**WEST STREET  
TYPICAL CROSS SECTION**

FILE NAME = I:\Municipalities\illage of Warrensburg\7301.01 SRTS W-L Grade Sch Ph 2\CADD\CADD.Gw1\7301.01\_SHT04\_tgsaecs\_REV.dgn

USER NAME = rkocher	DESIGNED - CMF	REVISED -
	DRAWN - RLK	REVISED -
PLOT SCALE = 40.0000' / 1" =	CHECKED - CMF	REVISED -
PLOT DATE = 9/13/2022	DATE - 7/13/2022	REVISED -

**CHASTAIN  
& ASSOCIATES LLC**  
CONSULTING ENGINEERS

DECATUR, IL      SCHAUMBURG, IL  
ROCKFORD, IL    CHAMPAIGN, IL  
BENTON, IL       LAFAYETTE, IN  
                         PADUCAH, KY  
(833) 424-2782      184-001397

**WARRENSBURG SRTS SIDEWALK IMPROVEMENTS  
TYPICAL SECTIONS & DETAILS**

SCALE:      SHEET NO.    OF    SHEETS    STA.      TO STA.

F.A. RTE.	SECTION	COUNTY	TOTAL SHEETS	SHEET NO.
	19-00001-00-SW	MACON	10	4
			CONTRACT NO. 95915	
ILLINOIS FED. AID PROJECT				

PLAN	SURVEYED	BY	DATE
	PLOTTED		
	GRADES CHECKED		
	STRUCTURE NOTATIONS CHECKED		
	NOTE BOOK NO.		
	CHECKED BY		
	FILE NAME		

PROFILE	SURVEYED	BY	DATE
	PLOTTED		
	GRADES CHECKED		
	STRUCTURE NOTATIONS CHECKED		
	NOTE BOOK NO.		
	CHECKED BY		
	FILE NAME		

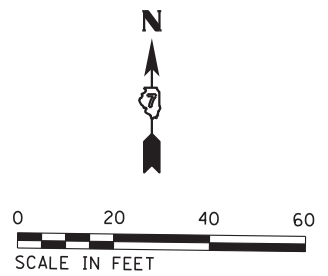
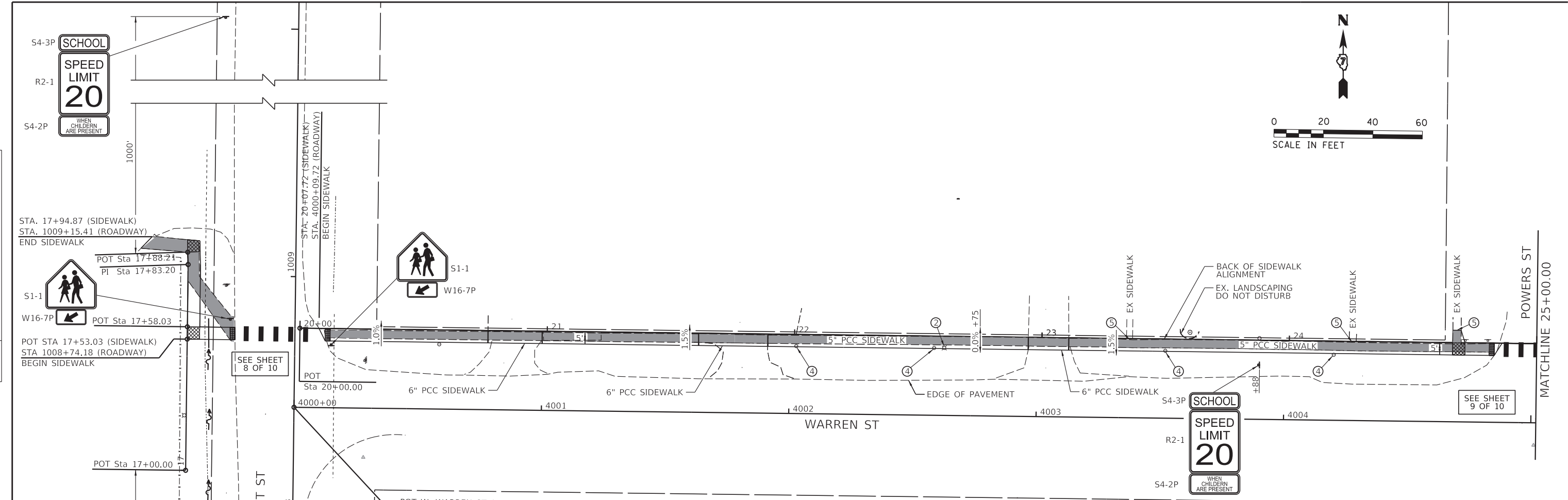

**LEGEND**

- 709.61 TOP OF SIDEWALK ELEV. U.N.O.
- SIDEWALK REMOVAL
- LEVEL LANDING TO BE CONSTRUCTED - 5X5' DIMENSION UNLESS OTHERWISE NOTED. SLOPE IN EACH DIRECTION IS 1.0% UNLESS OTHERWISE NOTED.
- 2'-0" WIDE DETECTABLE WARNING SURFACE
- ① GUY WIRES FOR UTILITY POLE TO REMAIN. DO NOT DISTURB.
- ② LIGHT OR UTILITY POLE TO REMAIN.
- ③ SIGN TO BE RELOCATED (BY OTHERS).
- ④ WATER METER TO BE AVOIDED OR RELOCATED. COORDINATE WITH THE VILLAGE. RELOCATION BY THE VILLAGE WHERE REQUIRED.
- ⑤ SAWCUT EXISTING SIDEWALK OR PAVEMENT. NEW SIDEWALK ELEVATION TO MATCH (±1/4").

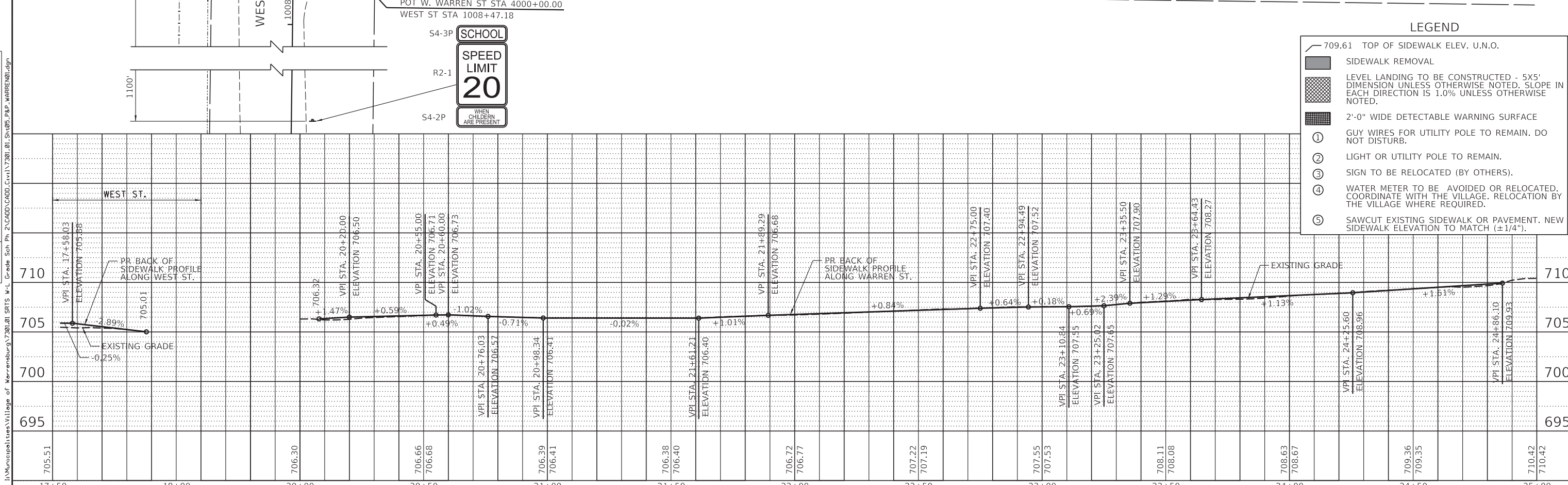

USER NAME = rkocher DESIGNED - CMF DRAWN - RLK PLOT SCALE = 20.0000' / in. PLOT DATE = 9/14/2022		REVISIONS REVISIONS - REVISIONS - REVISIONS - REVISIONS -		<b>CHASTAIN &amp; ASSOCIATES LLC</b> CONSULTING ENGINEERS DECATUR, IL    SCHAUMBURG, IL ROCKFORD, IL    CHAMPAIGN, IL BENTON, IL    LAFAYETTE, IN PADUCAH, KY (833) 424-2782    184-001397		<b>WARRENSBURG SRTS SIDEWALK IMPROVEMENTS</b> <b>WARREN STREET PLAN AND PROFILE</b> SCALE:    SHEET NO. 1 OF 3 SHEETS    STA. 20+00.00 TO STA. 25+00.00		F.A. RTÉ.    SECTION    COUNTY    TOTAL SHEETS    SHEET NO. 19-00001-00-SW    MACON    10    5		CONTRACT NO. 95915 ILLINOIS FED. AID PROJECT	
--	--	---	--	--	--	---	--	---	--	---	--

I:\Municipalities\Warrensburg\7301.01 SRTS W-L Grade Sch Ph 2\CADD\CADD-Civil\7301.01.Sta05.P&P.WARREN01.dgn

PLAN	SURVEYED	BY	DATE
	PLOTTED		
	GRADES CHECKED		
	ALIGNMENT CHECKED		
	STRUCTURE NOTATIONS CHKD		
	NO. _____		
	CADD FILE NAME		

PROFILE	SURVEYED	BY	DATE
	PLOTTED		
	GRADES CHECKED		
	ALIGNMENT CHECKED		
	STRUCTURE NOTATIONS CHKD		
	NO. _____		
	CADD FILE NAME		

I:\Municipalities\Warrensburg\7301.01 SRIS W-L Grade Sch Ph 2\CADD\CADD-Civil\7301.01\_Sch06-P&P-WARREN02.dgn

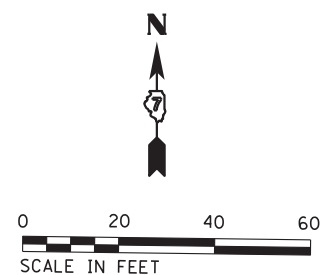
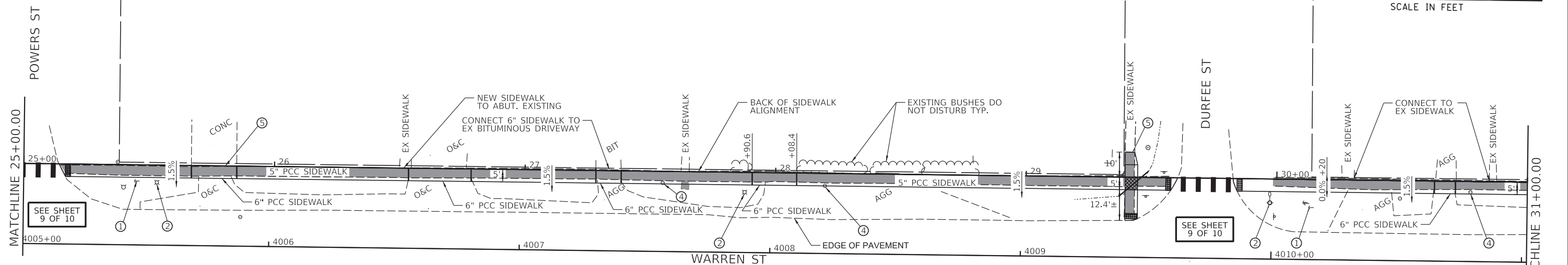

**LEGEND**

- 709.61 TOP OF SIDEWALK ELEV. U.N.O.
- SIDEWALK REMOVAL
- ▨ LEVEL LANDING TO BE CONSTRUCTED - 5X5' DIMENSION UNLESS OTHERWISE NOTED. SLOPE IN EACH DIRECTION IS 1.0% UNLESS OTHERWISE NOTED.
- 2'-0" WIDE DETECTABLE WARNING SURFACE
- ① GUY WIRES FOR UTILITY POLE TO REMAIN. DO NOT DISTURB.
- ② LIGHT OR UTILITY POLE TO REMAIN.
- ③ SIGN TO BE RELOCATED (BY OTHERS).
- ④ WATER METER TO BE AVOIDED OR RELOCATED. COORDINATE WITH THE VILLAGE. RELOCATION BY THE VILLAGE WHERE REQUIRED.
- ⑤ SAWCUT EXISTING SIDEWALK OR PAVEMENT. NEW SIDEWALK ELEVATION TO MATCH (±1/4").

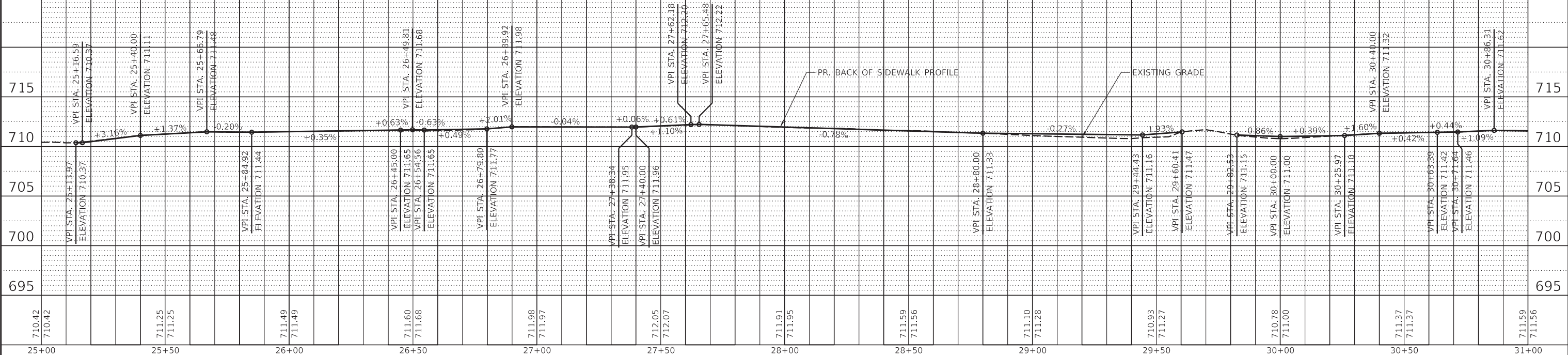

USER NAME = rkocher	DESIGNED - CMF	REVISED -
	DRAWN - RLK	REVISED -
PLOT SCALE = 20.0000' / in.	CHECKED - CMF	REVISED -
PLOT DATE = 9/13/2022	DATE - 7/13/2022	REVISED -

**CHASTAIN & ASSOCIATES LLC**  
CONSULTING ENGINEERS

DECATUR, IL      SCHAUMBURG, IL  
ROCKFORD, IL    CHAMPAIGN, IL  
BENTON, IL       LAFAYETTE, IL  
                                 PADUCAH, KY

(833) 424-2782      184-001397

**WARRENSBURG SRIS SIDEWALK IMPROVEMENTS**  
**WARREN STREET PLAN AND PROFILE**

SCALE:      SHEET NO. 2 OF 3 SHEETS      STA. 25+00.00 TO STA. 31+00.00

F.A. RTÉ.	SECTION	COUNTY	TOTAL SHEETS	SHEET NO.
	19-0001-00-SW	MACON	10	6
CONTRACT NO. 95915				
ILLINOIS FED. AID PROJECT				

PLAN	SURVEYED	DATE
	PLOTTED	
	GRADES CHECKED	
	STRUCTURE NOTATIONS CHECKED	
	NO. _____	
	DATE _____	

PROFILE	SURVEYED	DATE
	PLOTTED	
	GRADES CHECKED	
	STRUCTURE NOTATIONS CHECKED	
	NO. _____	
	DATE _____	

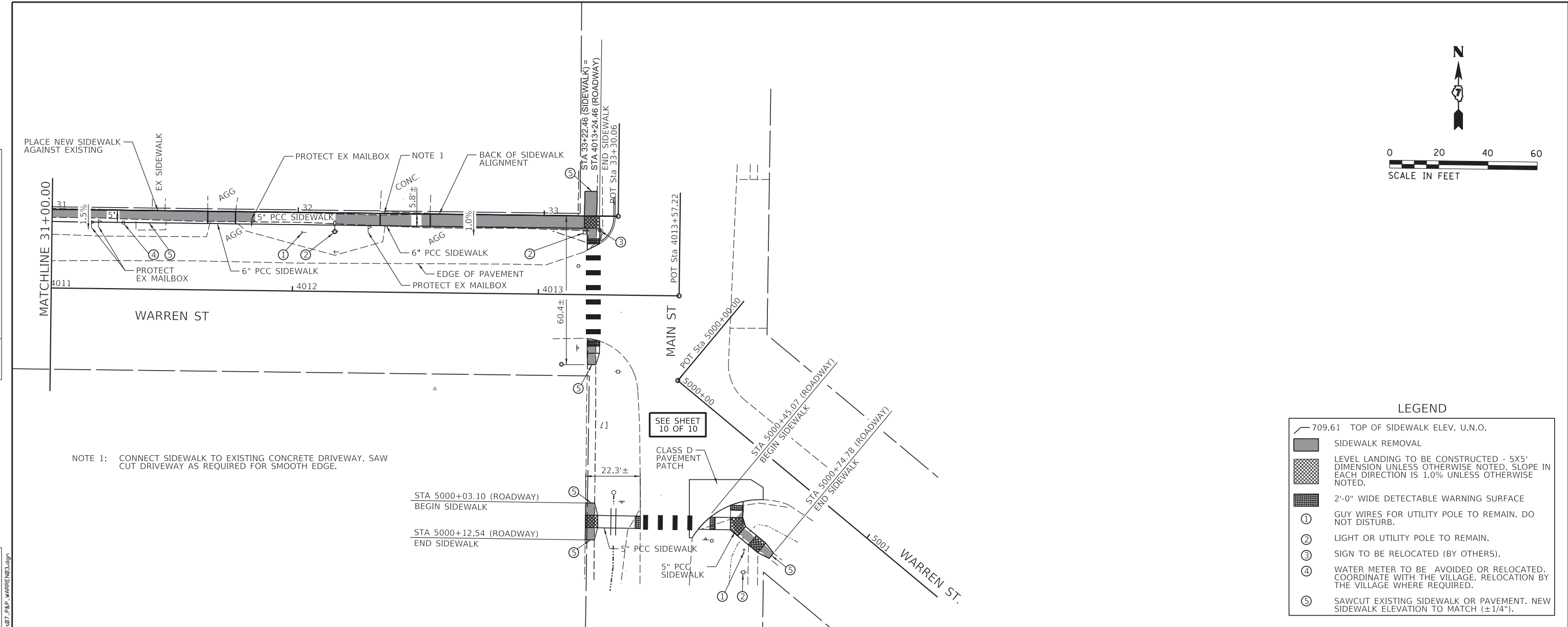

NOTE 1: CONNECT SIDEWALK TO EXISTING CONCRETE DRIVEWAY. SAW CUT DRIVEWAY AS REQUIRED FOR SMOOTH EDGE.

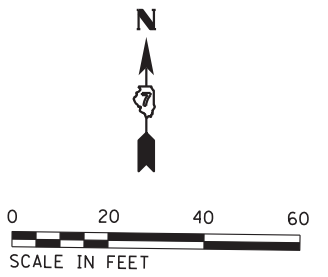

**LEGEND**

- 709.61 TOP OF SIDEWALK ELEV. U.N.O.
- █ SIDEWALK REMOVAL
- ▨ LEVEL LANDING TO BE CONSTRUCTED - 5X5' DIMENSION UNLESS OTHERWISE NOTED. SLOPE IN EACH DIRECTION IS 1.0% UNLESS OTHERWISE NOTED.
- ▩ 2'-0" WIDE DETECTABLE WARNING SURFACE
- ① GUY WIRES FOR UTILITY POLE TO REMAIN. DO NOT DISTURB.
- ② LIGHT OR UTILITY POLE TO REMAIN.
- ③ SIGN TO BE RELOCATED (BY OTHERS).
- ④ WATER METER TO BE AVOIDED OR RELOCATED. COORDINATE WITH THE VILLAGE. RELOCATION BY THE VILLAGE WHERE REQUIRED.
- ⑤ SAWCUT EXISTING SIDEWALK OR PAVEMENT. NEW SIDEWALK ELEVATION TO MATCH (±1/4").

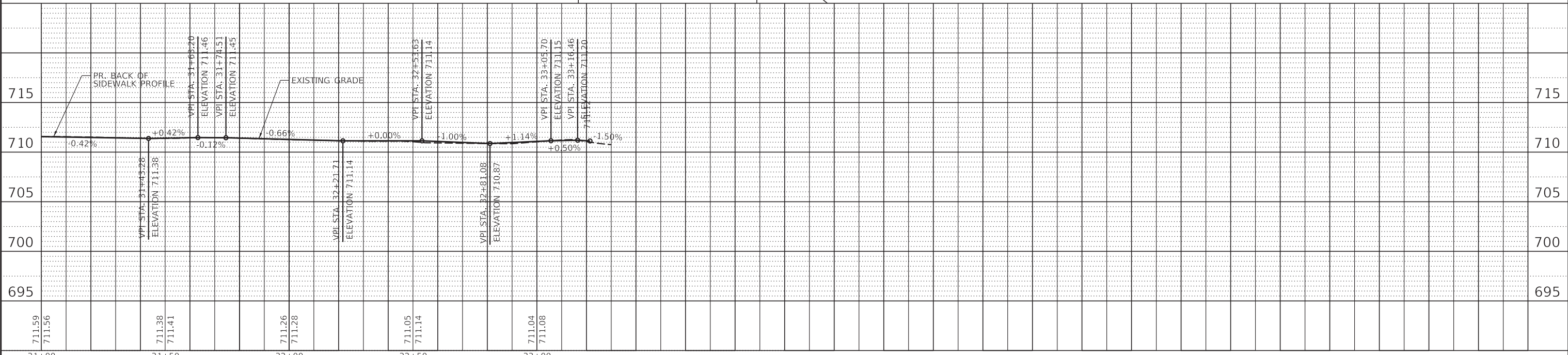

USER NAME = rkocher		DESIGNED - CMF	REVISED -	<b>CHASTAIN &amp; ASSOCIATES LLC</b> CONSULTING ENGINEERS DECATUR, IL    SCHAUMBURG, IL ROCKFORD, IL    CHAMPAIGN, IL BENTON, IL    LAFAYETTE, IN PADUCAH, KY (833) 424-2782    184-001397	<b>WARRENSBURG SRTS SIDEWALK IMPROVEMENTS</b> <b>WARREN STREET PLAN AND PROFILE</b>	F.A. RTÉ.	SECTION	COUNTY	TOTAL SHEETS	SHEET NO.
PLOT SCALE = 20.0000' / in.		CHECKED - CMF	REVISED -			19-00001-00-SW	MACON	10	7	
PLOT DATE = 9/13/2022		DATE - 7/13/2022	REVISED -			CONTRACT NO. 95915			ILLINOIS FED. AID PROJECT	
						SCALE:	SHEET NO. 3 OF 3 SHEETS	STA. 31+00.00 TO STA. 33+30.06		

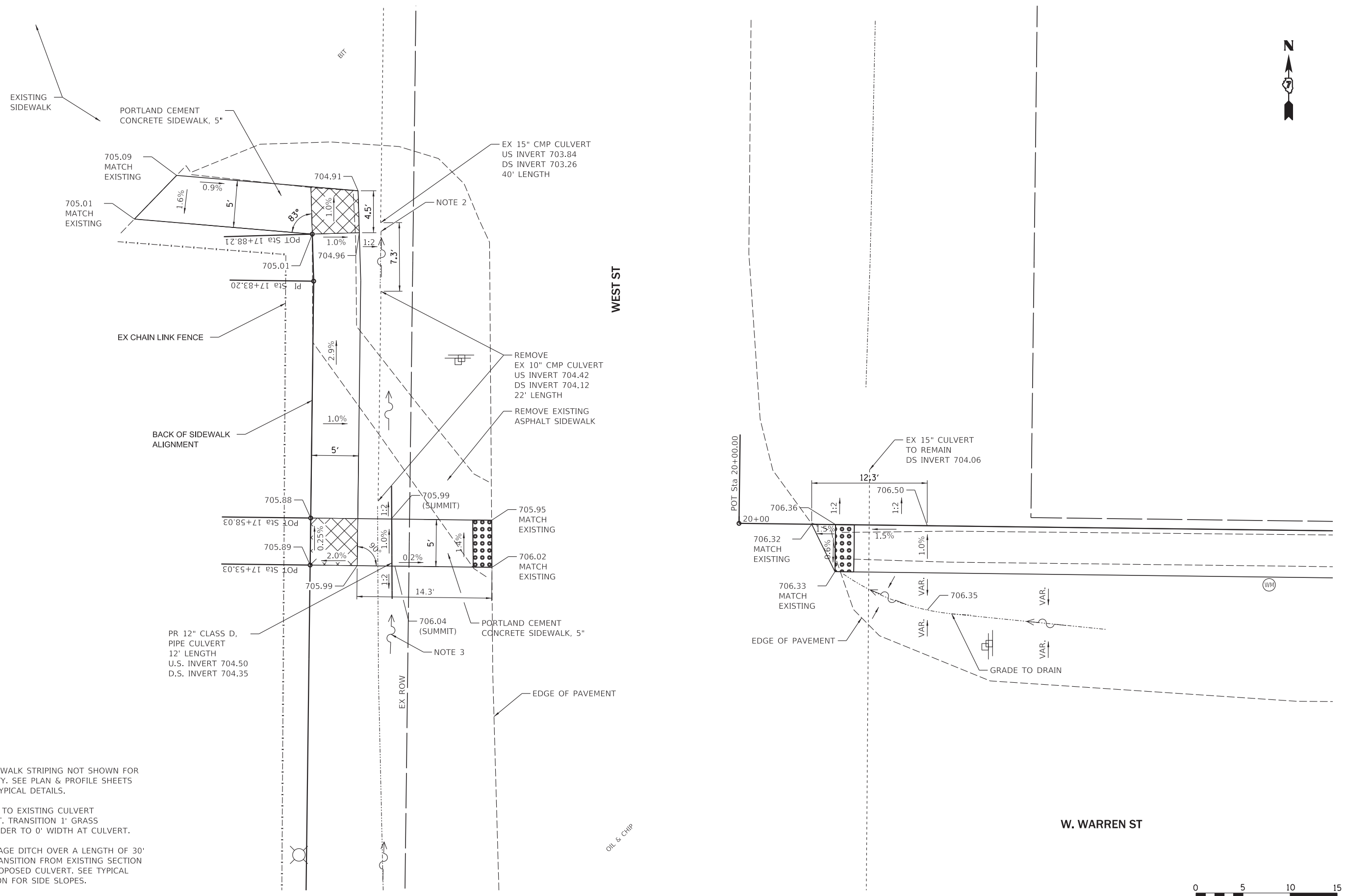

- NOTE 1: CROSSWALK STRIPING NOT SHOWN FOR CLARITY. SEE PLAN & PROFILE SHEETS AND TYPICAL DETAILS.
- NOTE 2: SLOPE TO EXISTING CULVERT INVERT. TRANSITION 1' GRASS SHOULDER TO 0' WIDTH AT CULVERT.
- NOTE 3: RE-GRADE DITCH OVER A LENGTH OF 30' TO TRANSITION FROM EXISTING SECTION TO PROPOSED CULVERT. SEE TYPICAL SECTION FOR SIDE SLOPES.



FILE NAME = I:\Municipalities\illage of Warrensburg\7301.01 SRTS W-L Grade Sch Ph 2\CADD\CADD.Civil\7301.01\_Sht08\_Ramp-Int\_Details01.dgn

USER NAME = rkocher	DESIGNED - CMF	REVISED -
	DRAWN - RLK	REVISED -
PLOT SCALE = 5.0000' / in.	CHECKED - CMF	REVISED -
PLOT DATE = 7/28/2022	DATE - 7/13/2022	REVISED -

**CHASTAIN & ASSOCIATES LLC**  
CONSULTING ENGINEERS

DECATUR, IL      SCHAUMBURG, IL  
ROCKFORD, IL    CHAMPAIGN, IL  
BENTON, IL       LAFAYETTE, IN  
                         PADUCAH, KY  
(833) 424-2782      184-001397

**WARRENSBURG SRTS SIDEWALK IMPROVEMENTS**  
**WESTWARREN RAMP AND INTERSECTION DETAILS**

SCALE: 1" = 5'    SHEET NO. 1 OF 1 SHEETS    STA. N/A    TO STA. N/A

F.A. RTE.	SECTION	COUNTY	TOTAL SHEETS	SHEET NO.
	19-00001-00-SW	MACON	10	8
CONTRACT NO. 95915				
ILLINOIS FED. AID PROJECT				



NOTE 1: GRADE FLOWLINE TO MEET CULVERT INVERTS AND DRAIN TO THE NORTH. GRADE 10' UPSTREAM AND 20' DOWNSTREAM.

NOTE 2: CROSSWALK STRIPING NOT SHOWN FOR CLARITY. SEE PLAN & PROFILE SHEETS AND TYPICAL DETAILS

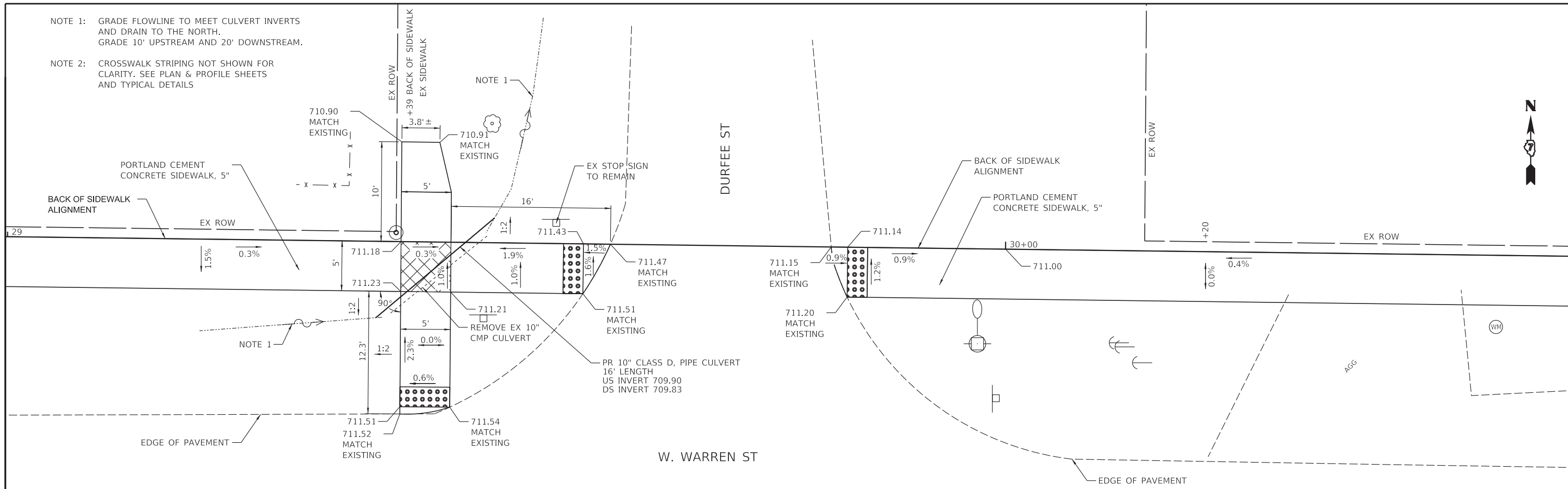

NOTE 1: CROSSWALK STRIPING NOT SHOWN FOR CLARITY. SEE PLAN & PROFILE SHEETS AND TYPICAL DETAILS.

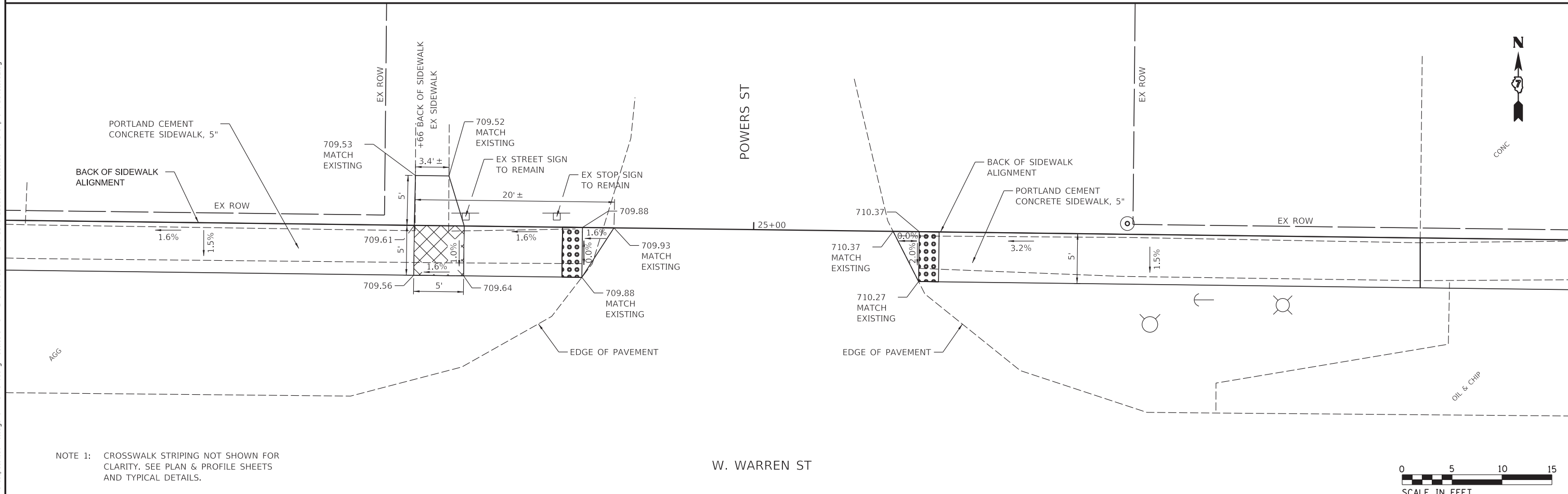

FILE NAME = I:\Municipalities\Warrensburg\7301.01\_SRTS W-L Grade Sch Ph 2\CADD\CADD.Gw1\7301.01\_Sht09\_Ramp-Int\_Details.dgn

USER NAME = rkocher	DESIGNED - CMF	REVISED -
	DRAWN - RLK	REVISED -
PLOT SCALE = 5.0000' / 1"	CHECKED - CMF	REVISED -
PLOT DATE = 7/28/2022	DATE - 7/13/2022	REVISED -

**CHASTAIN & ASSOCIATES LLC**  
CONSULTING ENGINEERS

DECATUR, IL      SCHAUMBURG, IL  
ROCKFORD, IL    CHAMPAIGN, IL  
BENTON, IL       LAFAYETTE, IN  
                         PADUCAH, KY  
(833) 424-2782      184-001397

**WARRENSBURG SRTS SIDEWALK IMPROVEMENTS**  
**WARRENPOWERS RAMP AND INTERSECTION DETAILS**

SCALE: 1" = 5'    SHEET NO. 1 OF 1 SHEETS    STA. N/A    TO STA. N/A

F.A. RTE.	SECTION	COUNTY	TOTAL SHEETS	SHEET NO.
	19-0001-00-SW	MACON	10	9
CONTRACT NO. 95915				
ILLINOIS FED. AID PROJECT				

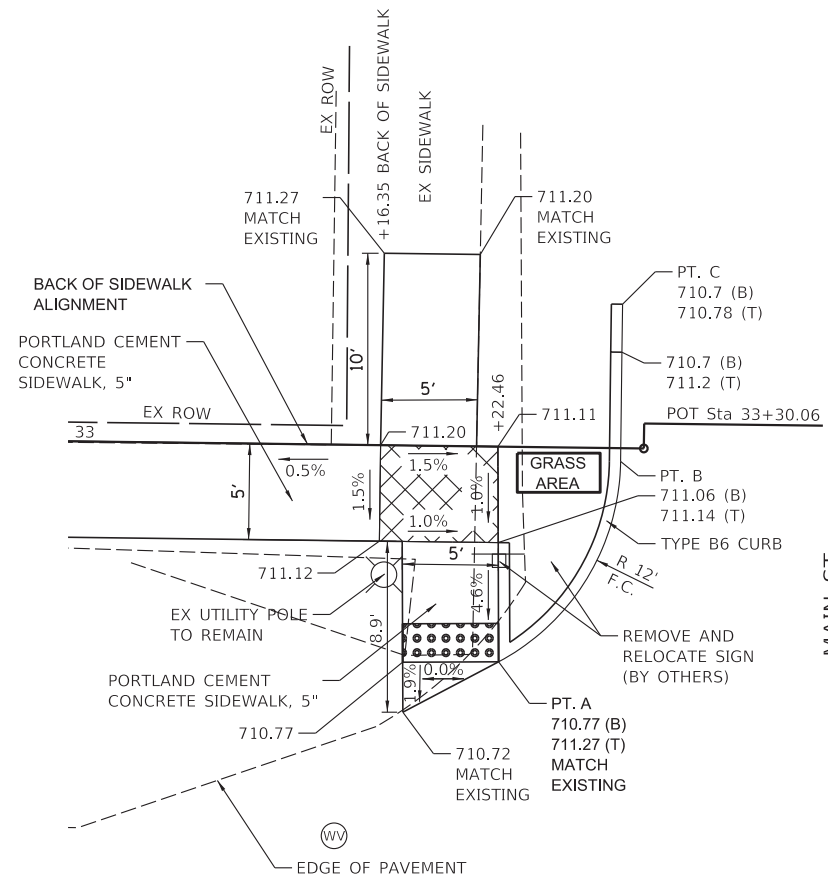

NOTE: (B) DENOTES BASE OF CURB ELEVATION AND (T) DENOTES TOP. PAVEMENT ELEVATIONS ARE APPROXIMATE AND SHOULD MATCH EXISTING.

W. WARREN ST

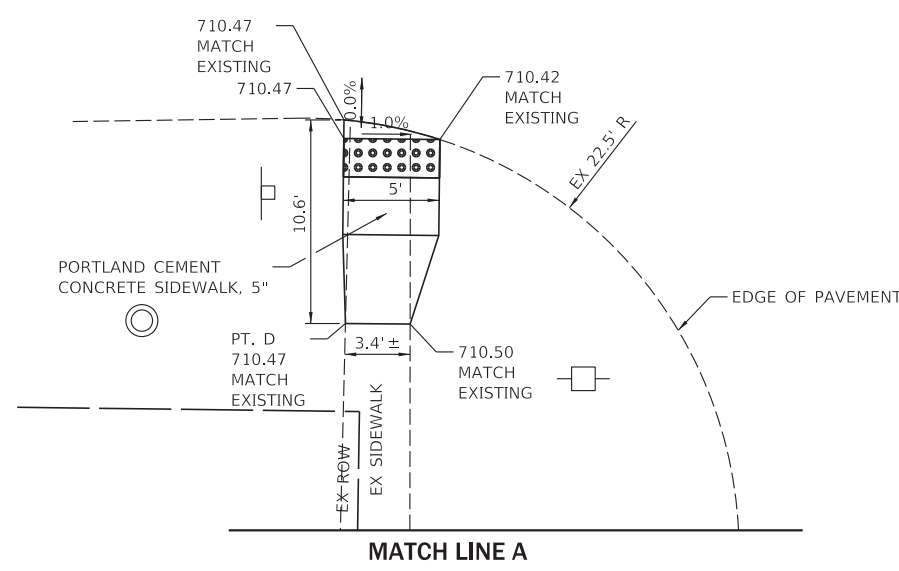

MATCH LINE A

NOTE 1: CROSSWALK STRIPING NOT SHOWN FOR CLARITY. SEE PLAN & PROFILE SHEETS AND TYPICAL DETAILS.

	NORTHING	EASTING
PT. A (PC)	1189231.8899	779767.9310
PT. B (PT)	1189242.3290	779774.2847
PT. C	1189250.5191	779774.3872
PT. D	1189182.7293	779763.0237
PT. E	1189116.4992	779762.1273
PT. F	1189115.8072	779807.9948
PT. G	1189115.6100	779821.0662
PT. H	1189112.3810	779804.4140
PT. I	1189136.0182	779804.4140

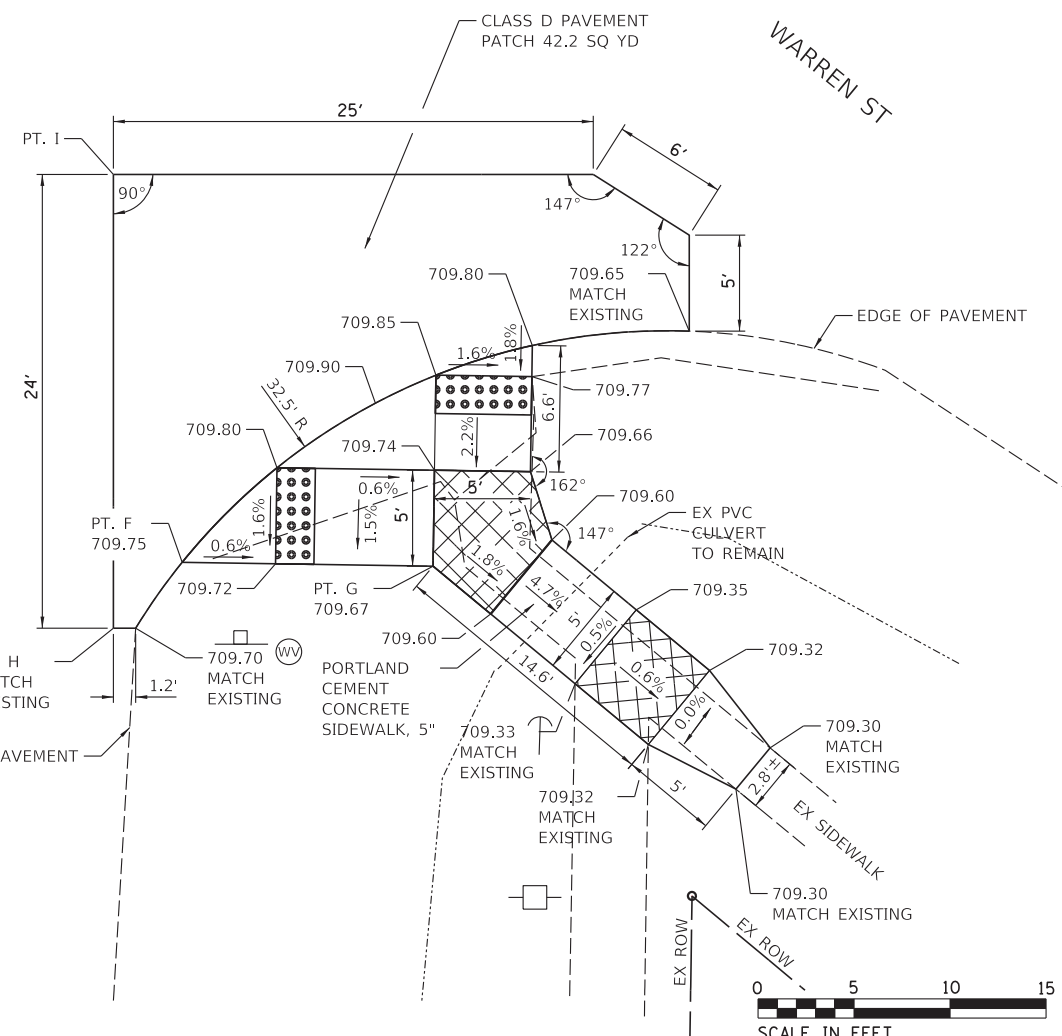
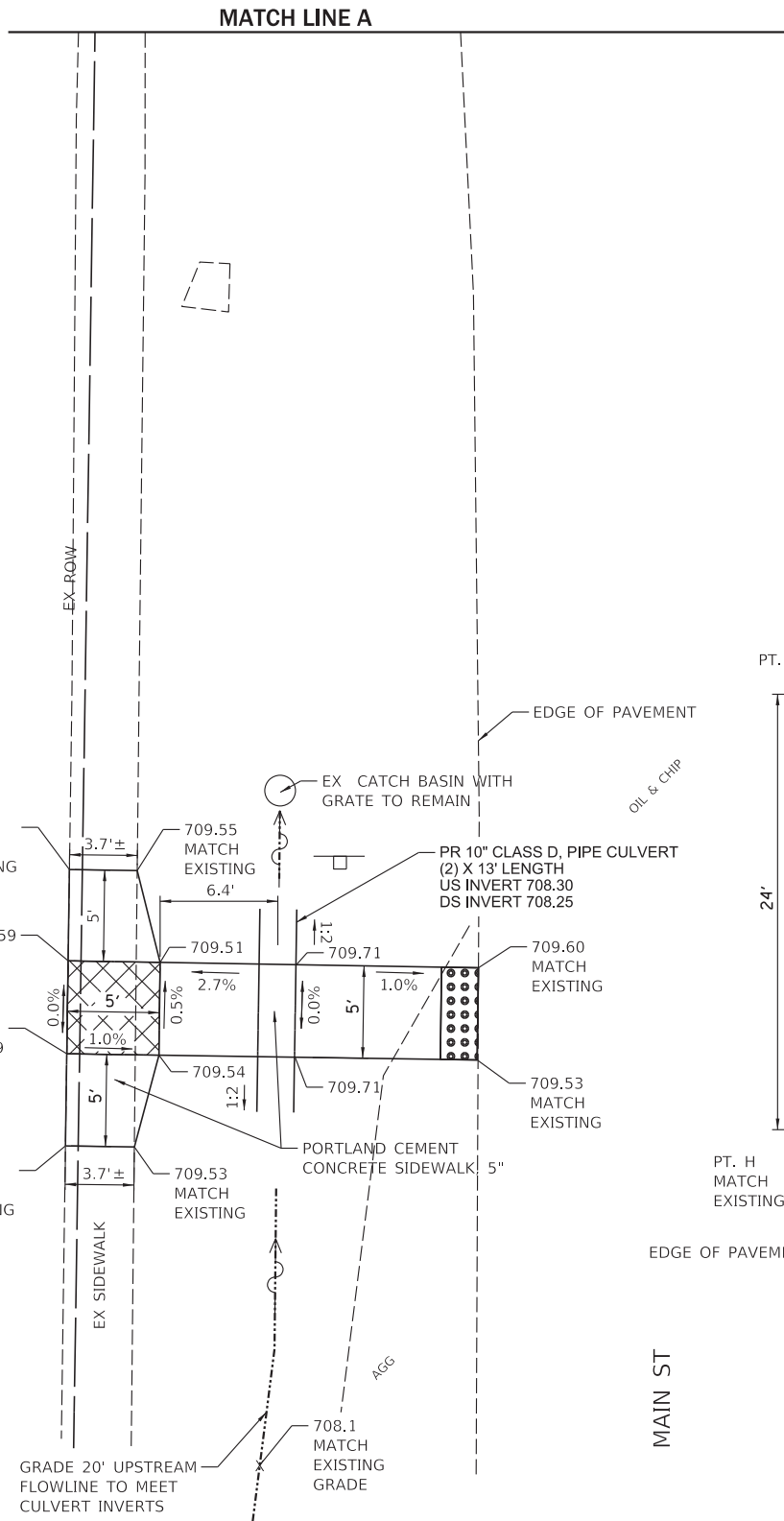

FILE NAME = I:\Municipalities\Warrensburg\7301.01\_SRTS W-L Grade Sch Ph 2\CADD\CADD.Civil\7301.01\_Sht10\_Ramp-Int\_Details03.dgn

USER NAME = rkoacher	DESIGNED - CMF	REVISED -
PLOT SCALE = 5.0000' / 1"	DRAWN - RLK	REVISED -
PLOT DATE = 7/28/2022	CHECKED - CMF	REVISED -
	DATE - 7/13/2022	REVISED -

**CHASTAIN & ASSOCIATES LLC**  
CONSULTING ENGINEERS

DECATUR, IL      SCHAUMBURG, IL  
ROCKFORD, IL    CHAMPAIGN, IL  
BENTON, IL       LAFAYETTE, IN  
                         PADUCAH, KY  
(833) 424-2782      184-001397

**WARRENSBURG SRTS SIDEWALK IMPROVEMENTS**  
**WARRENMAIN RAMP AND INTERSECTION DETAILS**

SCALE: 1" = 5'    SHEET NO. 1 OF 1 SHEETS    STA. N/A    TO STA. N/A

F.A. RTE.	SECTION	COUNTY	TOTAL SHEETS	SHEET NO.
	19-0001-00-SW	MACON	10	10
ILLINOIS FED. AID PROJECT			CONTRACT NO. 95915	