

FBI	SECTION	COUNTY	TOTAL SHEETS	SHEET NO.
90	1314B	COOK	160	20
FED. ROAD DIST. NO.		ILLINOIS FED. AID PROJECT		CONTRACT 60293

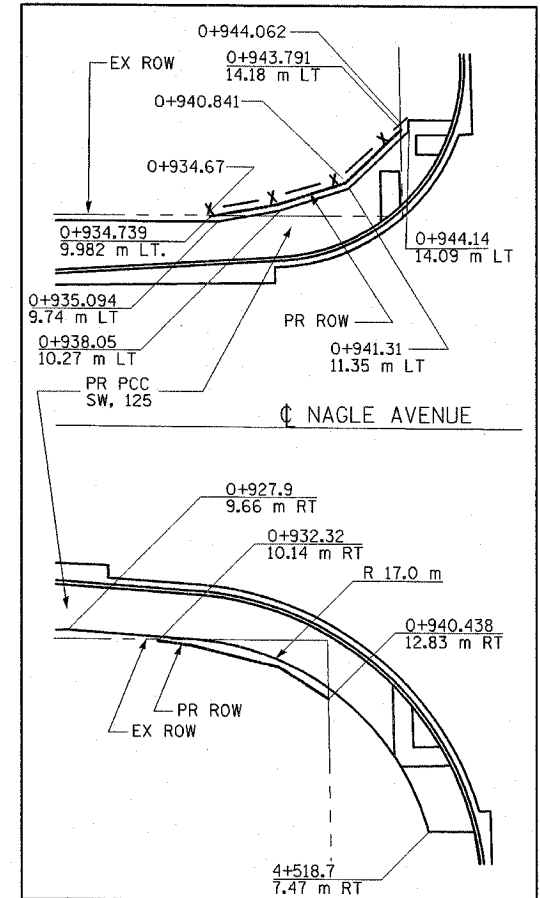
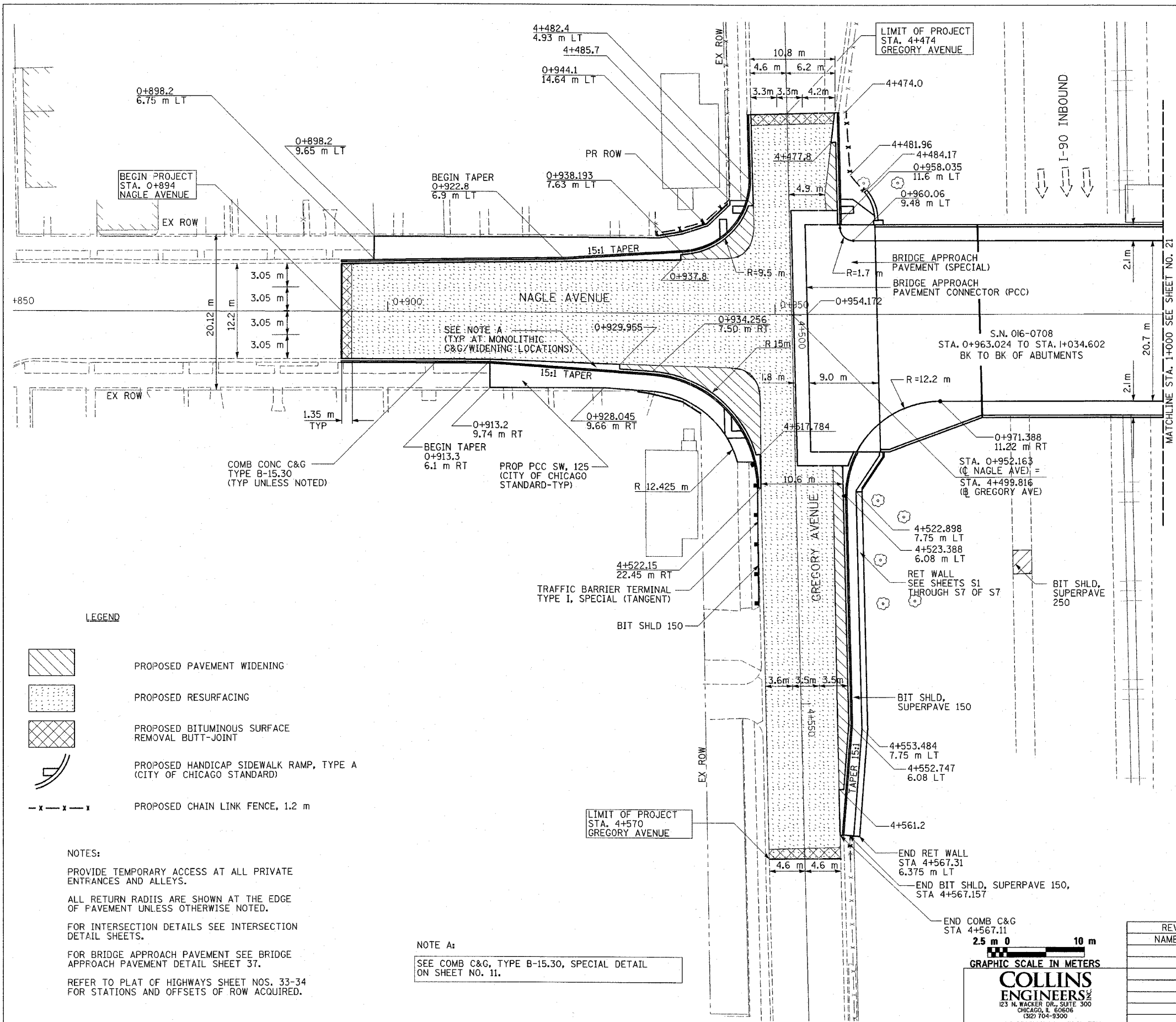

**CHAIN LINK FENCE AND SIDEWALK DETAIL**  
 (REFER TO PLAT OF HIGHWAYS SHEET NOS. 33-34 FOR STATIONS AND OFFSETS OF ROW ACQUISITION.)

**LEGEND**

- PROPOSED PAVEMENT WIDENING
- PROPOSED RESURFACING
- PROPOSED BITUMINOUS SURFACE REMOVAL BUTT-JOINT
- PROPOSED HANDICAP SIDEWALK RAMP, TYPE A (CITY OF CHICAGO STANDARD)
- PROPOSED CHAIN LINK FENCE, 1.2 m

**NOTES:**

PROVIDE TEMPORARY ACCESS AT ALL PRIVATE ENTRANCES AND ALLEYS.

ALL RETURN RADII ARE SHOWN AT THE EDGE OF PAVEMENT UNLESS OTHERWISE NOTED.

FOR INTERSECTION DETAILS SEE INTERSECTION DETAIL SHEETS.

FOR BRIDGE APPROACH PAVEMENT SEE BRIDGE APPROACH PAVEMENT DETAIL SHEET 37.

REFER TO PLAT OF HIGHWAYS SHEET NOS. 33-34 FOR STATIONS AND OFFSETS OF ROW ACQUIRED.

**NOTE A:**  
 SEE COMB C&G, TYPE B-15.30, SPECIAL DETAIL ON SHEET NO. 11.

2.5 m 0 10 m  
 GRAPHIC SCALE IN METERS

**COLLINS ENGINEERS**  
 123 N. WACKER DR., SUITE 300  
 CHICAGO, IL 60606  
 (312) 704-9300  
 ILLINOIS PROFESSIONAL DESIGN FIRM  
 LICENSE NO. 184-000993

REVISIONS	
NAME	DATE

ILLINOIS DEPARTMENT OF TRANSPORTATION

PROPOSED ROADWAY PLAN  
 NAGLE AVENUE AND  
 GREGORY AVENUE

DATE: DECEMBER 2004

DRAWN BY: ML, DR, FD  
 CHECKED BY: JMH, MOK

FILE: G:\2724\CIVIL\EXHIBIT\NAGLE\2724023.dgn