

FAI RTE.	SECTION	COUNTY	TOTAL SHEETS	SHEET NO.
90	1314B	COOK	160	26
FED. ROAD DIST. NO.		ILLINOIS FED. AID PROJECT	CONTRACT 60293	

- NOTES:**
1. MAINTENANCE OF TRAFFIC, LANE CLOSURE, BARRICADES, AND SIGNAGE SHALL BE IN ACCORDANCE WITH STANDARD 701606.
 2. MAINTENANCE OF TRAFFIC, LANE CLOSURE, BARRICADES, AND SIGNAGE SHALL BE IN ACCORDANCE WITH STANDARD 701411 FOR EXIT/ENTRANCE RAMP.
 3. MAINTENANCE OF TRAFFIC, BARRICADES, AND SIGNAGE SHALL BE IN ACCORDANCE WITH STANDARD 701801 FOR SIDEWALK CLOSURE.
 4. FOR TEMPORARY TRAFFIC SIGNAL INFORMATION SEE SHEET 41 THRU 63.
 5. ALL DRUMS, TYPE I AND TYPE II BARRICADES SHALL BE SPACED AT 8 METERS CENTER TO CENTER ALONG TANGENTS AND 4 m CENTER TO CENTER ALONG CURVES.
 6. ALL LANE TAPERS SHALL BE AT LEAST 15:1.
 7. THE CONTRACTOR SHALL MAINTAIN ACCESS TO ONE SIDEWALK ACROSS THE BRIDGE AT ALL TIMES.
 8. CONTRACTOR MAY SHIFT TRAFFIC ON GREGORY AVENUE (EAST OF NAGLE AVENUE) DURING OFF PEAK HOURS, IN ORDER TO RESURFACE MIDDLE PORTION OF ROADWAY.
 9. CONTRACTOR MAY SHIFT TRAFFIC, AFTER RECONSTRUCTION OF SOUTH HALF OF INTERSECTION, ON BRYN MAWR AVENUE (EAST OF NAGLE AVENUE) DURING OFF PEAK HOURS, IN ORDER TO RECONSTRUCT PORTION OF ROADWAY.
 10. ARROW BOARDS SHALL BE PROVIDED AND INCLUDED IN THE COST FOR TRAFFIC CONTROL AND PROTECTION STANDARD 701606. THE ARROW BOARDS SHALL BE LOCATED AS SHOWN IN PLANS OR AS DIRECTED BY THE ENGINEER.
 11. CONTRACTOR SHALL MAINTAIN ALL REGULATORY SIGNAGE THROUGHOUT THE DURATION OF THE PROJECT AND THIS WORK SHALL BE INCLUDED IN THE COST FOR TRAFFIC CONTROL AND PROTECTION STANDARD 701606.

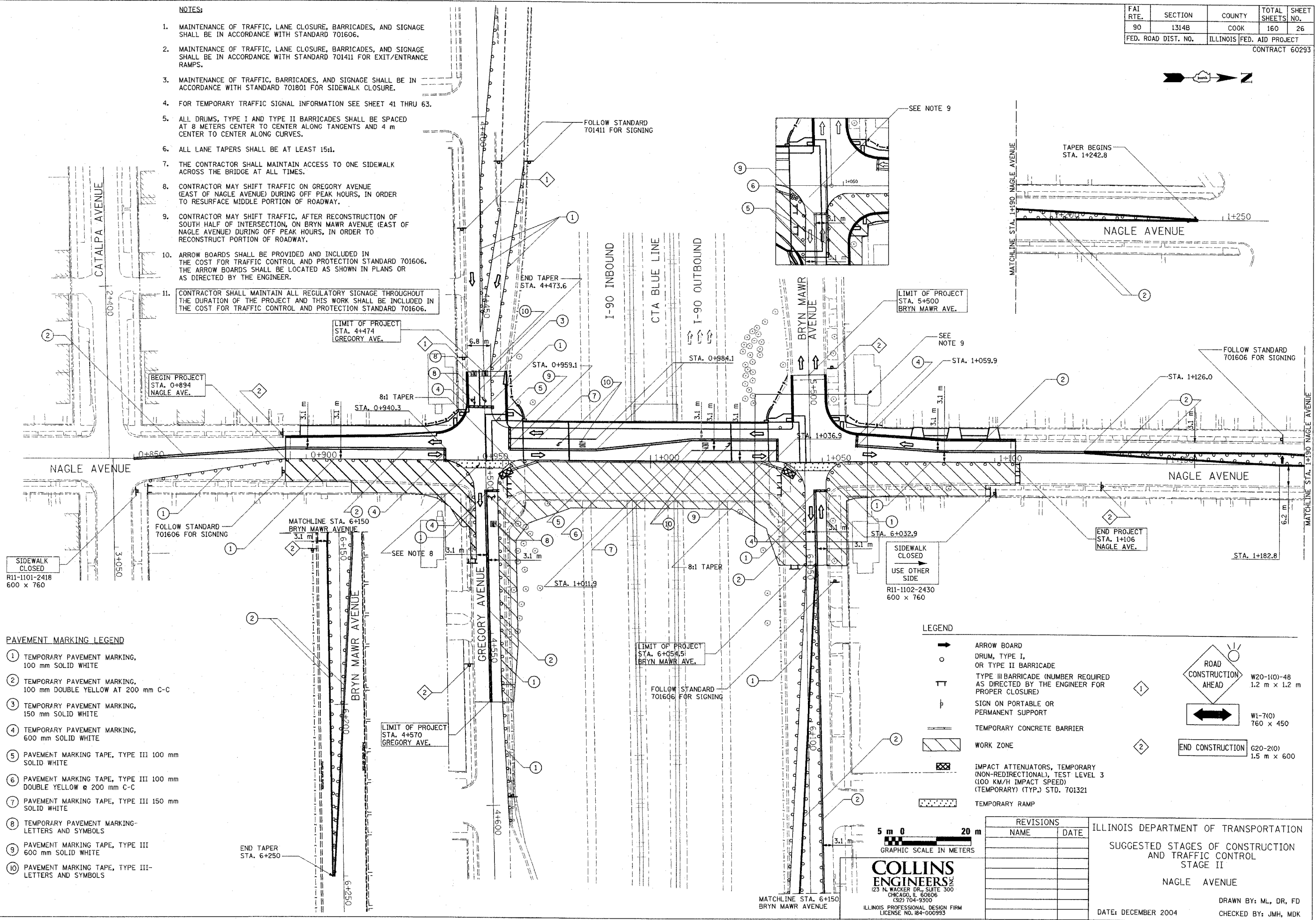

- PAVEMENT MARKING LEGEND**
1. TEMPORARY PAVEMENT MARKING, 100 mm SOLID WHITE
 2. TEMPORARY PAVEMENT MARKING, 100 mm DOUBLE YELLOW AT 200 mm C-C
 3. TEMPORARY PAVEMENT MARKING, 150 mm SOLID WHITE
 4. TEMPORARY PAVEMENT MARKING, 600 mm SOLID WHITE
 5. PAVEMENT MARKING TAPE, TYPE III 100 mm SOLID WHITE
 6. PAVEMENT MARKING TAPE, TYPE III 100 mm DOUBLE YELLOW @ 200 mm C-C
 7. PAVEMENT MARKING TAPE, TYPE III 150 mm SOLID WHITE
 8. TEMPORARY PAVEMENT MARKING-LETTERS AND SYMBOLS
 9. PAVEMENT MARKING TAPE, TYPE III 600 mm SOLID WHITE
 10. PAVEMENT MARKING TAPE, TYPE III-LETTERS AND SYMBOLS

- LEGEND**
- ARROW BOARD
 - DRUM, TYPE I, OR TYPE II BARRICADE
 - TYPE III BARRICADE (NUMBER REQUIRED AS DIRECTED BY THE ENGINEER FOR PROPER CLOSURE)
 - SIGN ON PORTABLE OR PERMANENT SUPPORT
 - TEMPORARY CONCRETE BARRIER
 - WORK ZONE
 - IMPACT ATTENUATORS, TEMPORARY (NON-REDIRECTIONAL), TEST LEVEL 3 (100 KM/H IMPACT SPEED) (TEMPORARY) (TYP.) STD. 701321
 - TEMPORARY RAMP
 - ROAD CONSTRUCTION AHEAD (W20-110)-48 1.2 m x 1.2 m
 - W1-710) 760 x 450
 - END CONSTRUCTION (G20-210) 1.5 m x 600

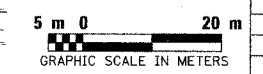

COLLINS ENGINEERS
123 N. WACKER DR., SUITE 300
CHICAGO, IL 60606
(312) 104-9500
ILLINOIS PROFESSIONAL DESIGN FIRM
LICENSE NO. 184-000993

REVISIONS	
NAME	DATE

ILLINOIS DEPARTMENT OF TRANSPORTATION
SUGGESTED STAGES OF CONSTRUCTION AND TRAFFIC CONTROL
STAGE II
NAGLE AVENUE
DRAWN BY: ML, DR, FD
CHECKED BY: JMH, MOK
DATE: DECEMBER 2004

FILE: G:\2724\CIVIL\EXHIBIT\NAGLE\2724020.dgn