

ROUTE NO.	SECTION	COUNTY	TOTAL SHEETS	SHEET NO.
FAU 2783	1314B	COOK	160	121
SHEET NO. S3				
S7 SHEETS				
CONTRACT 60293				

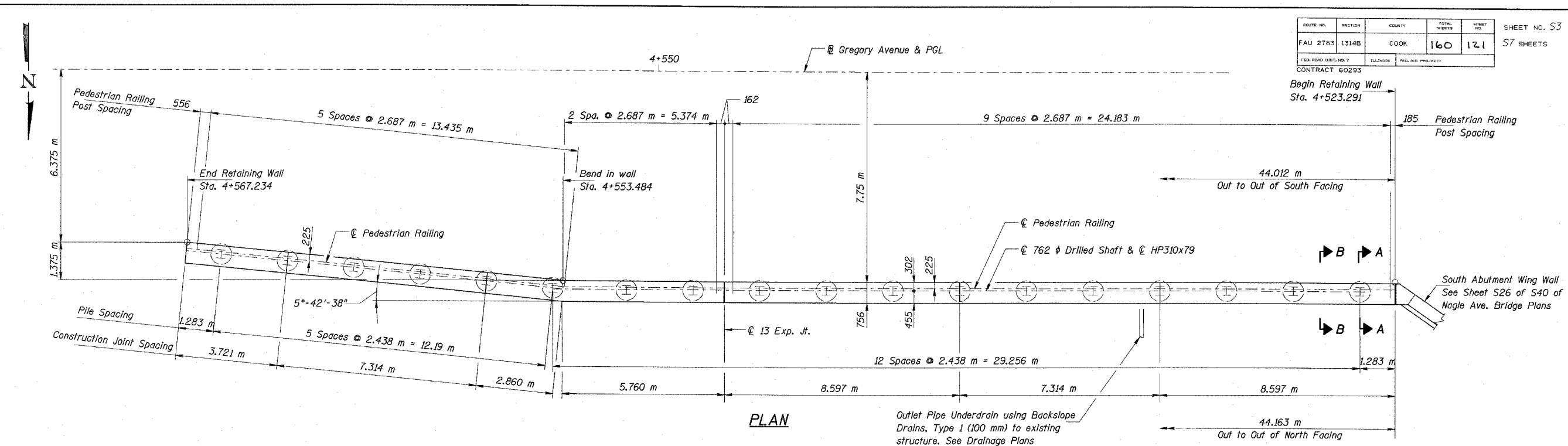

PLAN

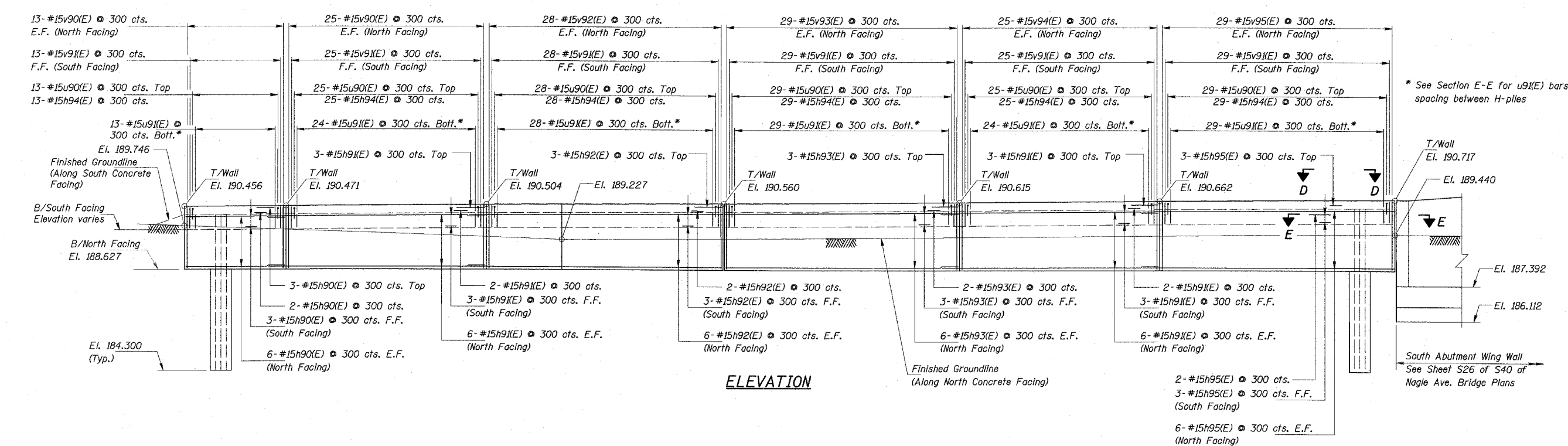

ELEVATION

Legend
 E.F. = Indicates Each Face
 F.F. = Indicates Front Face

Minimum Bar Laps
 #15 Bars = 640

Notes:
 Reinforcement bars designated (E) shall be epoxy coated.
 All dimensions are in millimeters (mm) except as noted.
 See Sheet S4 of S7 for Sections A-A, B-B, D-D & E-E
 Wall Facing Joint Details and Bill of Materials.
 See Sheet S5 of S7 for Pedestrian Railing Details.

REVISIONS	
NAME	DATE

COLLINS ENGINEERS
 123 N. WACKER DR., SUITE 300
 CHICAGO, IL 60606
 (312) 764-9300
 ILLINOIS PROFESSIONAL DESIGN FIRM
 LICENSE NO. 184-000993

ILLINOIS DEPARTMENT OF TRANSPORTATION
 F.A.I. 90 (I-90)
 AT NAGLE AVENUE
 F.A.U. RTE. 2783 SEC 1314B
 COOK COUNTY STATION 4+545.264
 STRUCTURE NO. 016-W779

RETAINING WALL DETAILS-I

DRAWN BY KAC
 CHECKED BY ERB/DGS
 DATE: DEC. 2004