

INLET BOX, TYPE B	RIM	INV	PIPE DRAINS, 300mm	METAL END SECTION, 300mm			
STATION	OFFSET	ELEV	LENGTH (m)	STATION	OFFSET	INV ELEV	
29+966.2	3.95m RT.	290.52	289.91	16.7	29+977.2	12.8m RT.	284.39
29+967.0	3.95m LT.	290.53	289.92	17.9	29+967.1	19.9m LT.	284.84
30+032.8	3.95m RT.	290.47	289.86	17.8	30+026.7	18.6m RT.	284.54
30+033.6	3.95m LT.	290.48	289.87	16.7	30+030.7	18.5m LT.	286.16

SECTION	COUNTY	TOTAL SHEETS	SHEET NO.
305	McHENRY	53	8
STA.	TO STA.		
FED. ROAD DIST. NO.	ILLINOIS FED. AID PROJECT		
CONTRACT NUMBER: 60756			

STATION	LOCATION
29+961.003 TO PARAPET WALL	RT.
PARAPET WALL TO 30+038.061	RT.

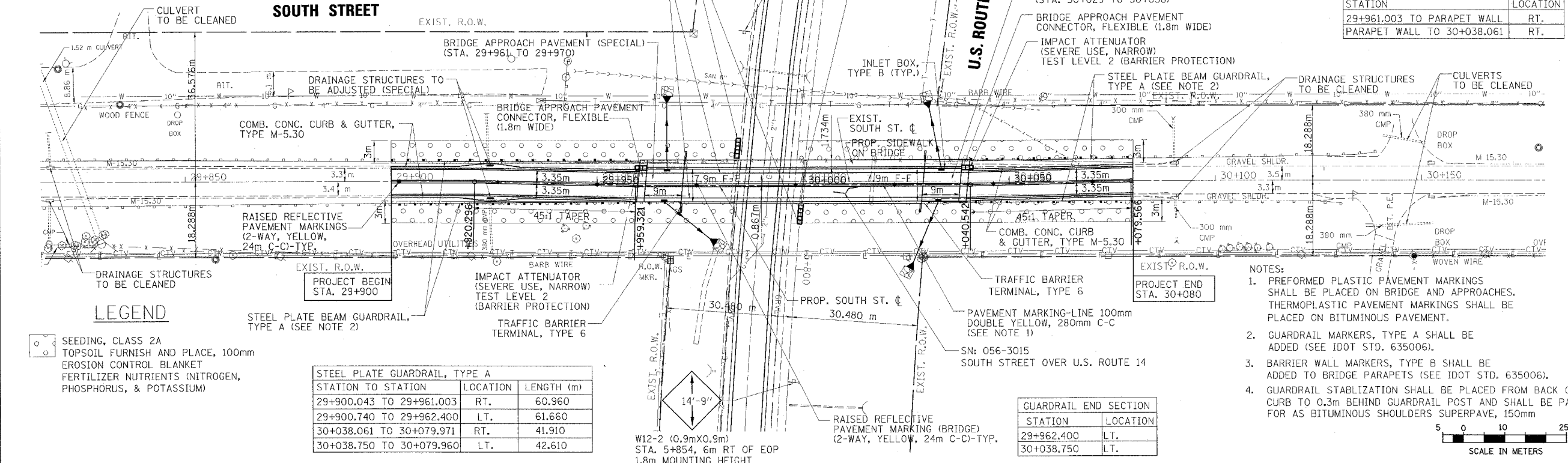

LEGEND

- SEEDING, CLASS 2A
- TOPSOIL FURNISH AND PLACE, 100mm
- EROSION CONTROL BLANKET
- FERTILIZER NUTRIENTS (NITROGEN, PHOSPHORUS, & POTASSIUM)

STATION TO STATION	LOCATION	LENGTH (m)
29+900.043 TO 29+961.003	RT.	60.960
29+900.740 TO 29+962.400	LT.	61.660
30+038.061 TO 30+079.971	RT.	41.910
30+038.750 TO 30+079.960	LT.	42.610

STATION	LOCATION
29+962.400	LT.
30+038.750	LT.

- NOTES:**
1. PREFORMED PLASTIC PAVEMENT MARKINGS SHALL BE PLACED ON BRIDGE AND APPROACHES. THERMOPLASTIC PAVEMENT MARKINGS SHALL BE PLACED ON BITUMINOUS PAVEMENT.
 2. GUARDRAIL MARKERS, TYPE A SHALL BE ADDED (SEE IDOT STD. 635006).
 3. BARRIER WALL MARKERS, TYPE B SHALL BE ADDED TO BRIDGE PARAPETS (SEE IDOT STD. 635006).
 4. GUARDRAIL STABILIZATION SHALL BE PLACED FROM BACK OF CURB TO 0.3m BEHIND GUARDRAIL POST AND SHALL BE PAID FOR AS BITUMINOUS SHOULDERS SUPERPAVE, 150mm

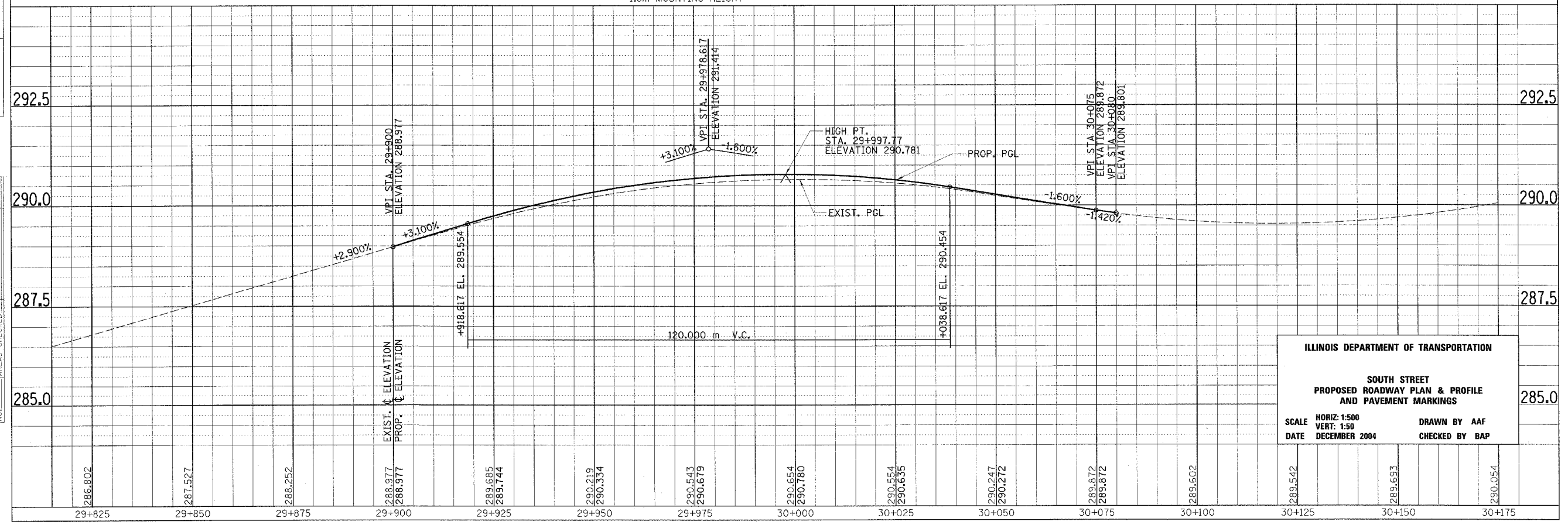
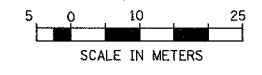

ILLINOIS DEPARTMENT OF TRANSPORTATION

**SOUTH STREET
PROPOSED ROADWAY PLAN & PROFILE
AND PAVEMENT MARKINGS**

SCALE: HORIZ: 1:500
VERT: 1:50
DATE: DECEMBER 2004

DRAWN BY: AAF
CHECKED BY: BAP

BY: _____ DATE: _____
 SURVEYED PLOTTED
 NOTE BOOK TEMPLATE
 AREAS CHECKED

HOH
 HARRY A. HOFFMAN ASSOCIATES, INC.
 DESIGN AND CONSULTING ENGINEERS
 1862
 G:\PROJECTS\1962\DGNS\CIVIL\1962CPPI.DGN

BY: _____ DATE: _____
 ORIGINAL SURVEYED
 SURVEY PLOTTED
 NOTE BOOK TEMPLATE
 AREAS CHECKED