

F.A.P. RTE.	SECTION	COUNTY	TOTAL SHEETS	SHEET NO.
337	19R-1	LAKE	800	1
			+ 34	
			834	834 sheets

STATE OF ILLINOIS  
DEPARTMENT OF TRANSPORTATION  
DIVISION OF HIGHWAYS  
**PROPOSED  
HIGHWAY PLANS**

IMPROVEMENT LOCATED IN VILLAGE  
OF LAKE ZURICH, LAKE COUNTY

FOR INDEX OF SHEETS, SEE SHEET NO. 2

DESIGN DESIGNATION  
3880(20) ARTERIAL 8.11(PCC-20)

POSTED SPEED LIMIT  
IL RTE 22 = 30 MPH  
US RTE 12 = 45 MPH

TRAFFIC DATA  
IL RTE 22, MALL DR TO US RTE 12 = 26,500 (2000), 40,000 (2020)  
IL RTE 22, US RTE 12 TO ELA RD = 17,000 (2000), 38,000 (2020)  
IL RTE 22, ELA RD TO OLD RAND RD = 20,100 (2000), 43,000 (2020)  
IL RTE 22, OLD RAND RD TO BUESCHING RD = 22,900 (2000), 32,000 (2020)  
US RTE 12, NORTH OF IL RTE 22 = 44,500 (2000), 52,000 (2020)  
US RTE 12, SOUTH OF IL RTE 22 = 48,800 (2000), 55,000 (2020)

F.A.P. ROUTE 337 (ILLINOIS ROUTE 22)  
WEST OF US ROUTE 12 TO EAST OF BUESCHING ROAD  
RECONSTRUCTION, WIDENING, RAILROAD BRIDGE OVER  
IL ROUTE 22, INTERSECTION IMPROVEMENTS, DRAINAGE, LIGHTING  
SECTION: 19R-1  
PROJECT: NHF-0337(006)  
LAKE COUNTY  
C-91-326-00

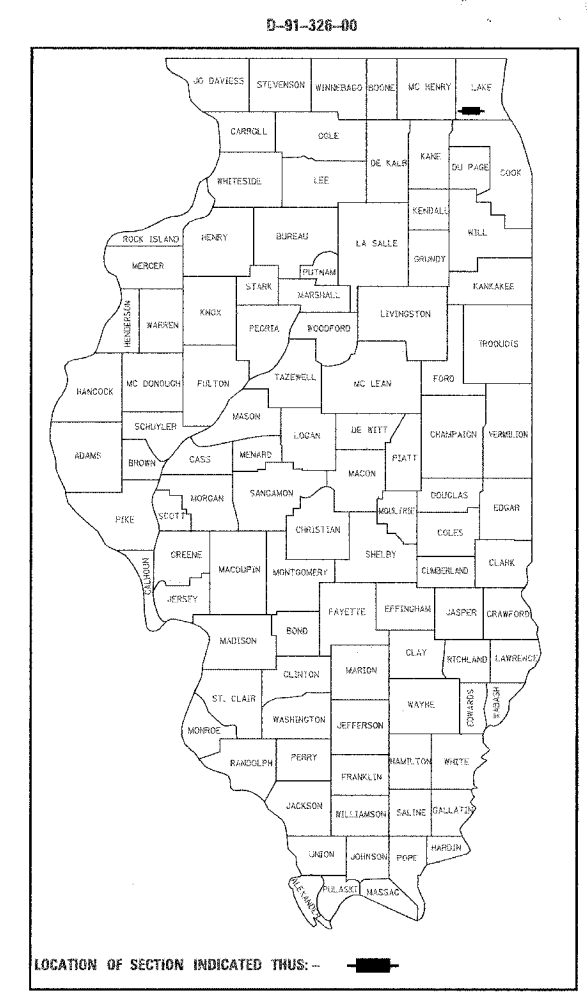

PRINTED BY THE AUTHORITY OF THE STATE OF ILLINOIS

METRIC RATIOS

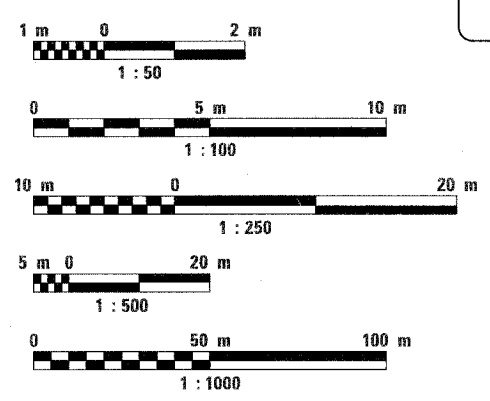

FULL SIZE PLANS HAVE BEEN PREPARED USING STANDARD ENGINEERING SCALES. REDUCED SIZED PLANS WILL NOT CONFORM TO STANDARD SCALES. IN MAKING MEASUREMENTS ON REDUCED PLANS, THE ABOVE SCALES MAY BE USED.

J.U.L.I.E.  
JOINT UTILITY LOCATION INFORMATION FOR EXCAVATION  
1-800-892-0123

CONTRACT NO. 60997

PROJECT ENGINEER: KIM VORMITTAG - (847) 705-4055

BEGIN PROJECT  
IL ROUTE 22  
STA. 6+927.80

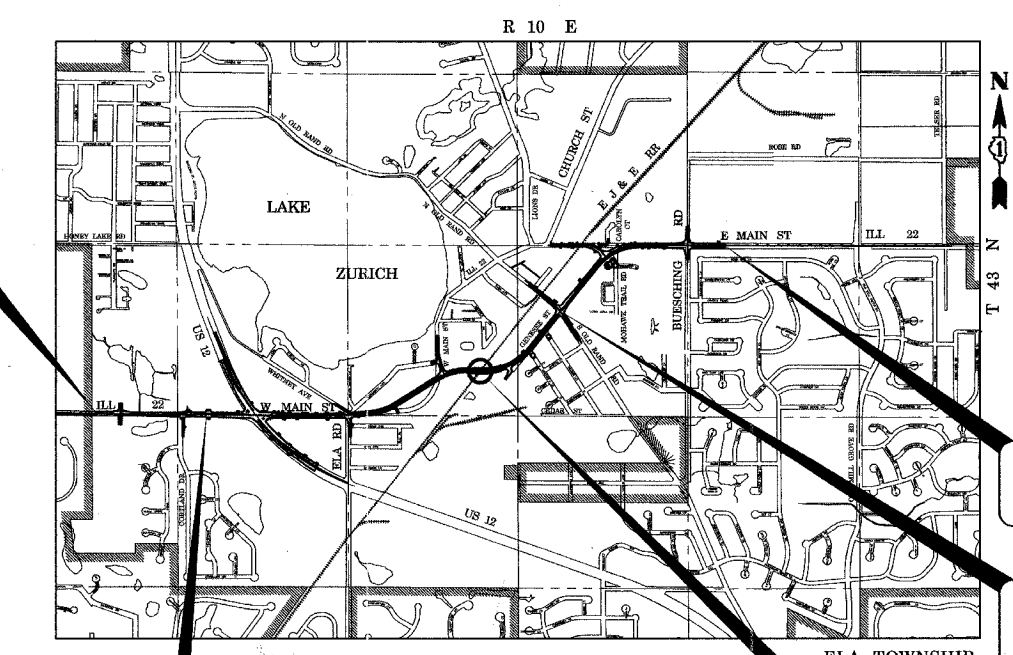

STATION EQUATION  
IL ROUTE 22  
STA. 7+449.930 BK  
STA. 7+449.825 AH

LOCATION MAP  
SCALE: 1:20,000

GROSS LENGTH OF PROJECT = 3.272 KM  
NET LENGTH OF PROJECT = 3.272 KM

END PROJECT  
IL ROUTE 22  
STA. 10+200.00

STATION EQUATION  
IL ROUTE 22  
STA. 9+290.163 BK  
STA. 9+292.400 AH

E J & E RR  
OVER IL RTE 22  
STA. 8+794.186  
STRUCTURE NUMBER  
049-0188



*David D. Landwehr* 7/21/04  
EXP. 11/30/05

STATE OF ILLINOIS  
DEPARTMENT OF TRANSPORTATION  
DIVISION OF HIGHWAYS  
SUBMITTED July 21, 20 04  
Diana O'Keefe/A DISTRICT ENGINEER  
October 1, 20 04  
Michael J. Blum ENGINEER OF DESIGN AND ENVIRONMENT  
October 1, 20 04  
Victor Mateer/mr DIRECTOR, DIVISION OF HIGHWAYS

PLANS PREPARED BY:  
**URS**  
1701 GOLF ROAD, SUITE 1000 TEL (847) 364-8800  
ROLLING MEADOWS IL. 60008 FAX (847) 364-8818