

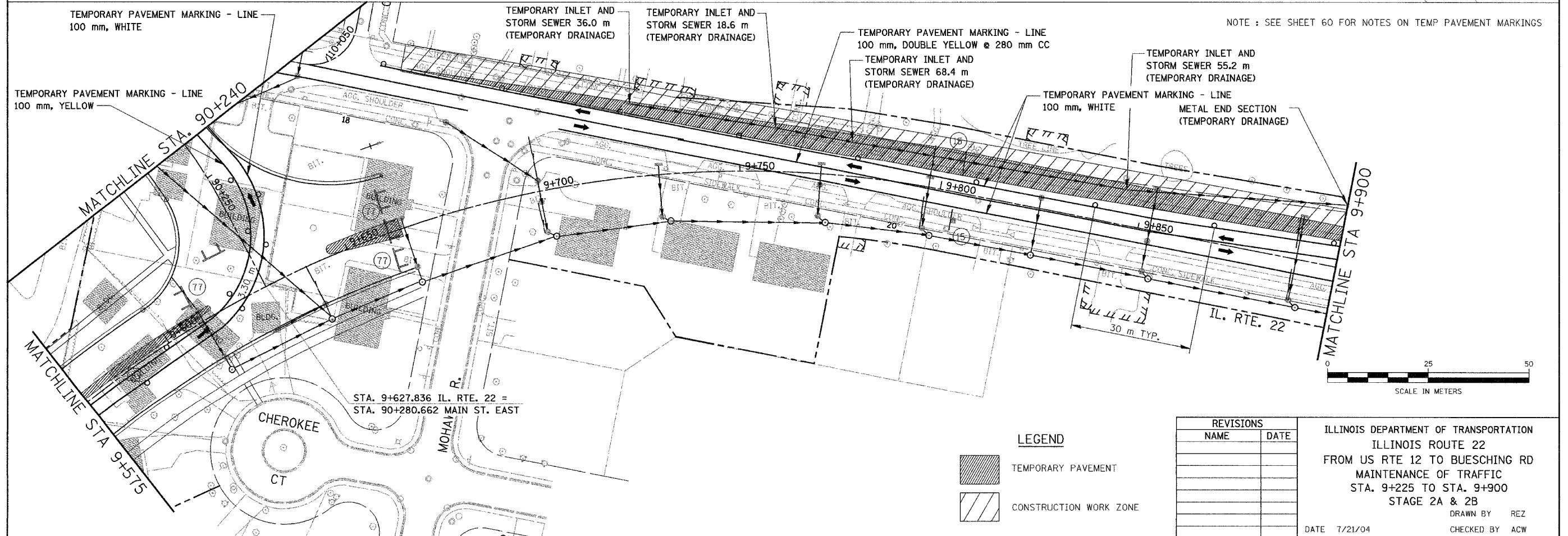

NOTE: SIGNS 54 AND 80 TO BE COVERED WHEN NOT IN USE

F.A. RTE.	SECTION	COUNTY	TOTAL SHEETS	SHEET NO.
337	19R-1	LAKE	800	124
STA.	TO STA.			
FED. ROAD DIST. NO.	ILLINOIS FED. AID PROJECT		60997	

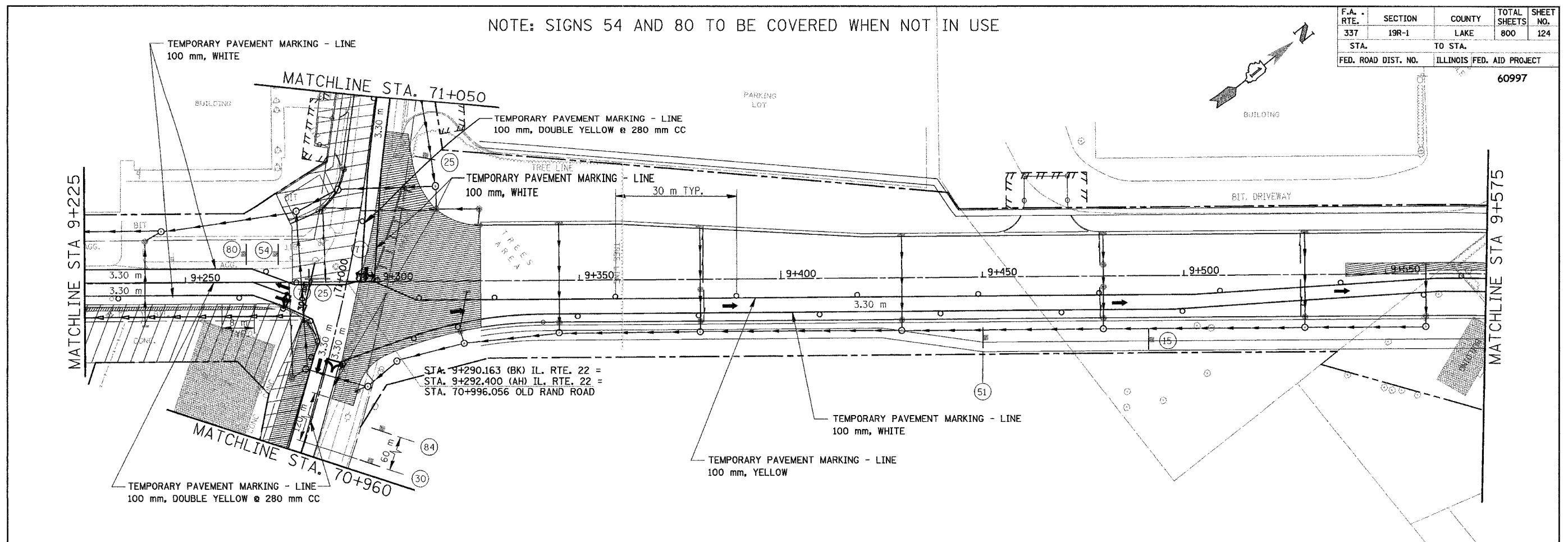

NOTE: SEE SHEET 60 FOR NOTES ON TEMP PAVEMENT MARKINGS

LEGEND

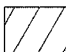
-  TEMPORARY PAVEMENT
-  CONSTRUCTION WORK ZONE

REVISIONS	
NAME	DATE

ILLINOIS DEPARTMENT OF TRANSPORTATION  
 ILLINOIS ROUTE 22  
 FROM US RTE 12 TO BUESCHING RD  
 MAINTENANCE OF TRAFFIC  
 STA. 9+225 TO STA. 9+900  
 STAGE 2A & 2B  
 DRAWN BY REZ  
 CHECKED BY ACW  
 DATE 7/21/04