

F.A. RTE.	SECTION	COUNTY	TOTAL SHEETS	SHEET NO.
337	19R-1	LAKE	800	202
STA.		TO STA.		
FED. ROAD DIST. NO.		ILLINOIS FED. AID PROJECT		

#60997

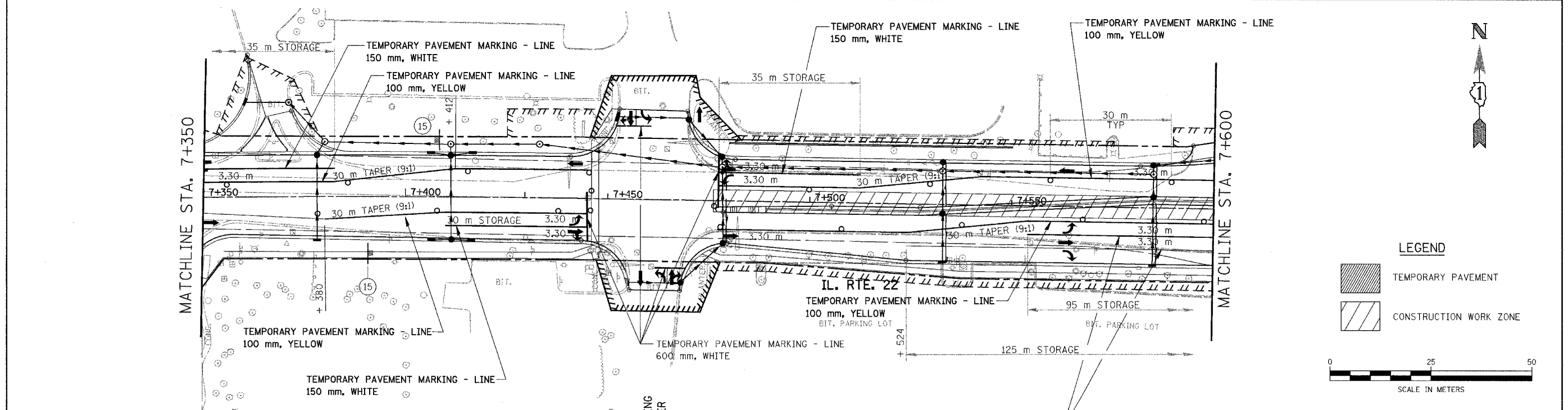
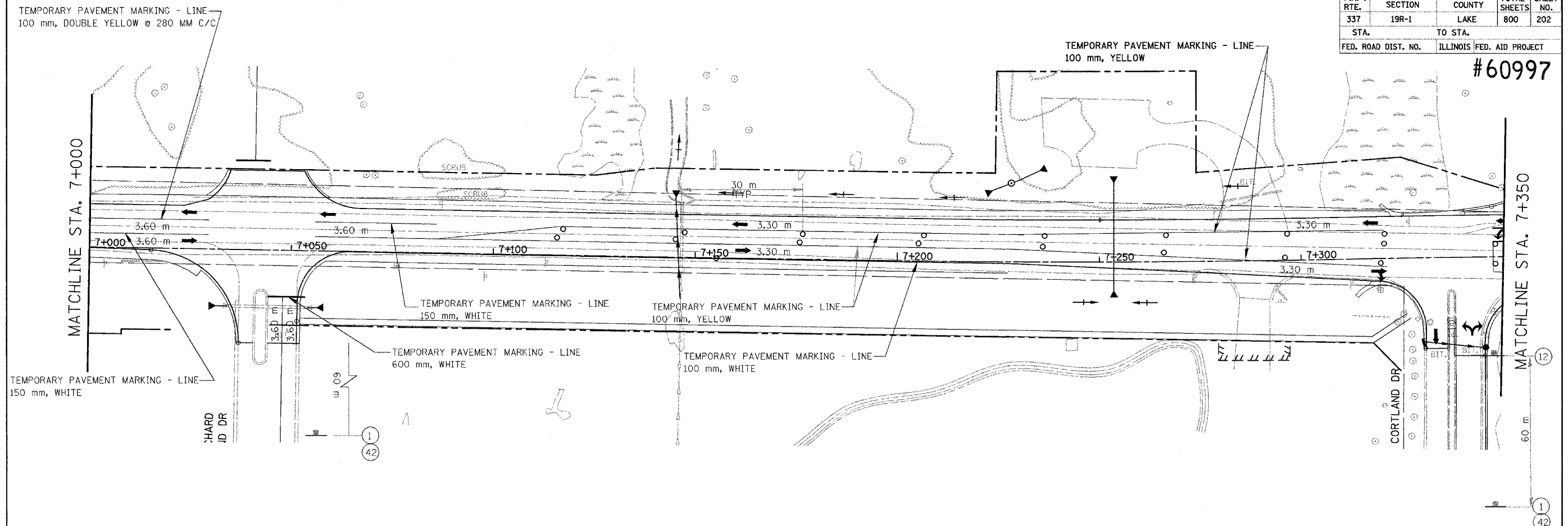

LEGEND

- TEMPORARY PAVEMENT
- CONSTRUCTION WORK ZONE

SCALE IN METERS

REVISIONS	
NAME	DATE
REVISOR	11/24/04
FROM STA. 6+922.366 TO STA. 7+440.820	

ILLINOIS DEPARTMENT OF TRANSPORTATION
 ILLINOIS ROUTE 22
 FROM US RTE 12 TO BUESCHING RD
 MAINTENANCE OF TRAFFIC
 STA. 7+000 TO STA. 7+600
 STAGE 6A & 6B

DATE 7/21/04

DRAWN BY DCS
 CHECKED BY SMK

NOTE: SEE SHEET 60 FOR NOTES ON TEMP PAVEMENT MARKINGS