

F.A. RTE.	SECTION	COUNTY	TOTAL SHEETS	SHEET NO.
337	19R-1	LAKE	800	240
STA.		TO STA.		
FED. ROAD DIST. NO.		ILLINOIS FED. AID PROJECT		

60997

- LEGEND**
- PAVEMENT REMOVAL
 - DRIVEWAY, SIDEWALK & MEDIAN REMOVAL
 - BIT SURF REMOVAL
 - BIT SURF REM BUTT JT
 - C & G REM
 - 10' TREE REMOVAL

RELOCATION OF EXISTING MAILBOXES SHALL BE COORDINATED WITH THE POST OFFICE. THIS WORK SHALL BE INCIDENTAL TO THE WORK.

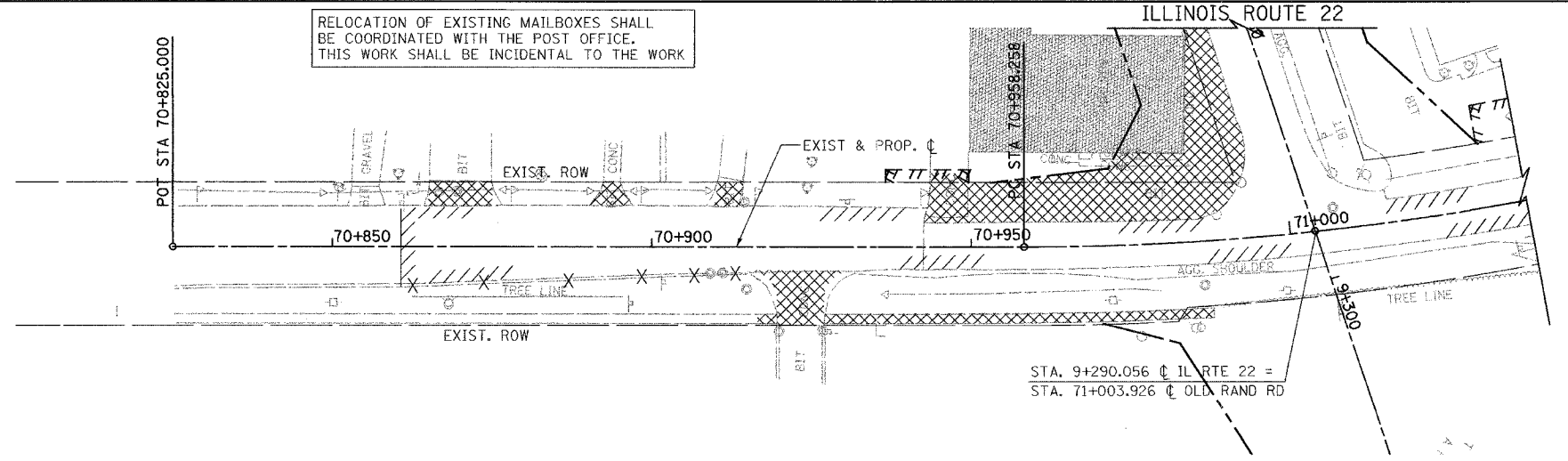

EXISTING PLAN

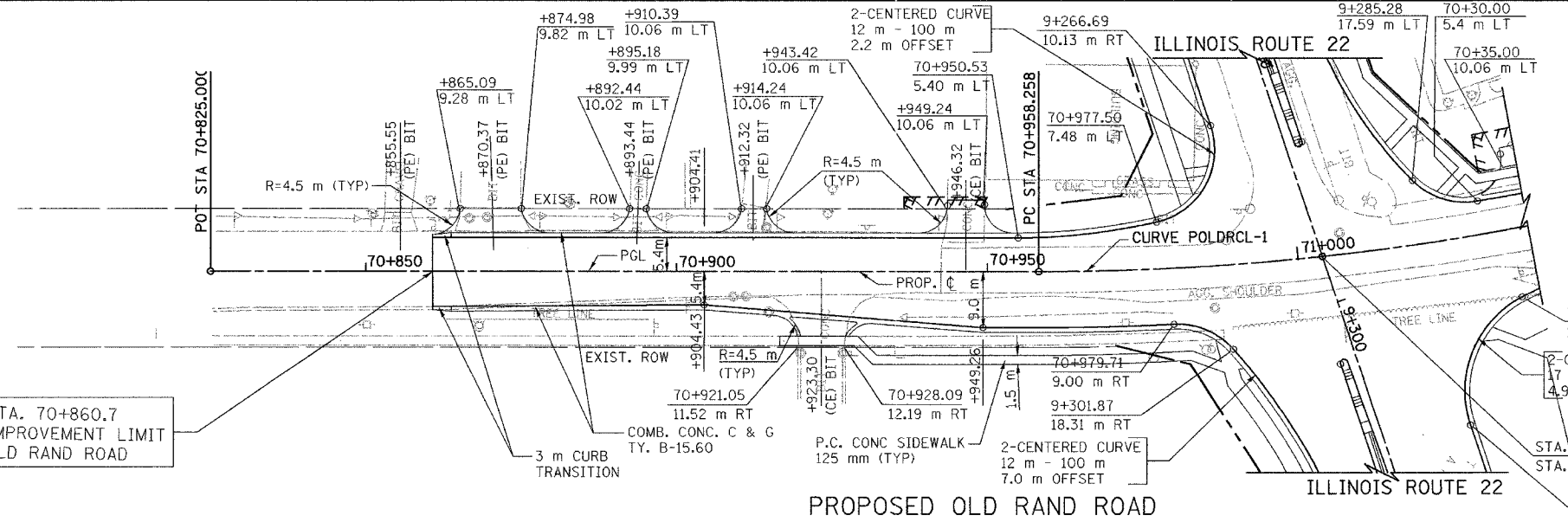

PROP. CURVE POLDRCL-1
 PI STA = 71+026.032
 $\Delta = 17^\circ 54' 50''$ (LT)
 R = 430.000 m
 T = 67.774 m
 L = 134.443 m
 E = 5.308 m
 $e =$ -----
 T.R. = ----- m
 S.E. = NC
 P.C. STA = 70+958.258
 P.T. STA = 71+092.700

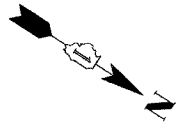

STA. 70+860.7
 IMPROVEMENT LIMIT
 OLD RAND ROAD

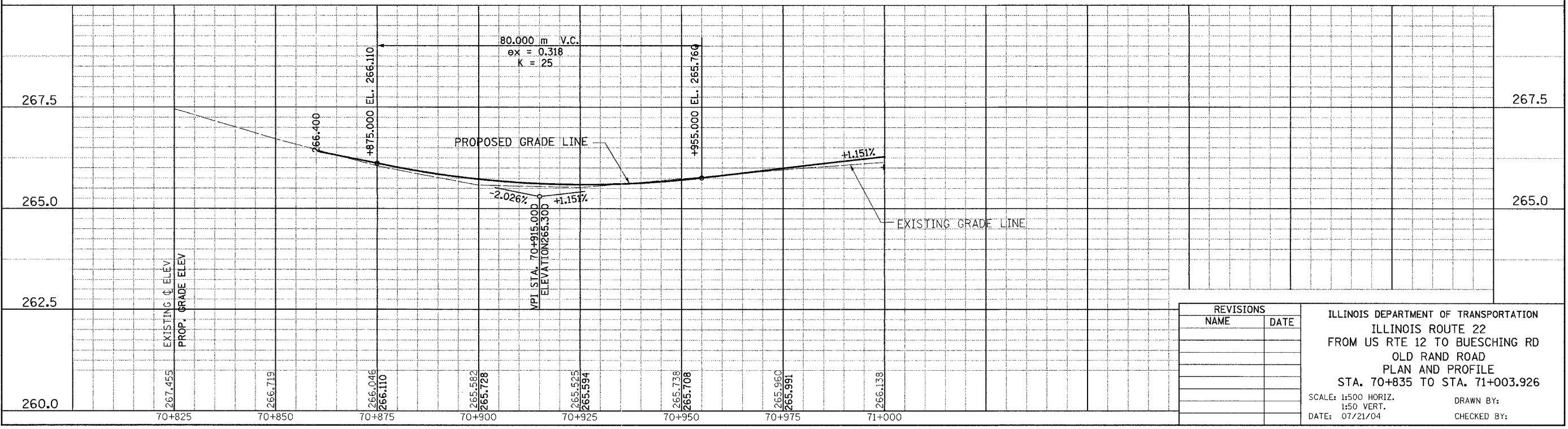

REVISIONS	
NAME	DATE

ILLINOIS DEPARTMENT OF TRANSPORTATION
 ILLINOIS ROUTE 22
 FROM US RTE 12 TO BUESCHING RD
 OLD RAND ROAD
 PLAN AND PROFILE
 STA. 70+835 TO STA. 71+003.926

SCALE: 1:500 HORIZ.
 1:50 VERT.
 DATE: 07/21/04

DRAWN BY:
 CHECKED BY:

FINAL SURVEY PLOTTED	BY	DATE
NOTE BOOK TEMPLATE		
AREAS CHECKED		
NO.		

ORIGINAL SURVEY PLOTTED	BY	DATE
NOTE BOOK TEMPLATE		
AREAS CHECKED		
NO.		