

F.A. RTE.	SECTION	COUNTY	TOTAL SHEETS	SHEET NO.
337	19R-1	LAKE	800	246A
STA.	TO STA.			
FED. ROAD DIST. NO.	ILLINOIS FED. AID PROJECT		CONTRACT NO. 60997	



LEGEND

[Hatched pattern]	PAVEMENT REMOVAL
[Cross-hatched pattern]	DRIVEWAY, SIDEWALK & MEDIAN REMOVAL
[Diagonal lines]	BIT SURF REMOVAL
[Diagonal lines]	BIT SURF REM BUTT JT
[Cross-hatched pattern]	C & G REM
[Circle with X]	TREE REMOVAL

PROJECT LIMITS
 STA. 6+927.80
 BEGIN CONSTRUCTION

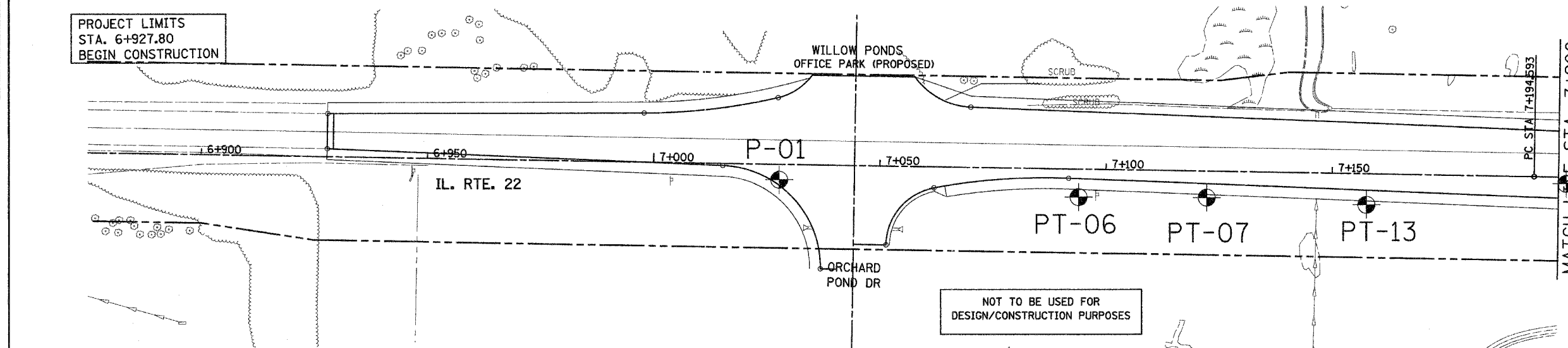
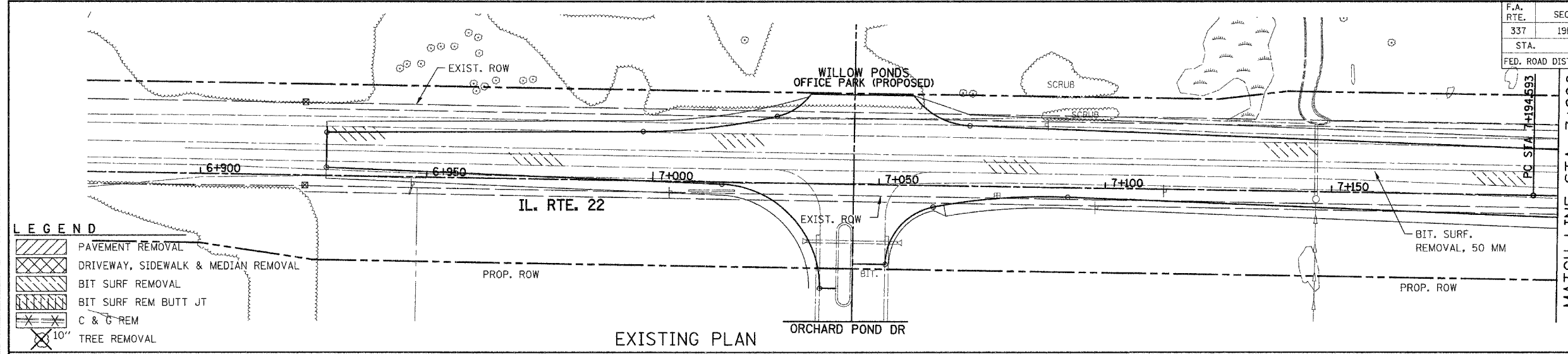

NOT TO BE USED FOR DESIGN/CONSTRUCTION PURPOSES

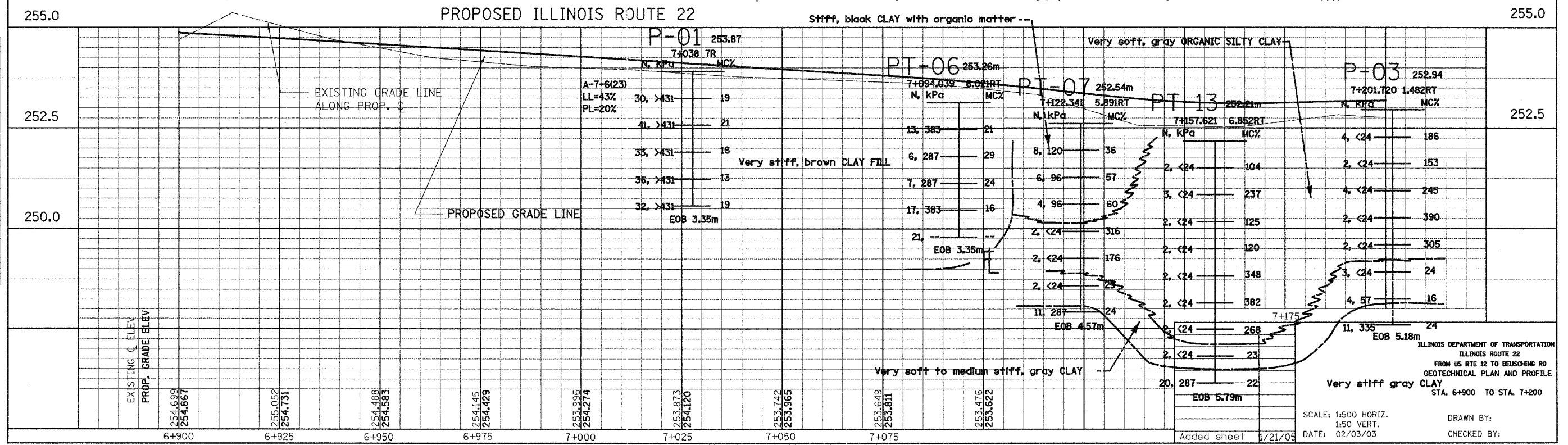

FINAL SURVEY PLOTTED
 NOTE BOOK TEMPLATE AREAS CHECKED
 NO. _____

ORIGINAL SURVEY PLOTTED
 NOTE BOOK TEMPLATE AREAS CHECKED
 NO. _____

SCALE: 1:500 HORIZ.
 1:50 VERT.
 DATE: 02/03/03
 DRAWN BY:
 CHECKED BY:

ILLINOIS DEPARTMENT OF TRANSPORTATION
 ILLINOIS ROUTE 22
 FROM US RTE 12 TO BEUSCHING RD
 GEOTECHNICAL PLAN AND PROFILE
 STA. 6+900 TO STA. 7+200