

F.A. RTE.	SECTION	COUNTY	TOTAL SHEETS	SHEET NO.
337	19R-1	LAKE	800	246Y
STA. 9+290.056		TO STA. 71+225.426		
FED. ROAD DIST. NO.		ILLINOIS FED. AID PROJECT		
CONTRACT NO. 60997				

FINAL SURVEYED SURVEY PLOTTED	BY	DATE
NOTE BOOK TEMPLATE AREAS CHECKED		
NO.		

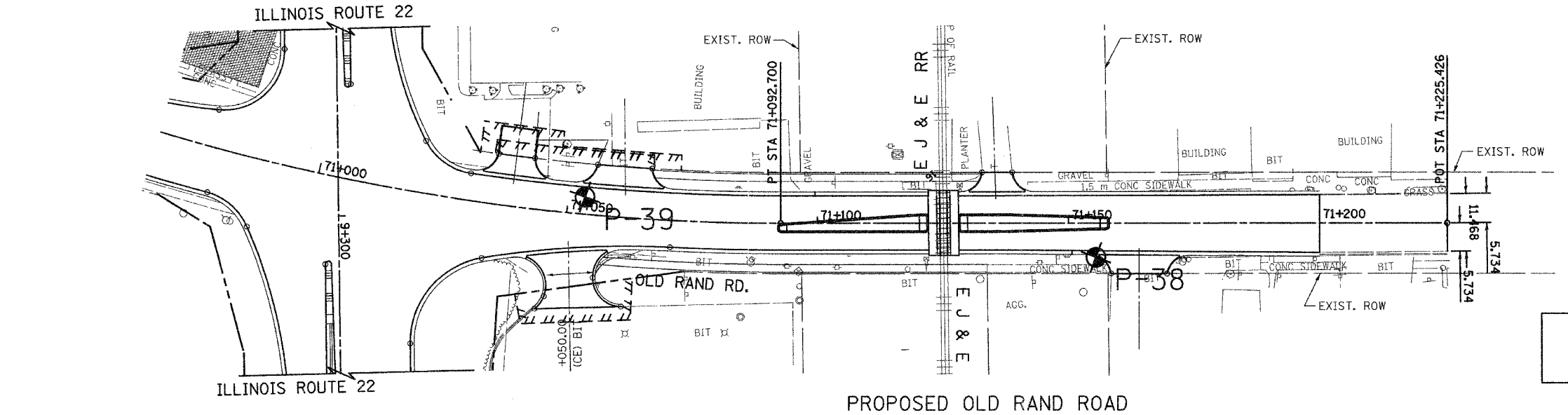
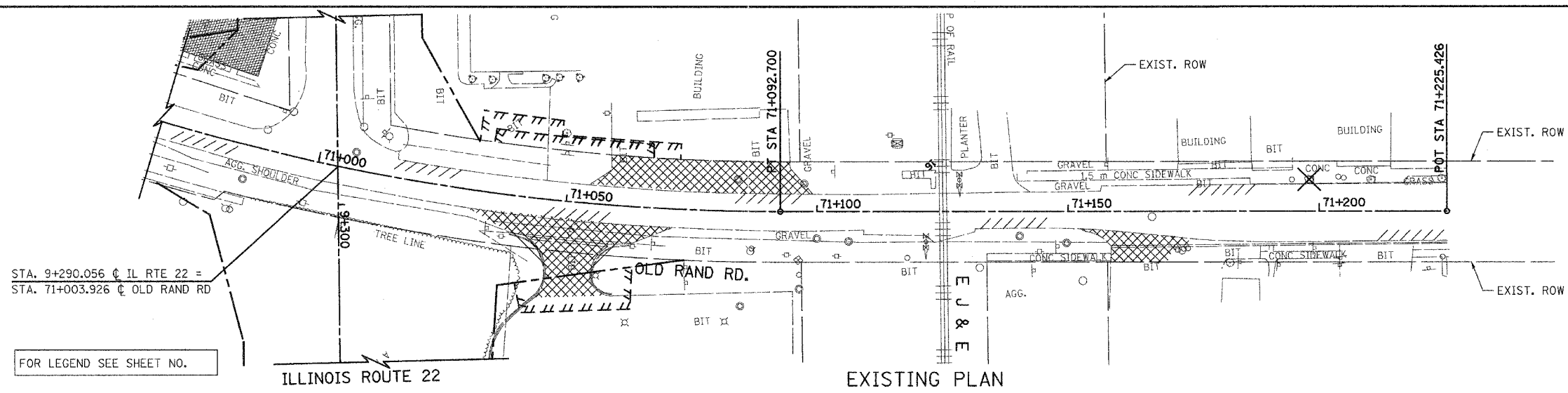

NOT TO BE USED FOR DESIGN/CONSTRUCTION PURPOSES

ORIGINAL SURVEYED SURVEY PLOTTED	BY	DATE
NOTE BOOK TEMPLATE AREAS CHECKED		
NO.		

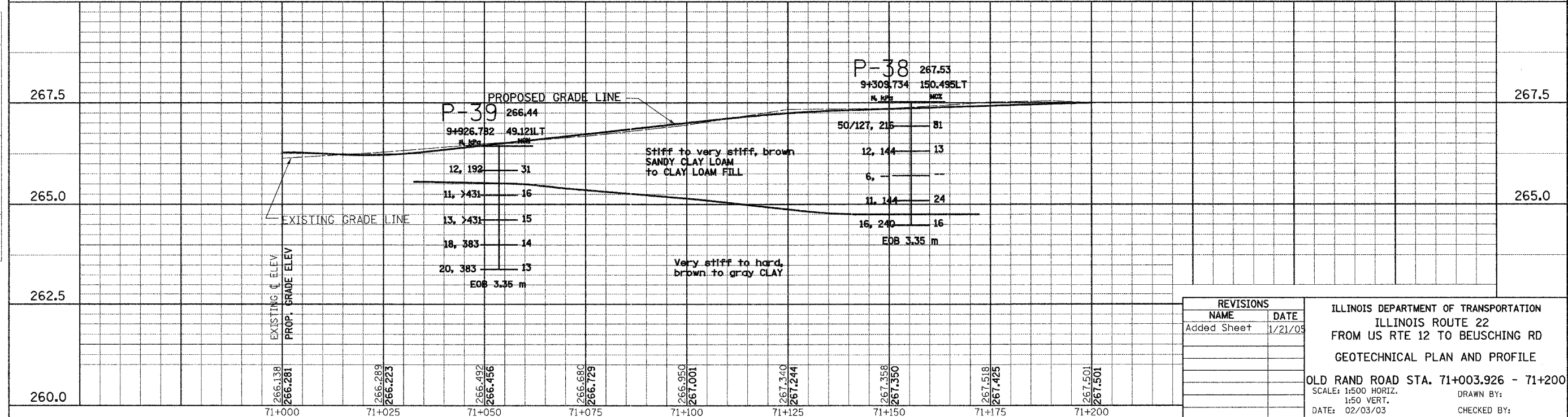

REVISIONS	
NAME	DATE
Added Sheet	1/21/09

ILLINOIS DEPARTMENT OF TRANSPORTATION  
 ILLINOIS ROUTE 22  
 FROM US RTE 12 TO BEUSCHING RD  
 GEOTECHNICAL PLAN AND PROFILE

OLD RAND ROAD STA. 71+003.926 - 71+200  
 SCALE: 1:500 HORIZ.  
 1:50 VERT.  
 DATE: 02/03/03  
 DRAWN BY:  
 CHECKED BY: