

F.A. RTE.	SECTION	COUNTY	TOTAL SHEETS	SHEET NO.
337	19R-1	LAKE	800	246F
STA.	TO STA.			
FED. ROAD DIST. NO.	ILLINOIS FED. AID PROJECT		CONTRACT NO. 60997	

FINAL SURVEY PLOTTED	DATE
NOTE BOOK TEMPLATE	
AREAS CHECKED	
NO.	

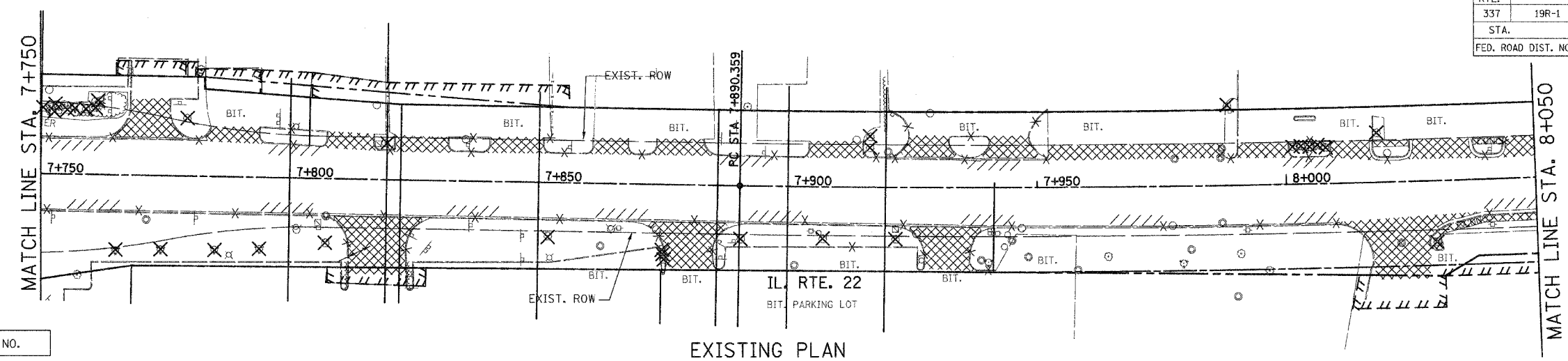

FOR LEGEND SEE SHEET NO.



ORIGINAL SURVEY PLOTTED	DATE
NOTE BOOK TEMPLATE	
AREAS CHECKED	
NO.	

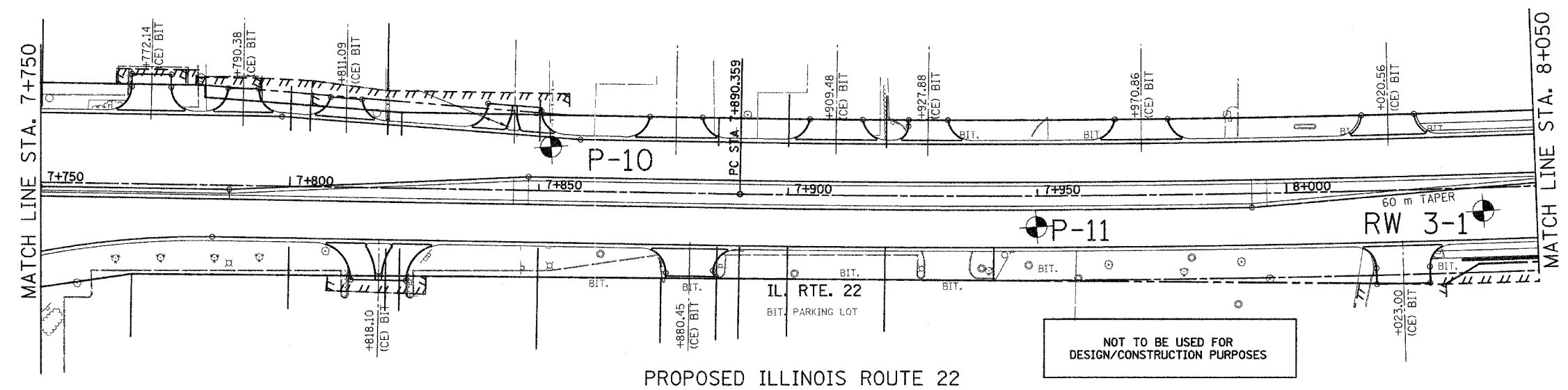

PROP. CURVE 618
 PI STA = 8+060.564
 $\Delta = 6^\circ 41' 38''$ (LT)
 R = 2,910.449 m
 T = 170.206 m
 L = 340.024 m
 E = 4.973 m
 $e =$ -----
 T.R. = ----- m
 S.E. RUN. = ----- m
 P.C. STA = 7+890.359
 P.T. STA = 8+230.383

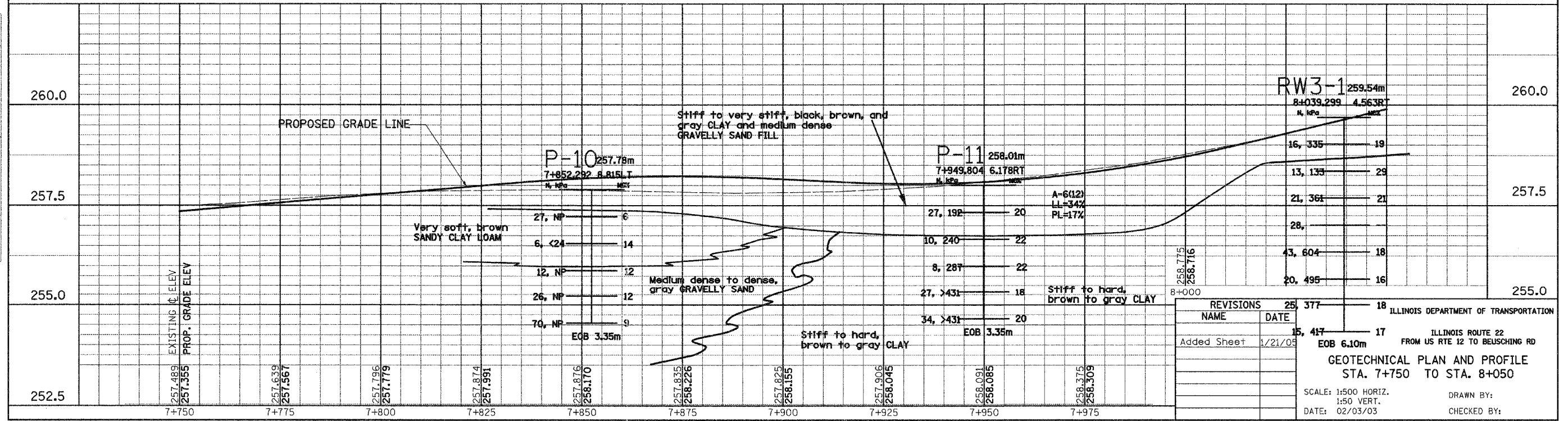

REVISIONS NAME	DATE
Added Sheet	1/21/03

ILLINOIS DEPARTMENT OF TRANSPORTATION
 ILLINOIS ROUTE 22
 FROM US RTE 12 TO BEUSCHING RD
GEOTECHNICAL PLAN AND PROFILE
 STA. 7+750 TO STA. 8+050
 SCALE: 1:500 HORIZ.
 1:50 VERT.
 DATE: 02/03/03
 DRAWN BY:
 CHECKED BY: