

PIPE NO.	D5	D6	D7	D8	E12A	E12	E9	E10	E11	E24A	E13	E14	E15	E16	E17	E18	E8	E20	E21		E23	E24	E25	E26		D5B	E16A	D5A
SIZE (mm)	300	300	300	300	375	375	375	450	375	300	450	300	300	375	300	300	300	375	375		300	300	300	300		300	300	300
LENGTH (m)	1.5	19.5	34.2	27.1	13.5	3.8	6.9	46.5	2.1	11.9	31.8	2.1	11.9	22.8	2.1	11.9	2.7	37.8	2.1		3.8	6.4	11.1	17.1		25.1	2.7	1.6
TYPE	1	1	2	2	1	1	1	2	2	1	2	1	1	1	1	1	1	1	1		2	1	1	1		2	1	1
T.B.F. (CU. M.)	1.00	5.40	22.60	9.80	8.20	8.30	14.60	N/A	1.00	3.30	N/A	1.00	2.80	N/A	1.00	3.30	N/A	N/A	1.00		1.00	1.50	2.60	4.00		16.60	N/A	1.00

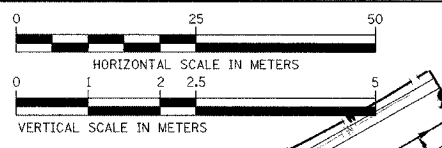

F.A. RTE.	SECTION	COUNTY	TOTAL SHEETS	SHEET NO.
337	19R-1	LAKE	800	262
STA.	TO STA.			
FED. ROAD DIST. NO.	ILLINOIS FED. AID PROJECT		60997	

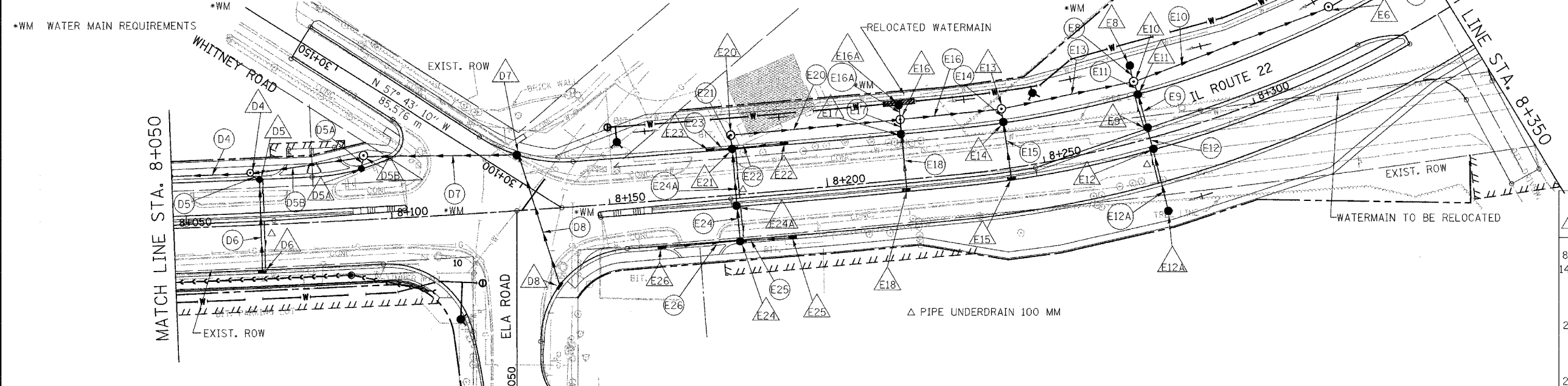

D5B	E16A
8+094.1	8+218.8
14.43 LT	17.0 LT
CB-A	CB-C
1.2	0.6
T-24	T-8
261.100	260.644
	260.150
	259.261

STR. NO.	D4	D5	D6	D7	D8	E6	E12A	E8
STA.	8+068.0	8+070.0	8+070.0	8+129.9	8+137.2	8+325.0	8+275.0	8+275.0
OFF. (m)	12.0 LT	10.35 LT	10.35 RT	12.56 LT	17.57 RT	13.6 LT	17.1 RT	17.2 LT
TYPE	MH-A	CB-A	INL-A	CB-A	INL-A	MH-A	CB-C	CB-C
DIA. (m)	1.2	1.2	0.6	1.2	0.6	1.2	0.6	0.6
F&G	T-1-CL	T-24	T-24	T-24	T-24	T-1-CL	T-8	T-8
RIM EL.	260.331	260.238	260.238	261.153	260.925	261.800	260.700	260.825
INV. N	258.900	259.001	259.200	259.829	260.100	260.865	260.100	260.275
INV. S	258.870	259.001				259.769		
INV. E	258.870	259.383				259.769		
INV. W	258.300		259.500			259.709		

STR. NO.	E9	E10	E11	E12	E13	E14	E15	E16	E17	E18	E24A	E20	E21	E22	E23	E24	E25	E26	D5A
STA.	8+275.0	8+275.0	8+275.0	8+275.0	8+242.0	8+242.0	8+242.0	8+218.0	8+218.0	8+218.0	8+179.0	8+179.0	8+179.0	8+191.0	8+174.0	8+179.0	8+191.0	8+161.0	8+093.0
OFF. (m)	2.24 LT	13.60 LT	10.35 LT	2.75 RT	13.60 LT	10.35 LT	2.75 RT	13.60 LT	10.35 LT	2.75 RT	13.60 LT	10.35 LT	10.35 LT	10.35 LT	10.35 LT	10.35 RT	10.35 RT	10.35 RT	11.62 LT
TYPE	CB-A	MH-A	CB-A	CB-A	MH-A	CB-A	INL-A	MH-A	CB-A	INL-A	CB-A	MH-A	CB-A	INL-A	INL-A	CB-A	INL-A	INL-A	INL-A
DIA. (m)	1.2	1.2	1.2	1.2	1.2	1.2	0.6	1.2	1.2	0.6	1.2	1.2	0.6	0.6	0.6	1.2	0.6	0.6	0.6
F&G	T-24	T-1-CL	T-24	T-24	T-1-CL	T-24	T-24	T-1-CL	T-24	T-24	T-24	T-1-CL	T-24	T-24	T-24	T-24	T-24	T-24	T-24
RIM EL.	262.868	262.155	261.564	261.830	261.250	261.398	261.649	261.498	261.419	261.517	261.361	261.313	261.209	261.228	261.213	261.209	261.209	261.334	261.776
INV. N	260.014	260.243	259.979	260.032	261.250	261.398	261.649	260.130	260.233	260.350	260.302	260.302	260.243	260.243	260.243	260.334			
INV. S	260.014	259.968	259.979	260.032	260.360	260.380	260.500	260.212	260.233	260.233	260.302	260.222	260.243	260.243	260.243	260.334			
INV. E	260.014	259.857	259.979	260.032	260.360	260.380	260.500	260.212	260.233	260.233	260.302	260.222	260.243	260.243	260.243	260.334			
INV. W		259.917		260.041	260.041	260.380	260.500	260.212	260.233	260.233	260.302	260.222	260.243	260.243	260.243	260.334	260.410	260.420	259.800

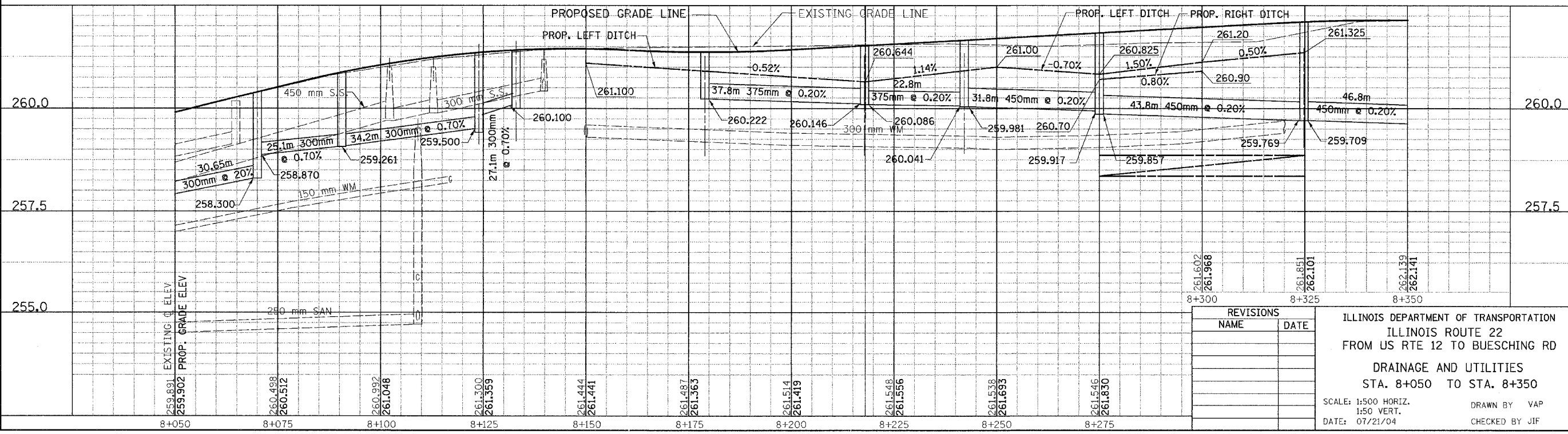

REVISIONS	
NAME	DATE

ILLINOIS DEPARTMENT OF TRANSPORTATION
 ILLINOIS ROUTE 22
 FROM US RTE 12 TO BUESCHING RD
 DRAINAGE AND UTILITIES
 STA. 8+050 TO STA. 8+350
 SCALE: 1:500 HORIZ.
 1:50 VERT.
 DATE: 07/21/04
 DRAWN BY: VAP
 CHECKED BY: JIF

FINAL SURVEY PLOTTED. NOTE 0004. AREAS CHECKED.

ORIGINAL SURVEY PLOTTED. NOTE 0004. AREAS CHECKED.